

BACKGROUND INFORMATION DOCUMENT

PROPOSED PROSPECTING RIGHT APPLICATION ON PORTION 09 AND 13 OF THE FARM RESERVE NO.12 15832-HU IN THE MAGISTERIAL DISTRICT OF NONGOMA IN THE KWAZULU NATAL PROVINCE: **KZN30/5/1/1/2/11125 PR**

Prepared by: **Geo-Aspex (Pty) Ltd**

Prepared for: **Contrarians Capital Pty Ltd**

PURPOSE OF THIS DOCUMENT

Geo-Aspex (Pty) Ltd has been appointed as an independent Environmental Consultant by **Contrarians Capital Pty Ltd** to conduct Environmental Impact Assessment (EIA), Compile an Environmental Management Plan (EMP) and undertake Public Participation Process (PPP). This is done for processes of acquiring environmental authorization for the proposed Prospecting Right application within **Portion 09 and 13 of the farm reserve no.12 15832-HU in the magisterial district of Nongoma in the KwaZulu Natal Province**

The Purpose of this Background Information Document (BID) is to provide a perfunctory description of the project and outline EIA processes to be followed and contributions from Interested and Affected Parties (IAPs) on the issues related to the project in question, allowing comments and concerns to be raised.

Results of the EIA, both negative and positive will be submitted and made available to the relevant Departments such as the Department of Mineral Resources and if requested, Environmental Affairs, Water and Sanitation, Landowners and other interested stakeholders.

This Background Information Document therefore requests and invites IAPs to comment on the environmental, physical, social and economic impacts associated with the proposed Mining Activities. Be assured that your comments are of great value as they ensure that relevant issues are taken into consideration. Attached at the end of this document is a registration form, kindly complete it and send it back to Livhuwani Sigwadi through given means of communication also attached there.

PROJECT DESCRIPTION

The prospecting work will be done in phases, each phase conditional on the success of the previous phase. Desktop Studies as the preliminary assessment of the potential resource area or rather the applied farm and its surrounding areas. It provides baseline information which includes but not limited to; exact location of the farm, accessibility, general topography, and the geological setting of the area. Coal, Iron Ore, Psuedocoal, Mica, Graphite, Manganese and Torbanite drilling operations will be carried out for the purpose of retrieving core samples and laboratory analyses will be performed on the core samples to establish the quality of coal and associated rocks properties. Ten (10) exploration boreholes will be drilled, each up to a depth of approximately 500 m are planned for the five years period; however, a 20% additional or retention of boreholes may be necessary depending on the new geological information gathered during the initial stages of the drilling programme. On average, a borehole takes approximately three days to complete. Should it be necessary to conduct any bulk sampling operations, an application for Ministerial approval in terms of Section 20 of the Mineral and Petroleum Resources Development Act, 2002, which includes an amended Environmental Management Plan (EM Plan), will be submitted once the necessary studies have been conducted.

REGULATORY FRAMEWORK

Therefore, EIA process to be undertaken will be conducted in accordance with the National Environmental Management Act (Act 38 of 1998) and Environmental Impact Assessment regulations as amended (April 2017).

The prospecting right is required for a period of five years. Prospecting will take place according to the time-frame for the **Coal, Iron Ore, Psuedocoal, Mica, Graphite, Manganese and Torbanite** minerals therefore; this will be conducted in accordance with Mineral and Petroleum Resources Development Act, (Act 28 of 2002). Other regulatory guidelines to be followed include: National Water Act, 1998 (Act 36 of 1998), National Air Quality Standards (GN 1210: 2009) and National Dust Control Regulations (GN 275: 2017).

BASIC AND ENVIRONMENTAL IMPACT ASSESSMENT PROCESSES

These are planning and decision-making tools used in identifying potential environmental, economic and social consequences of a proposed activity prior the commencement of the activity.

These together with the public issues and concerns are to be identified sufficiently early so that they can be assessed and incorporated into the final reports when/if necessary.

These tools are regarded crucial because they are utilized in order to demonstrate to the relevant stakeholders about the potential impacts, which in turn leads to the Mining application process being a success or declined.

PUBLIC PARTICIPATION PROCESS

Public Participation remains a cornerstone of the Environmental Impact Assessment process. It ensures provision of relevant and enough information with openness and transparency. Public Participation process presents to IAPs, an opportunity to understand what the project is about, and affords them an opportunity to make valuable contributions towards the EIA process.

IAP can be any person, group of persons or organization interested in or affected by the proposed activity, and any organ of state that may have jurisdiction over any aspect of the activity.

The key objective of PPP during the Scoping phase is to afford the IAPs with an opportunity to comment and provide valuable inputs during the planning phase of the project.

For this specific proposed project, IAPs will be given a period of 30 days to comment and raise issues/concerns with regards to this BID.

Kindly keep the following dates:

- ❖ Stakeholder engagement and consultation: **26 November 2021 – 15 January 2022**
- ❖ Review of Draft Basic Assessment Report: **16 January 2022 – 14 February 2022**
- ❖ Submission of the Final EMP: **18 February 2022**

Please note: According to the regulation3(3) of the NEMA regulations, public participation process (PPP) will not take place from the 15th of December 2021 to the 5th of January 2022.

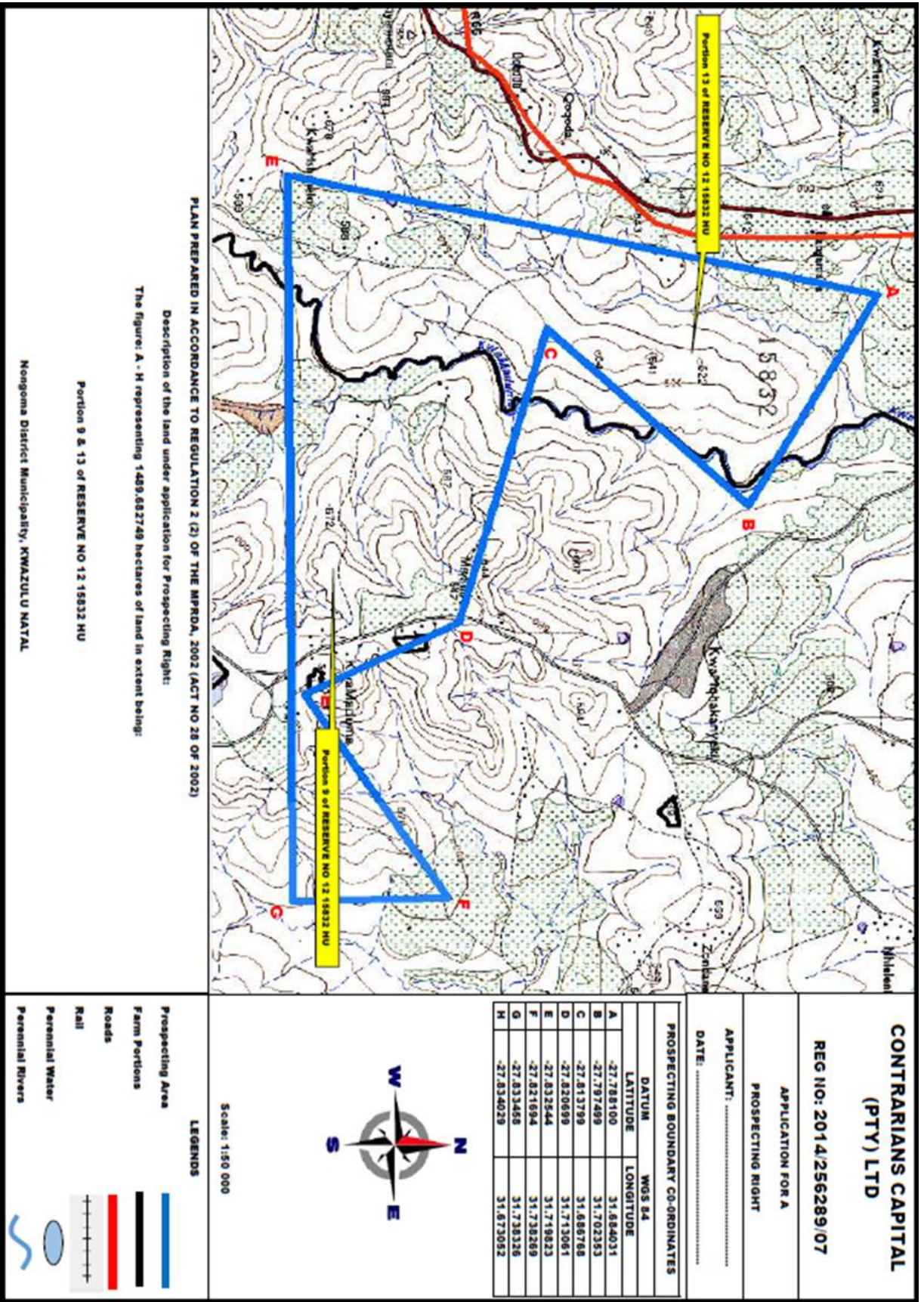

PLAN PREPARED IN ACCORDANCE TO REGULATION 2 (2) OF THE MPRDA, 2002 (ACT NO 28 OF 2002)

Description of the land under application for Prospecting Right:

The figure: A - H representing 1489,682749 hectares of land in extent being:

Portion 9 & 13 of RESERVE NO 12 15832 HU

Nongoma District Municipality, KWAZULU NATAL

**CONTRARIANS CAPITAL
(PTY) LTD**

REG NO: 2014/256289/07

APPLICATION FOR A
PROSPECTING RIGHT

APPLICANT:

DATE:

PROSPECTING BOUNDARY CO-ORDINATES

DATUM	WGS 84
LATITUDE	LONGITUDE
A	-27.788100 31.684031
B	-27.797499 31.702353
C	-27.813799 31.686768
D	-27.820699 31.713061
E	-27.832644 31.749823
F	-27.821694 31.738269
G	-27.833458 31.738326
H	-27.834029 31.673052



Scale: 1:50 000

LEGENDS

- Prospecting Area
- Farm Portions
- Roads
- Rail
- Perennial Water
- Perennial Rivers

APPLICATION FOR A PROSPECTING RIGHT APPLICATION ON PORTION 09 AND 13 OF THE FARM RESERVE NO.12 15832-HU IN THE MAGISTERIAL DISTRICT OF NONGOMA IN THE KWAZULU NATAL PROVINCE

I&APs REGISTRATION & COMMENT SHEET

Attention: **Livhuwani Sigwadi**

Email: livhuwani@geoaspex.co.za

Cell: **076 065 29062**

Name			Surname		
Company					
Position					
Address					
Tel No.			Fax No.		
E-mail			Cell No.		
Method preferred for further communication:			<input type="checkbox"/> Email	<input type="checkbox"/> Postal	or <input type="checkbox"/> Fax
Indicate your interest in the above-mentioned project					
Provide your comments here:					
Provide your questions here:					
Add any person you think may be interested and affected parties:					
Full names					
Address					
E-mail					
Contact No.					