

- IMPORTANT:**
- All architectural drawings to be read in conjunction with Engineers drawings.
 - Architectural drawings to take precedence over Consultants drawings during construction.
 - All boundaries, dimensions and levels are to be checked on site before construction and any discrepancies are to be reported to the Architect.
 - Partial Services: Any discrepancies with site or other information is to be advised to the Architect and direction or approval is to be sought before the implementation of the detail.
 - For the purpose of coordination, all relevant parties must check this information prior to implementation and report any discrepancies to the Architect.
 - Any discrepancies **MUST** be reported to the ARCHITECT immediately prior to any commencement of work. P.G.A. will not be responsible for work carried out without the ARCHITECT's consent as well as deviations from the approved plans.
 - Any plans removed from ARCHITECT'S office without his prior authorization will be deemed unchecked and thereafter invalid.
 - The attention of the Owner is drawn to the fact that changes to the plan and/or specifications after official approval are likely to invalidate that approval.
 - No construction is to be carried out on site prior to approval of submissions from relevant authorities.
 - Do not scale this drawing.
 - All Revisions made by engineer must be indicated in a revision cloud and the date the revision was made.

Revision:	Notes:	Date:



Project:
 PROPOSED NEW BUILDING TO CIVIL ENGINEERING DEPARTMENT
 SCHOOL OF CIVIL ENGINEERING
 UKZN - HOWARD COLLEGE
 276 KING GEORGE V AVENUE
 DURBAN 4041
 REM OF 1 OF SUB 5702 & REM OF SUB 5702,
 & REM OF 492
 CANOR MANOR

Client/Owner's Signature:
 For Stage 4.2 - Construction

Architect's Signature:

Contact No:

Drawing title: FIRST STOREY PLAN

Date: July 2015 **Checked:** YSE

Scale: 1:50 **DWG No:** 14080

Drawn: YSE **Sheet No:** 8 of 10



Reg. NO: 5278

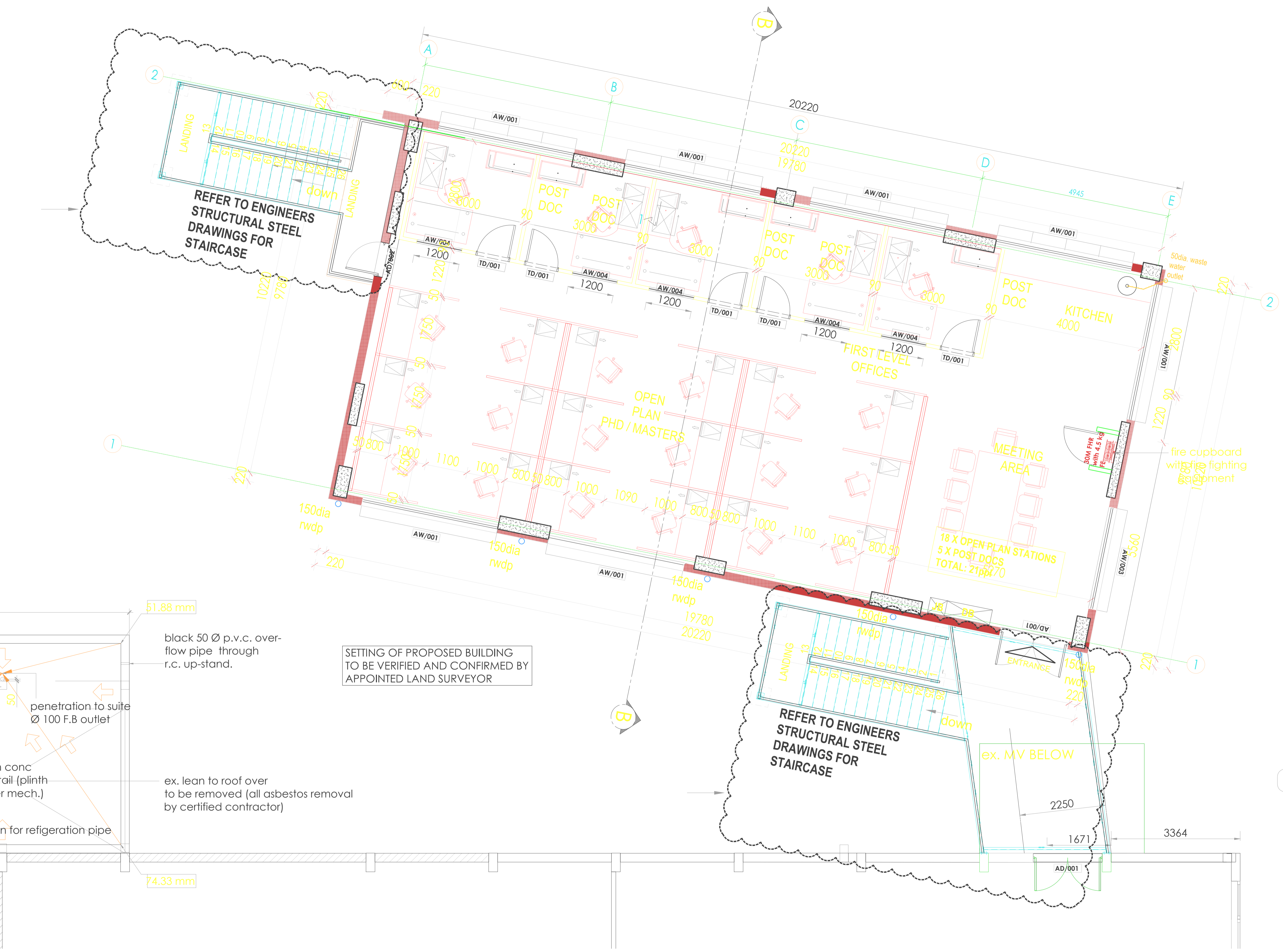

FIRST STOREY PLAN
 scale: 1:50