

- WATER RETICULATION KEY:**
- Isolation valves for toilets/urinals etc.
 - Cold water tap
 - Hot water tap
 - 32mm dia Cold water pipe (in wall or roofspace)
 - 32mm dia Hot water pipe (in wall or roofspace)
 - Main water feed from existing source (40mm dia HDPE Class 12 below ground) (40mm dia Copper Class 01 above ground)

Scale: 1:100
Restaurant - water reticulation plan

NOTE: CORRECT & ACCURATE POSITION OF THESE WATER RETICULATION ELEMENTS INSTALLATION TO BE CONFIRMED ON SITE.

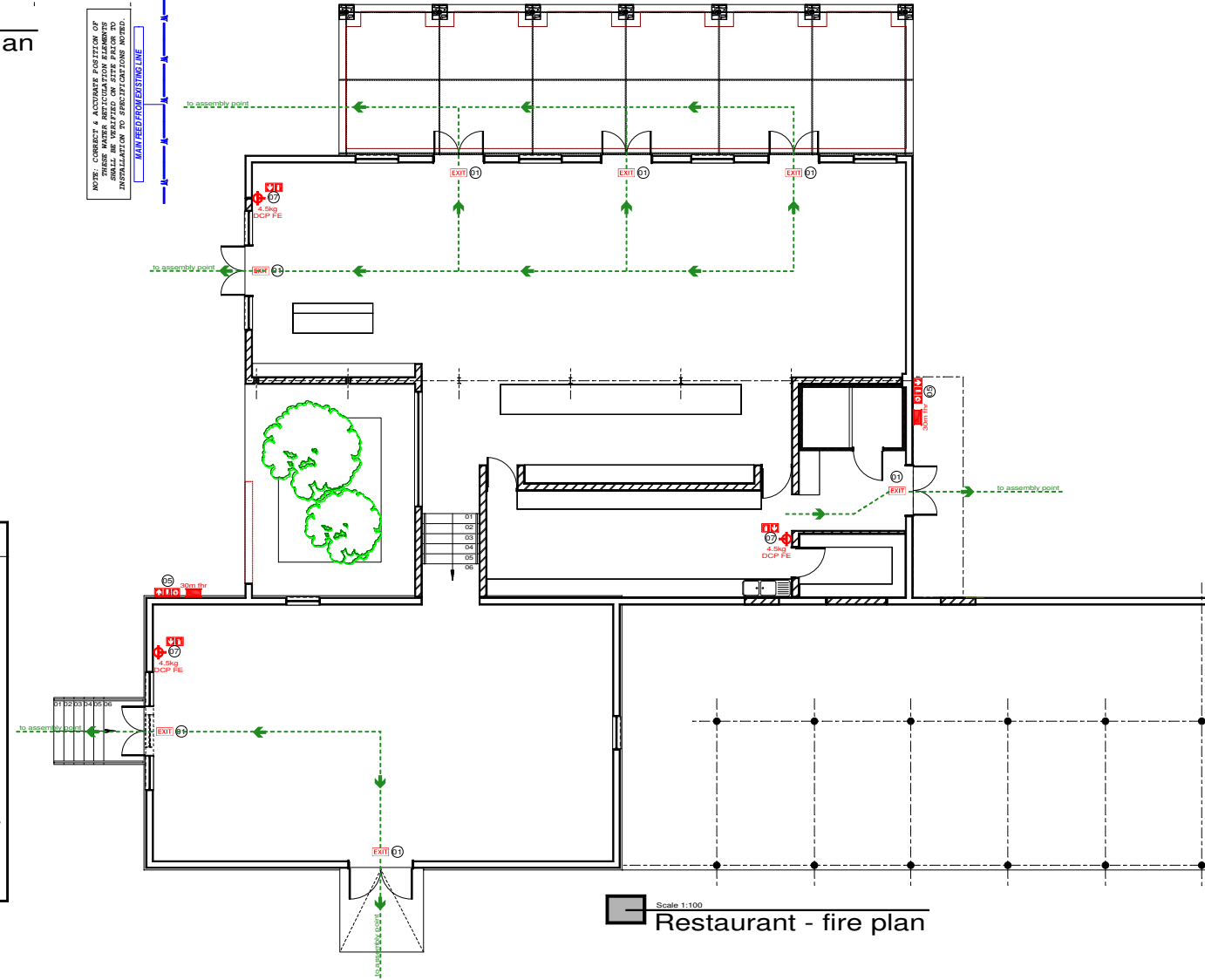

Scale: 1:100
Restaurant - fire plan

FIRE SIGNAGE SCHEDULE

01	300x150mm	Photoluminescent "EXIT" signage, size 300x150mm in SANS 1186 certified ABS plastic, with natural anodized aluminum frame, drilled, plugged and fixed with non-corrosive screws against wall surface above door-frame. Colour: White panel with red border-line, and red pictogram as per SANS.
02	300x150mm	Photoluminescent "ESCAPE ROUTE - LEFT" signage, size 300x150mm in SANS 1186 certified ABS plastic, with natural anodized aluminum frame, mounted (hanging) to underside of ceiling with non-corrosive screws or drilled, plugged and fixed with non-corrosive screws against wall surface above door-frame. Colour: Green with white border-line, and white pictograms as per SANS.
03	300x150mm	Photoluminescent "ESCAPE ROUTE - RIGHT" signage, size 300x150mm in SANS 1186 certified ABS plastic, with natural anodized aluminum frame, mounted (hanging) to underside of ceiling with non-corrosive screws or drilled, plugged and fixed with non-corrosive screws against wall surface above door-frame. Colour: Green with white border-line, and white pictograms as per SANS.
04	300x150mm	Photoluminescent "ESCAPE ROUTE - DOWN" signage, size 300x150mm in SANS 1186 certified ABS plastic, with natural anodized aluminum frame, mounted (hanging) to underside of ceiling with non-corrosive screws or drilled, plugged and fixed with non-corrosive screws against wall surface above door-frame. Colour: Green with white border-line, and white pictograms as per SANS.

FIRE SIGNAGE SCHEDULE (continued)

05	450x150mm	Photoluminescent double-sided "FIRE CABINET" signage, size 450x150mm in SANS 1186 certified ABS plastic, with natural anodized aluminum frame, mounted against wall with non-corrosive screws. Colour: White panel with red border-line, and red pictogram as per SANS.
06	450x150mm	Photoluminescent double-sided "FIRE CABINET" signage, size 450x150mm in SANS 1186 certified ABS plastic, with natural anodized aluminum frame, mounted against wall with non-corrosive screws. Colour: White panel with red border-line, and red pictogram as per SANS.
07	300x150mm	Photoluminescent "FIRE EXTINGUISHER" signage, size 300x150mm in SANS 1186 certified ABS plastic, with natural anodized aluminum frame, drilled, plugged and fixed with non-corrosive screws against wall surface above fire-extinguisher. Colour: White panel with red border-line, and red pictogram as per SANS.
08	300x300mm	Photoluminescent "FLAMMABLE LIQUIDS / NO SMOKING / NO FIRE" signage, size 300x300mm in SANS 1186 certified ABS plastic, with natural anodized aluminum frame, drilled, plugged and fixed with non-corrosive screws against wall surface AT 1.8m AFFL. Colour: White panel with red border-line, and red pictogram as per SANS.

COPYRIGHT RESERVED
 COPYRIGHT NOTICE
 COPYRIGHT © 2017 - Bakopane Architects cc
 Copyright subsists in this drawing. The person or entity whose name appears in the title block of this drawing, is hereby granted a non-exclusive licence to use, display, print and/or reproduce this drawing to the extent necessary to carry out and complete the project described in the title block of this drawing. This licence in respect of the copyright is expressly limited as aforesaid and the person and / or entity referred to above shall not be entitled to grant sub-licences in respect of the copyright in this drawing to any other entity. This licence confers no ownership rights in the copyright vesting in the drawing and this drawing and the copyright subsisting therein will, at all times, remain the property of Bakopane Architects cc. Any unauthorised reproduction, publication, transmission, adaptation and/or inclusion of this drawing in a cinematograph film or television broadcast is an act of copyright infringement which will render the doer of the act liable for civil law copyright infringement and may in certain circumstances render the doer liable to criminal prosecution. Requests and enquiries concerning this drawing and the rights subsisting therein should be addressed to the copyright owner.

No.	Date	Notes	Drawn
Rev 00	28/06/17	working drawing started	cw

- GENERAL NOTES:**
1. Check all measurements, levels and details on site before commencement with work.
 2. Refer any discrepancies to architect.
 3. All work to be done in accordance with SANS-10400.
 4. Nothing to be scaled from drawing; request measurement from architect.
 5. Architect's & engineer's drawings to be read together.
 6. Drawing to be used for intention as mentioned in Drawing description.



CLIENTS SIGNATURE:



DEPARTMENT'S SIGNATURE:



PRINCIPAL AGENT SIGNATURE:

bakopane architects

Practise Building
 23 Corridor Crescent,
 Rouse Hill Business Park,
 Ben Hur Ed 11
 Post: P.O. Box 543, Emalileni, 1035
 Tel: 012 653 6251 / 653 6255
 Fax: 086 567 5564
 Email: bakopane@gmail.com

ARCHITECTS SIGNATURE:

TITLE:
PROPOSED ALTERATIONS & ADDITIONS TO TAUNG SKULL HERITAGE SITE FOR NORTH-WEST RURAL, ENVIRONMENTAL & AGRICULTURE DEPARTMENT PROVINCE OF NORTH-WEST

DRAWING DESCRIPTION: restaurant: water reticulation plan, fire plan	ORIGINAL	A1
	DRG. SIZE	
	SCALE: 1/100	
REV.	0	