



AREA: BELLEVUE	PROJECT NUMBER: Mm0275306283
FEEDER: BELLEVUE	ITEM OF: 1 OF 5
SUPPLY TO: (M)PHO NUKU	
ESKOM REPRESENTATIVE: S O SONO	CELL: +27 76 976 4583
*DISTRIBUTION/*TRANSMISSION	EMAIL: SonoSO@eskom.co.za

**WAYLEAVE CONTRACT  
POWERLINE AND/OR CABLE AND ASSOCIATED INFRASTRUCTURE**

**1. GENERAL**

**1.1 Identification of parties:**

1.1.1 Contractor means any entity appointed as an independent contractor to execute works on the Property in the exercise of the Rights.

1.1.2 Eskom means Eskom Holdings SOC Ltd, a public company with registration number 2002/015527/30 with its head office at Megawatt Park, 2 Maxwell Drive, Sunninghill, Sandton.

1.1.3 Lessee means the holder of a lease registered against the title deed of the Property and is .....  
 , a company / close corporation / trust / partnership / natural person / Government department / tribal authority of .....  
 , herein represented by .....  
 who through signature here below, warrants his or her authority to sign on behalf of the Lessee.

1.1.4 Owner means René Eloff. 3902 0012 081 a company / close corporation / trust / partnership / natural person / Government department / tribal authority of .....  
Plot 23 Bellevue W/R  
 , herein represented by R. Eloff  
 , who through signature here below, warrants his or her authority to sign on behalf of the Owner.

1.1.5 Property means: BELLEVUE 104-29 JU  
 .....  
 .....  
 held by virtue of Title Deed/s number/s..... extent .....

*R Eloff*

1.1.6 Usufructuary means ..... ,  
 a company / close corporation / trust / partnership / natural person /  
 Government department / tribal authority of  
 .....  
 , herein represented by .....  
 , who through signature here below, warrants his or her authority to sign on  
 behalf of the Usufructuary.

**2. THE RIGHTS**

2.1  

The Owner grants, generally, an irrevocable right (herein the "Rights"), in perpetuity and free of charge, to Eskom and over the Property, for the distribution and transmission of electricity and related purposes, substantially along the route indicated by letters A,B,C,D,E,F... on the attached sketch plan, comprising an area 9 meters on either side of the centre line of the Goods, once they are built (the "Wayleave Area"), and the Rights include those set out in paragraph 2 hereof.

2.2 To the extent necessary to give effect hereto, the Owner's spouse, Lessee and/or Usufructuary agrees to the granting of the Rights by signing below.

2.3 The Rights, specifically, include the rights to:

- 2.3.1 convey electricity and telecommunication across the Property;
- 2.3.2 erect structures, conductors, cables, appliances and, without limitation, everything else as may be necessary or convenient in exercising the Rights (herein referred to as the "Goods") and the Owner agrees that structure-supporting mechanisms may reasonably extend beyond the Wayleave Area where it is necessary to safely secure the Goods;
- 2.3.3 enter and be upon the Property at any time in order to construct, erect, operate, use, maintain, repair, re-erect, alter or inspect the Goods or in order to gain access to any adjacent property in the exercise of rights similar to the Rights;
- 2.3.4 have these Goods remain on the Property for so long as either Eskom or the Owner requires them to;
- 2.3.5 extend the Goods to other customers, suppliers or contracting parties of Eskom, over the Property;
- 2.3.6 use existing roads and gates giving access to and running across the Property and to erect in any fence such gates as may be necessary or convenient to gain access to or exit from the Property and the Goods or in order to gain access to any adjacent property in the exercise of rights similar to the Rights;
- 2.3.7 remove any material or structures, and cut or trim any tree, bush or grass within the Wayleave Area or to the extent necessary where the Goods extends beyond the Wayleave Area, in order to comply with the restrictions referred to in paragraph 3.2 hereof;
- 2.3.8 every ancillary right necessary or convenient for the proper exercise of the Rights granted to Eskom; and



- 2.3.9 At Eskom's election, have this wayleave registered as a servitude against the title deed of the Property.
- 2.4 The Rights will apply to all electricity infrastructure on the Property and the area which such infrastructure covers will be deemed to be included in the Wayleave Area and/or Restricted Area. It is agreed that the Owner herewith grants permission for all electricity infrastructure on the Property to remain on the Property.
- 2.5 Any expenses to be incurred, which are necessitated by a change to or removal of the Goods in the Wayleave Area required by the Owner, are for the Owner's account and must be paid for by the Owner in advance. Eskom will effect such changes or removals after receipt of such payment, if such changes or removal are technically possible.
- 2.6 The Contractor may exercise any of the Rights.
- 2.7 Eskom may:
- 2.7.1 let any portion of the Goods to any third party on such conditions as Eskom may deem fit;
- 2.7.2 cede all or any of the Rights granted in terms of this Wayleave to any third party.

### 3. THE OBLIGATIONS

- 3.1 Eskom must:
- 3.1.1 ensure that any of Eskom's gates that it had used is closed after use;
- 3.1.2 pay reasonable compensation for intentional damage or damage caused through a negligent act or omission, caused by Eskom, its employees or agents in pursuit of the Rights, save where Eskom is acting in accordance with sub-clause 2.3.7 of this document; and
- 3.1.3 where a Contractor exercises the Rights, ensure that the Contractor complies with the obligations contained in this sub-clause 3.1.1.
- 3.2 The Owner must ensure that no:
- 3.2.1 building or structure is erected or installed above or below the surface of the ground within the Wayleave Area and no tree or bush is planted within the Wayleave Area or within 9 metres from any structure-supporting mechanism (the "Restricted Area");
- 3.2.2 tree, which could grow to a height in excess of the horizontal distance of that tree from the nearest conductor of any power line is planted or allowed to continue growing, regardless if it is outside of the Wayleave or Restricted Area;
- 3.2.3 material which may in the opinion of Eskom endanger any electricity infrastructure is placed within the Wayleave or Restricted Area.

R.E.

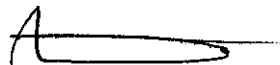

R.E.  

3.3 The Owner must bring the existence of this wayleave contract to the attention of any purchaser or other transferee of the Property (or of any portion of the Property) before the Property (or any portion thereof) is sold and/or transferred to such purchaser or transferee, or if the Owner grants any further rights in or to the Property to any other third party, to such third Party.

3.4 The Owner must inform Eskom in writing if it is going to sell the Property.

3.5 The Owner's attention is drawn to the provisions of section 10.17.1 of the regulations promulgated in terms of the Explosives Act 26 of 1956, which prescribes that when blasting is to be done within 500 (five hundred) metres of any electricity infrastructure, written confirmation must first be obtained from Eskom concerning the protection of electricity infrastructure.

Signed at R. F. J. O. H. on 2. 4. 19.

R. F. J. O. H.  
The Owner

Witnesses:

1. \_\_\_\_\_

2. \_\_\_\_\_

Signed at \_\_\_\_\_ on \_\_\_\_\_.

\_\_\_\_\_  
Spouse of the Owner if married in community of property

Witnesses:

1. \_\_\_\_\_

2. \_\_\_\_\_

Signed at \_\_\_\_\_ on \_\_\_\_\_.

\_\_\_\_\_  
The Usufructary

Witnesses:

1. \_\_\_\_\_

2. \_\_\_\_\_

Signed at \_\_\_\_\_ on \_\_\_\_\_.

\_\_\_\_\_  
The Lessee

Witnesses:

1. \_\_\_\_\_

2. \_\_\_\_\_

Signed at \_\_\_\_\_ on \_\_\_\_\_.

\_\_\_\_\_  
Eskom Holdings SOC Limited

Witnesses:

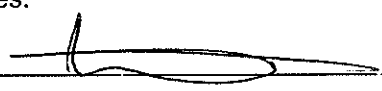
1.  \_\_\_\_\_

2. \_\_\_\_\_



**Annex B - Distribution Environmental Screening Document (DESD)**  
(Informative)

**Reticulation Powerlines and Ancillary Services**

Ratified and accepted by  
Environmental Practitioner

Environmental Specialist  
Head of Engineering Survey

(one signature please)

Accepted by Land Owner/s/Users

I have seen the completed document and accept the  
recommendations made

Form completed by S.O Sono

in consultation with: NUKU

CAPACITY (e.g. land owner, specialist):

DATE COMPLETED: 22 March 2019

S. S. MOTLALERGOSI  
Analysis 10/07/19

R. Eloff

R. Eloff

**Assessor/s**

Signature: R. Eloff

Signature: R. Eloff

R. Eloff

← Initials & Surname

← Signature

← Signature

← Fill in

**Instructions**

1. Fill the report in as neatly and completely as possible.
2. Where the question / statement is not applicable mark N/A.
3. Indicate sensitive areas on a map and/or spanning plans.
4. When in doubt, consult the Environmental Practitioner in your region.

The purpose of this *DESD* is to:

- Determine whether or not the project should be subject to R543-7, published in terms of the National Environmental management Act 107 of 1998.
- Identify and mitigate the negative impact of Eskom's activities to a minimum in line with both Legislation and Eskom's Environmental Policies.
- This report is a guide to Route Selection, Construction and Field Services.

**NOTE Complete the report before the survey!!!**

**This is not an office exercise.**

**Extra sheets of paper may be added and referenced if insufficient space has been provided.**

**ESKOM COPYRIGHT PROTECTED**

When downloaded from the WEB, this document is uncontrolled and the responsibility rests with the user  
to ensure it is in line with the authorized version on the WEB

**Annex B**  
(continued)

**1 Project description**

Project name/Survey  
Request ..... MPHO NUKU ..... Area BELLEVUE .....  
Project number MNM275306283 ..... File number .....  
Rural scheme/  
Feeder BELLEVUE ..... Voltage 11.kV .....  
Supply from EXTRA POLE NEAR POLE NUMBER PBE137A/1 .....  
(scheme name, pole numbers for tee-off)  
Supply to BELLEVUE 104-53 JU .....  
(Farm name, etc.)

**2 Properties traversed**

Farm name .....  
Registration number and Division ..... Sub-division .....  
Compilation number ..... Line length (m) .....  
Farm name .....  
Registration number and Division ..... Sub-division .....  
Compilation number ..... Line length/Site area (m<sup>2</sup>) .....

**3 Brief description of the surrounding area**

.PORTION 52 OF THE FARM BELLEVUE.....  
.....  
.....  
.....  
.....  
.....

Could the proposed project have an impact on or be constrained by any of the following environmental aspects?

Encircle the appropriate aspect, giving a description of the present state as well as an indication of the possible negative impact. **Note that mitigating measures for these impacts are to be included in the Environmental Management Programme.**

**ESKOM COPYRIGHT PROTECTED**

When downloaded from the WEB, this document is uncontrolled and the responsibility rests with the user to ensure it is in line with the authorized version on the WEB.



**Annex B**  
(continued)

**4 Physical environment**

4.1 Water: streams rivers dams wetlands springs floodplains OTHER N/A ..

Present condition: LAND COVERED WITH VEGETATION AND GRASS .....

Potential impact (e.g. threat of pollution): LOW (POLLUTION) .....

.....  
.....  
.....

4.2 Soil: sandy rocky clayey OTHER .....

Present condition: SOIL IS SANDY AND MIGHT HAVE BIG ROCKS UNDERNEATH .....

Potential impact (e.g. of erosion) .....

4.3 Topography mountains ridges hills valleys ravines dongas OTHER .....

Present condition: RIDGES .....

Potential impact (e.g. of erosion) LOW (POLLUTION) .....

Comments/mitigating measures:  
.....  
.....  
.....  
.....  
.....  
.....  
.....  
.....

**Annex B**  
(continued)

**5 Natural environment**

5.1 Flora: indigenous protected exotic OTHER .....

Brief description and conservation status (e.g. rare, etc., mention trees/bush/grass) .....

Potential impact (e.g. permit applications) TREE PERMIT MIGHT BE REQUIRED .....

5.2 Fauna: mammals birds OTHER .....

Brief description and conservation status:

(e.g. rare, protected, etc., mention giraffe, elephants, eagles, vultures, etc., mention migratory paths)

BIRDS MIGHT BE IN THE AREA .....

Potential impact (e.g. threat of electrocution, collision, etc.) MEDIUM (COLLISION) .....

Comments/mitigating

measures:

Tree permit not required. Should the protected tree be retained during construction/bush clearing, stop the project and notify environmental section.

**6 Social environment**

6.1 Restricted areas: nature/game reserves hiking trails tourism routes parks recreational areas

Residential areas green belts sacred/holy grounds OTHER .....

Brief description RESIDENTIAL PLOTS AND A GEUST HOUSE .....

**Annex B**

(continued)

Potential impact e.g. threat of encroachment, etc. **NONE**.....

**6.2 Visual aesthetics:** easily seen hidden partially **HIDDEN**.....

Brief description **..ON..THE..KABOKWENI..ROAD**.....

Potential impact **..NONE**.....

<b>6.3 Natural heritage:</b>	cultural	archaeological	monuments	palaeontological
	significance	objects		objects
	graves	meteorites	ruins	<b>OTHER..N/A</b> .....

**Note:** Should any natural heritage resource as listed above, or as defined in the National Heritage Resource Act, No 25 of 1999 be identified, the requirements of Act 25 of 1999 shall be followed by notifying the SAHRA. **If line or access road length exceeds 300m SAHRA shall be notified.**

Potential impact **..NONE**.....

Comments/mitigating measures

**7 Economic environment**

<b>7.1 Land use:</b>	crops	orchards	grazing	crop spraying
	game farming	forestry areas	mining	<b>OTHER..N/A</b> .....

Brief description **..NO ACTIVITY ON LAND**.....

**Annex B**  
(continued)

Potential impact NONE.....

**7.1.1 Commercial:** factories shops OTHER N/A.....

Brief description .....

Potential impact NONE.....

**7.1.2 Infrastructure:** roads railways communications power lines air fields  
pipelines sewage OTHER .....

Brief description: PROPOSED ROUTE RUNS ALONG THE FARM ACCESS ROAD.....

Potential impact NONE.....

**Comments/mitigating measures:**

.....  
.....  
.....  
.....

**ESKOM COPYRIGHT PROTECTED**

When downloaded from the WEB, this document is uncontrolled and the responsibility rests with the user  
to ensure it is in line with the authorized version on the WEB

**Annex C - Environmental Management Plan**  
(Normative)

**1 General conditions**

- 1.1 The Eskom project manager or co-ordinator shall be responsible for ensuring that the land owners have been informed before any work is carried out on site. Contractors shall find out if the landowners have been informed before moving onto site.
- 1.2 No fences, gates or locks shall be damaged to obtain access onto a line route. Arrangements shall be made in advance to obtain permission for access.
- 1.3 Use of private roads shall be arranged in advance. Any damage to private roads shall be repaired at the contractor's expense and to the satisfaction of the landowner. This shall be the responsibility of the project manager or co-ordinator.
- 1.4 Gates shall be left as they are found, i.e. closed gates shall be kept closed and open gates shall be left open. Gates to adjacent properties or onto public roads shall be closed at all times. Any Eskom gates installed on the line route shall be kept closed and locked except while stringing is taking place. Open gates shall be guarded to prevent animals straying and unauthorised persons and vehicles entering into adjacent camps or properties.
- 1.5 Permission shall be obtained from landowners before any water is used.
- 1.6 No fires shall be lit on private property. If fires are lit on Eskom's property or in the construction camp, provision shall be made that no accidental fires are started. No firewood shall be collected in the veld.
- 1.7 If activities that can cause a fire are carried out, fire extinguishers shall be available on site and in the construction camp.
- 1.8 No property may be accessed after normal working hours except with the permission of the landowner. Privacy shall be respected at all times.
- 1.9 Eskom, Eskom's contractors and their employees shall at all times be courteous towards landowners, tenants and the local community.
- 1.10 Eskom, Eskom's contractors and their employees shall not cause damage to property, crops or animals. Activities that may cause conflict with landowners, tenants, the local work force or the local community shall be avoided. Should conflict arise it shall be immediately reported to the Eskom project manager or co-ordinator.
- 1.11 Vehicles shall be driven at a moderate speed on private roads and stay within the statutory speed limit on public roads.
- 1.12 All movement of vehicles shall take place on the established Eskom servitude road or on private roads as agreed in advance. Keep to existing tracks. No movement shall take place through the veld. Special care shall be taken to prevent excess damage during wet weather.

**ESKOM COPYRIGHT PROTECTED**

When downloaded from the WEB, this document is uncontrolled and the responsibility rests with the user to ensure it is in line with the authorized version on the WEB.

**Annex B**

(continued)

What impact will this project have on elements 4 to 7?

1. Physical

No impact (0)

Medium impact (2)

High impact (4)

2. Natural

No impact (0)

Medium impact (2)

High impact (4)

3. Social

No impact (0)

Medium impact (2)

High impact (4)

Overall impact:

This section addresses the overall environmental impact of the project. The impacts as assessed in the above three spheres (physical, natural and social) need to be considered to determine the overall impact

0                                  2                                  4  
No impact                          Medium impact                          High impact

If the overall impact is between 2 and 4, contact the Environmental Management Officer or the Environmental Senior Superintendent.

**Alternatives**

Have alternative routes been discussed with the relevant land owner/s or users?

Yes  \_\_\_\_\_  
No  \_\_\_\_\_

**Detailed study**

Is an *environmental assessment* required in terms of Regulation R543?

Yes \_\_\_\_\_  
No  \_\_\_\_\_

Should a permit application be made to DWA?

Yes \_\_\_\_\_  
No \_\_\_\_\_

Should the SAHRA be notified?

Yes  \_\_\_\_\_  
No  \_\_\_\_\_

*SAHRA should be notified  
length of the line 321m*

**ESKOM COPYRIGHT PROTECTED**

**Annex C**

(continued)

- 1.13** If any vehicle should get stuck, the damage shall be repaired immediately so that no deep ruts remain.
- 1.14** Any damage to private property shall immediately be reported to Eskom and the owner. The damage shall be rectified immediately if possible and/or appropriate compensation shall be paid to the owner at the discretion of the project manager/co-ordinator in consultation with the property owner. A record of damages and rectifying action shall be kept. The landowner's satisfaction with the outcome of rectifying action shall be obtained in writing.
- 1.15** A proper system of waste management shall be instituted in the construction camp. This entails that sufficient waste bins are available on site and in the construction camp. The waste shall be dumped at an approved waste disposal site. No containers, scrap metal, conductor etc. shall be left on site.
- All scrap shall be removed and taken to an appropriate disposal site. No oil, diesel or other chemicals shall be spilled or discarded anywhere. If an accidental spill occurs, it shall be reported immediately and cleaned to the satisfaction of Eskom and the landowner. No waste shall be left in the veld or on the line route.
- 1.16** Washing and toilet facilities shall be provided on site and in the construction camp. The facilities shall comply with Eskom standards and shall have the approval of the landowner.
- 1.17** No human excrement shall be left in the veld. If no toilet facilities are available such waste shall be buried *immediately*.
- 1.18** Herbicides shall only be applied with Eskom's permission and in accordance with the Eskom Policy on Herbicides ESKPBAAD4.
- 1.19** Camp and office sites shall be dismantled and removed after completion of the construction phase of the project. The site shall be rehabilitated to as close as possible to its original condition to the satisfaction of the landowner, which shall be in writing.
- 1.20** All excavations shall be enclosed to prevent animals or people from accidentally falling into excavations.
- 1.21** No trees shall be cut or removed without prior permission from the landowner. Permits shall be obtained for the cutting and removal protected trees (protected trees shall be dealt with in 2, **Special conditions**).
- 1.22** Should any natural heritage object be found, or exposed during excavations, all work shall be terminated immediately and the finding reported to the Project Manager who shall inform the Eskom Environmental Practitioner and the SAHRA.

**ESKOM COPYRIGHT PROTECTED**

**Annex C**

(continued)

**2 Special conditions**

(Specific issues identified during the scoping as needing attention i.e. erosion berms, bird flappers, protected trees. etc.).

.....  
 .....  
 .....

**TYPICAL MITIGATION MEASURES**

<b>ENVIRONMENTAL CONCERNS</b>	<b>MITIGATION MEASURES</b>
<b>AGRICULTURE</b>	
Loss of standing crop due to access road and tower work site.	<ul style="list-style-type: none"> <li>- limit width of access and size of tower site.</li> <li>- avoidance of crop areas.</li> <li>- monetary compensation for crop loss.</li> <li>- time construction to avoid growing season.</li> </ul>
Soil Compaction	<ul style="list-style-type: none"> <li>- scheduling activities to times of the year when soils are least susceptible to compaction.</li> <li>- stop activities when ground conditions are poor.</li> <li>- use of equipment with low bearing capacity.</li> <li>- chisel ploughing.</li> </ul>
Construction of new lines	<ul style="list-style-type: none"> <li>- locate access roads along existing traffic routes.</li> </ul>
Topsoil – subsoil mixing/soil rutting	<ul style="list-style-type: none"> <li>- scheduling activities.</li> <li>- stop activity when ground conditions are poor.</li> <li>- use of equipment with low bearing capacity.</li> <li>- use of gravel roads.</li> <li>- addition of manures to offset fertility loss.</li> <li>- compensation for reduced soil pEAuctivity.</li> <li>- removal of spoil and/or bentonite from foundation operations.</li> <li>- Segregation of topsoil and subsoil.</li> </ul>
Disturbance to farm operations	<ul style="list-style-type: none"> <li>- maintain contact with landowner/tenant regarding preferences.</li> </ul>
Loss of livestock	<ul style="list-style-type: none"> <li>- employ noise control measures near sensitive livestock.</li> <li>- Construction of farm gates.</li> <li>- Securing farm gates.</li> <li>- Clean-up construction materials which could be ingested.</li> <li>- Compensation for lost, injured livestock.</li> </ul>
<b>SOCIAL IMPACTS</b>	
Mud and Dust	<ul style="list-style-type: none"> <li>- wetting down dry soils.</li> <li>- chemical control of dust.</li> <li>- cleaning roads to remove mud..</li> <li>- temporary planting of grasses.</li> </ul>

**ESKOM COPYRIGHT PROTECTED**

When downloaded from the WEB, this document is uncontrolled and the responsibility rests with the user to ensure it is in line with the authorized version on the WEB.



**Annex C**

(continued)

Aesthetics	<ul style="list-style-type: none"> <li>- screen with natural or planted vegetation restoration.</li> <li>- avoid linear access down the right-of-way.</li> <li>- addition of topsoil to gravel access roads.</li> <li>- hoarding construction sites.</li> <li>- installation of landscaping in advance of site completion.</li> </ul>
Inconvenience	<ul style="list-style-type: none"> <li>- select route and method of installation to suit landowners' conditions.</li> <li>- select timing of activity.</li> </ul>
Heritage resources	<ul style="list-style-type: none"> <li>- avoidance/isolation.</li> <li>- design measures to make facility less obtrusive.</li> <li>- screening.</li> <li>- alternate methods of equipment.</li> <li>- protection by use of enclosures, barrier fencing, covering.</li> <li>- salvage in conjunction with SAHRA.</li> <li>- relocation in conjunction with SAHRA.</li> </ul>
Tourism and recreation resources	<ul style="list-style-type: none"> <li>- design measures to make facility less obtrusive or disruptive.</li> <li>- screening and restoration.</li> <li>- minimise noise and dust.</li> <li>- safety precautions to protect the public.</li> <li>- scheduling to avoid peak use periods.</li> </ul>
<b>WATER QUALITY</b>	
Sedimentation of streams due to erosion from the right-of way.	<ul style="list-style-type: none"> <li>- minimise use of slopes adjacent to streams during soils testing, construction and maintenance.</li> <li>- maintain a cover crop.</li> <li>- retain buffers.</li> </ul>
Stream bank erosion.	<ul style="list-style-type: none"> <li>- mechanical erosion control.</li> <li>- retain shrubby stream bank vegetation and selectively cut or prune trees during line clearing/maintenance.</li> <li>- selective spraying of herbicides.</li> <li>- Mechanical erosion control.</li> </ul>
Impedance of natural flow streams/others surface waters.	<ul style="list-style-type: none"> <li>- use and maintenance of appropriate stream crossing device.</li> </ul>
Ponding or channelization of surface waters due to rutting.	<ul style="list-style-type: none"> <li>- timing activities to stable ground conditions.</li> <li>- use of gravel roads.</li> </ul>
Contamination of surface or ground waters through spills or leaks of toxic substances.	<ul style="list-style-type: none"> <li>- spill control material and procedures readily available.</li> <li>- site selection where possible.</li> </ul>
Soil compaction/topsoil-subsoil mixing.	<ul style="list-style-type: none"> <li>- avoidance of rutting by vehicles where possible.</li> <li>- construction timing.</li> <li>- use of gravel roads.</li> <li>- use of vehicles with low bearing pressures.</li> <li>- stop activities when ground conditions are poor.</li> </ul>
Wind/water erosion.	<ul style="list-style-type: none"> <li>- avoidance of areas with high erosion potential.</li> <li>- timing activities to the most stable ground conditions.</li> <li>- slope stabilisation.</li> <li>- mechanical erosion control.</li> <li>- vegetation erosion control.</li> <li>- recompaction of trenches.</li> <li>- avoid trenching parallel to the fall of a slope.</li> </ul>

**ESKOM COPYRIGHT PROTECTED**

When downloaded from the WEB, this document is uncontrolled and the responsibility rests with the user to ensure it is in line with the authorized version on the WEB.

**Annex C**

(continued)

Contamination by petrochemicals.	<ul style="list-style-type: none"> <li>- spill control material and procedures made readily available.</li> <li>- restoration methods investigated.</li> </ul>
<b>FAUNA &amp; FLORA</b>	
Loss of habitat, breeding and/or food source for terrestrial wildlife.	<ul style="list-style-type: none"> <li>- environmental mapping to identify sensitive areas.</li> <li>- avoidance of areas containing rare/endangered species.</li> <li>- construction and maintenance activities to be timed where possible to avoid peak breeding periods.</li> <li>- the creation of "edge" (may be considered a positive impact.)</li> <li>- promotion of wildlife habitat through vegetation control.</li> <li>- avoid the filling of small wetlands.</li> <li>- use design with low risk to wildlife electrocution or collision</li> <li>- fit bird flight divertors to powerlines in bird migration areas.</li> </ul>
Changes in composition of vegetation as a result of disturbance.	<ul style="list-style-type: none"> <li>- construction timing to minimise soil disturbance.</li> <li>- restoration of soils to a stable condition.</li> </ul>
Removal or burial of stream bottom habitat and increased turbidity due to sedimentation.	<ul style="list-style-type: none"> <li>- minimise erosion from the right-of-way by maintaining a cover crop.</li> <li>- mechanical erosion control.</li> <li>- minimise stream bank erosion by retaining shrubby bank vegetation and selective cutting, pruning of trees near watercourses.</li> <li>- installation of sediment traps when necessary.</li> </ul>
Possible loss of wildlife/fish migration/travel routes.	<ul style="list-style-type: none"> <li>- avoid filling small wetlands servings as staging areas for waterfowl migration.</li> <li>- Installation and maintenance of a proper stream crossing device.</li> <li>- time construction activities to avoid disturbance to migrating fish and wildlife or during breeding.</li> <li>- Follow Eskom standards for the application of herbicides near watercourses.</li> <li>- Preserve and/or augment existing natural corridor crossings; investigate tower placement to optimise clearances to preserve existing vegetation.</li> </ul>
IntEAuction of exotic plant species resulting from vegetative erosion control.	<ul style="list-style-type: none"> <li>- use of native species for erosion control.</li> </ul>
Vegetation stress due to nutrient loss as a result of soil deterioration.	<ul style="list-style-type: none"> <li>- erosion control measures.</li> </ul>
Changes in vegetation due to soil disturbance (topsoil-subsoil mixing).	<ul style="list-style-type: none"> <li>- time construction/clearing to take advantage of stable soil conditions.</li> </ul>

**ESKOM COPYRIGHT PROTECTED**

When downloaded from the WEB, this document is uncontrolled and the responsibility rests with the user to ensure it is in line with the authorized version on the WEB.

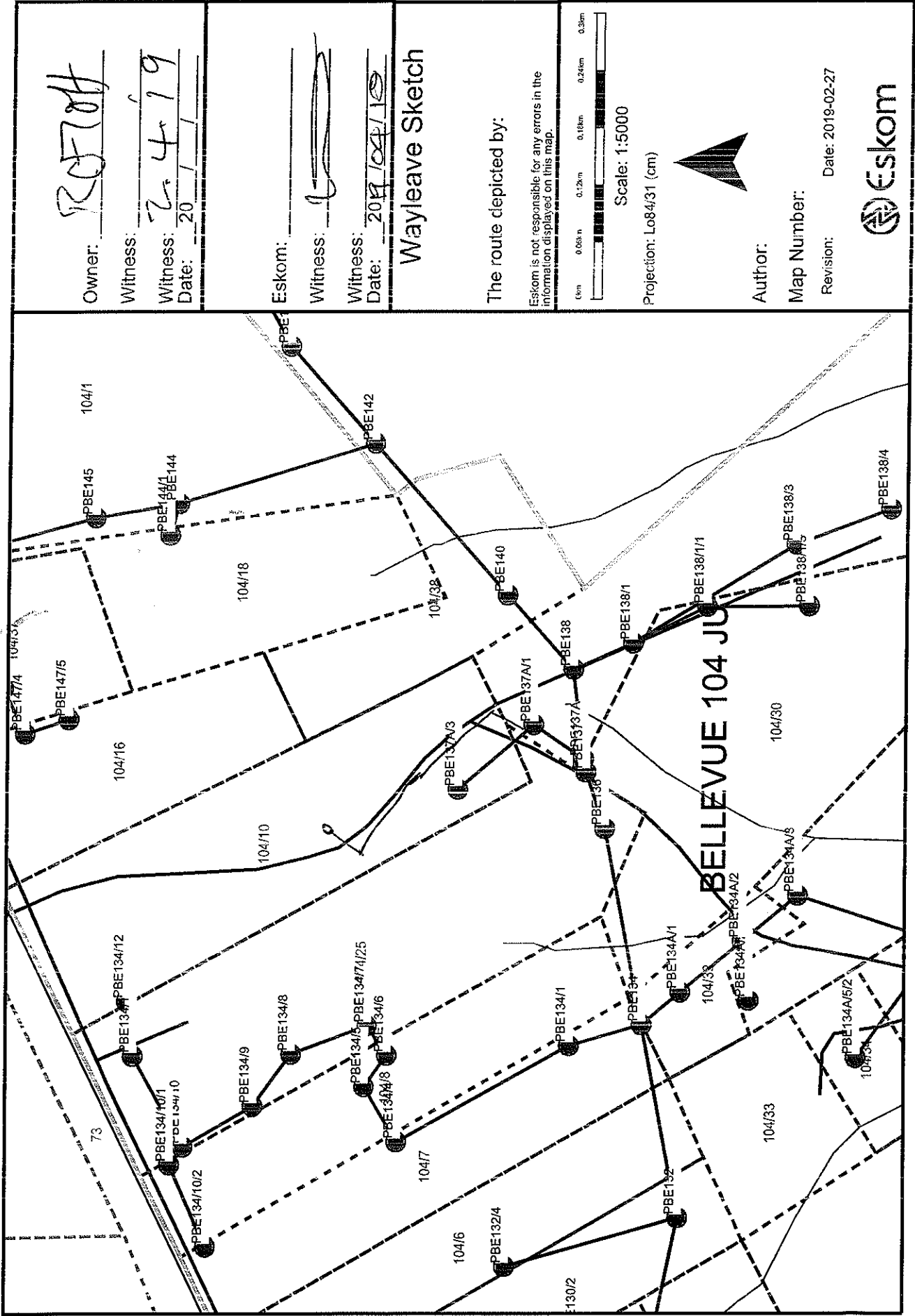

Owner: ROF 704  
 Witness: \_\_\_\_\_  
 Witness: 2.4.19  
 Date: 20 / /

Eskom: \_\_\_\_\_  
 Witness: \_\_\_\_\_  
 Witness: \_\_\_\_\_  
 Date: 2019/04/19

### Wayleave Sketch

The route depicted by:

Eskom is not responsible for any errors in the information displayed on this map.

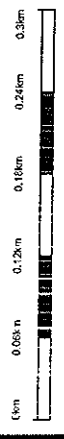

Scale: 1:5000

Projection: Lo84/31 (cm)

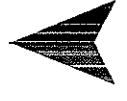

Author: \_\_\_\_\_  
 Map Number: \_\_\_\_\_  
 Revision: \_\_\_\_\_  
 Date: 2019-02-27



