



BACKGROUND INFORMATION DOCUMENT (BID)

For prospecting right for coal on Portion of portion
02 of the Zonderfout 226 IR, situated under Delmas
Magisterial District, Mpumalanga Province
DMRE REF.: MP 305/1/1/2/17328 PR

PREPARED FOR



Mancamane Trading Enterprise

REG NO: 2012/ 215911/ 07

24 Maritz Avenue ,Delmas 2210

Cell.: 083 449 2823

Email:daisy@mancamane.co.za

PREPARED BY



Singo Consulting (Pty) Ltd

Office 870, 5 Balalaika Street Tasbet Park Ext 2,
Witbank, 1040

Tel: 013 692 0041

Cell: 072 924 0633

Fax: 086 514 4103

E-mail: kenneth@singoconsulting.co.za

Purpose

The purpose of this Background Information Document (BID) is to consult with lawful landowner(s), stakeholders and all Interested and Affected Parties (I&APs) of the proposed prospecting project and to provide them with the opportunity to receive information, provide comments, and to raise any concerns related to the prospecting right application process.

Introduction

Mancamane Trading Enterprise (Pty) Ltd has applied for a Prospecting Right with associated Environmental Authorisation in order to prospect Coal. The application was lodged with the Mpumalanga Province Department of Mineral Resources and Energy accepted on the 08th of August 2022. In order to undertake prospecting activities, Mancamane Trading Enterprise (Pty) Ltd requires a granted Prospecting Right (PR) in terms of the Mineral and Petroleum Resources Development Act (MPRDA, Act No.28 of 2002). Other regulatory guidelines to be followed include: National Water Act, 1998 (Act 36 of 1998), National Air Quality Standards (GN 1210: 2009) and National Dust Control Regulations (GN 827: 2013). Mancamane Trading Enterprise (Pty) Ltd is also required to obtain an Environmental Authorisation (EA) in terms of the National Environmental Management Act (NEMA, Act No. 107 of 1998) which requires the submission of an Environmental Management Programme Report. Singo Consulting (Pty) Ltd has been appointed by Mancamane Trading Enterprise (Pty) Ltd to be the Environmental Assessment Practitioner (EAP) to assist in complying with these requirements.

Table 1: Environmental Technician Details

ENVIRONMENTAL ASSESSMENT PRACTITIONER	SINGO CONSULTING (PTY) LTD
Contact Person(s)	: Tshepo Mkhabela
Cell No.	: 072 924 0633
Tel. No.	: 013 692 0041
Fax No.	: 086 5144 103
Email(s)	: tshepo@singoconsulting.co.za
Physical Address	: Office No 870, 5 Balalaika Street, Tasbet Park Ext 2, Witbank, 1040
Postal Address	: Private Bag X 7297, Postnet Suite 87, Highveld Mall, Witbank, 1035

Table 2: Project Applicant Details

NAME OF APPLICANT	MANCAMANE TRADING ENTERPRISE(PTY) LTD
Contact Person	: Mrs Daisy Jane Maseko
Cell No.	: 083 449 2823
Email	: daisy@mancamane.co.za
Physical Address	: 24 Maritz Avenue, Delmas, 2210
DMRE Reference No.	: MP 305/1/1/2/17328 PR

Aim of the BID

This document aims to provide the following:

- To provide background information to landowners and interested and affected parties (I&APs) on the proposed prospecting activities and the legal framework;
- To give an overview of environmental baseline information and environmental impacts that may potentially occur;
- To explain the Public Participation Process (PPP) to be followed; and
- To consult stakeholders and provide them the opportunity to register as I&APs.

Locality

This proposed prospecting area is situated approximately 8.5 km North-East of Delmas, and It is parallel to N12.

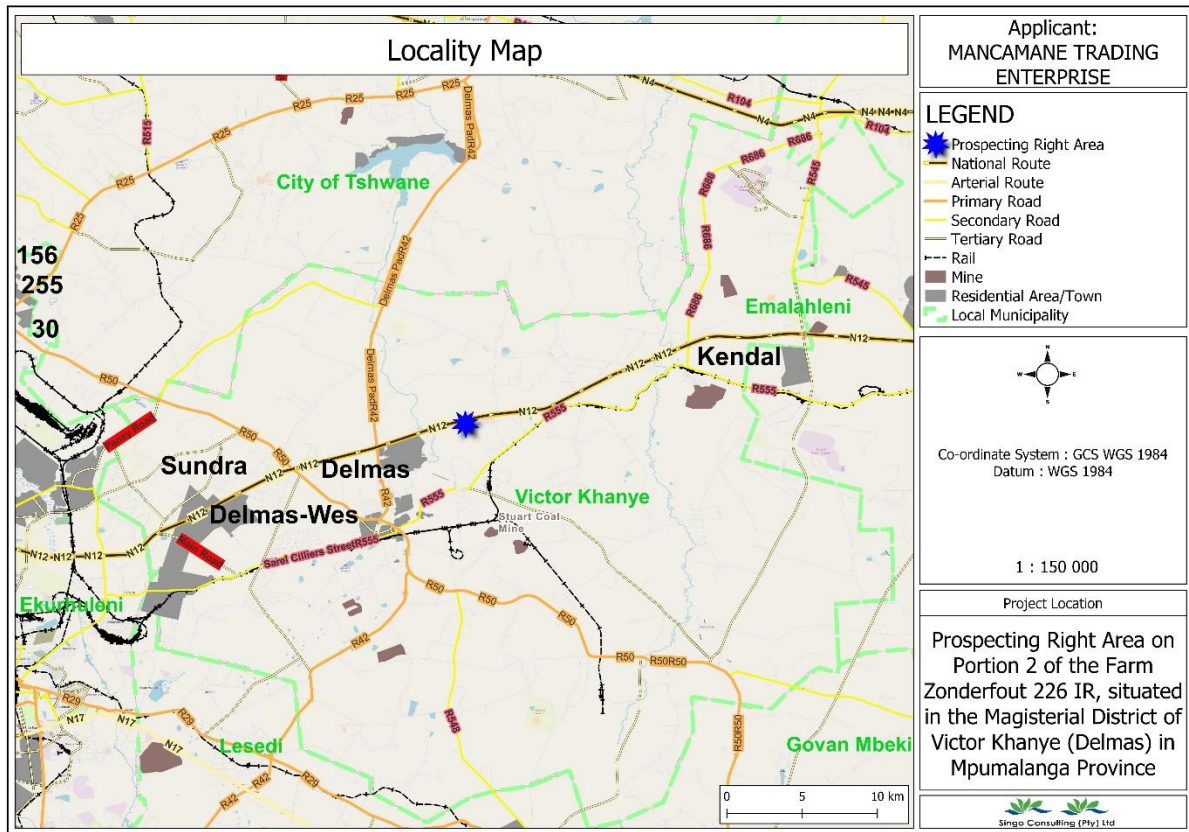

Figure 1: Location of the proposed project

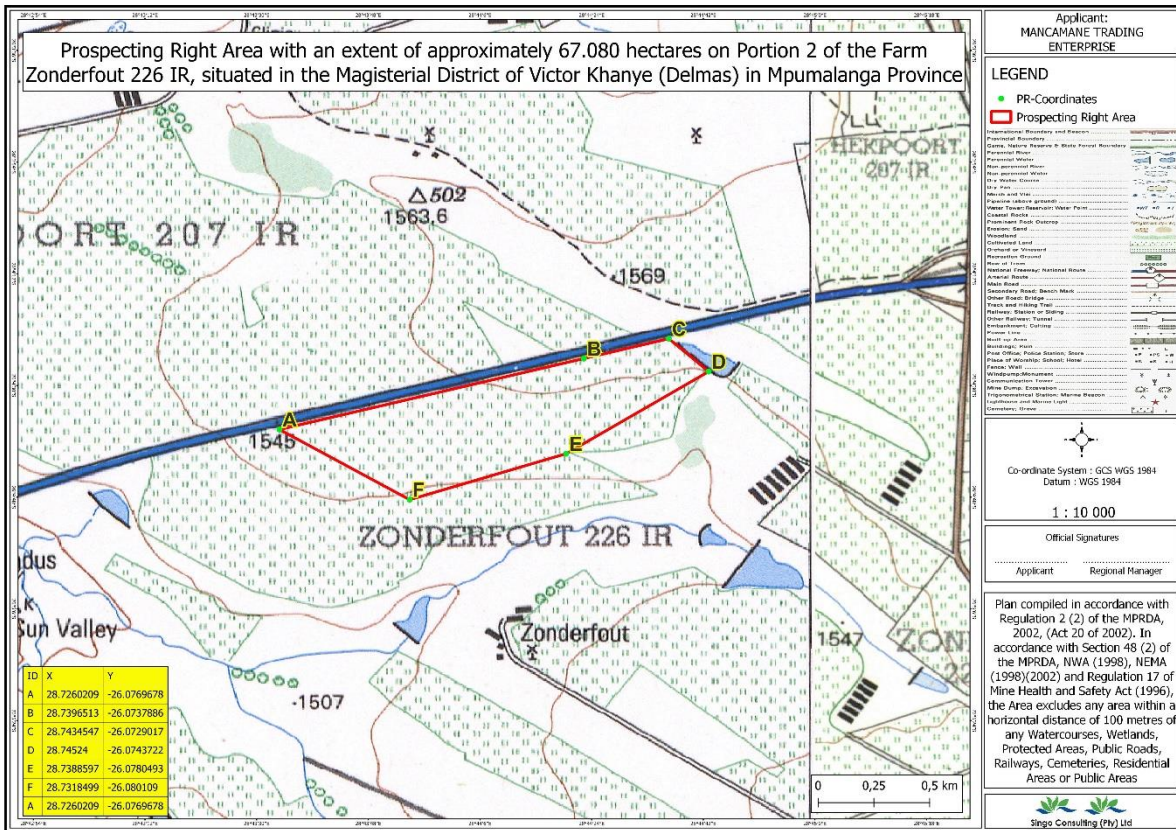

Figure 2: Reg2 (2) of the proposed project area : (A-26.0769678, 28.7260209)

Need

The coal that is being prospected has the potential to supply local & regional power stations and possible international customers. Coal is crucial for the generation of electricity in South Africa, supplying more than 90% of the population. After prospecting activities, which is the thorough search of a mineral through core drilling, it will be accessed if mining coal will be viable not only for the company but also for the community. The success of the project will contribute to the economic development in the Local Municipal area

After prospecting activities, which is the thorough search of a mineral through core drilling, it will be accessed if mining the above-mentioned minerals will be viable not only for the company but also for the community. The success of the project will contribute to the economic development in the Local Municipal area.

Legislative requirements

The prospecting right application is subjected to the following Acts:

- National Environmental Management Act (Act 107 of 1998)
- Environmental Impact Assessment regulations as amended (April 2017);
- Mineral and Petroleum Resources Development Act, (Act 28 of 2002);
- National Water Act, 1998 (Act 36 of 1998);
- National Air Quality Standards (GN 1210: 2009); and
- National Dust Control Regulations (GN 827: 2013).

Basic and Environmental Impact Assessment Processes

During this process the positive and negative impacts associated with the prospecting activities are assessed; and suitable alternatives and/or management measures are proposed to reduce the environmental impacts.

1. Technical process involves :

- Submitting application forms to DMRE;
- Compiling the Draft Basic Assessment Report (DBAR) and Environmental Management Programme Report(EMPr).
- Submit the DBAR and EMPr to all I&APs to review and comment.
- Incorporate comments into final BAR and EMPr.
- Submit final BAR and EMPr to the DMRE.

2. Public participation:

Public input is an important legislated requirement of the prospecting right application process. The proposed PPP for this study will include a number of steps, as listed below:

Issuing notification of this proposal to:

- Owners and occupiers of the farms as well as those adjacent to the site;
- The municipal councillor and local taxpayer's association;
- The municipality which has jurisdiction (Victor Khanye Local Municipality)
- Any organ of the state having jurisdiction;
- Placing an advert in a local newspaper (Streeknuus)
- Placing a notice on the site;
- Meetings with landowners and key I&APs, as required;
- Public review of the Draft Environmental Management Plan Report; and
- Notifying stakeholders when the proposed project is granted.

Prospecting Methodology

Prospecting activities will be undertaken over a period of five (5) years and are designed in phases, each phase conditional on the success of the previous phase. Both invasive and non-invasive methods will be implemented. Desktop study of the area has commenced, and this incorporates desktop geographical and geological mapping. This will be followed by detailed geochemical and geotechnical surveys. In turn, this is followed by detailed geophysical studies and later, a detailed drilling, sampling, assaying and mineralogical study. Diamond core drilling methods will be utilised to prospect in situ ore deposits. To ensure or minimise impacts on the receiving environment, all the activities will be guided by the project's EMP.

Develop Impacts Assessment Methods

Impact assessment methods were developed to:

- Identify the potential impacts of a proposed development on the social and natural environment;
- Predict the probability of these impacts; and
- Evaluate the significance of the potential impacts.

The following are associated with the prospecting activities to be undertaken:

- **Access roads**

The applicant will require access to the site for both personnel and machinery associated with prospecting activities. Existing routes will be used such as the N12 and new access routes might be created with the agreement of the landowner, only when necessary. Potential impacts associated with the creation and use of access roads include soil compaction, generation of dust on gravel roads, machinery and vehicles and noise levels while drilling. However, with the appropriate mitigation strategies in place, including applying buffers to sensitive landscapes, notifying settlements around of the drilling times and using existing roads and access tracks wherever possible, the significance of these potential impacts can be reduced to low.

- **Faunal Disturbance**

Animals within the prospecting area will be moved to other locations because of the temporary disturbances.

- **Air pollution**

Prospecting is not as invasive as mining thus air pollution will be due to movement of mobile machinery on the site. Dust will be generated during the drilling or clearing vegetation. Mitigation Measure:

- ✓ Air quality will be minimised by means of the following:
 - Dust suppressions by means of water spraying will be implemented when there is a need.
 - Avoidance of unnecessary removal of vegetation.
 - Vehicles will be properly serviced in order for them to minimise emission of CO₂.
- ✓ Re-vegetation of rehabilitated areas not occupied by plant infrastructure to take place as soon as possible.

- **Noise pollution**

Noise will be generated by the drilling equipment and may disturb inhabitants. Mitigation measures:

- ✓ The company will comply with the Occupational Noise Regulations of the Occupational Health and Safety Act, Act 85 of 1993. The company will comply with the measures for good practice with regards to management of noise related impacts during construction and operation.
- ✓ Workers will be inducted with regard to the measure to reduce noise pollution on site.

- **Soil pollution**

Contamination of soil may occur from accidental spillages from the machineries brought to the site.

Mitigation measures:

- ✓ If any soil is contaminated during the prospecting activities, it will be immediately scooped and stored for collection in the enclosed containers or plastic and transported to a recognized facility or company for further treatment.
- ✓ Small spills will be treated on site using bio-sorb or oil cap.

- **Surface disturbance**

Only a small segment of the surface will be disturbed as a result of drilling due to prospecting activities.

- **Vegetation Loss**

Some of the vegetation will be disturbed on areas that drilling will be done. In all areas where site is going to be established vegetation will be disturbed. Mitigation measures:

- ✓ Vegetation will be protected by avoiding unnecessary clearance and by using existing roads at all times.
- ✓ All vehicles will be monitored so that they move on the existing tracks at all times. All prospected areas will be rehabilitated.
- ✓ Fire extinguisher will always be available on site through the prospecting period. If invader species are encountered, they will be uprooted or cut off and destroyed completely.

- **Water Use**

Water required for the operation and potable water for domestic use will be sourced and the details thereof will be finalised at a later stage.

- **Socio-Economic Factors**

There is minimal potential for employment due to the nature of prospecting activities. Minimal opportunities are to be expected for the affected/surrounding communities.

Decision making by competent authority (CA)

The Department of Mineral Resource and Energy (DMRE) are the competent authorities in respect of both the NEMA and the MPRDA processes. Based on the information provided in the Environmental Management Plan Report, the CA will decide regarding the continuation with phase 2 of the application. I&APs will be notified and given direction and information about the approval/rejection of the application, given an opportunity to appeal and a way forward.

Timeframes and Important Dates

I&AP's are invited to send us their comments on local knowledge or any relevant information regarding the project that we may incorporate into developing a well-informed BAR and EMPr during the stakeholder engagement and review period. During the review period, kindly submit any comments based on the draft BAR and EMPr to **Ms Tshepo Mkhabela** no later than the **09th of November 2022** using the contact details provided below on the comment form. The draft BAR and EMPr will be made available at **Delmas Public Library (Cnr Sarel Cilliers & Van Riebeeck, 2210, Delmas, Mpumalanga)**. A soft copy is available from **Singo Consulting (Pty) Ltd** upon request, using the contact details of the Environmental Technician.

Kindly note the following dates:

- Stakeholder engagement and consultation: **Ongoing throughout the process of compiling the BAR and EMPr.**
- Review of Draft BAR and EMPr: **10 October 2022 – 09 November 2022.**

