

NOTE : ALL THREADED BAR AND NUTS TO BE 8.8 GRADE

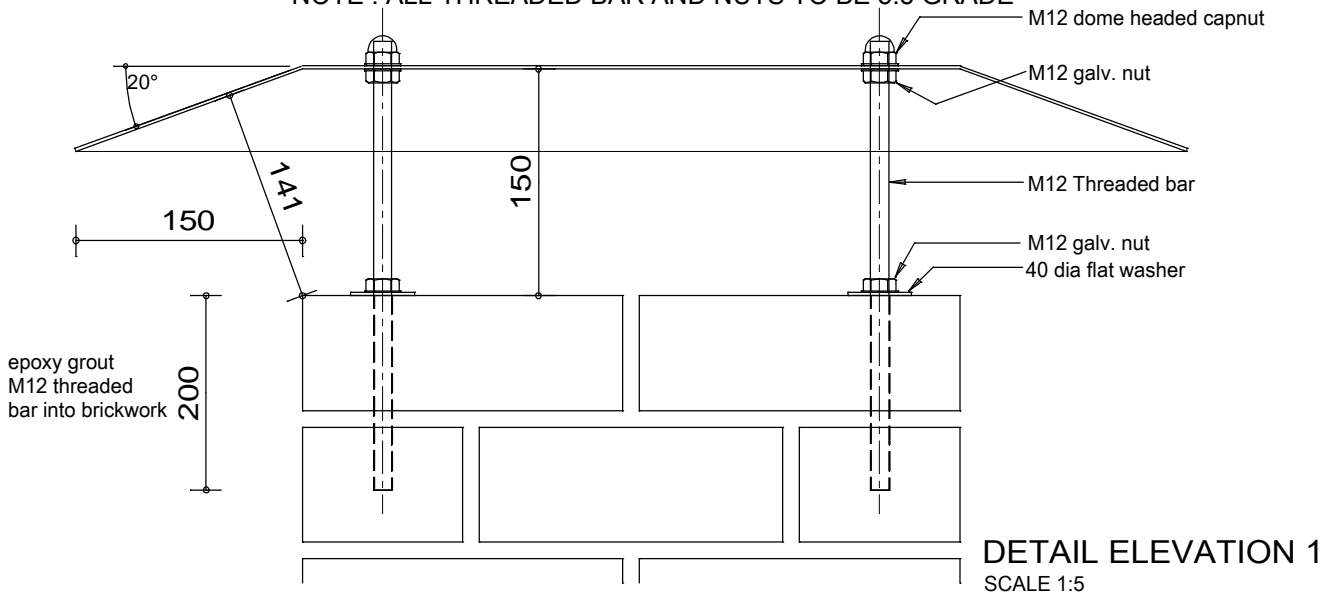

CONSTRUCTION METHODOLOGY:

1. INSPECT CHIMNEY AND TAKE MEASUREMENTS ON SITE
2. MANUFACTURE HOOD AND POSITION THREADED BAR AND ADJUST TO SUIT THE ON SITE MEASUREMENTS
3. ENSURE THAT THREADED BAR IS INSTALLED AS SHOWN ON CENTRELINE OF BRICKWORK

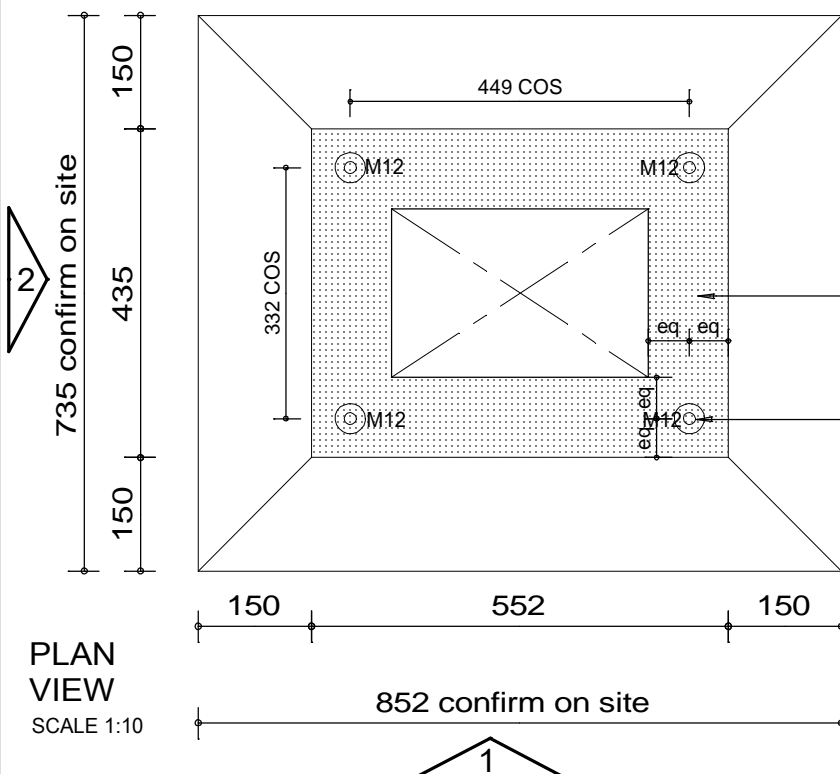

- * canopy made of 2mm mild steel in a powdercoated black finish.
- * 4 x M12 galvanised threaded bar fasteners with dome headed capnut on top face with M12 Nyloc nut below top plate.
- * 4 x M12 nuts at bottom with large galv. washer adjusted on thread to allow for level installation of chimney hood.
- * threaded rods epoxy grouted into brickwork approx. 200mm deep.

CANOPY HOOD FOR KITCHEN EXTRACTOR AT PMB STATION

DRAWN: TW DATE: 28.01.2014

