

| Lighting Legend | | Lighting Legend | |
|-----------------|--|-----------------|---|
| | Recessed Fluorescent Downlight with front reflector with 300 x 600mm Future 2400 | | Single Fluorescent Light |
| | Recessed Fluorescent Downlight with front reflector with 300 x 600mm Future 1400 | | Under Canopy Fluorescent applied & installed by canopy contractor Code: Nelson NLS 2300/17 DP 05 / 04 |
| | Emergency Fluorescent Fitting with 4 tube luminaire | | Ceiling / Plaster Repair Flat Light, applied and installed by Refrig Contractor Code: NLS 2300/17 DP 05 / 04 |
| | Emergency Fluorescent Fitting with acoustic diffuser with 4 tube luminaire | | Ceiling Drop Box Code: Nelson NS / 23 000 - 4000 / EA 7000 |
| | Emergency Fluorescent Fitting with 4 tube luminaire | | Drop - Storage Box for Lift Hall |

| Electrical Legend | | Ceiling Legend | |
|-------------------|---------------------------------|----------------|---|
| | 15 AMP Single Socket Plug Point | | 1200x600 exposed 'T' suspended ceiling with white pre-painted 'T's and plain white ceiling tiles height 3150mm AFFL. |
| | 15 AMP Double Socket Plug Point | | 1200x600 exposed 'T' suspended ceiling with white pre-painted 'T's and plain white ceiling tiles height 2500mm AFFL. |
| | 15 AMP Dedicated Plug Point | | Flush Plastered Gypsum bulkhead skinned, sanded & painted to specifications. Ceiling height to start at and drop no lower than 2050mm AFFL, to accommodate curved menu box area to be not lower than 2050mm AFFL. |
| | 3 Phase Isolator Switch | | |
| | 3 Phase Power Outlet Point | | |
| | Extractor Canopy ON/OFF | | |
| | Distribution Board | | |
| | Fire Point | | |
| | Telephone Point | | |
| | Power Bar | | |

Note:
150AMP 3 Phase Power is required and Power Supply is to be upgraded by the Landlord/Developer if required

Electrical Notes

Allowance to be made for power supply to x 5 menu boxes in flush plastered bulkhead

A power supply is to be allowed for under counter fluorescent fittings

All Fluorescent fittings to have Lumilux / polylux / colour 21 tubes with electronic controlled gear

Fire Requirements

Class of occupancy: A1
All class coverings to comply with NBR 7715
All emergency exits to be fitted with a locking device in accordance with the NBR 7715
FC's to be installed in accordance with NBR 7734
Fire fighting equipment to be provided in accordance with the NBR 7732
All ceilings to comply with the NBR 7713
All marking and sign posting to be installed in accordance with 7720 of NBR
A 30m Firehose reel to be installed in premises where the facility has not been provided.

Note:
The Fire Department is to be contacted on completion to obtain a clearance certificate prior to electrical connection

Extractor Canopy Specs

Supplier to supply moisture proof light fittings to extractor canopy

3.5 Kw Stop / Start Switch 7.2 amps Max
6.3 x 30amp 5 KA at DB 6
Stop / Start Switch fitted to Power bar, as per
Dorrego Spec
services have been effected the existing structure i.e. where ducting exists the existing roof structure, the opening to be flash sealed properly

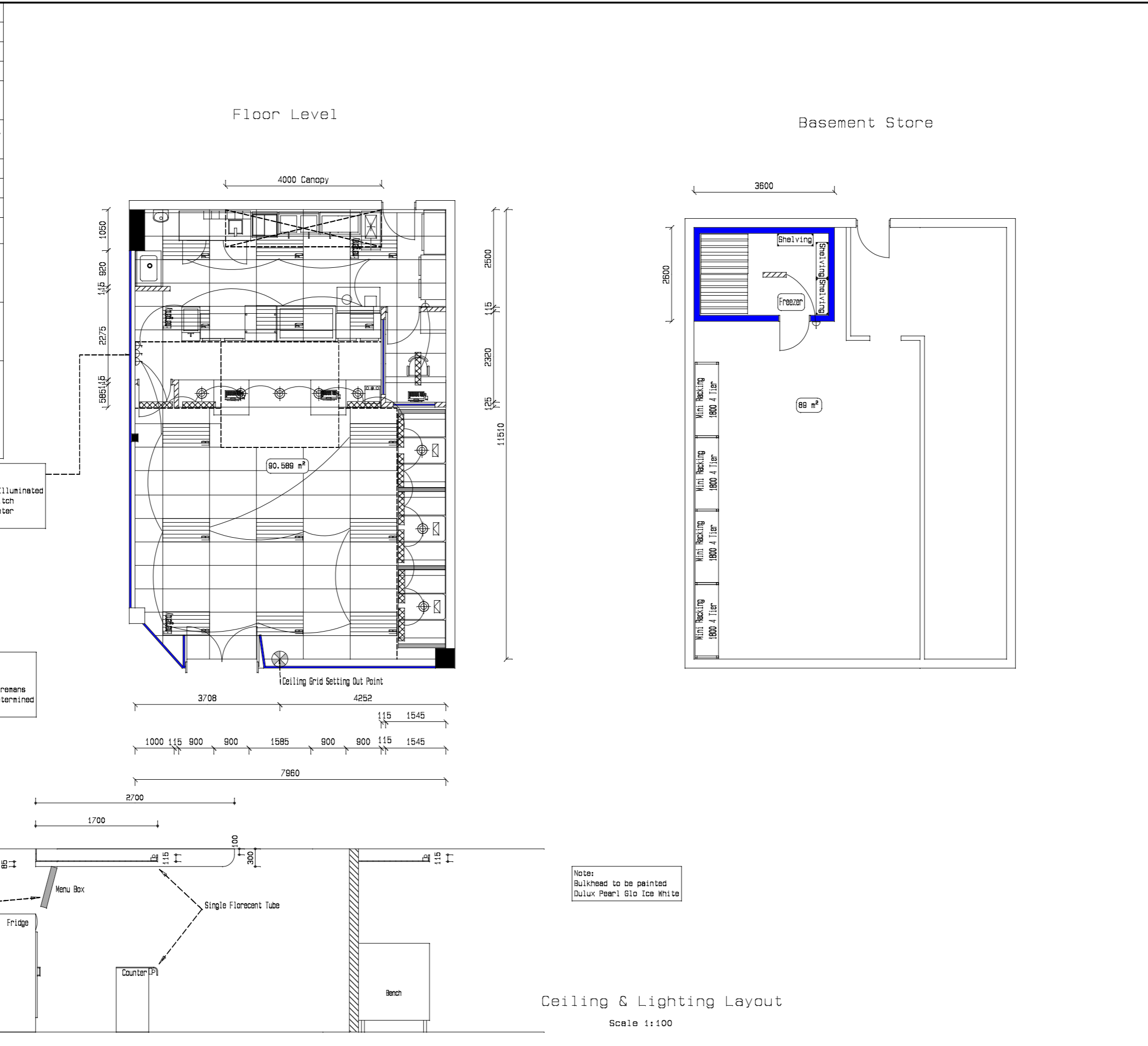

| Revisions |
|---|
| |
| General Notes |
| All Dimensions and Levels are to be verified on site prior to commencing setting out, workshop drawings or construction Figured dimensions only to be used Discrepancies, Errors, and Omissions are to be reported to the designer immediately as they become evident All contractors to familiarise themselves with the site and franchise specs, prior to submission of tenders Drawings to be read in conjunction with the general specs and notes Any part of the drawing may not be reproduced and is reserved by the designer Any information which is unclear to be queried with the designer |
| General Building Notes |
| All stores, offices, toilets, change rooms, to have cross ventilated mechanical ventilation if required Kitchen flooring to be a non slip porcelain tile with epoxy grouting to be acid resistant All walls above the tile line in the kitchen to be primed and painted with a non porous and moisture proof paint: White Satin Emul unless otherwise specified Kitchen ceilings to be dust proof and non porous Floor drains to be flush with the finished floor surface and the floors to be graded towards the floor drains Wall to floor junctions to prep and scullery areas to be covered with ceramic tiles Wash hand basins to have approved liquid soap dispensers and paper towel dispensers. All water piping and electrical conduiting to be encased in the wall behind the plaster Walls behind MFF's to have a minimum of 3 ceramic tile splashback Canopy to comply with the current health regulations Plaster to be made rot proof prior to occupation All tables: Shelving units etc: to have lowest shelf 150mm AFFL. |
| DoRegos |
| Note: The fire department to be contacted on completion of the contract to obtain a clearance certificate prior to electrical connection |
| ALL WORK TO BE CARRIED OUT IN ACCORDANCE WITH THE MUNICIPAL BY - LAWS AND LOCAL AUTHORITY REQUIREMENTS |
| CPC |
| Corporated Project Consultants 14 Laurel Street Gardenia Park Blomfontein 9300 Tel: 083 514 9313 |
| Project: DoRego's Truck Stop NI - BFN |
| Drawing Description: Ceiling & Lighting Layout |
| Drawn By: Francesco Moretti Date: 6 September 2012 Scale: 1:100 Ceiling Height: 3100 Modules: XXX Drawing #: Pietermaritzburg Retailer: XXX Signoff: XXX |
| Franchisee Approval |
| Franchisor Approval |