

Plumbing Legend	
	Cold Water Point
	Hot Water Point
	Drainage Point 50mm
	100L Geyser

Note:  
The main DB Board to be advised by Electrician onsite

Note:  
All water points to be at 1200mm AFFL unless otherwise Specified

Note:  
An Electronic Grease Trap To be Installed On a Regular 5/Steel Or Plastic Trap

Electrical Legend	
	15 AMP Single Socket Plug Point
	15 AMP Double Socket Plug Point
	15 AMP Dedicatid Plug Point
	3 Phase Isolator Switch
	3 Phase Power Outlet Point
	Extractor Canopy ON/OFF
	Distribution Board
	Fax Point
	Telephone Point
	Power Bar 5/Steel - Drugges Spec

Note:  
Geyser position TBA by Plumber/Builder onsite

Note:  
x2 60A Isolators 3 Phase  
x2 30A Isolators 3 Phase  
x2 off (4"x4") Double Plugs  
3.5 KW - 3 Phase Stop/Start Canopy

Note:  
In Power Bar  
x4 Double Plugs (4"x4")

Note:  
A Power Supply To Be Installed In Ceiling Void For 6 No Illuminated Menu Boxes On Separate Switch

Note:  
150AMP 3 Phase Power is required and Power Supply is to be upgraded by the Landlord /Developer if required

**Electrical Notes**

A power supply is to be allowed for under counter fluorescent fittings

All Fluorescent fittings to have Lumilux / polylux / colour 2l tubes with electronic controlled gear

**Fire Requirements**

Class of occupancy : A1

All class coverings to comply with NBR 1174

All emergency exits to be fitted with a locking device in accordance with the NBR IT 19

FE's to be installed in accordance with NBR 1734

Fire fighting equipment to be provided in accordance with the NBR 1732

All ceilings to comply with the NBR 1713

All marking and sign posting to be installed in accordance with 1720 of NBR

A 30m Firehose reel to be installed in premises where the facility has not been provided.

Note:  
The Fire Department is to be contacted on completion to obtain a clearance certificate prior to electrical connection

**Extractor Canopy Specs**

Supplier to supply moisture proof light fittings to extractor canopy

3.5 Kw Stop / Start Switch@ 7.2 amps Max  
6.3 x 30amp 5 KA at DB 6

Stop / Start Switch fitted to Power bar, as per Drago's Spec

services have been affected the existing structure i.e. where ducting exits the existing roof structure, the opening to be flash sealed properly

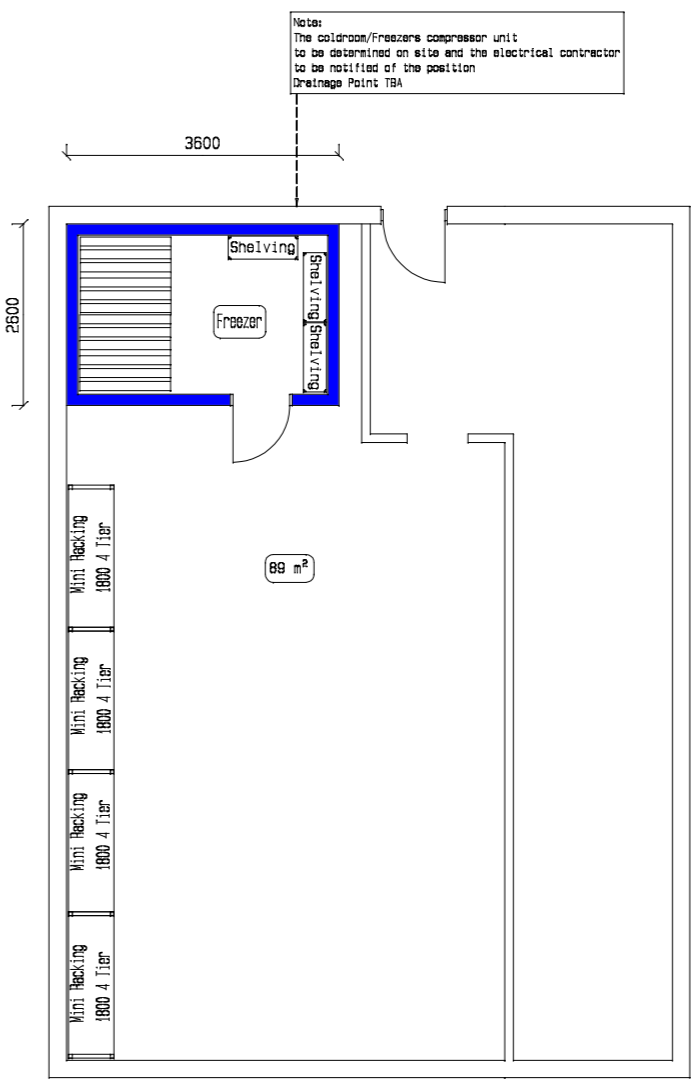
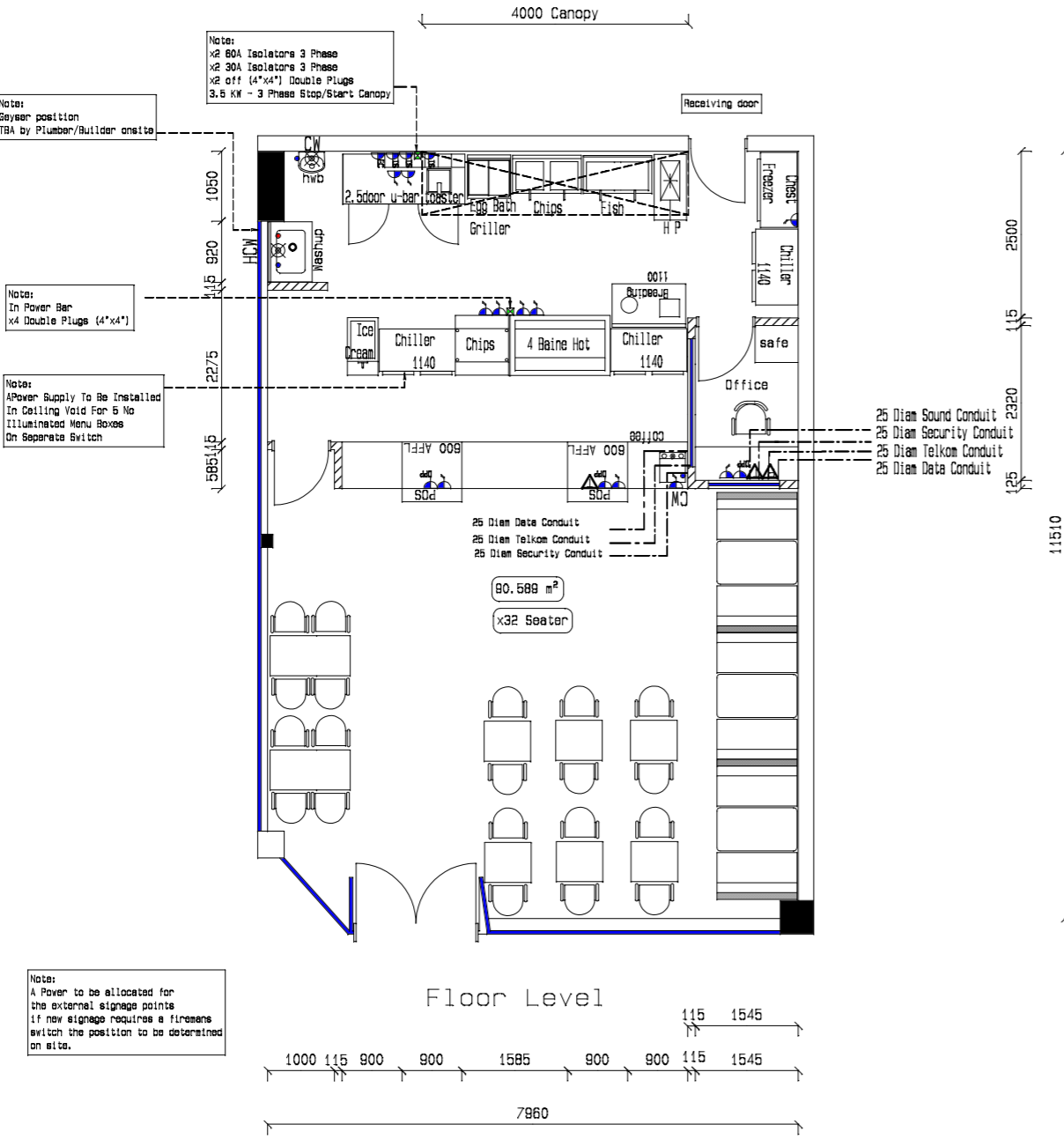

Note:  
The coldroom/freezer compressor unit to be determined on site and the electrical contractor to be notified of the position  
Drainage Point TBA

Basement Store

Revisions
General Notes
All Dimensions and Levels are to be verified on site prior to commencing setting out, workshop drawings or construction Figured dimensions only to be used Discrepancies, Errors, and Omissions are to be reported to the designer immediately as they become evident All contractors to familiarise themselves with the site and franchise specs, prior to submission of tenders Drawings to be read in conjunction with the general specs and notes Any part of the drawing may not be reproduced and is reserved by the designer Any information which is unclear to be queried with the designer
General Building Notes
All stores, offices, toilets, change rooms, to have cross ventilations mechanical ventilation if required Kitchen flooring to be a non slip porcelain tile with epoxy grouting to be acid resistant All walls above the tile line in the kitchen primed and painted with a non porous and washable paint finish: White Satin Emul unless otherwise specified Kitchen ceilings to be dust proof and non porous Wall to floor junctions to prep and seal with epoxy to be covered with ceramic tile Wash hand basins to have approved liquid soap dispensers and paper towel dispensers All water piping and electrical conduiting to be embedded in the wall behind the plaster Walls behind NSF's to have a minimum of 3 ceramic tile splashback Canopy to comply with the current health regulations Premises to be made rodent proof prior to occupation All tables: Shelving units etc to have lowest shelf 150mm AFFL
DoRego's
Note: The fire department to be contacted on completion of the contract to obtain a clearance certificate prior to electrical connection
ALL WORK TO BE CARRIED OUT IN ACCORDANCE WITH THE MUNICIPAL BY - LAWS AND LOCAL AUTHORITY REQUIREMENTS
CPC
Comprehensive Project Consultants 14 Laurel Street Gardenia Park Blomfontein 9300 Tel: 083 514 9313
Project: DoRego's
Drawing Description: Plumbing & Electrical Layout
Drawn By: Francesco Moretti Date: 6 September 2012 Scale: 1:100 Ceiling Height: 3100 Modules: XXX Drawing #: Pietermaritzburg Retailer: XXX Signoff: XXX
Franchisee Approval
Franchisor Approval