

LOCALITY PLAN

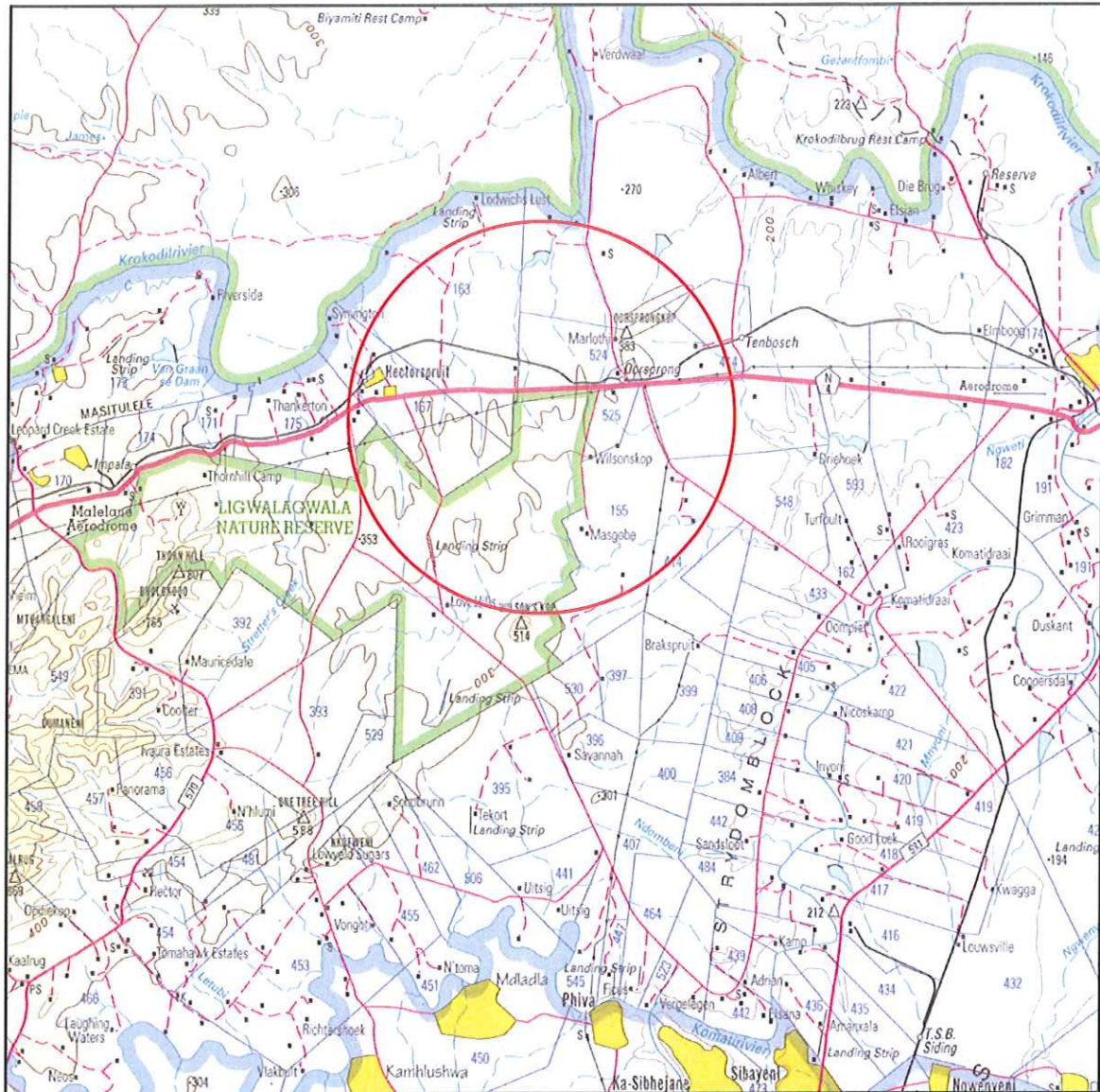

Eskom
Geographic Mapping Nelspruit
are not responsible for any errors
in external datasets displayed on this map.

SCALE 1:250 000

Information from official maps reproduced under Government printers copyright authority No. 4138 of 28/03/1969



Northern Region
Land Development

P.O.Box 1567
Nelspruit 1200
Tel 013 -755 9617
Fax 013 -755 9660

Feeder:	KOORSBOOM/THANKERTON 22kV	Surveyor:	NTHABISENG
Customer:	MATHABA	Geographic mapping:	Jo-Anne Cronje
Project No:	KML117201994	Date compiled:	17/04/2014
Length of line:	0.360km	Revised by:	
Portion of map no:	2530	Revision date:	
Page:	1 of 3		

DASHED RED LINE INDICATES POWERLINE ROUTE

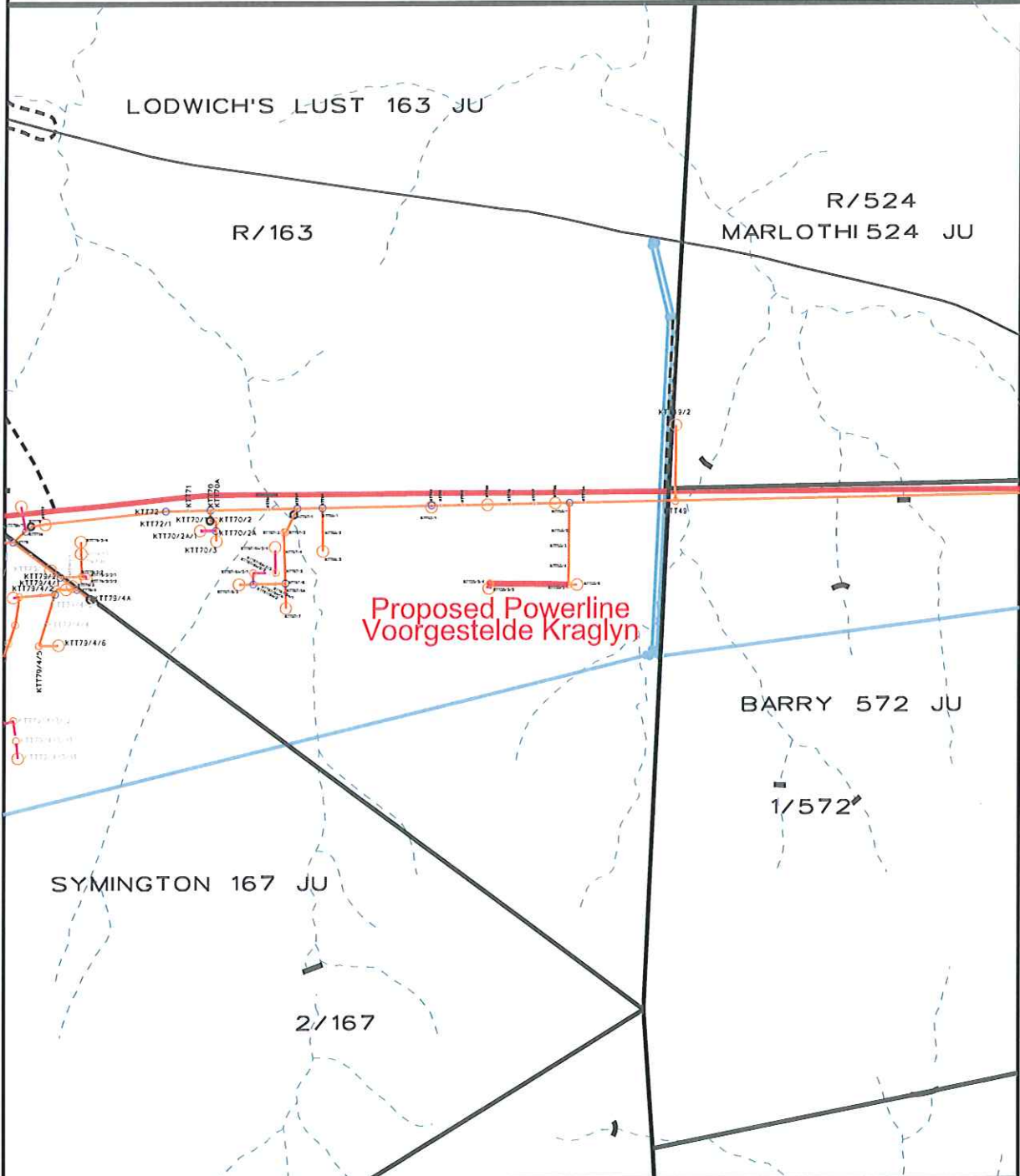

Route plan
Northern Region

Disclaimer
Geographic Mapping Nelspruit
are not responsible for any errors
in external datasets displayed on this map.
The following external datasets were used:
Cadastral
Topographical

Feeder:	KOORSBOOM/THANKERTON 22kV
Customer:	MATHABA
Project No:	KML117201994
FSA / TSA Area:	MALELANE

Portion of map no:
2531BC
Scale: 1:25 000



Information from official maps reproduced under Government printers copyright authority No. 4138 of 28/03/1969

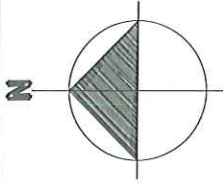

Pole no: KTT55/5
 Tee off angle: 90°0'0"
 KOORSBOOM/THANKERTON 22kV
 LAT: -25° 26' 39.8", LONG: 31° 43' 49.1"
 WX: 73459.323 WY: -2815483.547

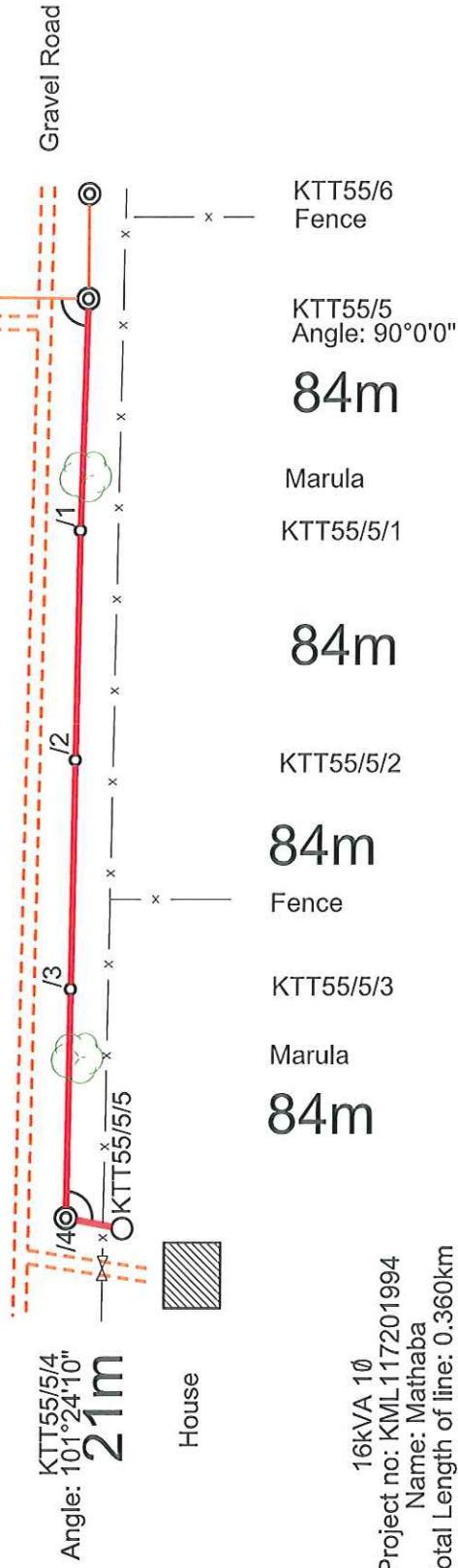

16kVA 1Ø
 Project no: KML117201994
 Name: Mathaba
 Total Length of line: 0.360km
 Surveyor: Nthabiseng

NOTE: RED PEGS on site
 indicate structure position.

PLEASE NOTE:
 No protected trees/plants may be cut/trimmed/removed
 unless the applicable tree permit is issued and handed
 to the construction contractor.