

REVISION

Date	No.

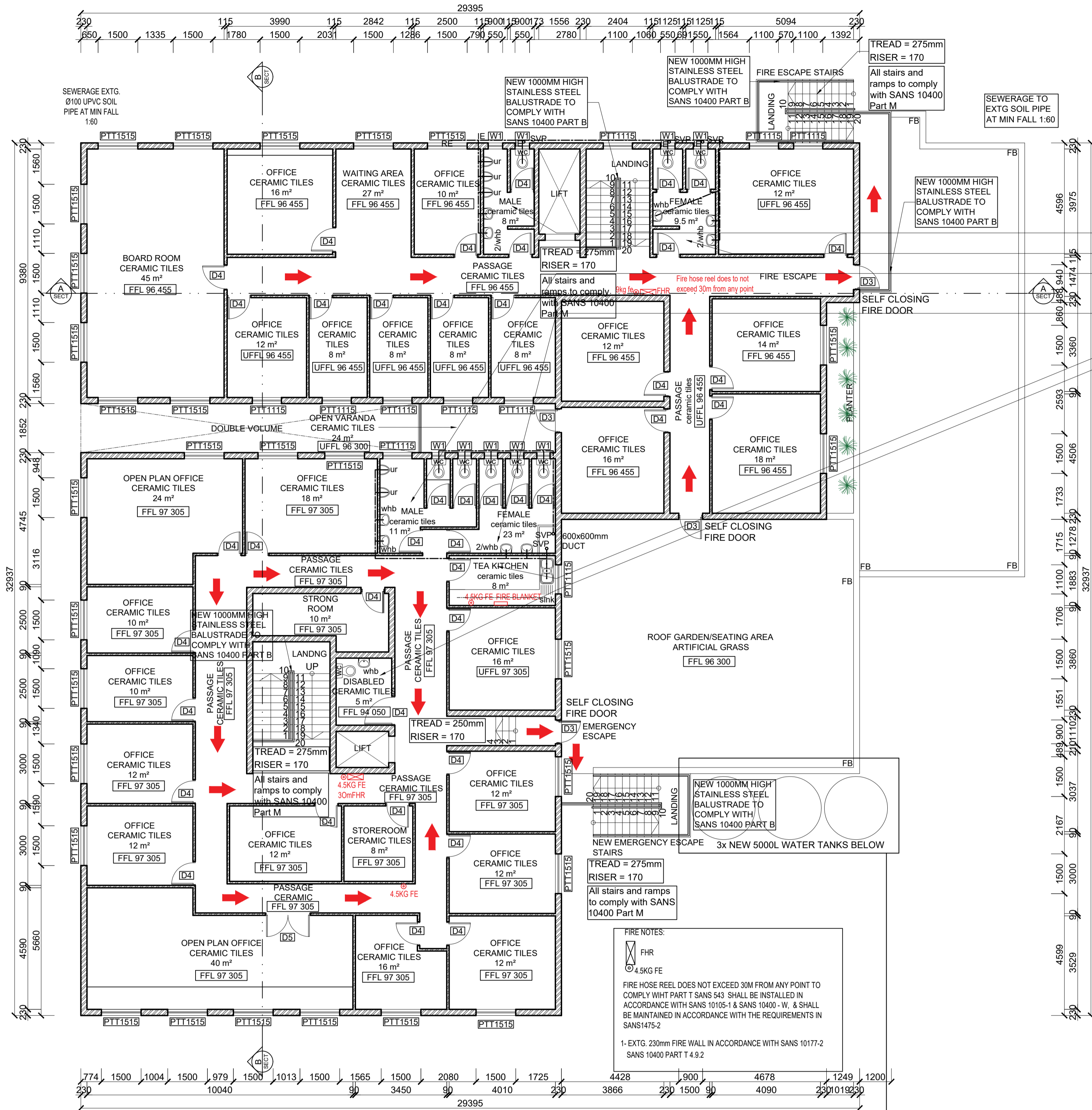

FIRST STOREY SANITARY FIXTURES

	WC	URINAL	WHB
MALE	3	5	4
NEW			
FEMALE	5		5
NEW			
DISABLED			
NEW			

NOTE FOR ALL SPACES WITH NO NATURAL VENTILATION & LIGHT:
 PROVIDE AIRCONDITIONER/EXTRACTORS OR SIMILAR AS ARTIFICIAL VENTILATION SYSTEM TO COMPLY WITH SANS 10400 - T & SANS 10400 - O - 4.3

PROVIDE SYSTEM OF ARTIFICIAL LIGHT TO COMPLY WITH SANS 10114-1
 ANY BATHROOMS WITHOUT NATURAL VENTILATION TO BE MECHANICALLY VENTILATED AND TO COMPLY WITH SANS 10400-T & SANS 10400-O-4.3

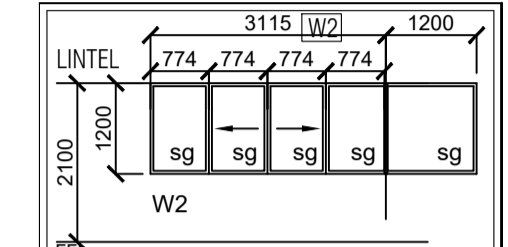

WINDOW CODE	W2
QTY.	1 NO.
IRONOMGERY	AS PER MANUFACTURES INSTRUCTION
GLAZING	
MATERIAL	ALUMINIUM

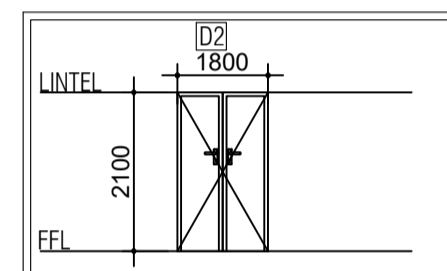

DOOR CODE	D5
QTY.	5 NO.
IRONOMGERY	AS PER MANUFACTURES INSTRUCTION
GLAZING	
MATERIAL	ALUMINIUM

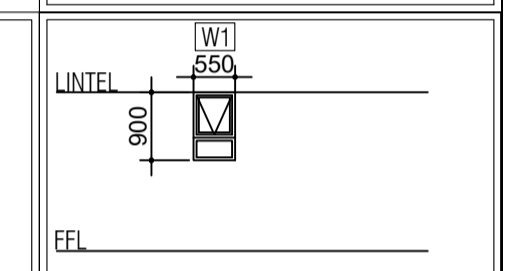

WINDOW CODE	W1
QTY.	5 NO.
IRONOMGERY	AS PER MANUFACTURES INSTRUCTION
GLAZING	
MATERIAL	ALUMINIUM

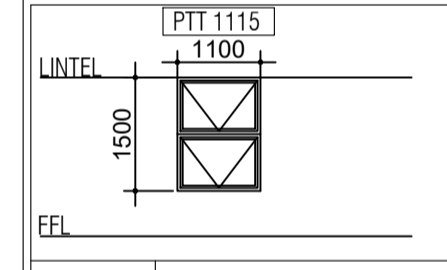

WINDOW CODE	PTT 1115
QTY.	3 NO.
IRONOMGERY	AS PER MANUFACTURES INSTRUCTION
GLAZING	
MATERIAL	ALUMINIUM

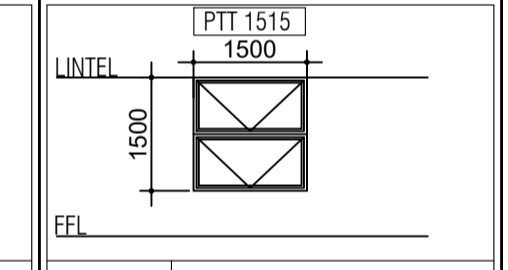

WINDOW CODE	PTT 1515
QTY.	3 NO.
IRONOMGERY	AS PER MANUFACTURES INSTRUCTION
GLAZING	
MATERIAL	ALUMINIUM

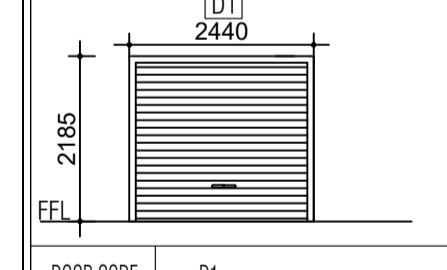

DOOR CODE	D1
QTY.	5 NO.
IRONOMGERY	AS PER MANUFACTURES INSTRUCTION
GLAZING	
MATERIAL	ALUMINIUM

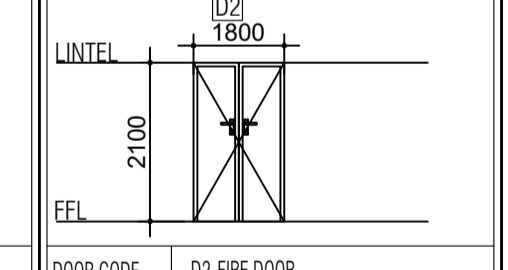

DOOR CODE	D2-FIRE DOOR
QTY.	3 NO.
IRONOMGERY	AS PER MANUFACTURES INSTRUCTION
GLAZING	
MATERIAL	ALUMINIUM

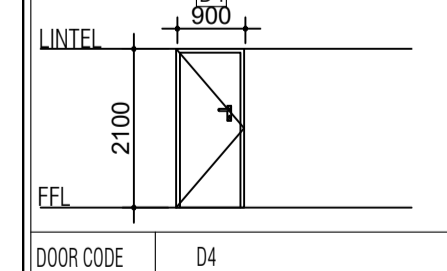

DOOR CODE	D4
QTY.	82 NO.
IRONOMGERY	AS PER MANUFACTURES INSTRUCTION
GLAZING	
MATERIAL	TIMBER

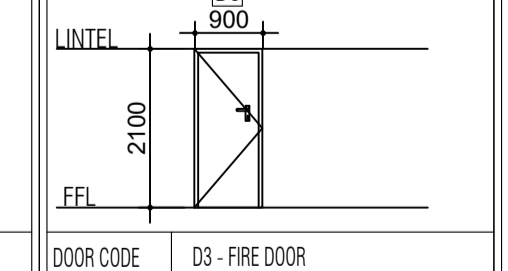

DOOR CODE	D3-FIRE DOOR
QTY.	8 NO.
IRONOMGERY	AS PER MANUFACTURES INSTRUCTION
GLAZING	
MATERIAL	ALUMINIUM

**FIRST STOREY PLAN
 EMERGENCY & FIRE PLAN
 SCALE 1:100**

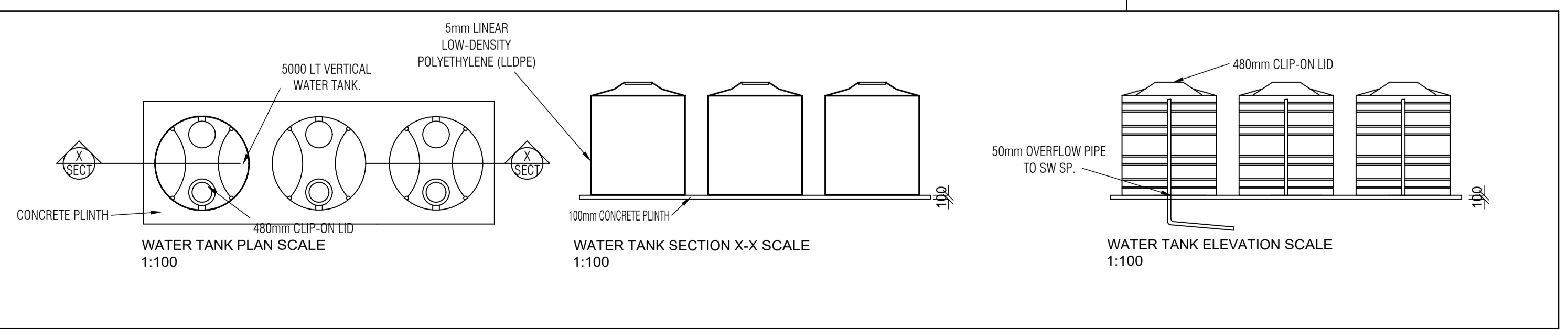

**ADDITIONS AND ALTERATIONS FOR NEW OFFICES
 ERF 165 UMZINTO**

Project Description
 ADDITIONS AND ALTERATIONS FOR NEW OFFICES ON ERF 165 UMZINTO FOR MARLIN GOVENDER

PAGE DESCRIPTION: FLOOR PLAN, FIRE PLAN, WINDOWS AND DOOR SCHEDULES

SOUTH AFRICAN COUNCIL OF ARCHITECTURAL PROFESSIONALS
 REGISTRATION NO: PRARCH 20711
 Client/Owner: SINAVE CONSTRUCTION (PTY) LTD

Contact No: 0824498622

Drawn	NN	Date	22/11/2021
Designed	LM	Page No.	2 OF 6
Scale	as shown	Dwg.Ref.	19041

Signatures

Client/Owner: _____

Author/Architect: _____

PR ARCH: 20711
 (B Tech arch, NHDP, B ARCH ADV.)

Lee Maree
 Tel: 083 344 8367
 Lee@L7a.co.za
 PO Box 932 Shell Beach * 4265

