

NOTE FOR DETAILS OF NEW EN-SUITE BEDROOM SEE DWG. D-836/4

PLAN  
1:100

NOTES:

ROOF:

3000A TILES ON REINFORCED MILDSTEEL OR 2500 MICROSLAB 'CONFLAS' UNDERLAY CENTRES OF CROSS BATTENS & VERTICAL BATTENS TO CORONATION SPECIFICATION.

R.W.GOODS.

ALL ARBESTOS CEMENT TO MATCH EXISTING R.W.D.P.'s ALL 75 MM Ø TO DISCHARGE INTO R.W. SUMPS THEN THROUGH 150 MM Ø BRUN CONG. PIPES TO CONNECT UP WITH EXIST. R.W. SYSTEM.

WALLS: EXT.

• ALL ROUGH PLASTER TO MATCH EXISTING FINISHES  
• 1 COAT CONDITIONER & 2 COATS P.V.A.  
• EXTERNAL FACE OF INSIDE 114 SKIN OF OUTSIDE WALLS TO BE BAGGED & PAINTED 2 COATS BITUMEN.

CILLS:

EXTERNAL CILLS TO MATCH EXISTING UNLESS SHOWN OTHERWISE.

ABS

PROVIDE ALL AIRBRICKS TO LOCAL AUTHORITIES REQUIREMENTS, NO 2 OVER EACH NEW DOOR & WINDOW.

FLOOR SLABS.

ALL NEW FLOOR SLABS TO BE 100 MM THICK CONCRETE LAID ON P.C.P. REINFORCED HARDCORE 100 MM THICK

FOOTINGS:

UNDER 220 WALLS PROVIDE 600 W X 220 FCU  
114 " " " " 400 W X 150 "

AGs & D.P.C.s

BUILD IN G.S.I. ANT GUARDS & BITUMASTIC FELT D.P.C.s UNDER ALL NEW WALLS AT SLAB LEVEL.

10.000 FINISHED LEVEL

X10.000 EXISTING LEVEL SHOWN THUS

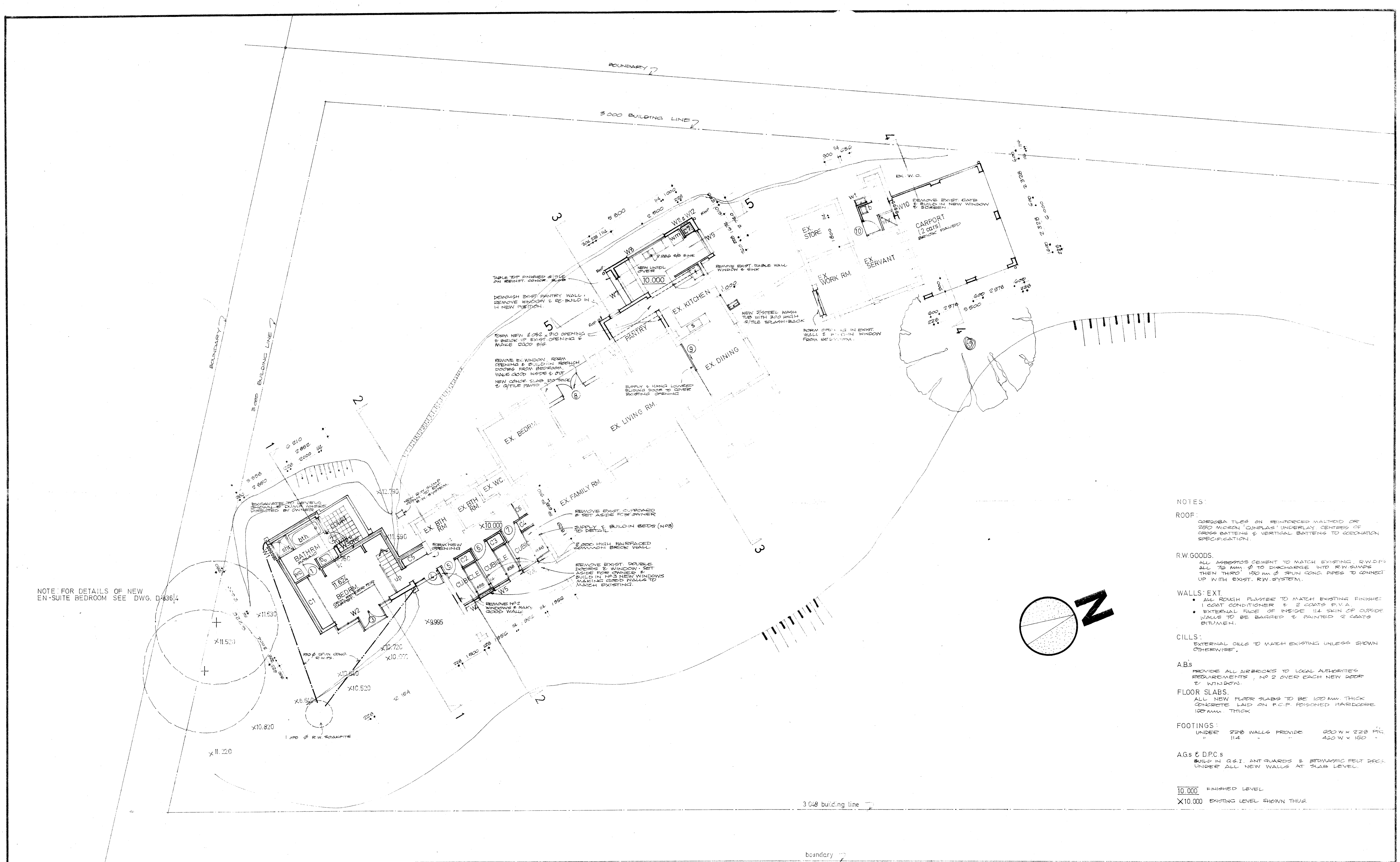
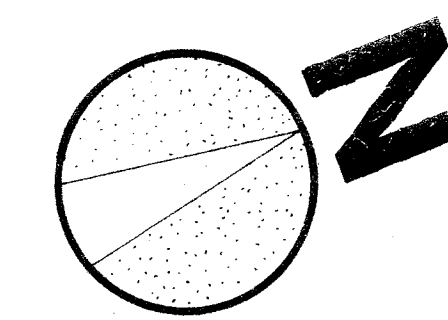

REVISIONS

WORKING DRAWINGS  
PLAN  
SCALE: 1:100  
DATE: 23.10.72  
DELT: P.C.

ADDITIONS & ALTERATIONS TO MRS. J. CLYDE'S RESIDENCE ON LOT WESTVILLE.

BONIEUX ROUGIER & CROXON ARCHITECTS, 314 S.A. PERMANENT BLDGS., PINETOWN 7.364



DRG NUMBER  
D-835-2