

Phase 1 Cultural Heritage Impact Assessment:

**PROSPECTING RIGHT APPLICATION OF DIAMONDS ALLUVIAL AND
DIAMONDS GENERAL NEAR CHRISTIANA ON THE REMAINING EXTENT OF
PORTION 1 OF THE FARM KAFFRARIA 314HO, LEKWA-TEEMANE LOCAL
MUNICIPALITY, NORTH WEST PROVINCE**

Prepared for:

Milnex 189CC (Representative: Mr D Labuschagne)

- Postal Address: P O Box 1086, Schweizer-Reneke, 2780; Tel: 084 735 6221; E-mail: danie@milnex-sa.co.za

Prepared by:

J A van Schalkwyk (D Litt et Phil),

- Heritage Consultant: ASAPA Registration No.: 164 - Principal Investigator: Iron Age, Colonial Period, Industrial Heritage.
- Postal Address: 62 Coetzer Avenue, Monument Park, 0181; Tel: 076 790 6777; E-mail: jvschalkwyk@mweb.co.za

Report No: 2017/JvS/043

- Status: Final
- Date: September 2017
- Revision No: -
- Date: -



Copy Right:

This report is confidential and intended solely for the use of the individual or entity to whom it is addressed or to whom it was meant to be addressed. It is provided solely for the purposes set out in it and may not, in whole or in part, be used for any other purpose or by a third party, without the author's prior written consent.

Declaration:

I, J.A. van Schalkwyk, declare that:

- I am suitably qualified and accredited to act as independent specialist in this application.
- I do not have any financial or personal interest in the proposed development, nor its developers or any of their subsidiaries, apart from the provision of heritage assessment and management services, for which a fair numeration is charged.
- The work was conducted in an objective manner and any circumstances that might have compromised this have been reported.



J A van Schalkwyk
Heritage Consultant
September 2017



EXECUTIVE SUMMARY

**Phase 1 Cultural Heritage Impact Assessment:
PROSPECTING RIGHT APPLICATION OF DIAMONDS ALLUVIAL AND
DIAMONDS GENERAL NEAR CHRISTIANA ON THE REMAINING EXTENT OF
PORTION 1 OF THE FARM KAFFRARIA 314HO, LEKWA-TEEMANE LOCAL
MUNICIPALITY, NORTH WEST PROVINCE**

Milnex 189 CC was contracted by **Chrismar Delwerye (Pty) Ltd** as the independent environmental consultant to undertake the Scoping and EIA process for a prospecting right for the prospecting of Diamond Alluvial and Diamond General near Christiana on the Remaining Extent of Portion 1 of the farm Kaffraria 314HO, North West Province.

In accordance with Section 38 of the NHRA, an independent heritage consultant was appointed by *Milnex 189 CC* to undertake a cultural heritage assessment to determine if the proposed prospecting activities for diamonds would have an impact on any sites, features or objects of cultural heritage significance.

The cultural landscape qualities of the region essentially consist of two components. The first is made up of a limited pre-colonial (Stone Age and Iron Age) occupation. The second component is a rural area in which the human occupation consists of two elements, being made up of a farming community and an urban element, rural towns and townships, most of which developed during the last 150 years.

Identified heritage sites

- (8.3.1.1) Scattered surface occurrences of Middle and possible Late Stone Age stone tools, cores and flakes were identified in a few areas across the prospecting area, but no habitation or tool processing areas were identified. The density of tools has been calculated to be less than 1 tool/flake per 100m².
 - This feature has Low local significance – Grade IV-C
- (8.3.3.1) The ruins of an old homestead, consisting of the foundation of the structure, build with locally quarried limestone blocks.
 - This feature has Low local significance – Grade IV-C
- (8.3.3.2) The ruins of an old homestead, consisting of the foundation of the structure, build with locally quarried limestone blocks.
 - This feature has Low local significance – Grade IV-C
- (8.3.3.3) A small informal burial place. Due to the tall grass cover it was not possible to get a definite count of the number of graves. Two have headstones with the dates ranging between 1963 and 1978.
 - This feature has High/medium local significance – Grade IV-A
- (8.3.3.4) The ruins of a well-built rectangular structure of stone, with a doorway facing east. It is approximately 4 x 2,5 metres in size. A short distance to the north west a circular structure, also built with stone occurs. It is approximately 1,5 metres in diameter.
 - This feature has Medium local significance – Grade IV-B

Impact assessment

- (8.3.1.1) Scattered surface occurrences of Middle and Late Stone Age stone tools and flakes were identified in a few areas across the prospecting area.
 - Impact = None - the significance weighting for the impact on the identified sites is rated as **low**.

- Mitigation: None required.
- (8.3.3.1) The ruins of an old homestead, consisting of the foundation of the structure, build with locally quarried limestone blocks.
 - Impact = the significance weighting for the impact on the identified sites is rated as **medium**.
 - Mitigation: None required.
- (8.3.3.2) The ruins of an old homestead, consisting of the foundation of the structure, build with locally quarried limestone blocks.
 - Impact = the significance weighting for the impact on the identified sites is rated as **medium**.
 - Mitigation: None required.
- (8.3.3.3) A small informal burial place. Due to the tall grass cover it was not possible to get a definite count of the number of graves. Two have headstones with the dates ranging between 1963 and 1978.
 - Impact = the significance weighting for the impact on the identified sites is rated as **medium**.
 - Mitigation: Avoid site, maintain buffer zone of 5 metres demarcated with wire fencing.
- (8.3.3.4) The ruins of a well-built rectangular structure of stone, with a doorway facing east. A short distance to the north west a circular structure, also built with stone occurs.
 - Impact = the significance weighting for the impact on the identified sites is rated as **medium**.
 - Mitigation: Avoid site, maintain buffer zone of 5 metres demarcated with wire fencing. It is recommended that this feature is retained. If that is not possible and it must be demolished, it should be documented (excavated and mapped) in full prior to prospecting activities taking place.

Heritage sites	Significance of impact	Mitigation measures
Kaffraria Diamond Prospecting: Construction Phase		
Without mitigation	Medium	n/a
With mitigation	Low	n/a
Kaffraria Diamond Prospecting: Operation Phase		
Without mitigation	n/a	n/a
With mitigation	n/a	n/a

Reasoned opinion as to whether the proposed activity should be authorised:

- From a heritage point of view it is recommended that the proposed development be allowed to continue on acceptance of the proposed mitigation measures.

Conditions for inclusion in the environmental authorisation:

- Should archaeological sites or graves be exposed during construction work, it must immediately be reported to a heritage practitioner so that an investigation and evaluation of the finds can be made.



J A van Schalkwyk
Heritage Consultant
September 2017

TECHNICAL SUMMARY

Project description	
Description	Mining Permit Application on Diamonds Alluvial and Diamonds General
Project name	Kaffraria 314HO Diamond Prospecting Permit Application

Description	Mining Permit Application on Diamonds Alluvial and Diamonds General
Project name	Kaffraria 314HO Diamond Prospecting Permit Application

Applicant
Chrismar Delwerye (Pty) Ltd

Chrismar Delwerye (Pty) Ltd

Environmental assessors
Milnex 189 CC
Mr Danie Labuschagne

Milnex 189 CC

Mr Danie Labuschagne

Property details													
Province	North West												
Magisterial district	Christiana												
Local municipality	Lekwa-Teemane												
Topo-cadastral map	2725CC												
Farm name	Remaining extent of Portion 1 of the farm Kaffraria 314HO												
Closest town	Christiana												
Coordinates	Centre point (approximately)												
	<table border="1" style="width: 100%; text-align: center;"> <tr> <th>No</th> <th>Latitude</th> <th>Longitude</th> <th>No</th> <th>Latitude</th> <th>Longitude</th> </tr> <tr> <td>1</td> <td></td> <td></td> <td></td> <td></td> <td></td> </tr> </table>	No	Latitude	Longitude	No	Latitude	Longitude	1					
No	Latitude	Longitude	No	Latitude	Longitude								
1													

Province	North West												
Magisterial district	Christiana												
Local municipality	Lekwa-Teemane												
Topo-cadastral map	2725CC												
Farm name	Remaining extent of Portion 1 of the farm Kaffraria 314HO												
Closest town	Christiana												
Coordinates	Centre point (approximately)												
	<table border="1" style="width: 100%; text-align: center;"> <tr> <th>No</th> <th>Latitude</th> <th>Longitude</th> <th>No</th> <th>Latitude</th> <th>Longitude</th> </tr> <tr> <td>1</td> <td></td> <td></td> <td></td> <td></td> <td></td> </tr> </table>	No	Latitude	Longitude	No	Latitude	Longitude	1					
No	Latitude	Longitude	No	Latitude	Longitude								
1													

Development criteria in terms of Section 38(1) of the NHR Act	Yes/No
Construction of road, wall, power line, pipeline, canal or other linear form of development or barrier exceeding 300m in length	No
Construction of bridge or similar structure exceeding 50m in length	No
Development exceeding 5000 sq m	Yes
Development involving three or more existing erven or subdivisions	No
Development involving three or more erven or divisions that have been consolidated within past five years	No
Rezoning of site exceeding 10 000 sq m	No
Any other development category, public open space, squares, parks, recreation grounds	No

Development criteria in terms of Section 38(1) of the NHR Act	Yes/No
Construction of road, wall, power line, pipeline, canal or other linear form of development or barrier exceeding 300m in length	No
Construction of bridge or similar structure exceeding 50m in length	No
Development exceeding 5000 sq m	Yes
Development involving three or more existing erven or subdivisions	No
Development involving three or more erven or divisions that have been consolidated within past five years	No
Rezoning of site exceeding 10 000 sq m	No
Any other development category, public open space, squares, parks, recreation grounds	No

Land use	
Previous land use	Farming (grazing and crop planting)
Current land use	Farming (grazing)

Previous land use	Farming (grazing and crop planting)
Current land use	Farming (grazing)

TABLE OF CONTENTS

	Page
LIST OF FIGURES.....	V
GLOSSARY OF TERMS AND ABBREVIATIONS.....	VI
1. INTRODUCTION.....	1
2. TERMS OF REFERENCE	1
3. LEGISLATIVE FRAMEWORK.....	2
4. HERITAGE RESOURCES.....	3
5. STUDY APPROACH AND METHODOLOGY	4
6. SITE SIGNIFICANCE AND ASSESSMENT	6
7. PROJECT DESCRIPTION.....	8
8. DESCRIPTION OF THE AFFECTED ENVIRONMENT	10
9. MANAGEMENT MEASURES.....	17
10. RECOMMENDATIONS.....	18
11. REFERENCES.....	21
APPENDIX 1. INDEMNITY AND TERMS OF USE OF THIS REPORT	23
APPENDIX 2. SPECIALIST COMPETENCY.....	24
APPENDIX 3. CONVENTIONS USED TO ASSESS THE SIGNIFICANCE OF HERITAGE RESOURCES	25
APPENDIX 4. RELEVANT LEGISLATION.....	27
APPENDIX 5. RELOCATION OF GRAVES	29
APPENDIX 6. INVENTORY OF IDENTIFIED CULTURAL HERITAGE SITES.....	30
APPENDIX 7. IMPACT TABLES	35

LIST OF FIGURES

	Page
Fig. 1. Map indicating the track log (green) of the field survey.	5
Fig. 2. Location of the study area in regional context.	8
Fig. 3. Layout of the proposed development.	9
Fig. 4. Views over the study area.....	11
Fig. 5. Existing structures (main house and barn) on the farm.	11
Fig. 6. Aerial view of the study area.....	11
Fig. 7. Map: Plan of the Mining District of Klerksdorp (1908).	13
Fig. 8. Location of the identified sites.....	14

GLOSSARY OF TERMS AND ABBREVIATIONS

TERMS

Stone Age: The first and longest part of human history is the Stone Age, which began with the appearance of early humans between 3-2 million years ago. Stone Age people were hunters, gatherers and scavengers who did not live in permanently settled communities. Their stone tools preserve well and are found in most places in South Africa and elsewhere.

Early Stone Age	2 000 000 - 150 000 Before Present
Middle Stone Age	150 000 - 30 000 BP
Later Stone Age	30 000 - until c. AD 200

Iron Age: Period covering the last 1800 years, when new people brought a new way of life to southern Africa. They established settled villages, cultivated domestic crops such as sorghum, millet and beans, and they herded cattle as well as sheep and goats. As they produced their own iron tools, archaeologists call this the Iron Age.

Early Iron Age	AD 200 - AD 900
Middle Iron Age	AD 900 - AD 1300
Later Iron Age	AD 1300 - AD 1830

Historical Period: Since the arrival of the white settlers - c. AD 1840 - in this part of the country.

Cumulative impacts: "Cumulative Impact", in relation to an activity, means the past, current and reasonably foreseeable future impact of an activity, considered together with the impact of activities associated with that activity, that in itself may not be significant, but may become significant when added to existing and reasonably foreseeable impacts eventuating from similar or diverse activities.

Mitigation, means to anticipate and prevent negative impacts and risks, then to minimise them, rehabilitate or repair impacts to the extent feasible.

ABBREVIATIONS

ADRC	Archaeological Data Recording Centre
ASAPA	Association of Southern African Professional Archaeologists
CS-G	Chief Surveyor-General
EIA	Early Iron Age
ESA	Early Stone Age
LIA	Late Iron Age
LSA	Later Stone Age
HIA	Heritage Impact Assessment
MSA	Middle Stone Age
NASA	National Archives of South Africa
NHRA	National Heritage Resources Act
PHRA	Provincial Heritage Resources Agency
SAHRA	South African Heritage Resources Agency

Phase 1 Cultural Heritage Impact Assessment:**PROSPECTING RIGHT APPLICATION OF DIAMONDS ALLUVIAL AND DIAMONDS GENERAL NEAR CHRISTIANA ON THE REMAINING EXTENT OF PORTION 1 OF THE FARM KAFFRARIA 314HO, LEKWA-TEEMANE LOCAL MUNICIPALITY, NORTH WEST PROVINCE****1. INTRODUCTION**

Milnex 189 CC was contracted by **Chrismar Delwerye (Pty) Ltd** as the independent environmental consultant to undertake the Scoping and EIA process for a prospecting right for the prospecting of Diamond Alluvial and Diamond General near Christiana on the Remaining Extent of Portion 1 of the farm Kaffraria 314, Registration Division: HO, North West Province.

South Africa's heritage resources, also described as the 'national estate', comprise a wide range of sites, features, objects and beliefs. However, according to Section 27(18) of the National Heritage Resources Act (NHRA), No. 25 of 1999, no person may destroy, damage, deface, excavate, alter, remove from its original position, subdivide or change the planning status of any heritage site without a permit issued by the heritage resources authority responsible for the protection of such site.

In accordance with Section 38 of the NHRA, an independent heritage consultant was appointed by *Milnex 189 CC* to undertake a cultural heritage assessment to determine if the proposed prospecting activities for diamonds would have an impact on any sites, features or objects of cultural heritage significance.

This report forms part of the Environmental Impact Assessment (EIA) as required by the EIA Regulations in terms of the National Environmental Management Act, 1998 (Act No. 107 of 1998) as amended and is intended for submission to the South African Heritage Resources Agency (SAHRA).

2. TERMS OF REFERENCE

The aim of a full HIA investigation is to provide an informed heritage-related opinion about the proposed development by an appropriate heritage specialist. The objectives are to identify heritage resources (involving site inspections, existing heritage data and additional heritage specialists if necessary); assess their significances; assess alternatives in order to promote heritage conservation issues; and to assess the acceptability of the proposed development from a heritage perspective.

The result of this investigation is a heritage impact assessment report indicating the presence/ absence of heritage resources and how to manage them in the context of the proposed development.

Depending on SAHRA's acceptance of this report, the developer will receive permission to proceed with the proposed development, on condition of successful implementation of proposed mitigation measures.

2.1 Scope of work

The aim of this study is to determine if any sites, features or objects of cultural heritage significance occur within the boundaries of the area where the diamond prospecting activities is to take place. This includes:

- Conducting a desk-top investigation of the area;
- A visit to the proposed development site,

The objectives were to:

- Identify possible archaeological, cultural and historic sites within the proposed development areas;
- Evaluate the potential impacts of construction, operation and maintenance of the proposed development on archaeological, cultural and historical resources;
- Recommend mitigation measures to ameliorate any negative impacts on areas of archaeological, cultural or historical importance.

2.2 Limitations

The investigation has been influenced by the following factors:

- It is assumed that the description of the proposed project, provided by the client, is accurate.
- No subsurface investigation (i.e. excavations or sampling) were undertaken, since a permit from SAHRA is required for such activities.
- It is assumed that the public consultation process undertaken as part of the Environmental Impact Assessment (EIA) is sufficient and that it does not have to be repeated as part of the heritage impact assessment.
- The unpredictability of buried archaeological remains.
- This report does not consider the palaeontological potential of the site.

3. LEGISLATIVE FRAMEWORK

The HIA is governed by national legislation and standards and International Best Practise. These include:

- South African Legislation
 - National Heritage Resources Act, 1999 (Act No. 25 of 1999) (NHRA) – see Appendix 4 for more detail on this Act
 - Mineral and Petroleum Resources Development Act, 2002 (Act No. 22 of 2002) (MPRDA);
 - National Environmental Management Act 1998 (Act No. 107 of 1998) (NEMA); and
 - National Water Act, 1998 (Act No. 36 of 1998) (NWA).
- Standards and Regulations
 - South African Heritage Resources Agency (SAHRA) Minimum Standards;
 - Association of Southern African Professional Archaeologists (ASAPA) Constitution and Code of Ethics;
 - Anthropological Association of Southern Africa Constitution and Code of Ethics.
- International Best Practise and Guidelines
 - ICOMOS Standards (Guidance on Heritage Impact Assessments for Cultural World Heritage Properties); and
 - The UNESCO Convention concerning the Protection of the World Cultural and Natural Heritage (1972).

4. HERITAGE RESOURCES

4.1 The National Estate

The NHRA (No. 25 of 1999) defines the heritage resources of South Africa which are of cultural significance or other special value for the present community and for future generations that must be considered part of the national estate to include:

- places, buildings, structures and equipment of cultural significance;
- places to which oral traditions are attached or which are associated with living heritage;
- historical settlements and townscapes;
- landscapes and natural features of cultural significance;
- geological sites of scientific or cultural importance;
- archaeological and palaeontological sites;
- graves and burial grounds, including-
 - ancestral graves;
 - royal graves and graves of traditional leaders;
 - graves of victims of conflict;
 - graves of individuals designated by the Minister by notice in the Gazette;
 - historical graves and cemeteries; and
 - other human remains which are not covered in terms of the Human Tissue Act, 1983 (Act No. 65 of 1983);
- sites of significance relating to the history of slavery in South Africa;
- movable objects, including-
 - objects recovered from the soil or waters of South Africa, including archaeological and palaeontological objects and material, meteorites and rare geological specimens;
 - objects to which oral traditions are attached or which are associated with living heritage;
 - ethnographic art and objects;
 - military objects;
 - objects of decorative or fine art;
 - objects of scientific or technological interest; and
 - books, records, documents, photographic positives and negatives, graphic, film or video material or sound recordings, excluding those that are public records as defined in section 1(xiv) of the National Archives of South Africa Act, 1996 (Act No. 43 of 1996).

4.2 Cultural significance

In the NHRA, Section 2 (vi), it is stated that “cultural significance” means aesthetic, architectural, historical, scientific, social, spiritual, linguistic or technological value or significance. This is determined in relation to a site or feature’s uniqueness, condition of preservation and research potential.

According to Section 3(3) of the NHRA, a place or object is to be considered part of the national estate if it has cultural significance or other special value because of

- its importance in the community, or pattern of South Africa's history;
- its possession of uncommon, rare or endangered aspects of South Africa's natural or cultural heritage;
- its potential to yield information that will contribute to an understanding of South Africa's natural or cultural heritage;
- its importance in demonstrating the principal characteristics of a particular class of South Africa's natural or cultural places or objects;
- its importance in exhibiting particular aesthetic characteristics valued by a community or cultural group;

- its importance in demonstrating a high degree of creative or technical achievement at a particular period;
- its strong or special association with a particular community or cultural group for social, cultural or spiritual reasons;
- its strong or special association with the life or work of a person, group or organisation of importance in the history of South Africa; and
- sites of significance relating to the history of slavery in South Africa.

A matrix was developed whereby the above criteria were applied for the determination of the significance of each identified site (see Appendix 3). This allowed some form of control over the application of similar values for similar identified sites.

5. STUDY APPROACH AND METHODOLOGY

5.1 Extent of the Study

This survey and impact assessment covers the area as presented in Section 7 below and illustrated in Figure 2 & 3.

5.2 Methodology

5.2.1.1 Survey of the literature

A survey of the relevant literature was conducted with the aim of reviewing the previous research done and determining the potential of the area. In this regard, various anthropological, archaeological and historical sources were consulted – see list of references in Section 11.

- Information on events, sites and features in the larger region were obtained from these sources.

5.2.1.2 Data bases

The *Heritage Atlas Database*, various SAHRA databases, the *Environmental Potential Atlas*, the *Chief Surveyor General* and the *National Archives of South Africa* were consulted.

- Database surveys produced a number of sites located in the larger region of the proposed development.

5.2.1.3 Other sources

Aerial photographs and topocadastral and other maps were also studied - see the list of references below.

- Information of a very general nature were obtained from these sources

5.2.1.4 Interviews

- Mr Fourie, current owner of the farm. Mr Fourie has been farming here since 1990 and knows the land and its conditions intimately. He also has a good understanding of the Stone Age and rock art (Stowlands is approximately 14 km from his farm).

The results of the above investigation are summarised in Table 1 below – see list of references in Section 11.

Table 1: Pre-Feasibility Assessment

Category	Period	Probability	Reference
Early hominin	Pliocene – Lower Pleistocene		
	Early hominin	None	
Stone Age	Lower Pleistocene – Holocene		
	Early Stone Age	None	
	Middle Stone Age	Low	
	Later Stone Age	Low	
	Rock Art	Medium	Fock & Fock (1984)
Iron Age	Holocene		
	Early Iron Age	None	
	Middle Iron Age	None	
	Later Iron Age	Medium	(Huffman 2007)
Colonial period	Holocene		
	Contact period	Medium	Burchell (1829); Campbell (1822); Harris (1852); Lye (1975); Moffat (1842)
	Recent history	Medium	Liebenberg (1990); Van den Bergh (1996);
	Industrial heritage	Medium	Van Schalkwyk (2016)

5.2.2 Field survey

The field survey was done according to generally accepted archaeological practices, and was aimed at locating all possible sites, objects and structures. The area that had to be investigated was identified by *Milnex 189 CC* by means of maps and *.kml* files indicating the development area. This was loaded onto an Asus device and used in Google Earth during the field survey to access the areas.

The site was visited on 22 September 2017. The site was investigated by walking some transects across it (see Fig. 1 below). Due to the dense grass cover, the very dry conditions and a strong north-westerly wind blowing on the day of the site visit, Mr Fourie, the land owner, was adamant that no vehicle would be allowed to drive on the farm.

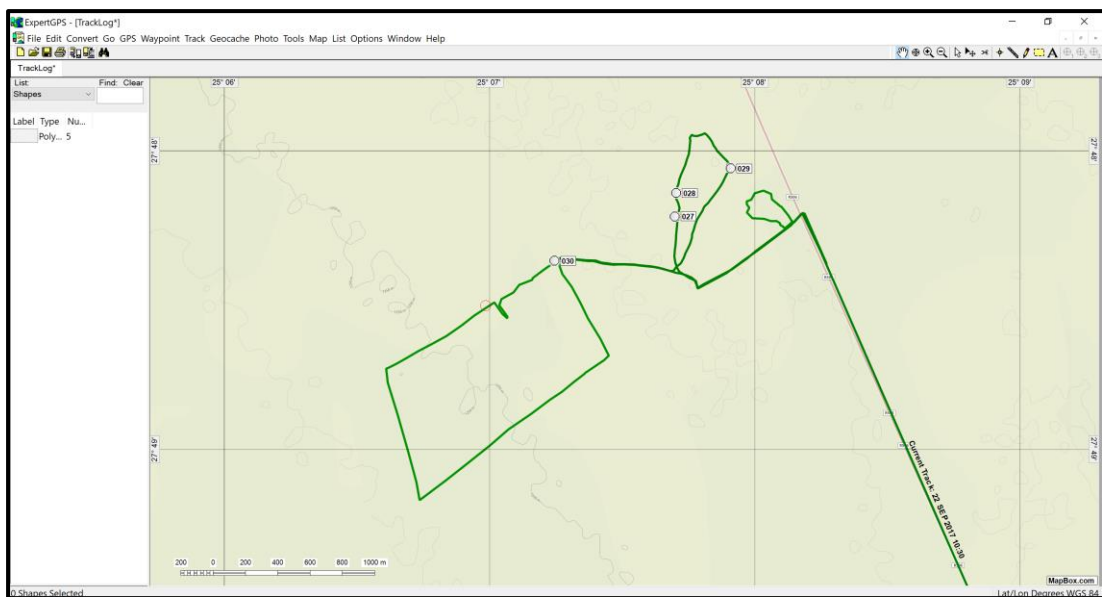

Fig. 1. Map indicating the track log (green) of the field survey.

5.2.3 Documentation

All sites, objects and structures that are identified are documented according to the general minimum standards accepted by the archaeological profession. Coordinates of individual localities are determined by means of the *Global Positioning System* (GPS) and plotted on a map. This information is added to the description in order to facilitate the identification of each locality.

The track log and identified sites were recorded by means of a Garmin Oregon 550 handheld GPS device. Photographic recording was done by means of a Canon EOS 550D digital camera.

Map datum used: Hartebeeshoek 94 (WGS84).

6. SITE SIGNIFICANCE AND ASSESSMENT

6.1 Heritage assessment criteria and grading

The National Heritage Resources Act, Act no. 25 of 1999, stipulates the assessment criteria and grading of heritage sites. The following grading categories are distinguished in Section 7 of the Act:

Table 2: Site Grading System.

SAHRA Cultural Heritage Site Significance			
Field Rating	Grade	Significance	Recommended Mitigation
National Significance	Grade I	High significance	Conservation by SAHRA, national site nomination, mention any relevant international ranking. No alteration whatsoever without permit from SAHRA
Provincial Significance	Grade II	High significance	Conservation by provincial heritage authority, provincial site nomination. No alteration whatsoever without permit from provincial heritage authority.
Local Significance	Grade III-A	High significance	Conservation by local authority, no alteration whatsoever without permit from provincial heritage authority. Mitigation as part of development process not advised.
Local Significance	Grade III-B	High significance	Conservation by local authority, no external alteration without permit from provincial heritage authority. Could be mitigated and (part) retained as heritage register site.
Generally Protected A	Grade IV-A	High/medium significance	Conservation by local authority. Site should be mitigated before destruction. Destruction permit required from provincial heritage authority.
Generally Protected B	Grade IV-B	Medium significance	Conservation by local authority. Site should be recorded before destruction. Destruction permit required from provincial heritage authority.
Generally Protected C	Grade IV-C	Low significance	Conservation by local authority. Site has been sufficiently recorded in the Phase 1 HIA. It requires no further recording before destruction. Destruction permit required from provincial heritage authority.

The occurrence of sites with a Grade I significance will demand that the development activities be drastically altered in order to retain these sites in their original state. For Grade II, III and IV sites, the applicable of mitigation measures would allow the development activities to continue.

6.2 Methodology for the assessment of potential impacts

All impacts identified during the EIA stage of the study will be classified in terms of their significance. Issues were assessed in terms of the following criteria:

- The **nature**, a description of what causes the effect, what will be affected and how it will be affected;
- The physical **extent**, wherein it is indicated whether:
 - 1 - the impact will be limited to the site;
 - 2 - the impact will be limited to the local area;
 - 3 - the impact will be limited to the region;
 - 4 - the impact will be national; or
 - 5 - the impact will be international;
- The **duration**, wherein it is indicated whether the lifetime of the impact will be:
 - 1 - of a very short duration (0–1 years);
 - 2 - of a short duration (2-5 years);
 - 3 - medium-term (5–15 years);
 - 4 - long term (> 15 years); or
 - 5 - permanent;
- The **magnitude** of impact, quantified on a scale from 0-10, where a score is assigned:
 - 0 - small and will have no effect;
 - 2 - minor and will not result in an impact;
 - 4 - low and will cause a slight impact;
 - 6 - moderate and will result in processes continuing but in a modified way;
 - 8 – high, (processes are altered to the extent that they temporarily cease); or
 - 10 - very high and results in complete destruction of patterns and permanent cessation of processes;
- The **probability** of occurrence, which describes the likelihood of the impact actually occurring and is estimated on a scale where:
 - 1 - very improbable (probably will not happen);
 - 2 - improbable (some possibility, but low likelihood);
 - 3 - probable (distinct possibility);
 - 4 - highly probable (most likely); or
 - 5 - definite (impact will occur regardless of any prevention measures);
- The **significance**, which is determined through a synthesis of the characteristics described above (refer formula below) and can be assessed as low, medium or high;
- The **status**, which is described as either positive, negative or neutral;
- The degree to which the impact can be reversed;
- The degree to which the impact may cause irreplaceable loss of resources; and
- The degree to which the impact can be mitigated.

The **significance** is determined by combining the criteria in the following formula:

$S = (E+D+M) \times P$; where
 S = Significance weighting
 E = Extent
 D = Duration
 M = Magnitude
 P = Probability

The **significance weightings** for each potential impact are calculated as follows:

Table 3: Significance Ranking

Significance of impact		
Points	Significant Weighting	Discussion
< 30 points	Low	Where this impact would not have a direct influence on the decision to develop in the area.
31-60 points	Medium	Where the impact could influence the decision to develop in the area unless it is effectively mitigated.

> 60 points	High	Where the impact must have an influence on the decision process to develop in the area.
-------------	-------------	---

7. PROJECT DESCRIPTION

7.1 Site location

The study area is located approximately 12 km north of the town of Christiana, adjacent to the R506 in North West Province (Fig. 2 below). For more information, see the Technical Summary on p. iv above.

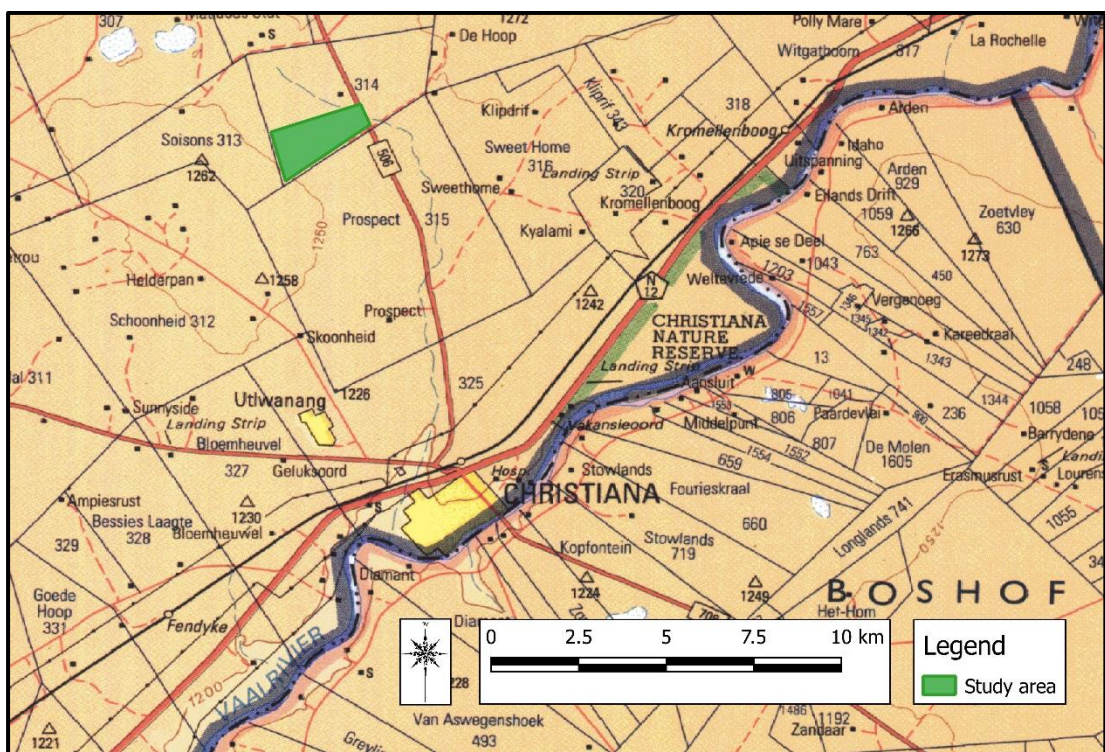

Fig. 2. Location of the study area in regional context. (Map 2724: Chief Surveyor-General)

7.2 Development proposal

- *The alluvial diamond mining methodology*

The process of alluvial diamond mining involves digging and sifting through mud, sand and gravel. Typically, diamonds come from geologic rock formations called Kimberlites. Kimberlite rock formations that contain diamonds are eroded over time by rivers and streams and can deposit diamonds in the sediments carried by those streams farther downstream from the original source rocks. These deposits are called alluvial diamond deposits. The locations of these alluvial diamond deposits are controlled by the surrounding topography, drainage patterns, and the location of the Kimberlites themselves.

Vegetation clearance takes place first from where stripping and stockpiling of topsoil. All topsoil (irrespective of depth) is stripped separately with an excavator and frond-end loader and stockpiled next to the first pit. The topsoil will be stored in such a way that the minimum runoff and erosion will emanate from it. The topsoil will be stored in a pile; around the pile surface runoff trenches will be constructed to divert any runoff around the pile. The topsoil will be used for final rehabilitation when mining has reached its end of life span. Concurrent rehabilitation will also be done.

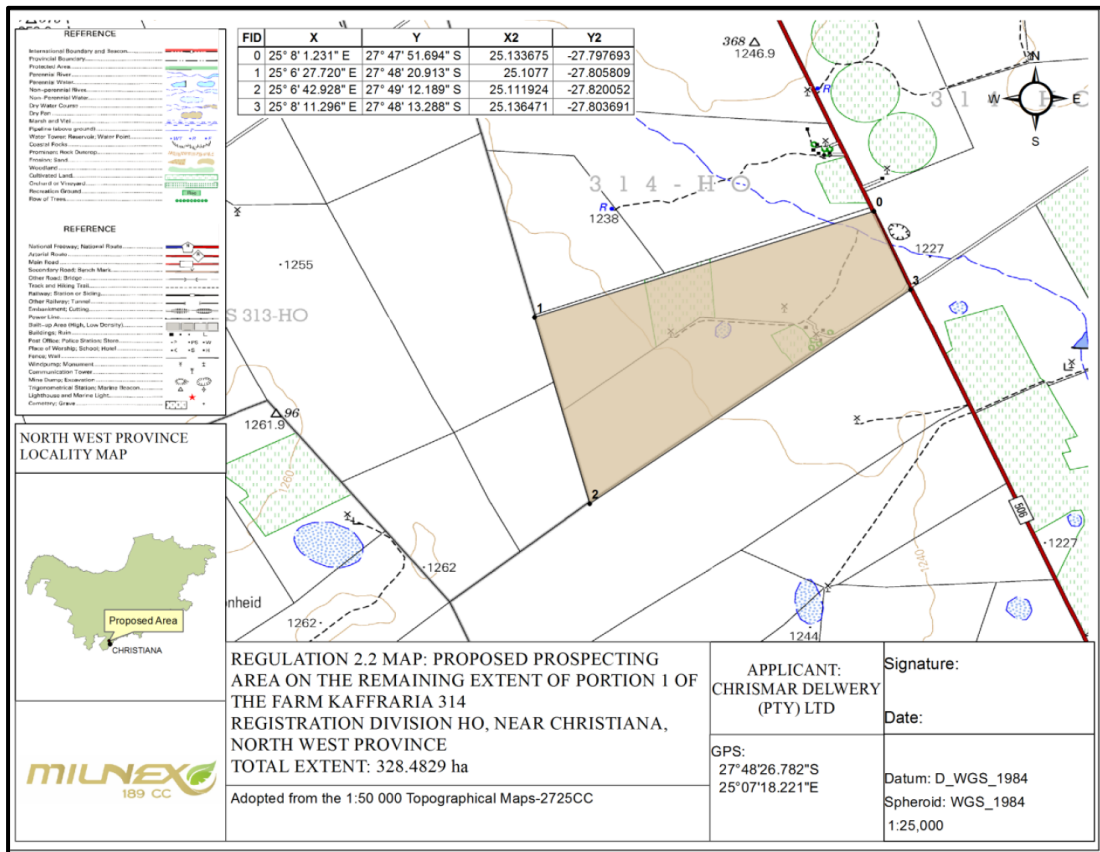

Fig. 3. Layout of the proposed development. (Image: Milnex 189 CC)

The following activities will be undertaken (taken from the Scoping Report compiled by Milnex 189 CC):

- Phase 1 - Site Visit (Month 0 - 3)

A formal site visit will be done within 90 days after the prospecting right was executed.

The applicant will appoint Dr Deon Tobias Vermaakt as the project geologist to conduct the site visit with him. It is foreseen that more than one site visit will be conducted. The purpose of the site visit shall be to familiarize the parties of the areas including the topography and the general geology before the invasive prospecting activities commence.

- Phase 2 - Desktop Studies (Month 4 - 6)

Desktop studies will be undertaken after a site investigation was done to determine the target areas including the identification of any infrastructure to be build and any potential problems that may need to be addressed.

- *Phase 3 – Pitting (Month 6 - 24)*

Pits will be positioned as determined by the geologist and after the geologist has assessed information obtained from the earlier prospecting activities.

It is envisaged that 100 pits will be dug. It may be less depending on results. 328.4829 Ha - 3m x 2m x 3m pit (100 pits). It is planned that 66.67 pits will be excavated in the first year, but it may be more if the process is quicker than planned for. It should be kept in mind that no more than 100 pits will be excavated.

The total area to be disturbed a year will be- 66.67 pits x (3m x2m) = 0.04 ha per year.

- *Phase 4 – Trenches (Month 25 - 42)*

The applicant will proceed with this way of prospecting by means of the open cast / trenching method, simultaneously or after pitting depending on the information obtained from the earlier work done. The trenches will be dug to remove and to wash the gravel. It will be washed by 1 x 16 feet washing pan to determine diamond proceeds per 100 ton of gravel.

It is envisaged that 40 trenches will be dug. It may be less depending on results. 328.4829 Ha - 30m x 20m x 3.5m pit (40 Trenches). It is planned that only 26.67 pits will be excavated in the first year, but it may be more if the process is quicker than planned for. It should be kept in mind that no more than 40 trenches will be excavated.

The total area to be disturbed a year will be- 26.67 pits x (30m x20m) = 1.6 ha per year.

No more than 1.64 ha will be left as un-rehabilitated in two years. Rehabilitation will be done concurrently.

- *Phase 5 - Consolidation and Interpretation of Results Data (Month 42 - 48)*

The project geologist shall monitor the program and consolidate and process the data and amend the program depending on the results received after each phase of prospecting. The DMR shall be updated of any amendments made. This shall be a continuous process throughout the prospecting work program.

8. DESCRIPTION OF THE AFFECTED ENVIRONMENT

8.1 Site description

The geology of the study area is made up of andesite, replaced by sand in the central part of the study area. This is the result of an ancient river that used to flow through the region. The original vegetation is classified as Dry Sandy Highveld Grassland, but has been impacted on due to having been used as agricultural fields over the western portion of the study area (Fig. 4). The topography is described as plains and pans.

According to Mr. Fourie, the current land owner, the existing farm buildings were erected by the previous farm owner, from whom he bought the farm in 1990 (Fig. 5). The buildings lack a definite style and does not exhibit any unique features. In addition, it is highly unlikely that the proposed diamond prospecting activities would have an impact on these buildings.

As this is a very small portion of the original farm Kaffraria, very little farming related structures occur on the site. The remains of old farm labourer structures were identified and will be described below (Section 8.3).



Fig. 4. Views over the study area.
(Note the dense grass cover)



Fig. 5. Existing structures (main house and barn) on the farm.

From the aerial photograph (Fig. 6 below), it can be seen that the western portion of the study area had been used for cultivation, which would have had a negative impact on any features that might have occurred there in the past.



Fig. 6. Aerial view of the study area.
(Image: Google Earth)

8.2 Overview of the region

The aim of this section is to present an overview of the history of the larger region in order to eventually determine the significance of heritage sites identified in the study area, within the context of their historic, aesthetic, scientific and social value, rarity and representivity – see Section 3.2 and Appendix 3 for more information.

The cultural landscape qualities of the region essentially consist of two components. The first is made up of a limited pre-colonial (Stone Age and Iron Age) occupation. The second component is a rural area in which the human occupation consists of two elements, being made up of a farming community and an urban element, rural towns and townships, most of which developed during the last 150 years.

8.2.1 Stone Age

Very little habitation of the central highveld area took place during Stone Age times. Tools dating to the Early Stone Age period are mostly found in the vicinity of larger watercourses, e.g. the Vaal River or the Harts River and especially in sheltered areas such as at the Taung fossil site. During Middle Stone Age (MSA) times (c. 150 000 – 30 000 BP), people became more mobile, occupying areas formerly avoided. In many cases, tools dating to this period are found on the banks of the many pans that occur all over. The MSA is a technological stage characterized by flakes and flake-blades with faceted platforms, produced from prepared cores, as distinct from the core tool-based ESA technology.

Late Stone Age (LSA) people had even more advanced technology than the MSA people and therefore succeeded in occupying even more diverse habitats. Some sites are known to occur in the region. These are mostly open sites located near river and pans. For the first time we also get evidence of people's activities derived from material other than stone tools. Ostrich eggshell beads, ground bone arrowheads, small bored stones and wood fragments with incised markings are traditionally linked with the LSA.

A number of rock engraving sites dating to the Later Stone Age are known to exist, or used to exist, in the region on the northern side of the Vaal River - across the Vaal River on the Free State side of Christiana is a well-known engraving site on the farm Stowlands, containing engravings dating to different periods, as well as graffiti dating to the Second South African War. Fock & Fock (1989) indicate the existence of a number of other sites in the larger region.

8.2.2 Iron Age

Iron Age people started to settle in southern Africa c. AD 300, with one of the oldest known sites at Broederstroom south of Hartebeespoort Dam dating to AD 470. Having only had cereals (sorghum, millet) that need summer rainfall, Early Iron Age (EIA) people did not move outside this rainfall zone, and neither did they occupy the central interior highveld area.

As yet, no sites dating to the Early Iron Age have been reported from the region and most sites date to the Late Iron Age. The occupation of the larger geographical area (including the study area) did not start much before the 1500s. By the 16th century things changed, with the climate becoming warmer and wetter, creating conditions that allowed Late Iron Age (LIA) farmers to occupy areas previously unsuitable, for example the treeless plains of the Free State.

According to Breutz (1959) stone walled sites dating to the Late Iron Age and which can be linked to the Tswana occupation of the area, are found on a number of farms in the region, e.g. Waai Hoek and Brul Pan. However, the historic most important one, named Dithakong, is

located some distance to the north-west. This site was first visited by early travellers such as Lichtenstein and John Campbell in the early part of the 19th century.

The earliest Iron Age settlers who moved into the North West Province region were Tswana-speakers such as the Tlhaping, Hurutshe, Fokeng, Kgatla and Rolong. In the region of the study area, it was mostly the booRapulana and booRatlou sections of the Rolong (Breutz 1959).

8.2.3 Historic period

Many early travellers, hunters and missionaries (Burchell 1824, Campbell 1822, Smith 1834-1836 (Lye 1975), Moffat 1842 and Harris 1852) either passed through the area or close to it. Their writings leave us a tantalising description of what life was in these communities before large-scale interaction with white settlers took place. Some of the first whites to settle here were the missionaries Samuel Broadbent and Thomas Hodgson, who settled some distance to the east of what later became known as Wolmaransstad.

The town of Christiana was established on the farm Zoutpanndrift in 1895 and became a municipality in 1904. It was named in honour of the daughter of MW Pretorius, first president of the South African Republic (ZAR) (Raper 2004:55).

Diamond were discovered in 1872 in the vicinity of Christiana, and again in 1891 and in 1903 the town became the centre of a diamond rush. The early proclamation of the various diggings are indicated in the map in Fig. X below.

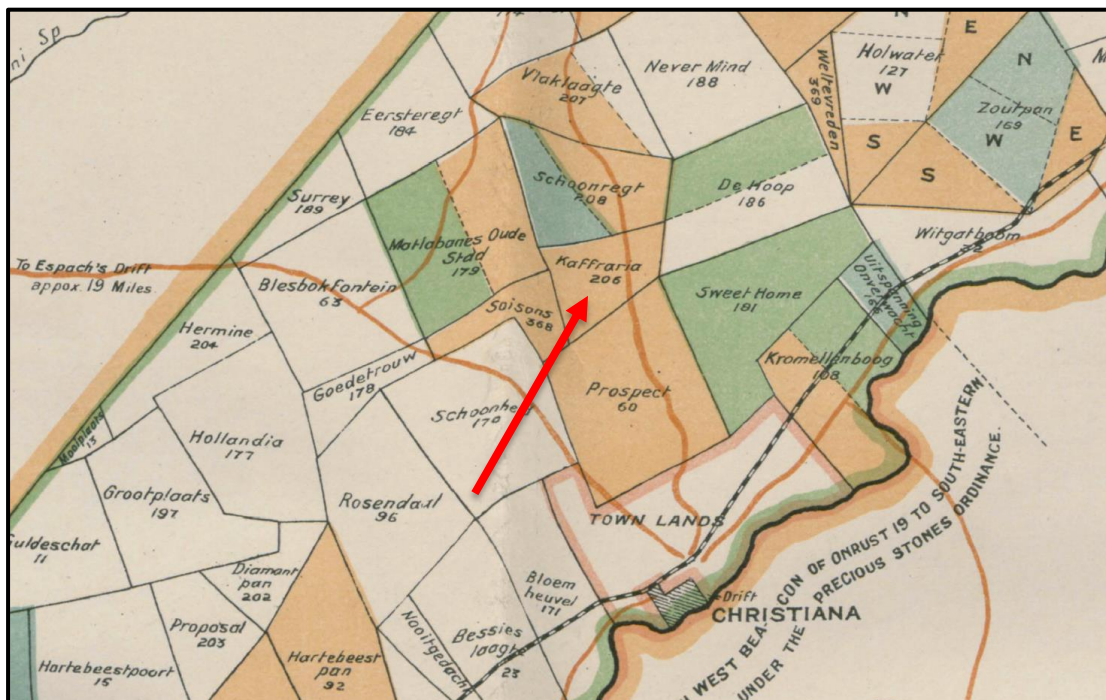

Fig. 7. Map: Plan of the Mining District of Klerksdorp (1908).
(Blue: Government Unproclaimed Ground; Green: Crown Land Open for Disposal; Yellow: Crown Land Alienated)

As it is located on the Vaal River, the railway line passing through the region played an important role during the Anglo Boer War (1899-1902). Blockhouses were erected by the British to protect the railway line and bridges across the river. The blockhouses were built Royal Engineers from masonry (Tomlinson 1997). A single blockhouse is said to exist on the

farm Stowlands south of the Vaal River. It was here that Gen. Sir A. Hunter crossed the Vaal River during the Second South African War, the first British general to cross into the Transvaal.

8.3 Identified sites

The following sites, features and objects of cultural significance were identified in the study area – see Appendix 6 for a discussion of each individual site.

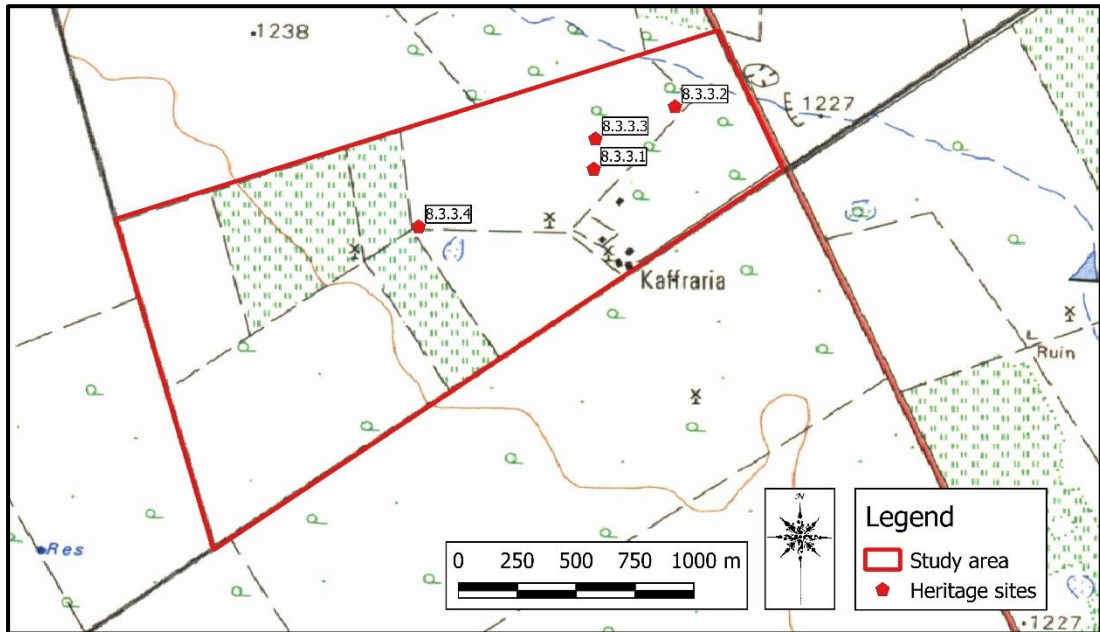

Fig. 8. Location of the identified sites.
(Map 2725CC: Chief Surveyor-General)

In terms of Section 7 of the NHRA, all the sites currently known or which are expected to occur in the study area are evaluated to have a grading as identified in the table below.

Table 4. Summary of Identified Heritage Resources in the Study Area.

IDENTIFIED HERITAGE RESOURCES			
NHRA category	Number	Coordinates	Impact rating
<i>Formal protections (NHRA)</i>			
National heritage site (Section 27)	None	-	-
Provincial heritage site (Section 27)	None	-	-
Provisional protection (Section 29)	None	-	-
Listed in heritage register (Section 30)	None	-	-
<i>General protections (NHRA)</i>			
Structures older than 60 years (Section 34)	8.3.3.1	-27.80367, 25.12831	Medium
	8.3.3.2	-27.80099, 25.13181	Medium
	8.3.3.4	-27.80615, 25.12076	Medium
Archaeological site or material (Section 35)	8.3.1.1	General	Low
Palaeontological site or material (Section 35)	None	-	-
Graves or burial grounds (Section 36)	8.3.3.3	-27.80237, 25.12838	Medium
Public monuments or memorials (Section 37)	None	-	-
<i>Other</i>			
Any other heritage resources (describe)	None	-	-

8.3.1 Stone Age

- Scattered surface occurrences of Middle and possible Late Stone Age stone tools, cores and flakes were identified in a few areas across the prospecting area, but no habitation or tool processing areas were identified. The density of tools has been calculated to be less than 1 tool/flake per 100m².
 - This feature has Low local significance – Grade IV-C

8.3.2 Iron Age

- No sites, features or objects dating to the Iron Age were identified in the study area.

8.3.3 Historic period

- (8.3.3.1) The ruins of an old homestead, consisting of the foundation of the structure, build with locally quarried limestone blocks.
 - This feature has Low local significance – Grade IV-C
- (8.3.3.2) The ruins of an old homestead, consisting of the foundation of the structure, build with locally quarried limestone blocks.
 - This feature has Low local significance – Grade IV-C
- (8.3.3.3) A small informal burial place. Due to the tall grass cover it was not possible to get a definite count of the number of graves. Two have headstones with the dates ranging between 1963 and 1978.
 - This feature has High/medium local significance – Grade IV-A
- (8.3.3.4) The ruins of a well-built rectangular structure of stone, with a doorway facing east. It is approximately 4 x 2,5 metres in size. A short distance to the north west a circular structure, also built with stone occurs. It is approximately 1,5 metres in diameter.
 - This feature has Medium local significance – Grade IV-B

8.4 Impact assessment

Heritage impacts are categorised as:

- Direct or physical impacts, implying alteration or destruction of heritage features within the project boundaries;
- Indirect impacts, e.g. restriction of access or visual intrusion concerning the broader environment;
- Cumulative impacts that are combinations of the above.

Impacts can be managed through one or a combination of the following measures:

- Mitigation
- Avoidance
- Compensation
- Enhancement (positive impacts)
- Rehabilitation
- Interpretation
- Memorialisation

Sources of risk were considered with regards to development activities defined in Section 2(viii) of the NHRA that may be triggered and are summarised in Table 5 below. These issues formed the basis of the impact assessment described. The potential risks are discussed according to the various phases of the project below.

Table 5. Potential Risk Sources.

	Activity	Description	Risk
Issue 1	Removal of Vegetation	Vegetation removal for site preparation and the installation of required infrastructure, e.g. access roads and water pipelines.	The identified risk is damage or changes to resources that are generally protected in terms of Sections 27, 28, 31, 32, 34, 35, 36 and 37 of the NHRA that may occur in the proposed project area.
Issue 2	Construction of required infrastructure, e.g. access roads, water pipelines	Construction machinery and vehicles will be utilised to construct the required infrastructure, e.g. access roads and water pipelines.	The identified risk is damage or changes to resources that are generally protected in terms of Sections 27, 28, 31, 32, 34, 35, 36 and 37 of the NHRA that may occur in the proposed project area.
Issue 3	Stockpiling of topsoil	Soil from prospecting areas will be accommodated in designated spots to be returned to point of origin after completion of prospecting.	The identified risk is damage or changes to resources that are generally protected in terms of Sections 27, 28, 31, 32, 34, 35, 36 and 37 of the NHRA that may occur in the proposed project area.

Impact analysis of cultural heritage resources under threat of the proposed development, is based on the present understanding of the development and is presented in Appendix 7 and summarised in Table 6 below:

Impact assessment:

- (8.3.1.1) Scattered surface occurrences of Middle and Late Stone Age stone tools and flakes were identified in a few areas across the prospecting area.
 - Impact = None - the significance weighting for the impact on the identified sites is rated as **low**.
 - Mitigation: None required.
- (8.3.3.1) The ruins of an old homestead, consisting of the foundation of the structure, build with locally quarried limestone blocks.
 - Impact = the significance weighting for the impact on the identified sites is rated as **medium**.
 - Mitigation: None required.
- (8.3.3.2) The ruins of an old homestead, consisting of the foundation of the structure, build with locally quarried limestone blocks.
 - Impact = the significance weighting for the impact on the identified sites is rated as **medium**.
 - Mitigation: None required.
- (8.3.3.3) A small informal burial place. Due to the tall grass cover it was not possible to get a definite count of the number of graves. Two have headstones with the dates ranging between 1963 and 1978.
 - Impact = the significance weighting for the impact on the identified sites is rated as **medium**.
 - Mitigation: Avoid site, maintain buffer zone of 5 metres demarcated with wire fencing.
- (8.3.3.4) The ruins of a well-built rectangular structure of stone, with a doorway facing east. A short distance to the north west a circular structure, also built with stone occurs.

- Impact = the significance weighting for the impact on the identified sites is rated as **medium**.
 - Mitigation: Avoid site, maintain buffer zone of 5 metres demarcated with wire fencing. It is recommended that this feature is retained. If that is not possible and it must be demolished, it should be documented (excavated and mapped) in full prior to prospecting activities taking place.

Table 6: Impacts on identified Heritage Sites

Heritage sites	Significance of impact	Mitigation measures
Kaffraria Diamond Prospecting: Construction Phase		
Without mitigation	Medium	Avoid site
With mitigation	Low	Avoid site
Kaffraria Diamond Prospecting: Operation Phase		
Without mitigation	n/a	n/a
With mitigation	n/a	n/a

8.5 Alternatives considered

No alternatives were considered.

9. MANAGEMENT MEASURES

Heritage sites are fixed features in the environment, occurring within specific spatial confines. Any impact upon them is permanent and non-reversible. Those resources that cannot be avoided and that are directly impacted by the proposed development can be excavated/recorded and a management plan can be developed for future action. Those sites that are not impacted on can be written into the management plan, whence they can be avoided or cared for in the future.

9.1 Objectives

- Protection of archaeological, historical and any other site or land considered being of cultural value within the project boundary against vandalism, destruction and theft.
- The preservation and appropriate management of new discoveries in accordance with the NHRA, should these be discovered during construction activities.

The following shall apply:

- Known sites should be clearly marked in order that they can be avoided during construction activities.
- The contractors and workers should be notified that archaeological sites might be exposed during the construction activities.
- Should any heritage artefacts be exposed during excavation, work on the area where the artefacts were discovered, shall cease immediately and the Environmental Control Officer shall be notified as soon as possible;
- All discoveries shall be reported immediately to a heritage practitioner so that an investigation and evaluation of the finds can be made. Acting upon advice from these specialists, the Environmental Control Officer will advise the necessary actions to be taken;

- Under no circumstances shall any artefacts be removed, destroyed or interfered with by anyone on the site; and
- Contractors and workers shall be advised of the penalties associated with the unlawful removal of cultural, historical, archaeological or palaeontological artefacts, as set out in the National Heritage Resources Act (Act No. 25 of 1999), Section 51. (1).

9.2 Control

In order to achieve this, the following should be in place:

- A person or entity, e.g. the Environmental Control Officer, should be tasked to take responsibility for the heritage sites and should be held accountable for any damage.
- Known sites should be located and isolated, e.g. by fencing them off. All construction workers should be informed that these are no-go areas, unless accompanied by the individual or persons representing the Environmental Control Officer as identified above.
- In areas where the vegetation is threatening the heritage sites, e.g. growing trees pushing walls over, it should be removed, but only after permission for the methods proposed has been granted by SAHRA. A heritage official should be part of the team executing these measures.

10. RECOMMENDATIONS

Milnex 189 CC was contracted by **Chrismar Delwerye (Pty) Ltd** as the independent environmental consultant to undertake the Scoping and EIA process for a prospecting right for the prospecting of Diamond Alluvial and Diamond General near Christiana on the Remaining Extent of Portion 1 of the farm Kaffraria 314HO, North West Province.

The cultural landscape qualities of the region essentially consist of two components. The first is made up of a limited pre-colonial (Stone Age and Iron Age) occupation. The second component is a rural area in which the human occupation consists of two elements, being made up of a farming community and an urban element, rural towns and townships, most of which developed during the last 150 years.

Identified heritage sites

- (8.3.1.1) Scattered surface occurrences of Middle and possible Late Stone Age stone tools, cores and flakes were identified in a few areas across the prospecting area, but no habitation or tool processing areas were identified. The density of tools has been calculated to be less than 1 tool/flake per 100m².
 - This feature has Low local significance – Grade IV-C
- (8.3.3.1) The ruins of an old homestead, consisting of the foundation of the structure, build with locally quarried limestone blocks.
 - This feature has Low local significance – Grade IV-C
- (8.3.3.2) The ruins of an old homestead, consisting of the foundation of the structure, build with locally quarried limestone blocks.
 - This feature has Low local significance – Grade IV-C
- (8.3.3.3) A small informal burial place. Due to the tall grass cover it was not possible to get a definite count of the number of graves. Two have headstones with the dates ranging between 1963 and 1978.
 - This feature has High/medium local significance – Grade IV-A

- (8.3.3.4) The ruins of a well-built rectangular structure of stone, with a doorway facing east. It is approximately 4 x 2,5 metres in size. A short distance to the north west a circular structure, also built with stone occurs. It is approximately 1,5 metres in diameter.
 - This feature has Medium local significance – Grade IV-B

Impact assessment

- (8.3.1.1) Scattered surface occurrences of Middle and Late Stone Age stone tools and flakes were identified in a few areas across the prospecting area.
 - Impact = None - the significance weighting for the impact on the identified sites is rated as **low**.
 - Mitigation: None required.
- (8.3.3.1) The ruins of an old homestead, consisting of the foundation of the structure, build with locally quarried limestone blocks.
 - Impact = the significance weighting for the impact on the identified sites is rated as **medium**.
 - Mitigation: None required.
- (8.3.3.2) The ruins of an old homestead, consisting of the foundation of the structure, build with locally quarried limestone blocks.
 - Impact = the significance weighting for the impact on the identified sites is rated as **medium**.
 - Mitigation: None required.
- (8.3.3.3) A small informal burial place. Due to the tall grass cover it was not possible to get a definite count of the number of graves. Two have headstones with the dates ranging between 1963 and 1978.
 - Impact = the significance weighting for the impact on the identified sites is rated as **medium**.
 - Mitigation: Avoid site, maintain buffer zone of 5 metres demarcated with wire fencing.
- (8.3.3.4) The ruins of a well-built rectangular structure of stone, with a doorway facing east. A short distance to the north west a circular structure, also built with stone occurs.
 - Impact = the significance weighting for the impact on the identified sites is rated as **medium**.
 - Mitigation: Avoid site, maintain buffer zone of 5 metres demarcated with wire fencing. It is recommended that this feature is retained. If that is not possible and it must be demolished, it should be documented (excavated and mapped) in full prior to prospecting activities taking place.

Heritage sites	Significance of impact	Mitigation measures
Kaffraria Diamond Prospecting: Construction Phase		
Without mitigation	Medium	n/a
With mitigation	Low	n/a
Kaffraria Diamond Prospecting: Operation Phase		
Without mitigation	n/a	n/a
With mitigation	n/a	n/a

Reasoned opinion as to whether the proposed activity should be authorised:

- From a heritage point of view it is recommended that the proposed development be allowed to continue on acceptance of the proposed mitigation measures.

Conditions for inclusion in the environmental authorisation:

- Should archaeological sites or graves be exposed during construction work, it must immediately be reported to a heritage practitioner so that an investigation and evaluation of the finds can be made.

11. REFERENCES

11.1 Data bases

Chief Surveyor General
Environmental Potential Atlas, Department of Environmental Affairs and Tourism.
Heritage Atlas Database, Pretoria
National Archives of South Africa
SAHRA Archaeology and Palaeontology Report Mapping Project (2009)
SAHRIS Database

11.2 Literature

Acocks, J.P.H. 1975. *Veld Types of South Africa*. Memoirs of the Botanical Survey of South Africa, No. 40. Pretoria: Botanical Research Institute.

Bergh, J.S. (red.). 1998. *Geskiedenisatlas van Suid-Afrika: die vier noordelike provinsies*. Pretoria: J.L. Schaik.

Breutz, P-L. 1959. The tribes of Vryburg district. Ethnological Publications No. 46. Pretoria: Government Printer

Burchell W.J. 1824. *Travels in the interior of southern Africa*. 2 Vols. London: Longman, Hurst, Rees, Orme, Brown and Green.

Campbell, J. 1822. *Travels in South Africa, being a narrative of a second journey (1820)*. 2 Vols. London: Westley.

Fock, G.J. & Fock, D. 1984. *Feldsbilder in Sudafrica. Teil II. Kinderdam und Kalahari*. Koln: Bohlau Verlag.

Harris, W.C. 1852. *The wild sports of southern Africa*. London: Henry G Bohn.

Huffman, T.N. 2007. *Handbook to the Iron Age*. Scottsville: University of KwaZulu-Natal Press.

Liebenberg, M.M.B. 1990. *Schweizer-Reneke*. Pretoria: Raad vir Geesteswetenskaplike Navorsing.

Lye, W.F. 1975. *Andrew Smith's Journal of his expedition into the interior of South Africa: 1834-1836*. Cape Town: A.A. Balkema.

Lye, W.F. & Murray, C. 1980. *Transformations on the Highveld: the Tswana and Southern Sotho*. Cape Town: David Philip.

Moffat, R. 1842. *Missionary labours and scenes in southern Africa*. London: John Snow.

Norman, N. & Whitfield, G. 2006. *Geological Journeys*. Cape Town: Struik Publishers

Van den Bergh, G. 1996. *24 Battles and Battle Fields of the North West Province*. Potchefstroom: The North West Tourism Association.

Van Schalkwyk, J. 2016. *Cultural heritage impact assessment for the proposed diamond mining development on Portion 1 of the farm Kameelkuil 88HO, Mamusa Local Municipality, Schweizer-Reneke region, North West Province*. Pretoria: Unpublished report 2016/JvS/021

11.3 Maps and aerial photographs

1: 50 000 Topocadastral maps
Google Earth

APPENDIX 1. INDEMNITY AND TERMS OF USE OF THIS REPORT

The findings, results, conclusions and recommendations given in this report are based on the author's best scientific and professional knowledge as well as available information. The report is based on survey and assessment techniques which are limited by time and budgetary constraints relevant to the type and level of investigation undertaken and the author reserve the right to modify aspects of the report including the recommendations if and when new information may become available from ongoing research or further work in this field, or pertaining to this investigation.

Although all possible care is taken to identify all sites of cultural importance during the investigation of study areas, it is always possible that hidden or sub-surface sites could be overlooked during the study. The author of this report will not be held liable for such oversights or for costs incurred as a result of such oversights.

Although the author exercises due care and diligence in rendering services and preparing documents, he accepts no liability and the client, by receiving this document, indemnifies the author against all actions, claims, demands, losses, liabilities, costs, damages and expenses arising from or in connection with services rendered, directly or indirectly by the author and by the use of the information contained in this document.

This report must not be altered or added to without the prior written consent of the author. This also refers to electronic copies of this report which are supplied for the purposes of inclusion as part of other reports, including main reports. Similarly, any recommendations, statements or conclusions drawn from or based on this report must make reference to this report. If these form part of a main report relating to this investigation or report, this report must be included in its entirety as an appendix or separate section to the main report.

APPENDIX 2. SPECIALIST COMPETENCYJohan (Johnny) van Schalkwyk

J A van Schalkwyk, D Litt et Phil, heritage consultant, has been working in the field of heritage management for more than 40 years. Originally based at the National Museum of Cultural History, Pretoria, he has actively done research in the fields of anthropology, archaeology, museology, tourism and impact assessment. This work was done in Limpopo Province, Gauteng, Mpumalanga, North West Province, Eastern Cape, Northern Cape, Botswana, Zimbabwe, Malawi, Lesotho and Swaziland. Based on this work, he has curated various exhibitions at different museums and has published more than 70 papers, most in scientifically accredited journals. During this period he has done more than 2000 impact assessments (archaeological, anthropological, historical and social) for various government departments and developers. Projects include environmental management frameworks, roads, pipeline-, and power line developments, dams, mining, water purification works, historical landscapes, refuse dumps and urban developments.

A complete *curriculum vitae* can be supplied on request.

APPENDIX 3. CONVENTIONS USED TO ASSESS THE SIGNIFICANCE OF HERITAGE RESOURCES

A system for site grading was established by the NHRA and further developed by the South African Heritage Resources Agency (SAHRA 2007) and has been approved by ASAPA for use in southern Africa and was utilised during this assessment.

Significance

According to the NHRA, Section 2(vi) the **significance** of a heritage sites and artefacts is determined by it aesthetic, architectural, historical, scientific, social, spiritual, linguistic or technical value in relation to the uniqueness, condition of preservation and research potential. It must be kept in mind that the various aspects are not mutually exclusive, and that the evaluation of any site is done with reference to any number of these.

Matrix used for assessing the significance of each identified site/feature

1. SITE EVALUATION				
1.1 Historic value				
Is it important in the community, or pattern of history				
Does it have strong or special association with the life or work of a person, group or organisation of importance in history				
Does it have significance relating to the history of slavery				
1.2 Aesthetic value				
It is important in exhibiting particular aesthetic characteristics valued by a community or cultural group				
1.3 Scientific value				
Does it have potential to yield information that will contribute to an understanding of natural or cultural heritage				
Is it important in demonstrating a high degree of creative or technical achievement at a particular period				
1.4 Social value				
Does it have strong or special association with a particular community or cultural group for social, cultural or spiritual reasons				
1.5 Rarity				
Does it possess uncommon, rare or endangered aspects of natural or cultural heritage				
1.6 Representivity				
Is it important in demonstrating the principal characteristics of a particular class of natural or cultural places or objects				
Importance in demonstrating the principal characteristics of a range of landscapes or environments, the attributes of which identify it as being characteristic of its class				
Importance in demonstrating the principal characteristics of human activities (including way of life, philosophy, custom, process, land-use, function, design or technique) in the environment of the nation, province, region or locality.				
2. Sphere of Significance		High	Medium	Low
International				
National				
Provincial				
Regional				
Local				
Specific community				
3. Field Register Rating				
1.	National/Grade 1: High significance - No alteration whatsoever without permit from SAHRA			
2.	Provincial/Grade 2: High significance - No alteration whatsoever without			

	permit from provincial heritage authority.	
3.	Local/Grade 3A: High significance - Mitigation as part of development process not advised.	
4.	Local/Grade 3B: High significance - Could be mitigated and (part) retained as heritage register site	
5.	Generally protected A: High/medium significance - Should be mitigated before destruction	
6.	Generally protected B: Medium significance - Should be recorded before destruction	
7.	Generally protected C: Low significance - Requires no further recording before destruction	

APPENDIX 4. RELEVANT LEGISLATION

All archaeological and palaeontological sites, and meteorites are protected by the National Heritage Resources Act (Act no 25 of 1999) as stated in Section 35:

(1) Subject to the provisions of section 8, the protection of archaeological and palaeontological sites and material and meteorites is the responsibility of a provincial heritage resources authority: Provided that the protection of any wreck in the territorial waters and the maritime cultural zone shall be the responsibility of SAHRA.

(2) Subject to the provisions of subsection (8)(a), all archaeological objects, palaeontological material and meteorites are the property of the State. The responsible heritage authority must, on behalf of the State, at its discretion ensure that such objects are lodged with a museum or other public institution that has a collection policy acceptable to the heritage resources authority and may in so doing establish such terms and conditions as it sees fit for the conservation of such objects.

(3) Any person who discovers archaeological or palaeontological objects or material or a meteorite in the course of development or agricultural activity must immediately report the find to the responsible heritage resources authority, or to the nearest local authority offices or museum, which must immediately notify such heritage resources authority.

(4) No person may, without a permit issued by the responsible heritage resources authority-

- (a) destroy, damage, excavate, alter, deface or otherwise disturb any archaeological or palaeontological site or any meteorite;
- (b) destroy, damage, excavate, remove from its original position, collect or own any archaeological or palaeontological material or object or any meteorite;
- (c) trade in, sell for private gain, export or attempt to export from the Republic any category of archaeological or palaeontological material or object, or any meteorite; or
- (d) bring onto or use at an archaeological or palaeontological site any excavation equipment or any equipment which assist in the detection or recovery of metals or archaeological and palaeontological material or objects, or use such equipment for the recovery of meteorites.

In terms of cemeteries and graves the following (Section 36):

(1) Where it is not the responsibility of any other authority, SAHRA must conserve and generally care for burial grounds and graves protected in terms of this section, and it may make such arrangements for their conservation as it sees fit.

(2) SAHRA must identify and record the graves of victims of conflict and any other graves which it deems to be of cultural significance and may erect memorials associated with the grave referred to in subsection (1), and must maintain such memorials.

(3) No person may, without a permit issued by SAHRA or a provincial heritage resources authority-

- (a) destroy, damage, alter, exhume or remove from its original position or otherwise disturb the grave of a victim of conflict, or any burial ground or part thereof which contains such graves;
- (b) destroy, damage, alter, exhume, remove from its original position or otherwise disturb any grave or burial ground older than 60 years which is situated outside a formal cemetery administered by a local authority; or
- (c) bring onto or use at a burial ground or grave referred to in paragraph (a) or (b) any excavation equipment, or any equipment which assists in the detection or recovery of metals.

(4) SAHRA or a provincial heritage resources authority may not issue a permit for the destruction or damage of any burial ground or grave referred to in subsection (3)(a) unless it is satisfied that the applicant has made satisfactory arrangements for the exhumation and re-interment of the contents of such graves, at the cost of the applicant and in accordance with any regulations made by the responsible heritage resources authority.

The National Heritage Resources Act (Act no 25 of 1999) stipulates the assessment criteria and grading of archaeological sites. The following categories are distinguished in Section 7 of the Act:

- **Grade I:** Heritage resources with qualities so exceptional that they are of special national significance;
- **Grade II:** Heritage resources which, although forming part of the national estate, can be considered to have special qualities which make them significant within the context of a province or a region; and
- **Grade III:** Other heritage resources worthy of conservation, and which prescribes heritage resources assessment criteria, consistent with the criteria set out in section 3(3), which must be used by a heritage resources authority or a local authority to assess the intrinsic, comparative and contextual significance of a heritage resource and the relative benefits and costs of its protection, so that the appropriate level of grading of the resource and the consequent responsibility for its management may be allocated in terms of section 8.

Presenting archaeological sites as part of tourism attraction requires, in terms 44 of the Act, a Conservation Management Plan as well as a permit from SAHRA.

(1) Heritage resources authorities and local authorities must, wherever appropriate, co-ordinate and promote the presentation and use of places of cultural significance and heritage resources which form part of the national estate and for which they are responsible in terms of section 5 for public enjoyment, education, research and tourism, including-

- (a) the erection of explanatory plaques and interpretive facilities, including interpretive centres and visitor facilities;
- (b) the training and provision of guides;
- (c) the mounting of exhibitions;
- (d) the erection of memorials; and
- (e) any other means necessary for the effective presentation of the national estate.

(2) Where a heritage resource which is formally protected in terms of Part I of this Chapter is to be presented, the person wishing to undertake such presentation must, at least 60 days prior to the institution of interpretive measures or manufacture of associated material, consult with the heritage resources authority which is responsible for the protection of such heritage resource regarding the contents of interpretive material or programmes.

(3) A person may only erect a plaque or other permanent display or structure associated with such presentation in the vicinity of a place protected in terms of this Act in consultation with the heritage resources authority responsible for the protection of the place.

APPENDIX 5. RELOCATION OF GRAVES

If the graves are younger than 60 years, an undertaker can be contracted to deal with the exhumation and reburial. This will include public participation, organising cemeteries, coffins, etc. They need permits and have their own requirements that must be adhered to.

If the graves are older than 60 years old or of undetermined age, an archaeologist must be in attendance to assist with the exhumation and documentation of the graves. This is a requirement by law.

Once it has been decided to relocate particular graves, the following steps should be taken:

- Notices of the intention to relocate the graves need to be put up at the burial site for a period of 60 days. This should contain information where communities and family members can contact the developer/archaeologist/public-relations officer/undertaker. All information pertaining to the identification of the graves needs to be documented for the application of a SAHRA permit. The notices need to be in at least 3 languages, English, and two other languages. This is a requirement by law.
- Notices of the intention needs to be placed in at least two local newspapers and have the same information as the above point. This is a requirement by law.
- Local radio stations can also be used to try contact family members. This is not required by law, but is helpful in trying to contact family members.
- During this time (60 days) a suitable cemetery need to be identified close to the development area or otherwise one specified by the family of the deceased.
- An open day for family members should be arranged after the period of 60 days so that they can gather to discuss the way forward, and to sort out any problems. The developer needs to take the families requirements into account. This is a requirement by law.
- Once the 60 days has passed and all the information from the family members have been received, a permit can be requested from SAHRA. This is a requirement by law.
- Once the permit has been received, the graves may be exhumed and relocated.
- All headstones must be relocated with the graves as well as any items found in the grave.

Information needed for the SAHRA permit application

- The permit application needs to be done by an archaeologist.
- A map of the area where the graves have been located.
- A survey report of the area prepared by an archaeologist.
- All the information on the families that have identified graves.
- If graves have not been identified and there are no headstones to indicate the grave, these are then unknown graves and should be handled as if they are older than 60 years. This information also needs to be given to SAHRA.
- A letter from the landowner giving permission to the developer to exhume and relocate the graves.
- A letter from the new cemetery confirming that the graves will be reburied there.
- Details of the farm name and number, magisterial district and GPS coordinates of the gravesite.

APPENDIX 6. INVENTORY OF IDENTIFIED CULTURAL HERITAGE SITES

No.: 8.3.1.1	
Name: Surface scatter NHRA Category: Archaeological site or material (Section 35) Farm: Kaffraria 314HO Coordinates: Eastern section of site	

Description
Scattered surface occurrences of Middle and possible Late Stone Age stone tools, cores and flakes were identified in a few areas across the prospecting area, but no habitation or tool processing areas were identified. Find spots are labelled as low-density scatters if they contain less than five tools or flakes per square metre – in this case less than 1 tool/flake per 100m ² . Such scatters also do not necessarily contain complete diagnostic or formal tools. The material used for the artefacts is quartzite and hardened shale (MSA) and fine-grained silicates such as chert (LSA).

Significance of site/feature	This feature has Low local significance – Grade IV-C
-------------------------------------	--

Impact assessment
As all the material identified was found on the surface, it is not in its original context and as a result the possible impact of the prospecting activities is viewed to be low.

Significance of impact					
Extent	Duration	Magnitude	Probability	Significance	Weight
1	5	3	3	27	Low

Mitigation
As the density of the artefact scatter is very low, no further action is required

Requirements
None

References
1: 50 000 topocadastral map:



No.: 8.3.3.1	
Name: Homestead NHRA Category: Structures older than 60 years (Section 34) Farm: Kaffraria 314HO Coordinates: -27.80367, 25.12831	

Description
The ruins of an old homestead, consisting of the foundation structure, build with locally quarried limestone blocks.

Significance of site/feature	This feature has Low local significance – Grade IV-C
-------------------------------------	--

Impact assessment
This site is located in the larger diamond prospecting area, and therefore there is a possibility that it might be impact on.

Significance of impact					
Extent	Duration	Magnitude	Probability	Significance	Weight
1	5	6	3	36	Medium

Mitigation
It is recommended that this feature is retained. If that is not possible and it must be demolished, it should be documented in full prior to construction of the powerline taking place.

Requirements
As these structures are probably older than 60 years, a permit for its destruction must be obtained from the RHRA. Such a permit will only be issued on condition of its full documentation (mapping and photographing).

References
1: 50 000 topocadastral map

--	--

No.: 8.3.3.2	
Name: Homestead NHRA Category: Structures older than 60 years (Section 34) Farm: Kaffraria 314HO Coordinates: -27.80099, 25.13181	

Description
The ruins of an old homestead, consisting of the foundation structure, build with locally quarried limestone blocks.

Significance of site/feature	This feature has Low local significance – Grade IV-C
-------------------------------------	--

Impact assessment
This site is located in the larger diamond prospecting area, and therefore there is a possibility that it might be impact on.

Significance of impact					
Extent	Duration	Magnitude	Probability	Significance	Weight
1	5	6	3	36	Medium

Mitigation
It is recommended that this feature is retained. If that is not possible and it must be demolished, it should be documented in full prior to construction of the powerline taking place.

Requirements
As these structures are probably older than 60 years, a permit for its destruction must be obtained from the RHRA. Such a permit will only be issued on condition of its full documentation (mapping and photographing).

References
1: 50 000 topocadastral map



No.: 8.3.3.3	
Name: Burial site NHRA Category: Graves or burial grounds (Section 36). Farm: Kaffraria 314HO Coordinates: -27,80367, 25.12838	

Description
<p>A small informal burial place, with probably more than 10 graves – due to the dense grass cover, a trustworthy figure could not be achieved. Most of the graves are only marked with stone cairns. Two graves have headstones with dates ranging between 1963 and 1978. According to the current land owner, descendants still visit some of the grave sporadically.</p>



Significance of site/feature	This feature has High/medium local significance – Grade IV-C
-------------------------------------	--

Impact assessment
<p>This site is located in the larger diamond prospecting area, and therefore there is a possibility that it might be impact on.</p>

Significance of impact					
Extent	Duration	Magnitude	Probability	Significance	Weight
1	5	6	3	36	Medium

Mitigation
<p>It is recommended that the burial site should be avoided and fenced off with wire, leaving a buffer zone of at least five metres from the outer edges of the graves. If the area cannot be avoided, it is recommended that graves are relocated after the proper procedure has been followed – see Appendix 3.</p>

Requirements
<p>As some of the (unmarked) graves might be older than 60 years, a valid permit for their relocation must be obtained from SAHRA. This is in addition to all other requirements – see Appendix 3.</p>

References
<p>1: 50 000 topocadastral map</p>

No.: 8.3.3.4	
Name: Homestead NHRA Category: Structures older than 60 years (Section 34) Farm: Kaffraria 314HO Coordinates: -27.80615, 25.12076	

Description
<p>The ruins of a well-built rectangular structure of stone, with a doorway facing east. It is approximately 4 x 2,5 metres in size. A short distance to the north west a circular structure, also built with stone occurs. It is approximately 1,5 metres in diameter. It is much reminiscent of an early pioneer house that is first erected on arrival at a farm. Its location in the vicinity of a natural pan seems to support this.</p>

Significance of site/feature	This feature has Medium local significance – Grade IV-B
-------------------------------------	---

Impact assessment
<p>This site is located in the larger diamond prospecting area, and therefore there is a possibility that it might be impact on.</p>

Significance of impact					
Extent	Duration	Magnitude	Probability	Significance	Weight
1	5	6	3	36	Medium

Mitigation
<p>It is recommended that this feature is retained. If that is not possible and it must be demolished, it should be documented (excavated and mapped) in full prior to prospecting activities taking place.</p>

Requirements
<p>As these structures are probably older than 60 years, a permit for its destruction must be obtained from the RHRA. Such a permit will only be issued on condition of its full documentation (excavating, mapping and photographing).</p>

References
1: 50 000 topocadastral map



APPENDIX 7. IMPACT TABLES

Nature: As no sites, features or objects of cultural significance are known to exist in the development area, there would be no impact as a result of the proposed development.		
	Without mitigation	With mitigation
Construction Phase		
<i>Probability</i>	Definite (3)	Definite (1)
<i>Duration</i>	Permanent (5)	Permanent (5)
<i>Extent</i>	Limited to the site (1)	Limited to the site (1)
<i>Magnitude</i>	High (6)	Minor (2)
Significance	36 (medium)	14 (low)
<i>Status (positive or negative)</i>	Negative	Negative
Operational Phase		
<i>Probability</i>	Definite (3)	Definite (1)
<i>Duration</i>	Permanent (5)	Permanent (5)
<i>Extent</i>	Limited to the site (1)	Limited to the site (1)
<i>Magnitude</i>	High (6)	Low (2)
Significance	36 (medium)	14 (low)
<i>Status (positive or negative)</i>	Negative	Negative
Reversibility	Low	Moderate
<i>Irreplaceable loss of resources?</i>	Moderate	Low
<i>Can impacts be mitigated?</i>	Yes	