



An EOH Company

ECOLEAD: PROPOSED MODDERFONTEIN FUEL STATION DEVELOPMENT IN THE MIDRAND AREA, EKURHULENI MUNICIPALITY, GAUTENG PROVINCE

Archaeological Impact Assessment

Innovation in Sustainability



Prepared for: **EcoLead**

Prepared by: **Exigo Sustainability**



An EOH Company

Email info@exigo3.com
Tel +27 012 751 2160
Fax +27 086 607 2406

The Village Office Park (Block E),
309 Glenwood Road, Faerie Glen,
Pretoria, 0043

Postnet Suite 74,
Private Bag X07,
Arcadia, 0007

Innovation in
Sustainability

www.exigo3.com

ARCHAEOLOGICAL IMPACT ASSESSMENT (AIA) OF A PROTION OF THE FARM ALLANDALE 10IR FOR THR PROPOSED MODDERFONTEIN FUEL STATION DEVELOPMENT, MIDRAND, EKURHULENI MUNICIPALITY, GAUTENG PROVINCE

Conducted on behalf of:



RUAN MOSTERT
Director
Environmental Management (M.Env.Man), Pri.Sci.Nat
t: 072 7747 831
e: ruan@ecolead.co.za
w: www.ecolead.co.za

Compiled by:

Nelius Kruger (BA, BA Hons. Archaeology Pret.)

Reviewed by:

Ruan Mostert (Ecolead)

Document History

Document Version 1 (Draft) – 10 February 2017



An EOH Company

Email info@exigo3.com
Tel +27 012 751 2160
Fax +27 086 607 2406

The Village Office Park (Block E),
309 Glenwood Road, Faerie Glen,
Pretoria, 0043

Postnet Suite 74,
Private Bag X07,
Arcadia, 0007

Innovation in
Sustainability

www.exigo3.com

Although Exigo Sustainability exercises due care and diligence in rendering services and preparing documents, Exigo Sustainability accepts no liability, and the client, by receiving this document, indemnifies Exigo Sustainability and its directors, managers, agents and employees against all actions, claims, demands, losses, liabilities, costs, damages and expenses arising from or in connection with services rendered, directly or indirectly by Exigo Sustainability and by the use of the information contained in this document.

This document contains confidential and proprietary information equally shared between Exigo Sustainability and Ecolead, and is protected by copyright in favour of these companies and may not be reproduced, or used without the written consent of these companies, which has been obtained beforehand. This document is prepared exclusively for Ecolead and is subject to all confidentiality, copyright and trade secrets, rules, intellectual property law and practices of South Africa.

Exigo Sustainability promotes the conservation of sensitive archaeological and heritage resources and therefore uncompromisingly adheres to relevant Heritage Legislation (National Heritage Resources Act no. 25 of 1999, Human Tissue Act 65 of 1983 as amended, Removal of Graves and Dead Bodies Ordinance no. 7 of 1925, Excavations Ordinance no. 12 of 1980). In order to ensure best practices and ethics in the examination, conservation and mitigation of archaeological and heritage resources, Exigo Sustainability follows the Minimum Standards: Archaeological and Palaeontological Components of Impact Assessment as set out by the South African Heritage Resources Agency (SAHRA) and the CRM section of the Association for South African Professional Archaeologists (ASAPA).

DECLARATION

I, Nelius Le Roux Kruger, declare that –

- I act as the independent specialist;
- I am conducting any work and activity relating to the proposed Modderfontein Fuel Station Development in an objective manner, even if this results in views and findings that are not favourable to the client;
- I declare that there are no circumstances that may compromise my objectivity in performing such work;
- I have the required expertise in conducting the specialist report and I will comply with legislation, including the relevant Heritage Legislation (National Heritage Resources Act no. 25 of 1999, Human Tissue Act 65 of 1983 as amended, Removal of Graves and Dead Bodies Ordinance no. 7 of 1925, Excavations Ordinance no. 12 of 1980), the Minimum Standards: Archaeological and Palaeontological Components of Impact Assessment (SAHRA, AMAFA and the CRM section of ASAPA), regulations and any guidelines that have relevance to the proposed activity;
- I have not, and will not engage in, conflicting interests in the undertaking of the activity;
- I undertake to disclose to the applicant and the competent authority all material information in my possession that reasonably has or may have the potential of influencing - any decision to be taken with respect to the application by the competent authority; and - the objectivity of any report, plan or document to be prepared by myself for submission to the competent authority;
- All the particulars furnished by me in this declaration are true and correct.



Signature of specialist

Company: Exigo Sustainability

Date: 10 February 2017

EXECUTIVE SUMMARY

This report details the results of an Archaeological Impact Assessment (AIA) study on a Portion of the farm Allandale 10IR, subject to an Environmental Basic Assessment (BA) process for the proposed Modderfontein Fuel Station Development in the Ekurhuleni Municipality, Gauteng Province. The project entails the proposed construction of a fuel station on a plot measuring **2.5ha**. The report includes background information on the area’s archaeology, its representation in Southern Africa, and the history of the larger area under investigation, survey methodology and results as well as heritage legislation and conservation policies. A copy of the report will be supplied to the Gauteng Provincial Heritage Resources Authority (Gauteng-PHRA) and recommendations contained in this document will be reviewed.

Project Title	Modderfontein Fuel Station Development
Project Location	S25.99532° E28.15624°
1:50 000 Map Sheet	2528CC
Farm Portion / Parcel	Allandale 10IR
Magisterial District / Municipal Area	Ekurhuleni Municipality
Province	Gauteng Province

A number of archaeological and historical studies have been conducted in the Gauteng Province. These studies all infer a rich and diverse archaeological landscape. Sites, documenting Earlier, Middle and Later Stone Age habitation occur across the province, mostly in open air locales or in sediments alongside rivers or pans. Later, Bantu-speaking tribes moved into this area from the northern parts of Southern Africa and settled here. These were presumably Sotho-Tswana herder groups. During the nineteenth century Gauteng was extensively settled by both Bantu and European groups that migrated into this area. Moving into recent times, the archaeological record reflects the development of a rich colonial frontier, characterised by not only a complex industrial archaeological landscape such as mining developments, but also contact and conflict during the two Anglo-Boer Wars which herald the modern era in South African history.

In terms of heritage resources, the landscape around the project area is primarily well known for the occurrence of Historical Period occurrences and human burials. However, the proposed Modderfontein Fuel Station Development footprint is situated in surrounds that have been sterilised of potential heritage resources, especially those dating to pre-Colonial and prehistoric times and no heritage receptors were documented during the site survey. As such, the absence of heritage sites might be attributed to the fact that the surroundings at the Modderfontein Fuel Station Development have been transformed throughout by farming and urbanization. The following general heritage management recommendations are made based on general observations in the proposed project area:

- A Palaeontological Impact Assessment is recommended where bedrock is to be impacted and, should fossil remains such as fossil fish, reptiles or petrified wood be exposed during construction, these objects should be carefully safeguarded and the relevant heritage resources authority (Gauteng-

PHRA) should be notified immediately so that the appropriate action can be taken by a professional palaeontologist.

- Considering the localised nature of heritage remains, the general monitoring of the development progress by an ECO or by the heritage specialist is recommended for all stages of the project. Should any subsurface palaeontological, archaeological or historical material, or burials be exposed during construction activities, all activities should be suspended and the archaeological specialist should be notified immediately

No heritage resources were noted in the proposed Modderfontein Fuel Station Development footprints. It is the opinion of the author of this Archaeological Impact Assessment Report that the proposed Modderfontein Fuel Station Development may proceed from a culture resources management perspective, provided that no previously undetected heritage remains are found at any point in construction and operational phases.

It is essential that cognisance be taken of the larger archaeological landscape of the Gauteng Province and the Midrand region in order to avoid the destruction of previously undetected heritage sites. Water sources such as salt pans, drainage lines and rivers should also be regarded as potentially sensitive in terms of possible Stone Age deposits. The possible existence of Colonial Period resources deriving from the area's more recent history should also be considered. Should any previously undetected heritage resources be exposed or uncovered during construction phases of the proposed project, these should immediately be reported to SAHRA.

Since the intrinsic heritage and social value of graves and cemeteries are highly significant, these resources require special management measures. Should human remains be discovered at any stage, these should be reported to the Heritage Specialist and relevant authorities (SAHRA) and development activities should be suspended until the site has been inspected by the Specialist. The Specialist will advise on further management actions and possible relocation of human remains in accordance with the Human Tissue Act (Act 65 of 1983 as amended), the Removal of Graves and Dead Bodies Ordinance (Ordinance no. 7 of 1925), the National Heritage Resources Act (Act no. 25 of 1999) and any local and regional provisions, laws and by-laws pertaining to human remains. A full social consultation process should occur in conjunction with the mitigation of cemeteries and burials.

This report details the methodology, limitations and recommendations relevant to these heritage areas, as well as areas of proposed development. It should be noted that recommendations and possible mitigation measures are valid for the duration of the development process, and mitigation measures might have to be implemented on additional features of heritage importance not detected during this Phase 1 assessment (e.g. uncovered during the construction process).

NOTATIONS AND TERMS/TERMINOLOGY

Absolute dating:

Absolute dating provides specific dates or range of dates expressed in years.

Archaeology:

The study of the human past through its material remains.

Archaeological record:

The archaeological record minimally includes all the material remains documented by archaeologists. More comprehensive definitions also include the record of culture history and everything written about the past by archaeologists.

Artefact:

Entities whose characteristics result or partially result from human activity. The shape and other characteristics of the artefact are not altered by removal of the surroundings in which they are discovered. In the Southern African context examples of artefacts include potsherds, iron objects, stone tools, beads and hut remains.

Assemblage:

A group of artefacts recurring together at a particular time and place, and representing the sum of human activities.

¹⁴C or radiocarbon dating:

The ¹⁴C method determines the absolute age of organic material by studying the radioactivity of carbon. It is reliable for objects not older than 70 000 years by means of isotopic enrichment. The method becomes increasingly inaccurate for samples younger than ±250 years.

Ceramic Facies:

In terms of the cultural representation of ceramics, a facies is denoted by a specific branch of a larger ceramic tradition. A number of ceramic facies thus constitute a ceramic tradition.

Ceramic Tradition:

In terms of the cultural representation of ceramics, a series of ceramic units constitutes as ceramic tradition.

Context:

An artefact's context usually consists of its immediate *matrix*, its *provenience* and its *association* with other artefacts. When found in *primary context*, the original artefact or structure was undisturbed by natural or human factors until excavation and if in *secondary context*, disturbance or displacement by later ecological action or human activities occurred.

Culture:

A contested term, "culture" could minimally be defined as the learned and shared things that people have, do and think.

Cultural Heritage Resource:

The broad generic term *Cultural Heritage Resources* refers to any physical and spiritual property associated with past and present human use or occupation of the environment, cultural activities and history. The term includes sites, structures, places, natural features and material of palaeontological, archaeological, historical, aesthetic, scientific, architectural, religious, symbolic or traditional importance to specific individuals or groups, traditional systems of cultural practice, belief or social interaction.

Cultural landscape:

A cultural landscape refers to a distinctive geographic area with cultural significance.

Cultural Resource Management (CRM):

A system of measures for safeguarding the archaeological heritage of a given area, generally applied within the framework of legislation designed to safeguard the past.

Ecofact:

Non artefactual material remains that has cultural relevance which provides information about past human activities. Examples would include remains or evidence of domesticated animals or plant species.

Excavation:

The principal method of data acquisition in archaeology, involving the systematic uncovering of archaeological remains through the removal of the deposits of soil and the other material covering and accompanying it.

Feature:

Non-portable artefacts, in other words artefacts that cannot be removed from their surroundings without destroying or altering their original form. Hearths, roads, and storage pits are examples of archaeological features

GIS:

Geographic Information Systems are computer software that allows layering of various types of data to produce complex maps; useful for predicting site location and for representing the analysis of collected data within sites and across regions.

Historical archaeology:

Primarily that aspect of archaeology which is complementary to history based on the study of written sources. In the South African context it concerns the recovery and interpretation of relics left in the ground in the course of Europe's discovery of South Africa, as well as the movements of the indigenous groups during, and after the "Great Scattering" of Bantu-speaking groups – known as the *mfecane* or *difaqane*.

Impact: A description of the effect of an aspect of the development on a specified component of the biophysical, social or economic environment within a defined time and space.

Iron Age:

Also known as "Farmer Period", the "Iron Age" is an archaeological term used to define a period associated with domesticated livestock and grains, metal working and ceramic manufacture.

Lithic:

Stone tools or waste from stone tool manufacturing found on archaeological sites.

Management / Management Actions:

Actions – including planning and design changes - that enhance benefits associated with a proposed development, or that avoid, mitigate, restore, rehabilitate or compensate for the negative impacts.

Matrix:

The material in which an artefact is situated (sediments such as sand, ashy soil, mud, water, etcetera). The matrix may be of natural origin or human-made.

Megalith:

A large stone, often found in association with others and forming an alignment or monument, such as large stone statues.

Midden:

Refuse that accumulates in a concentrated heap.

Microlith:

A small stone tool, typically knapped of flint or chert, usually about three centimetres long or less.

Monolith:

A geological feature such as a large rock, consisting of a single massive stone or rock, or a single piece of rock placed as, or within, a monument or site.

Oral Histories:

The historical narratives, stories and traditions passed from generation to generation by word of mouth.

Phase 1 CRM Assessment:

An Impact Assessment which identifies archaeological and heritage sites, assesses their significance and comments on the impact of a given development on the sites. Recommendations for site mitigation or conservation are also made during this phase.

Phase 2 CRM Study:

In-depth studies which could include major archaeological excavations, detailed site surveys and mapping / plans of sites, including historical / architectural structures and features. Alternatively, the sampling of sites by collecting material, small test pit excavations or

auger sampling is required. Mitigation / Rescue involves planning the protection of significant sites or sampling through excavation or collection (in terms of a permit) at sites that may be lost as a result of a given development.

Phase 3 CRM Measure:

A Heritage Site Management Plan (for heritage conservation), is required in rare cases where the site is so important that development will not be allowed and sometimes developers are encouraged to enhance the value of the sites retained on their properties with appropriate interpretive material or displays.

Prehistoric archaeology:

That aspect of archaeology which concerns itself with the development of humans and their culture before the invention of writing. In South Africa, prehistoric archaeology comprises the study of the Early Stone Age, the Middle Stone Age and the greater part of the Later Stone Age and the Iron Age.

Probabilistic Sampling:

A sampling strategy that is not biased by any person's judgment or opinion. Also known as statistical sampling, it includes systematic, random and stratified sampling strategies.

Provenience

Provenience is the three-dimensional (horizontal and vertical) position in which artefacts are found. Fundamental to ascertaining the provenience of an artefact is *association*, the co-occurrence of an artefact with other archaeological remains; and *superposition*, the principle whereby artefacts in lower levels of a matrix were deposited before the artefacts found in the layers above them, and are therefore older.

Random Sampling:

A probabilistic sampling strategy whereby randomly selected sample blocks in an area are surveyed. These are fixed by drawing coordinates of the sample blocks from a table of random numbers.

Relative dating:

The process whereby the relative antiquity of sites and objects are determined by putting them in sequential order but not assigning specific dates.

Remote Sensing:

The small or large-scale acquisition of information of an object or phenomenon, by the use of either recording or real-time sensing device(s) that is not in physical or intimate contact with the object (such as by way of aircraft, spacecraft or satellite). Here, ground-based geophysical methods such as Ground Penetrating Radar and Magnetometry are often used for archaeological imaging.

Rock Art Research:

Rock art can be "decoded" in order to inform about cultural attributes of prehistoric societies, such as dress-code, hunting and food gathering, social behaviour, religious practice, gender issues and political issues.

Scoping Assessment:

The process of determining the spatial and temporal boundaries (i.e. extent) and key issues to be addressed in an impact assessment. The main purpose is to focus the impact assessment on a manageable number of important questions on which decision making is expected to focus and to ensure that only key issues and reasonable alternatives are examined. The outcome of the scoping process is a Scoping Report that includes issues raised during the scoping process, appropriate responses and, where required, terms of reference for specialist involvement.

Sensitive:

Often refers to graves and burial sites although not necessarily a heritage place, as well as ideologically significant sites such as ritual / religious places. *Sensitive* may also refer to an entire landscape / area known for its significant heritage remains.

Site (Archaeological):

A distinct spatial clustering of artefacts, features, structures, and organic and environmental remains, as the residue of human activity. These include surface sites, caves and rock shelters, larger open-air sites, sealed sites (deposits) and river deposits. Common functions of archaeological sites include living or habitation sites, kill sites, ceremonial sites, burial sites, trading, quarry, and art sites,

Slag:

The material residue of smelting processes from metalworking.

Stone Age:

An archaeological term used to define a period of stone tool use and manufacture.

Stratigraphy:

This principle examines and describes the observable layers of sediments and the arrangement of strata in deposits

Stratified Sampling:

A probabilistic sampling strategy whereby a study area is divided into appropriate zones – often based on the probable location of archaeological areas, after which each zone is sampled at random.

Systematic Sampling:

A probabilistic sampling strategy whereby a grid of sample blocks is set up over the survey area and each of these blocks is equally spaced and searched.

Tradition:

Artefact types, assemblages of tools, architectural styles, economic practices or art styles that last longer than a phase and even a horizon are describe by the term *tradition*. A common example of this is the early Iron Age tradition of Southern Africa that originated ± 200 AD and came to an end at about 900 AD.

Trigger: A particular characteristic of either the receiving environment or the proposed project which indicates that there is likely to be an *issue* and/or potentially significant *impact* associated with that proposed development that may require specialist input. Legal requirements of existing and future legislation may also trigger the need for specialist involvement.

Tuyère:

A ceramic blow-tube used in the process of iron smelting / reduction.

LIST OF ABBREVIATIONS

Abbreviation	Description
ASAPA	Association for South African Professional Archaeologists
AIA	Archaeological Impact Assessment
BP	Before Present
BCE	Before Common Era
CRM	Culture Resources Management
EIA	Early Iron Age (also Early Farmer Period)
EIA	Environmental Impact Assessment
EFP	Early Farmer Period (also Early Iron Age)
ESA	Earlier Stone Age
GIS	Geographic Information Systems
HIA	Heritage Impact Assessment
ICOMOS	International Council on Monuments and Sites
K2/Map	K2/Mapungubwe Period
LFP	Later Farmer Period (also Later Iron Age)
LIA	Later Iron Age (also Later Farmer Period)
LSA	Later Stone Age
MIA	Middle Iron Age (also Early later Farmer Period)
MSA	Middle Stone Age
NHRA	National Heritage Resources Act No.25 of 1999, Section 35
PFS	Pre-Feasibility Study
PHRA	Provincial Heritage Resources Authorities
SAFA	Society for Africanist Archaeologists
SAHRA	South African Heritage Resources Association
YCE	Years before Common Era (Present)

TABLE OF CONTENTS

EXECUTIVE SUMMARY	4
1 BACKGROUND.....	14
1.1 SCOPE AND MOTIVATION	14
1.2 PROJECT DIRECTION	14
1.3 PROJECT BRIEF	14
1.4 TERMS OF REFERENCE	16
1.5 CRM: LEGISLATION, CONSERVATION AND HERITAGE MANAGEMENT.....	16
1.5.1 <i>Legislation regarding archaeology and heritage sites</i>	16
1.5.2 <i>Background to HIA and AIA Studies</i>	18
2 REGIONAL CONTEXT.....	20
2.1 AREA LOCATION	20
2.2 AREA DESCRIPTION: RECEIVING ENVIRONMENT	20
2.3 SITE DESCRIPTION	20
3 METHOD OF ENQUIRY.....	23
3.1 SOURCES OF INFORMATION	23
3.1.1 <i>Desktop Study</i>	23
3.1.2 <i>Aerial Representations and Survey</i>	23
3.1.3 <i>Field Survey</i>	25
3.2 LIMITATIONS.....	25
3.2.1 <i>Access</i>	25
3.2.2 <i>Visibility</i>	25
3.2.3 <i>Limitations and Constraints Summary</i>	28
3.3 IMPACT ASSESSMENT	28
4 ARCHAEO-HISTORICAL CONTEXT.....	29
4.1 THE ARCHAEOLOGY OF SOUTHERN AFRICA.....	29
4.1.1 <i>The Stone Ages</i>	29
4.1.2 <i>The Iron Age Farmer Period</i>	31
4.1.3 <i>Pastoralism and the last 2000 years</i>	32
4.1.4 <i>Historical and Colonial Times and Recent History</i>	32
4.2 THE GAUTENG HERITAGE LANDSCAPE: SPECIFIC THEMES.....	33
4.2.1 <i>The Stone Ages</i>	33
4.2.2 <i>The Iron Age / Farmer Period</i>	33
4.2.3 <i>Later History and Colonial Period</i>	34
4.2.4 <i>The Voortrekkers and the Anglo-Boer War</i>	36
5 RESULTS: ARCHAEOLOGICAL SURVEY	36
5.1 THE STONE AGE	36
5.2 THE IRON AGE FARMER PERIOD	36
5.3 COLONIAL PERIOD AND RECENT TIMES	36
5.4 GRAVES	37
6 RESULTS: STATEMENT OF SIGNIFICANCE AND IMPACT RATING	37
6.1 POTENTIAL IMPACTS AND SIGNIFICANCE RATINGS	37
6.1.1 <i>General assessment of impacts on resources</i>	37
6.1.2 <i>Direct impact rating</i>	37
6.2 EVALUATION IMPACTS	37

6.2.1	Archaeology	38
6.2.2	Built Environment	38
6.2.3	Cultural Landscape.....	38
6.2.4	Graves / Human Burials Sites.....	38
6.3	MANAGEMENT ACTIONS	38
7	RECOMMENDATIONS.....	40
8	GENERAL COMMENTS AND CONDITIONS	41
9	BIBLIOGRAPHY	42
10	ADDENDUM 1: HERITAGE LEGISLATION BACKGROUND.....	44
10.1	CRM: LEGISLATION, CONSERVATION AND HERITAGE MANAGEMENT.....	44
10.1.1	Legislation regarding archaeology and heritage sites.....	44
10.1.2	Background to HIA and AIA Studies.....	45
10.2	ASSESSING THE SIGNIFICANCE OF HERITAGE RESOURCES.....	47
	- CATEGORIES OF SIGNIFICANCE	47
11	ADDENDUM 2: GRAVE RELOCATION AND SITE MANAGEMENT: STATUTORY MANDATE.....	50
11.1	ARCHAEOLOGY, GRAVES AND THE LAW	50
11.2	GRAVES: NECESSARY PROCEDURES	50
12	ADDENDUM 3: CONVENTIONS USED TO ASSESS THE SIGNIFICANCE OF HERITAGE.....	52
12.1	SITE SIGNIFICANCE MATRIX	52
12.2	IMPACT ASSESSMENT CRITERIA.....	52
12.3	DIRECT IMPACT ASSESSMENT CRITERIA	54
12.4	MANAGEMENT AND MITIGATION ACTIONS.....	55

LIST OF FIGURES

Figure 1-1: Aerial representation of the Modderfontein Fuel Station Development location and proposed surface portion.	15
Figure 2-1: 1:50 00 Map representation of the location of the proposed Modderfontein Fuel Station Development (sheet 2528CC).....	21
Figure 2-2: Aerial map providing a regional setting for the proposed Modderfontein Fuel Station Development location.....	22
Figure 3-1: Google Earth imagery of the proposed project area (white outline) with possible signs of surface changes or disturbance; ant hills or refuse heaps (?) are marked in orange, vegetation change possibly a sign of water seepage is marked in green and a drainage line is indicated in blue line.	24
Figure 3-2: General surroundings of the project area, looking east.....	25
Figure 3-3: A general view of the project area, looking north	26
Figure 3-4: View of vegetation and ant hills in the project area.	26
Figure 3-5: A clear change in vegetation (left and right) in a ventral portion of the project area – possibly a sign of water seepage.	26
Figure 3-6: View of one of many footpaths traversing the project area.	27
Figure 3-7: A sandstone boulder in the project area.....	27
Figure 3-8: General surroundings in the project area, looking south.....	27
Figure 3-9: View of refuse dumps along the western periphery of the project area at Modderfontein Raod.	28
Figure 4-1: Title deed for the farm, Allandale, circa 1951.	35

1 BACKGROUND

1.1 Scope and Motivation

Exigo Sustainability was commissioned by Ecolead for an Archaeological Impact Assessment (AIA) study subject to an Environmental Basic Assessment (BA) process for the Modderfontein Fuel Station Development in the Ekurhuleni Municipality, Gauteng Province. The rationale of this AIA is to determine the presence of heritage resources such as archaeological and historical sites and features, graves and places of religious and cultural significance in previously unstudied areas; to consider the impact of the proposed project on such heritage resources, and to submit appropriate recommendations with regard to the cultural resources management measures that may be required at affected sites / features.

1.2 Project Direction

Exigo Sustainability's expertise ensures that all projects be conducted to the highest international ethical and professional standards. As archaeological specialist for Exigo Sustainability, Mr Nelius Kruger acted as field director for the project; responsible for the assimilation of all information, the compilation of the final consolidated AIA report and recommendations in terms of heritage resources on the demarcated project areas. Mr Kruger is an accredited archaeologist and Culture Resources Management (CRM) practitioner with the Association of South African Professional Archaeologists (ASAPA), a member of the Society for Africanist Archaeologists (SAFA) and the Pan African Archaeological Association (PAA) as well as a Master's Degree candidate in archaeology at the University of Pretoria.

1.3 Project Brief

The proposed Modderfontein Fuel Station Development entails the construction of a filling station and related infrastructure linking to the M38 Modderfontein Road. The fuel station will be developed on a section of the farm Allandale 10IR where a plot of approximately 2.6ha has been demarcated for this purpose. The fuel station will thus be constructed on the most suitable portion of this demarcated plot.



Figure 1-1: Aerial representation of the Modderfontein Fuel Station Development location and proposed surface portion.

1.4 Terms of Reference

Heritage specialist input into the Environmental Impact Assessment (EIA) process is essential to ensure that, through the management of change, developments still conserve our heritage resources. Heritage specialist input in EIA processes can play a positive role in the development process by enriching an understanding of the past and its contribution to the present. It is also a legal requirement for certain development categories which may have an impact on heritage resources (Refer to Section 2.5.2).

Thus, EIAs should always include an assessment of heritage resources. The heritage component of the EIA is provided for in the **National Environmental Management Act, (Act 107 of 1998)** and endorsed by section 38 of the **National Heritage Resources Act (NHRA - Act 25 of 1999)**. In addition, the NHRA protects all structures and features older than 60 years, archaeological sites and material and graves as well as burial sites. The objective of this legislation is to ensure that developers implement measures to limit the potentially negative effects that the development could have on heritage resources. Based hereon, this project functioned according to the following **terms of reference** for heritage specialist input:

- *Provide a detailed description of all archaeological artefacts, structures (including graves) and settlements which may be affected, if any.*
- *Assess the nature and degree of significance of such resources within the area.*
- *Establish heritage informants/constraints to guide the development process through establishing thresholds of impact significance;*
- *Assess and rate any possible impact on the archaeological and historical remains within the area emanating from the proposed development activities.*
- *Propose possible heritage management measures provided that such action is necessitated by the development.*
- *Liaise and consult with the South African Heritage Resources Agency (SAHRA)*

1.5 CRM: Legislation, Conservation and Heritage Management

The broad generic term *Cultural Heritage Resources* refers to any physical and spiritual property associated with past and present human use or occupation of the environment, cultural activities and history. The term includes sites, structures, places, natural features and material of palaeontological, archaeological, historical, aesthetic, scientific, architectural, religious, symbolic or traditional importance to specific individuals or groups, traditional systems of cultural practice, belief or social interaction.

1.5.1 Legislation regarding archaeology and heritage sites

The South African Heritage Resources Agency (SAHRA) and its provincial offices aim to conserve and control the management, research, alteration and destruction of cultural resources of South Africa. It is therefore vitally important to adhere to heritage resource legislation at all times.

a. National Heritage Resources Act No 25 of 1999, section 35

According to the National Heritage Resources Act No 25 of 1999 (section 35) the following features are protected as cultural heritage resources:

- a. Archaeological artifacts, structures and sites older than 100 years

- b. Ethnographic art objects (e.g. prehistoric rock art) and ethnography
- c. Objects of decorative and visual arts
- d. Military objects, structures and sites older than 75 years
- e. Historical objects, structures and sites older than 60 years
- f. Proclaimed heritage sites
- g. Grave yards and graves older than 60 years
- h. Meteorites and fossils
- i. Objects, structures and sites of scientific or technological value.

In addition, the national estate includes the following:

- a. Places, buildings, structures and equipment of cultural significance
- b. Places to which oral traditions are attached or which are associated with living heritage
- c. Historical settlements and townscapes
- d. Landscapes and features of cultural significance
- e. Geological sites of scientific or cultural importance
- f. Archaeological and paleontological importance
- g. Graves and burial grounds
- h. Sites of significance relating to the history of slavery
- i. Movable objects (e.g. archaeological, paleontological, meteorites, geological specimens, military, ethnographic, books etc.)

With regards to activities and work on archaeological and heritage sites this Act states that:

“No person may alter or demolish any structure or part of a structure which is older than 60 years without a permit by the relevant provincial heritage resources authority.” (34. [1] 1999:58)

and

“No person may, without a permit issued by the responsible heritage resources authority-

- (a) destroy, damage, excavate, alter, deface or otherwise disturb any archaeological or palaeontological site or any meteorite;*
- (b) destroy, damage, excavate, remove from its original position, collect or own any archaeological or palaeontological material or object or any meteorite;*
- (c) trade in, sell for private gain, export or attempt to export from the Republic any category of archaeological or palaeontological material or object, or any meteorite; or*
- (d) bring onto or use at an archaeological or palaeontological site any excavation equipment or any equipment which assist in the detection or recovery of metals or archaeological and palaeontological material or objects, or use such equipment for the recovery of meteorites. (35. [4] 1999:58).”*

and

“No person may, without a permit issued by SAHRA or a provincial heritage resources agency-

- (a) destroy, damage, alter, exhume or remove from its original position or otherwise disturb the grave of a victim of conflict, or any burial ground or part thereof which contains such graves;*
- (b) destroy, damage, alter, exhume, remove from its original position or otherwise disturb any grave or burial ground older than 60 years which is situated outside a formal cemetery administered by a local authority;*
- (c) bring onto or use at a burial ground or grave referred to in paragraph (a) or (b) and excavation equipment, or any equipment which assists in the detection or recovery of metals (36. [3] 1999:60).”*

b. Human Tissue Act of 1983 and Ordinance on the Removal of Graves and Dead Bodies of 1925

Graves and burial grounds are commonly divided into the following subsets:

- a. ancestral graves
- b. royal graves and graves of traditional leaders
- c. graves of victims of conflict
- d. graves designated by the Minister
- e. historical graves and cemeteries
- f. human remains

Graves 60 years or older are heritage resources and fall under the jurisdiction of both the National Heritage Resources Act and the Human Tissues Act of 1983. However, graves younger than 60 years are specifically protected by the Human Tissues Act (Act 65 of 1983) and Ordinance on Excavations (Ordinance no. 12 of 1980) as well as any local and regional provisions, laws and by-laws. Such burial places also fall under the jurisdiction of the National Department of Health and the Provincial Health Departments. Approval for the exhumation and re-burial must be obtained from the relevant Provincial MEC as well as the relevant local authorities.

c. National Heritage Resources Act No 25 of 1999, section 35

This act (Act 107 of 1998) states that a survey and evaluation of cultural resources must be done in areas where development projects, that will change the face of the environment, will be undertaken. The impact of the development on these resources should be determined and proposals for the mitigation thereof are made. Environmental management should also take the cultural and social needs of people into account. Any disturbance of landscapes and sites that constitute the nation’s cultural heritage should be avoided as far as possible and where this is not possible the disturbance should be minimized and remedied.

1.5.2 Background to HIA and AIA Studies

South Africa’s unique and non-renewable archaeological and palaeontological heritage sites are ‘generally’ protected in terms of the National Heritage Resources Act (Act No 25 of 1999, section 35) and may not be disturbed at all without a permit from the relevant heritage resources authority. Heritage sites are frequently

threatened by development projects and both the environmental and heritage legislation require impact assessments (HIAs & AIAs) that identify all heritage resources in areas to be developed. Particularly, these assessments are required to make recommendations for protection or mitigation of the impact of the sites. HIAs and AIAs should be done by qualified professionals with adequate knowledge to (a) identify all heritage resources including archaeological and palaeontological sites that might occur in areas of developed and (b) make recommendations for protection or mitigation of the impact on the sites.

A detailed guideline of statutory terms and requirements is supplied in Addendum 1.

2 REGIONAL CONTEXT

2.1 Area Location

The proposed Modderfontein Fuel Station Development Project occurs in Midrand in the Ekurhuleni Metropolitan Municipality. The proposed project is located along the M38 Modderfontein Road between President Park and Glen Austin. The Grand Central Aerodrome occurs no more than 1.5km west of the project area. More specifically, the development footprint is situated at **S25.99532° E28.15624°** and it is located on 1:50 000 map sheet **2528CC**.

2.2 Area Description: Receiving Environment

The Modderfontein Fuel Station Development Project is situated within the Mesic Highveld Grassland of the Grassland Biome, in particular within its Eastern Highveld Grassland vegetation unit. The terrain morphology is gently to moderately undulating plains on the Highveld plateau supporting short to medium high, dense, tufted grassland. In places not disturbed, only scattered small wetlands, narrow stream alluvia, pans and occasional ridges or rocky outcrops interrupt the continuous grassland cover. Both vegetation types have been degraded to a large extent through extensive urbanization, agricultural activities and small scale livestock farming. This vegetation type occurs on slightly to moderately undulating plains with short open tree layer with a well-developed grass layer to grass plains with occasional trees at higher altitudes. The gently undulating highland topography is characterised by gentle rolling grass covered hills.

2.3 Site Description

Generally, the Midrand area is typical Highveld, a landscape characterised by gently sloping plains, separated by relatively deep valleys carved out by the Jukskei River, Kaalspruit, Olifantsspruit, Modderfontein Spruit and smaller watercourses. At places there are ensembles of large granite boulders, rocky outcrops and hillocks. Except where human settlement has occurred, the plains are generally treeless. The study area is situated in a landscape that has largely been transformed by farming and urbanisation. Pockets of level or undulating and undisturbed grassland remain with pioneering species prevalent in places. The development site slopes downwards to the east with a drainage line and probable water seepage occurring along the eastern periphery. A number of footpaths traverse the site and ant hills occur throughout. The western section along Modderfontein Road is littered with refuse and building rubble.

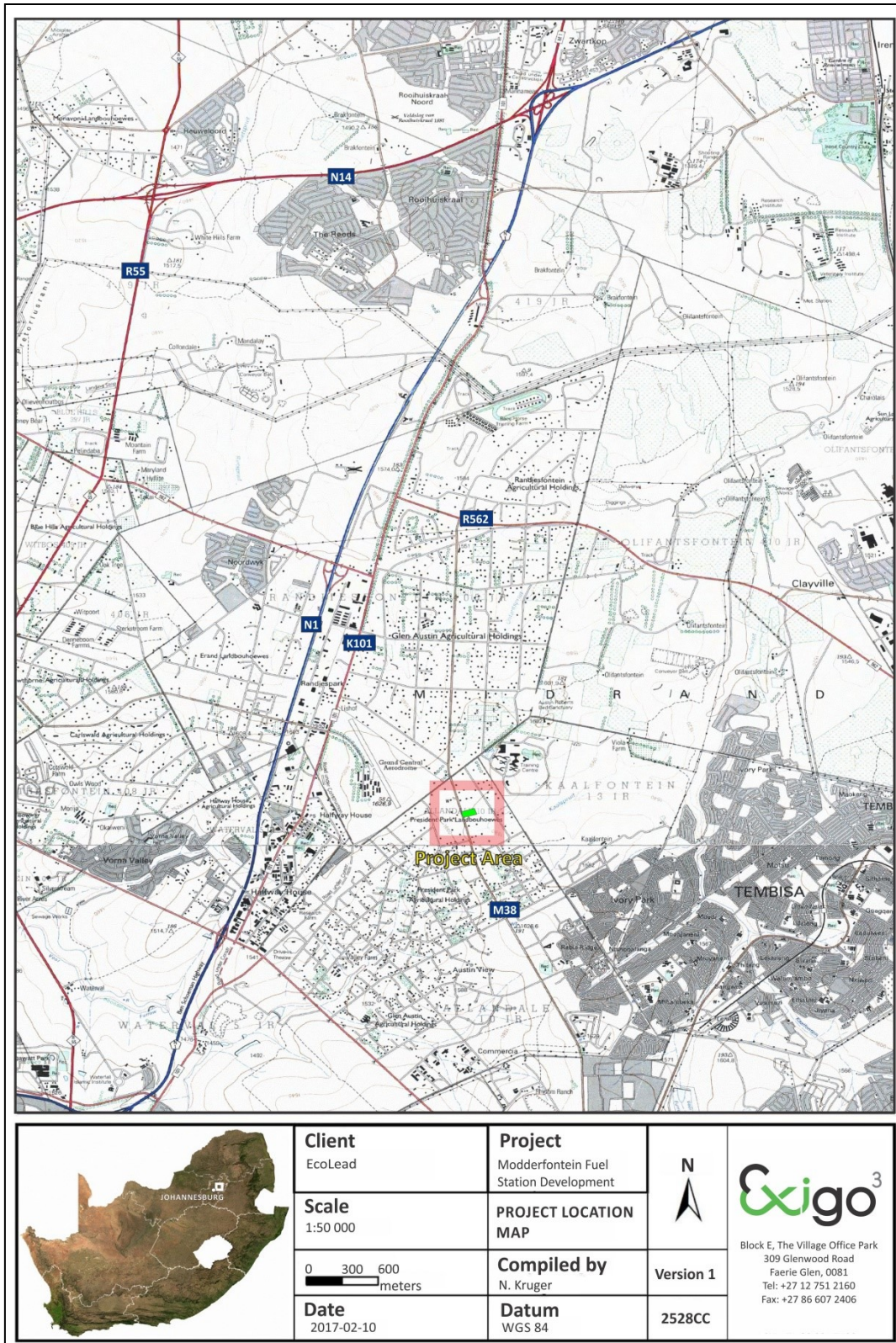

Figure 2-1: 1:50 00 Map representation of the location of the proposed Modderfontein Fuel Station Development (sheet 2528CC).



Figure 2-2: Aerial map providing a regional setting for the proposed Modderfontein Fuel Station Development location.

3 METHOD OF ENQUIRY

3.1 Sources of Information

Data from detailed desktop, aerial and field studies were employed in order to sample surface areas systematically and to ensure a high probability of heritage sites recording.

3.1.1 Desktop Study

The larger landscape of Gauteng has been well documented in terms of its archaeology and history. A desktop study was prepared in order to contextualize the proposed project within a larger historical milieu. The study drew on available unpublished archival databases and unpublished Heritage Assessment reports to give a comprehensive representation of known sites in the study area. A number of commercially driven Heritage Assessments have been conducted in the region around the project area. These include:

Kruger, N. 2015. Archaeological Impact Assessment for the K101 Road Upgrade Project, Midrand, Gauteng. Exigo Sustainability.

Huffman, T.N. 2002 Archaeological Assessment for the Gautrain University of the Witwatersrand - Archaeological Resources Management

Van der Walt, J. 2015. Archaeological Impact Assessment For the proposed Midridge Park Ext. 25 Township Development, Midrand, Gauteng. Heritage Contracts and Archaeological Consulting

Van Schalkwyk, J.A. 1999. A Survey of Cultural Resources in the Midrand Municipal Area National Cultural History Museum

Van Schalkwyk, J.A. 2006. Addendum to the heritage impact assessment for the proposed Gautrain Rapid Rail Link, Gauteng Province, South Africa, Unpublished report 2006/JvS/070. Pretoria

Furthermore, numerous academic papers and research articles supplied a historical context for the proposed project and archival sources, aerial photographs, historical maps and local histories were used to create a baseline of the landscape's heritage.

3.1.2 Aerial Representations and Survey

Aerial photography is often employed to locate and study archaeological sites, particularly where larger scale area surveys are performed. This method was applied to assist the foot site survey where depressions, variation in vegetation, soil marks and landmarks were examined. Specific attention was given to shadow sites (shadows of walls or earthworks which are visible early or late in the day), crop mark sites (crop mark sites are visible because disturbances beneath crops cause variations in their height, vigour and type) and soil marks (e.g. differently coloured or textured soil (soil marks) might indicate ploughed-out burial mounds). Attention was also given to moisture differences, as prolonged dampening of soil as a result of precipitation frequently occurs over walls or embankments. By superimposing high frequency aerial photographs with images generated with Google Earth, potential sensitive areas were subsequently identified, geo-referenced and transferred to a handheld GPS device. These areas served as referenced points from where further vehicular and pedestrian surveys were carried out. The aerial survey identified surface areas in the proposed Modderfontein Fuel Station Development footprints which might have been subjected to historical and more recent disturbances (see Figure 3-1).



Figure 3-1: Google Earth imagery of the proposed project area (white outline) with possible signs of surface changes or disturbance; ant hills or refuse heaps (?) are marked in orange, vegetation change possibly a sign of water seepage is marked in green and a drainage line is indicated in blue line.

3.1.3 Field Survey

Archaeological survey implies the systematic procedure of the identification of archaeological sites. An archaeological survey of the footprint areas subject to this study was conducted in October 2016. The process encompassed a field survey in accordance with standard archaeological practice by which heritage resources are observed and documented. In order to sample surface areas systematically and to ensure a high probability of site recording, the entire land portion of 2.6ha was systematically surveyed on foot by means of a transect survey. GPS reference points identified during the aerial survey were also visited and random spot checks were made (see detail in previous section). Using a Garmin E-trex Legend GPS objects and structures of archaeological / heritage value were recorded and photographed with a Canon 450D Digital camera. Real time aerial mapping and positioning by means of a hand-held tablet-based Google Earth application was also employed on site to investigate possible disturbed areas during the survey.

3.2 Limitations

3.2.1 Access

The project area occurs directly east of the M38 Modderfontein Road and the survey area demarcated for development is directly access via this road. The site is not fenced, access control is not applied to the areas relevant to this assessment and no restrictions were encountered.

3.2.2 Visibility

The surrounding vegetation around Midrand is mostly comprised out of mixed grasslands and some tree cover. However, the landscape around the project area has been transformed by urbanization and visibility at the time of the AIA site inspection (October 2016) was moderate to high (see Figures 3-2 to 3-5). In single cases during the survey sub-surface inspection was possible. Where applied, this revealed no archaeological deposits.



Figure 3-2: General surroundings of the project area, looking east.



Figure 3-3: A general view of the project area, looking north .



Figure 3-4: View of vegetation and ant hills in the project area.



Figure 3-5: A clear change in vegetation (left and right) in a ventral portion of the project area – possibly a sign of water seepage.



Figure 3-6: View of one of many footpaths traversing the project area.



Figure 3-7: A sandstone boulder in the project area.



Figure 3-8: General surroundings in the project area, looking south.



Figure 3-9: View of refuse dumps along the western periphery of the project area at Modderfontein Road.

3.2.3 Limitations and Constraints Summary

The foot site survey for the Modderfontein Fuel Station Development primarily focused around areas of potential heritage sensitivity as well as areas of high human settlement catchment probability (for example near drainage lines, in association with vegetation changes or around soil disturbances). The following constraints were encountered:

- **Visibility:** Visibility proved to be a minor constraint in areas with denser surface cover as well as portions where vegetation is more pristine.

Thus, even though it might be assumed that survey findings are representative of the heritage landscape of the project area for the Modderfontein Fuel Station Development, it should be stated that the possibility exists that individual sites could be missed due to the localised nature of some heritage remains as well as the possible presence of sub-surface archaeology. Therefore, maintaining due cognisance of the integrity and accuracy of the archaeological survey, it should be stated that the heritage resources identified during the study do not necessarily represent all the heritage resources present in the project area. The subterranean nature of some archaeological sites, dense vegetation cover and visibility constraints sometimes distort heritage representations and any additional heritage resources located during consequent development phases must be reported to the Heritage Resources Authority or an archaeological specialist.

3.3 Impact Assessment

For consistency among specialists, impact assessment ratings by Exigo Specialists are generally done using the Plomp¹ impact assessment matrix scale supplied by Exigo. According to this matrix scale, each heritage receptor in the study area is given an impact assessment. A cumulative assessment for the proposed project is also included.

¹ Plomp, H., 2004

4 ARCHAEO-HISTORICAL CONTEXT

4.1 The archaeology of Southern Africa

Archaeology in Southern Africa is typically divided into two main fields of study, the **Stone Age** and the **Iron Age** or **Farmer Period**. The following table provides a concise outline of the chronological sequence of periods, events, cultural groups and material expressions in Southern African pre-history and history.

Table 1 Chronological Periods across Southern Africa

Period	Epoch	Associated cultural groups	Typical Material Expressions
Early Stone Age 2.5m – 250 000 YCE	Pleistocene	Early Hominins: <i>Australopithecines</i> <i>Homo habilis</i> <i>Homo erectus</i>	Typically large stone tools such as hand axes, choppers and cleavers.
Middle Stone Age 250 000 – 25 000 YCE	Pleistocene	First <i>Homo sapiens</i> species	Typically smaller stone tools such as scrapers, blades and points.
Late Stone Age 20 000 BC – present	Pleistocene / Holocene	<i>Homo sapiens sapiens</i> including San people	Typically small to minute stone tools such as arrow heads, points and bladelets.
Early Iron Age / Early Farmer Period 300 – 900 AD	Holocene	First Bantu-speaking groups	Typically distinct ceramics, bead ware, iron objects, grinding stones.
Middle Iron Age (Mapungubwe / K2) / early Later Farmer Period 900 – 1350 AD	Holocene	Bantu-speaking groups, ancestors of present-day groups	Typically distinct ceramics, bead ware and iron / gold / copper objects, trade goods and grinding stones.
Late Iron Age / Later Farmer Period 1400 AD -1850 AD	Holocene	Various Bantu-speaking groups including Venda, Thonga, Sotho-Tswana and Zulu	Distinct ceramics, grinding stones, iron objects, trade objects, remains of iron smelting activities including iron smelting furnace, iron slag and residue as well as iron ore.
Historical / Colonial Period ±1850 AD – present	Holocene	Various Bantu-speaking groups as well as European farmers, settlers and explorers	Remains of historical structures e.g. homesteads, missionary schools etc. as well as, glass, porcelain, metal and ceramics.

4.1.1 The Stone Ages

- The Earlier Stone Age (ESA)

The Earlier Stone Age, from between 1.5 million and 250 000 years ago, refers to the earliest that *Homo sapiens sapiens*' predecessors began making stone tools. The earliest stone tool industry was referred to as the Olduvai Industry, originating from stone artefacts recorded at Olduvai Gorge, Tanzania. The Acheulian Industry, the predominant Southern African Early Stone Age Industry, which replaced the Olduvai Industry approximately 1.5 million years ago, is attested to in diverse environments and over wide geographical areas. The hallmark of the Acheulian Industry is its large cutting tools (LCTs or bifaces), primarily handaxes and cleavers. Bifaces emerged in East Africa more than 1.5 million years ago but have been reported from a wide range of areas, from South Africa to northern Europe and from India to the Iberian coast. Earlier Stone Age deposits typically occur on the flood-plains of perennial rivers. These ESA open sites sometimes contain stone tool scatters and manufacturing debris ranging from pebble tool choppers to core tools such as handaxes and cleavers. These groups seldom actively hunted, and relied heavily on the opportunistic scavenging of meat from carnivore kill sites. The most well-known Early Stone

Age site in Southern Africa is Amanzi Springs, situated about 10km north-east of Uitenhage, near Port Elizabeth (Deacon 1970). In a series of spring deposits a large number of stone tools were found in situ to a depth of 3-4m. Wood and seed material preserved remarkably very well within the spring deposits, and possibly date to between 800 000 to 250 000 years old.

- **The Middle Stone Age (MSA)**

The Middle Stone Age (MSA) spans a period from 250 000-30 000 years ago and focuses on the emergence of modern humans through the change in technology, behaviour, physical appearance, art and symbolism. Various stone artefact industries occur during this time period, although less is known about the time prior to 120 000 years ago, extensive systemic archaeological research is being conducted on sites across Southern Africa dating within the last 120 000 years (Thompson & Marean 2008). The large handaxes and cleavers were replaced by smaller stone artefacts called the MSA flake and blade industries. Surface scatters of these flake and blade industries occur widespread across Southern Africa although rarely with any associated botanical and faunal remains. It is also common for these stone artefacts to be found between the surface and approximately 50-80cm below ground. Fossil bone may in rare cases be associated with MSA occurrences (Gess 1969). These stone artefacts, like the Earlier Stone Age handaxes are usually observed in secondary context with no other associated archaeological material. The MSA is distinguished from the ESA by the smaller-sized and distinctly different stone artefacts and *chaine operateire* (method) used in manufacture, the introduction of other types of artefacts and evidence of symbolic behaviour. The prepared core technique was used for the manufacture of the stone artefacts which display a characteristic faceted striking platform and includes mainly unifacial and bifacial flake blades and points. The Howiesons Poort Industry (80 000-55 000 years ago) is distinguished from the other MSA stone artefacts: the size of tools are generally smaller, the range of raw materials include finer-grained rocks such as silcrete, chalcedony, chert and hornfels, and include segments, backed blades and trapezoids in the stone toolkit which were sometimes hafted (set or glued) onto handles. In addition to stone artefacts, bone was worked into points, possibly hafted, and used as tools for hunting (Deacon & Deacon 1999). Other types of artefacts that have been encountered in archaeological excavations include tick shell beads, the rim pieces of ostrich eggshell (OES) water flasks, ochre-stained pieces of ostrich eggshell and engraved and scratched ochre pieces, as well as the collection of materials for purely aesthetic reasons. The majority of MSA sites occur on flood plains and sometimes in caves and rock shelters. Sites usually consist of large concentrations of knapped stone flakes such as scrapers, points and blades and associated manufacturing debris. Tools may have been hafted but organic materials, such as those used in hafting, seldom remain preserved in the archaeological record. Limited drive-hunting activities are associated with the MSA.

- **The Later Stone Age (LSA)**

The Later Stone Age (LSA) spans the period from about 20 000 years ago until the colonial era, although some communities continue making stone tools today. The period between 30 000 and 20 000 years ago is referred to as the transition from the MSA to LSA; although there is a lack of crucial sites and evidence that represent this change. By the time of the Later Stone Age the genus *Homo*, in southern Africa, had developed into *Homo sapiens sapiens*, and in Europe, had already replaced *Homo neanderthalensis*. The LSA is marked by a series of technological innovations, new tools and artefacts, the development of economic, political and social systems, and core symbolic beliefs and rituals. The stone toolkits changed over time according to time-specific needs and raw material availability, from smaller microlithic Robberg, Wilton Industries and in between, the larger Albany/Oakhurst and the Kabeljous Industries. Bored stones used as part of digging sticks, grooved stones for sharpening and grinding and stone tools fixed to handles with mastic also become more common. Fishing equipment such as hooks, gorges and sinkers also appear within archaeological excavations. Polished bone tools such as eyed needles, awls, linkshafts and arrowheads also become a more common occurrence. Most importantly bows and arrows revolutionized the hunting economy. It was only within the last 2000 years that earthenware pottery was introduced. Before then tortoiseshell bowls were used for cooking and

ostrich eggshell (OES) flasks were used for storing water. Decorative items like ostrich eggshell and marine/fresh water shell beads and pendants were made. Hunting and gathering made up the economic way of life of these communities; therefore, they are normally referred to as hunter-gatherers. Hunter-gatherers hunted both small and large game and gathered edible plant foods from the veld. For those that lived at or close to the coast, marine shellfish and seals and other edible marine resources were available for the gathering. The political system was mainly egalitarian, and socially hunter-gatherers lived in bands of up to twenty people during the scarce resource availability dispersal seasons and aggregated according to kinship relations during the abundant resource availability seasons. Symbolic beliefs and rituals are evidenced by the deliberate burial of the dead and in the rock art paintings and engravings scattered across the Southern African landscape. Sites dating to the LSA are better preserved in rock shelters, although open sites with scatters of mainly stone tools can occur. Well-protected deposits in shelters allow for stable conditions that result in the preservation of organic materials such as wood, bone, hearths, ostrich eggshell beads and even bedding material. By using San (Bushman) ethnographic data a better understanding of this period is possible. South African rock art is also associated with the LSA.

4.1.2 The Iron Age Farmer Period

- Early Iron Age (Early Farming Communities)

The Early Iron Age (also Early Farmer Period) marks the movement of Bantu speaking farming communities into South Africa at around 200 A.D. These groups were agro-pastoralists that settled in the vicinity of water in order to provide subsistence for their cattle and crops. Artefact evidence from Early Farmer Period sites is mostly found in the form of ceramic assemblages and the origins and archaeological identities of this period are largely based upon ceramic typologies and sequences, where diagnostic pottery assemblages can be used to infer group identities and to trace movements across the landscape. Early Farmer Period ceramic traditions are classified by some scholars into different “streams” or trends in pot types and decoration that over time emerged in Southern Africa. These “streams” are identified as the Kwale Branch (east), the Nkope Branch (central) and the Kalundu Branch (west). More specifically, in the northern regions of South Africa at least three settlement phases have been distinguished for prehistoric Bantu-speaking agro-pastoralists. The first phase of the Early Iron Age, known as Happy Rest (named after the site where the ceramics were first identified), is representative of the Western Stream of migrations, and dates to AD 400-AD 600. The second phase of Diamant is dated to AD 600-AD 900 and was first recognized at the eponymous site of Diamant in the western Waterberg. The third phase, characterised by herringbone-decorated pottery of the Eiland tradition, is regarded as the final expression of the Early Iron Age (EIA) and occurs over large parts of the North West Province, Northern Province, Gauteng and Mpumalanga. This phase has been dated to about AD 900-AD 1200. Early Farmer Period ceramics typically display features such as large and prominent inverted rims, large neck areas and fine elaborate decorations. The Early Iron Age continued up to the end of the first millennium AD.

- Middle Iron Age / K2 Mapungubwe Period (early Later Farming Communities)

The onset of the middle Iron Age dates back to ±900 AD, a period more commonly known as the Mapungubwe / K2 phase. These names refer to the well-known archaeological sites that are today the pinnacle of South Africa’s Iron Age heritage. The inhabitants of K2 and Mapungubwe, situated on the banks of the Mpumalanga, were agriculturalists and pastoralists and were engaged in extensive trade activities with local and foreign traders. Although the identity of this Bantu-speaking group remains a point of contestation, the Mapungubwe people were the first state-organized society Southern Africa has known. A considerable amount of golden objects, ivory, beads (glass and gold), trade goods and clay figurines as well as large amounts of potsherds were found at these sites and also appear in sites dating back to this phase of the Iron Age. Ceramics of this tradition take the form of beakers with upright sides and decorations around the base (K2) and shallow-shouldered bowls with decorations as well as globular pots with long necks. (Mapungubwe). The site of Mapungubwe was deserted at around 1250 AD and this also marks the

relative conclusion of this phase of the Iron Age.

- **Later Iron Age (Later Farming Communities)**

The late Iron Age of Southern Africa marks the grouping of Bantu speaking groups into different cultural units. It also signals one of the most influential events of the second millennium AD in Southern Africa, the difaqane. The difaqane (also known as “the scattering”) brought about a dramatic and sudden ending to centuries of stable society in Southern Africa. Reasons for this change was essentially the first penetration of the Southern African interior by Portuguese traders, military conquests by various Bantu speaking groups primarily the ambitious Zulu King Shaka and the beginning of industrial developments in South Africa. Different cultural groups were scattered over large areas of the interior. These groups conveyed with them their customs that in the archaeological record manifest in ceramics, beads and other artefacts. This means that distinct pottery typologies can be found in the different late Iron Age groups of South Africa.

- **Bantu Speaking Groups in the South African interior**

It should be noted that terms such as “Nguni”, “Sotho”, “Venda” and others refer to broad and comprehensive language groups that demonstrated similarities in their origins and language. It does not imply that these Nguni / Sotho groups were homogeneous and static; they rather moved through the landscape and influenced each other in continuous processes marked by cultural fluidity.

Ethnographers generally divide major Bantu-speaking groups of Southern Africa into two broad linguistic groups, the Nguni and the Sotho with smaller subdivisions under these two main groups. Nguni groups were found in the eastern parts of the interior of South Africa and can be divided into the northern Nguni and the southern Nguni. The various Zulu and Swazi groups were generally associated with the northern Nguni whereas the southern Nguni comprised the Xhosa, Mpondo, Thembu and Mpondomise groups. The same geographically based divisions exist among Sotho groups where, under the western Sotho (or Tswana), groups such as the Rolong, Hurutshe, Kwena, Fokeng and Kgatla are found. The northern Sotho included the Pedi and amalgamation of smaller groups united to become the southern Sotho group or the Basutho. Other smaller language groups such as the Venda, Lemba and Tshonga Shangana transpired outside these major entities but as time progressed they were, however to lesser or greater extent influenced and absorbed by neighbouring groups.

4.1.3 Pastoralism and the last 2000 years

Until 2000 years ago hunter-gatherer communities traded, exchanged goods, encountered and interacted with other hunter-gatherer communities. From about 2000 years ago the social dynamics of the Southern African landscape started changing with the immigration of two 'other' groups of people, different in physique, political, economic and social systems, beliefs and rituals. One of these groups, the Khoekhoe pastoralists or herders entered Southern Africa with domestic animals, namely fat-tailed sheep and goats, travelling through the south towards the coast. They also introduced thin-walled pottery common in the interior and along the coastal regions of Southern Africa. Their economic systems were directed by the accumulation of wealth in domestic stock numbers and their political make-up was more hierarchical than that of the hunter-gatherers.

4.1.4 Historical and Colonial Times and Recent History

The Historical period in Southern Africa encompass the course of Europe's discovery of South Africa and the spreading of European settlements along the East Coast and subsequently into the interior. In addition, the formation stages of this period are marked by the large scale movements of various Bantu-speaking groups in the interior of South Africa, which profoundly influenced the course of European settlement. Finally, the final retreat of the San and Khoekhoen groups into their present-day living areas also occurred in the Historical period in Southern Africa.

4.2 The Gauteng Heritage Landscape: Specific Themes.

The history of Gauteng is reflected in a rich archaeological landscape. Sites, documenting Earlier, Middle and Later Stone Age habitation occur across the province, mostly in open air locales or in sediments alongside rivers or pans. In addition, a wealth of Later Stone Age rock art sites, most of which are in the form of rock engravings are to be found in the larger landscape. These sites occur on hilltops, slopes, rock outcrops and occasionally in river beds. Later, Bantu-speaking tribes moved into this area from the northern parts of Southern Africa and settled here. These were presumably Sotho-Tswana herder groups during the Late Iron Age times during the period AD 1500-1800. Settlement by Iron Age communities took place near rivers and close to rocky outcrops. Clusters of trees often indicate the presence of remaining stone walls and other structures. White farmers, settling in the area since the middle of the 19th century, divided up the landscape into a number of farms, which even today form the framework for agricultural, residential and other forms of development. Stands of poplar, palm, eucalyptus, pine and other trees often indicate the presence of farmsteads and proved to be helpful in tracing these cultural resources. The area is also divided by a historic railway line (dating back to the 1890s) and a large number of major and minor roads, some of which date back to the previous century, and along which a number of the area's older cultural resources (for example shops, farms, cemeteries, industrial sites) have been identified. For the largest part, the Midrand landscape is today a large residential, industrial and commercial hub, often engulfing and obliterating farmsteads, graveyards and other signs of earlier human occupation.

4.2.1 The Stone Ages

The history of human occupation of and settlement in the Midrand area, known so far, goes back at least 150 000 years, when groups of Early Stone Age people appeared periodically. These people survived by manufacturing simple tools and weapons of stone, bone and wood, which they used for hunting and gathering edible plants. No permanent settlement took place, and only deposits of stone artefacts, such as the one which previously existed on have remained behind. Following the Early Stone Age, Midrand was the scene of the periodic occupation by Middle and probably also by Late Stone age groups. Some of the local rock was suitable for manufacturing stone artefacts, as is evident on the farm Waterval. Settlement, which was only of a temporary nature, often occurred at sheltered spots close to rivers, such as Glenferness Cave. Numerous Middle Stone Age implements have been and are still are to be found along water-courses. The Later Stone Age (LSA) is of importance in geological terms as it marks the transition from the Pleistocene to the Holocene which was accompanied by a gradual shift from cooler to warmer temperatures. This change had its greatest influence on the higher lying areas of South Africa. Later Stone Age (LSA) sites occur both at the coast and inland as caves deposits, rock shelters, open sites and shell deposits. Excavations by Mason (1997) at the Boulders shopping centre (south east of the study area) was aimed at interpreting the cultural layering of the Midrand area and provides a good platform for understanding the cultural use of the landscape in this area. He identified 7 occupational layers in his excavations that can be broadly divided into Stone Age, Iron Age and historical occupations. MSA and LSA material was also recorded at Glenn Ferness cave. Huffman conducted an AIA for a residential development at Blue Hills to the west of the study area and recorded LSA material here.

4.2.2 The Iron Age / Farmer Period

The beginnings of the Iron Age (Farmer Period) in southern Africa are associated with the arrival of a new Bantu speaking population. Iron Age people moved into southern Africa by c. AD 200, entering the area either by moving down the coastal plains, or by using a more central route. These newcomers introduced a new way of life into areas that were occupied by Later Stone Age hunter-gatherers and Khoekhoe herders. Distinctive features of the Iron Age are a settled village life, food production (agriculture and animal husbandry), metallurgy (the mining, smelting and working of iron, copper and gold) and the manufacture

of pottery. Occupation of Midrand by the first groups of Iron Age settlers commenced about 1600 years ago. These people spoke Bantu languages, such as Tswana, kept domesticated animals, grew crops and manufactured pots and iron implements. Like the Stone Age people, they also hunted and gathered edible plants. A site such as The Boulders was probably occupied by early Iron Age groups between 350 and 600 AD, followed by new periods of settlement by Tswana-speaking groups since the early 16th century. Several previous studies are on record for the general study area (Mason 1997, Huffman 1999 and Marais & Botes 2014 as well as Van Schalkwyk 1998 & 2007 and Van der Walt 2014). Mason's excavations for the boulders shopping centre south of the current study area uncovered occupation levels dating to the, Iron Age periods.

4.2.3 Later History and Colonial Period

In the 1820s the first white people appeared on the scene, hunters, traders, missionaries and other travellers. Permanent occupation by whites began in the early 1840s, when Voortrekker farmers such as Frederik Andries Strydom and Johannes Elardus Erasmus established the farms Olifantsfontein and Randjesfontein respectively. Gradually the entire area was divided into farms, often with names which describe the local geographical conditions: Blue Hills, Witbos, Witpoort, Kaalfontein, Waterval, Zevenfontein, Witsloot, Diepsloot, and others. However, it was only since the 1880s that these farms were formally surveyed and mapped, and when not only their names, but also the names of rivers (Kaalspruit, Jukskei, etc) and other features became permanent fixtures on maps. Until well into the 20th century, the development of Midrand was determined by local agriculture. The original farms, which became more and more subdivided as the number of farmers increased, supplied food and fibre to the burgeoning populations of Pretoria in the north and the Witwatersrand in the south. Of the 19th and early 20th century farmsteads, only a few have survived, for example Bibury Grange, Blue Hills and Kaalfontein. Pretoria and Johannesburg were connected by stage-coach and post-cart services in the 1880s, and a stop-over station where horse and mule teams could be changed and passengers could rest was developed midway between the two towns. This facility became known as the 'Halfway House'. A year later, when it was predicted that the proposed railway line between the Witwatersrand and Pretoria would pass Halfway House, a township, known as 'Waterval Mooigelegen', was surveyed, which made provision for a station, government offices, shops and a market. However, the railway bypassed Halfway House to the east, and thus Midrand's first railway station was opened on the farm Olifantsfontein in 1892. Although the proposed township did not materialise, public interest had been kindled. Halfway House was discovered by many of the wealthy in Johannesburg, who began establishing country resorts where they could relax and pursue rural sports and hobbies such as horseriding. President Kruger often stopped over at the Halfway House Hotel during trips between Johannesburg and Pretoria. The Gibson brothers, who owned a stage-coach company, bought large tracts of land on the Jukskei River where they bred cattle and established a tree nursery. The old eucalyptus trees lining the Old Pretoria Road probably originated here.

Halfway House became a town in 1920, and in 1925 Halfway House Estate was established. Industrial, commercial and residential development, as symbolised by the opening of a post-office in 1939, only began in the late 1930s as a result of Halfway House's central and accessible location in the heart of Gauteng. A feature of the 1930s and 1940s was the establishment of large agricultural estates, for example Crowthorne and Beaulieu, which in later years were subdivided into smallholdings for purchase by wealthy members of the public. This period also saw the development of Midrand as a mecca for flying sport (Grand Central Flying Club 1937), motor racing (Grand Central Speedway 1948) and horseriding (Lippizaner equestrian centre) While Halfway House became the western development nucleus of the Midrand area, the same happened at Olifantsfontein in the east. When the Germiston-Pretoria railway line was surveyed in the early 1890s, extensive limestone and fire clay deposits were discovered east of the old Strydom farmstead on Olifantsfontein by John Richard Holmes. He established a lime-burning company in 1895,

which was soon followed by a brick-making firm. When Conrand tottered on the brick of bankruptcy, Cullinan started a pottery factory in Olifantsfontein. It was not very successful and it closed down in 1914.

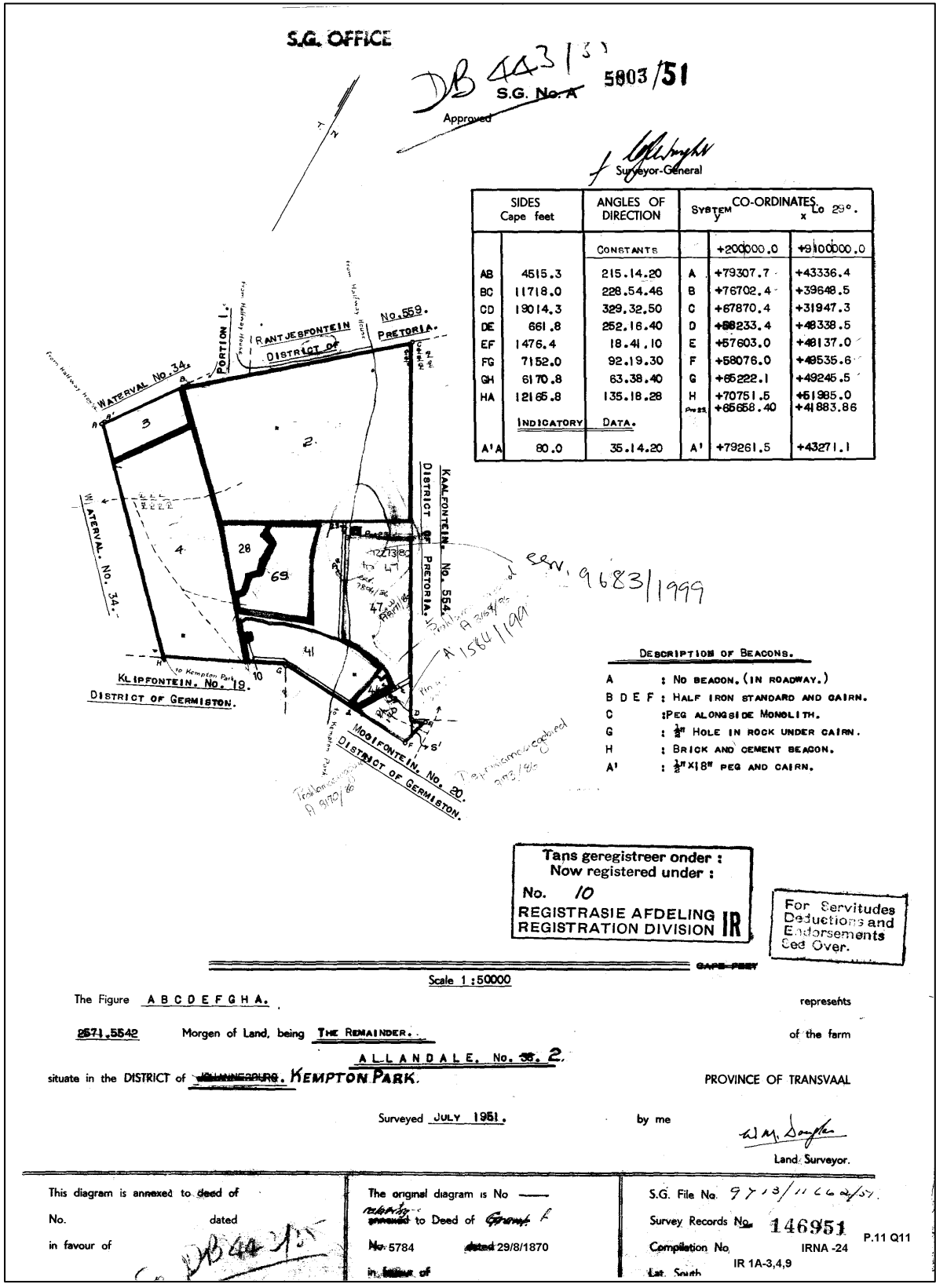

Figure 4-1: Title deed for the farm, Allandale, circa 1951.

In 1926 the business was revived when the Ceramic Studio was established, which became especially famous for the production of tile murals for decorating many government buildings erected in the 1930s, including the Halfway House post-office. The growth of Conrand and the Ceramic Studio led to residential and commercial development in Olifantsfontein, and in 1940 the Clayville township was established. Although Halfway House and Clayville had already been established, the first form of proper local government for these townships only was instituted in 1944, when the Halfway House/Olifantsfontein area came under the jurisdiction of the Transvaal Peri-Urban Areas Health (later Development) Board. In 1951 the Halfway House Local Area Committee was established as a form of local government under the jurisdiction of this Board. In 1964 a similar structure was instituted for Clayville/Olifantsfontein. These two Local Area Committees ceased to exist in 1981, when they amalgamated to form a fully-fledged new local authority known as Midrand.

4.2.4 The Voortrekkers and the Anglo-Boer War

The Anglo-Boer War (1899-1902) also touched Midrand, and for a short period it was a key focus of the British war effort, when the British forces under Lord Roberts advanced through Midrand from Johannesburg en route to Pretoria, which was occupied on 5 June 1900. A few British military units were stationed in the Midrand area, for example at the present Escom Training Centre and at Bibury Grange. No major battles took place in Midrand and the armed conflict was limited to Boer attempts at sabotaging the railway line, attacks on troop trains and other minor skirmishes. A notable event was the Boer demolition of the railway culvert near the present Pinedene Station, which had to be completely rebuilt by the Imperial Military Railways in 1901.

5 RESULTS: ARCHAEOLOGICAL SURVEY

In terms of heritage resources, the landscape around the project area is primarily well known for the occurrence of Historical Period occurrences and human burials. However, the proposed Modderfontein Fuel Station Development footprint area are situated in surrounds that have been sterilised of potential heritage resources, especially those dating to pre-Colonial and prehistoric times and no heritage receptors were documented during the site survey. The absence of heritage sites might be attributed to the fact that the Midrand area have been transformed throughout by farming and urbanization.

5.1 The Stone Age

Stone Age remains associated with caves, outcrops/hills and river courses are known to exist in the larger Midrand area. However, no stone tools or associated material culture or evidence of any factory or workshop site were found in the project areas.

5.2 The Iron Age Farmer Period

A frontier zone between the east and the west, the Gauteng landscape is rich in precolonial Iron Age Farmer Period remnants. However, the site inspection produced no Iron Age farmer sites.

5.3 Colonial Period and recent times

European and local farming communities settled in Gauteng and the Highveld during the Colonial Period in the last century. Archival maps and historical aerial photos of the areas directly surrounding the project area indicate few historical features or settlements. However, no Colonial Period occurrences were observed in any of the survey areas. In terms of the built environment, the area has no significance, as there are no old buildings, structures, or features, old equipment, public memorial or monuments in the footprint areas.

5.4 Graves

No human burials or graves were documented in the project area but previous studies (e.g. Pistorius, Van Vollenhoven) identified large numbers of formal and in informal burial grounds in the surrounding landscape.

6 RESULTS: STATEMENT OF SIGNIFICANCE AND IMPACT RATING

6.1 Potential Impacts and Significance Ratings²

The following section provides a background to the identification and assessment of possible impacts and alternatives, as well as a range of risk situations and scenarios commonly associated with heritage resources management. A guideline for the rating of impacts and recommendation of management actions for areas of heritage potential within the study area is supplied in Section 10.2 of the Addendum.

6.1.1 General assessment of impacts on resources

Generally, the value and significance of archaeological and other heritage sites might be impacted on by any activity that would result immediately or in the future in the destruction, damage, excavation, alteration, removal or collection from its original position, any archaeological material or object (as indicated in the National Heritage Resources Act (No 25 of 1999)). Thus, the destructive impacts that are possible in terms of heritage resources would tend to be direct, once-off events occurring during the initial construction period. However, in the long run, the proximity of operations in any given area could result in secondary indirect impacts. The EIA process therefore specifies impact assessment criteria which can be utilised from the perspective of a heritage specialist study which elucidates the overall extent of impacts.

6.1.2 Direct impact rating

Direct or primary effects on heritage resources occur at the same time and in the same space as the activity, e.g. loss of historical fabric through demolition work. **Indirect effects or secondary effects** on heritage resources occur later in time or at a different place from the causal activity, or as a result of a complex pathway, e.g. restriction of access to a heritage resource resulting in the gradual erosion of its significance, which is dependent on ritual patterns of access (refer to Section 10.3 in the Addendum for an outline of the relationship between the significance of a heritage context, the intensity of development and the significance of heritage impacts to be expected).

No heritage receptors were found in the project area and no direct or indirect impact to heritage resources is foreseen.

6.2 Evaluation Impacts

Previous studies conducted along Highveld regions around Middelburg suggest a rich and diverse archaeological landscape but the surroundings of the Modderfontein Fuel Station Development have been transformed by maize farming, mining, prospecting and related developments. Cognisance should nonetheless be taken of archaeological material that might be present in surface and sub-surface deposits along drainage lines and in pristine areas.

No heritage resources were noted in the proposed Modderfontein Fuel Station Development footprints. It is the opinion of the author of this Archaeological Impact Assessment Report that the proposed Modderfontein Fuel Station Development may proceed from a culture resources management

² Based on: Winter, S. & Baumann, N. 2005. *Guideline for involving heritage specialists in EIA processes: Edition 1.*

perspective, provided that no previously undetected heritage remains are found at any point in construction and operational phases.

6.2.1 Archaeology

The study did not identify any archaeological receptors which will be directly impacted by the proposed project and no impact on archaeological sites or features is anticipated.

6.2.2 Built Environment

The study has not identified any buildings or structures which will be impacted by the proposed project. This is confirmed by an examination of aerial photographs of the area. No impact on built environment sites is therefore anticipated.

6.2.3 Cultural Landscape

Even though the larger Gauteng area around Midrand comprises a relatively rich cultural landscape, the landscape surrounding the proposed project areas have been transformed by farming and urbanization. Further away from the project area, the landscape is typical of the central Highveld with large areas of flat plains and undulating hills and urban zones occurring throughout. This landscape stretches over many kilometres and the proposed project is unlikely to result in a significant impact on the landscape.

6.2.4 Graves / Human Burials Sites

No human burials or graves were documented in the project area. In the rural areas of the Gauteng Province graves and cemeteries sometimes occur within settlements or around homesteads but they are also randomly scattered around archaeological and historical settlements. The probability of additional and informal human burials encountered during development should thus not be excluded. In addition, human remains and burials are commonly found close to archaeological sites; they may be found in "lost" graveyards, or occur sporadically anywhere as a result of prehistoric activity, victims of conflict or crime. It is often difficult to detect the presence of archaeological human remains on the landscape as these burials, in most cases, are not marked at the surface. Human remains are usually observed when they are exposed through erosion. In some instances packed stones or rocks may indicate the presence of informal pre-colonial burials. If any human bones are found during the course of construction work then they should be reported to an archaeologist and work in the immediate vicinity should cease until the appropriate actions have been carried out by the archaeologist. Where human remains are part of a burial they would need to be exhumed under a permit from SAHRA (for pre-colonial burials as well as burials later than about AD 1500). Should any unmarked human burials/remains be found during the course of construction, work in the immediate vicinity should cease and the find must immediately be reported to the archaeologist, or the South African Heritage Resources Agency (SAHRA). Under no circumstances may burials be disturbed or removed until such time as necessary statutory procedures required for grave relocation have been met.

6.3 Management actions

Recommendations for relevant heritage resources management actions are vital to the conservation of heritage resources. A general guideline for recommended management actions is included in Section 10.4 of the Addendum. The following management measures would be required during implementation of the proposed Modderfontein Fuel Station Development.

OBJECTIVE: prevent unnecessary disturbance and/or destruction of previously undetected heritage receptors.

No specific action in terms of mitigation is required for the footprint areas of the Modderfontein Fuel Station Development. However, the following general procedure is required for the site:

PROJECT COMPONENT/S	All phases of construction and operation.		
POTENTIAL IMPACT	Damage/destruction of sites.		
ACTIVITY RISK/SOURCE	Digging foundations and trenches into sensitive deposits that are not visible at the surface.		
MITIGATION: TARGET/OBJECTIVE	To locate previously undetected heritage remains / graves as soon as possible after disturbance so as to maximize the chances of successful rescue/mitigation work.		
MITIGATION: ACTION/CONTROL	RESPONSIBILITY	TIMEFRAME	
Fixed Mitigation Procedure (required)			
Site Monitoring: Regular examination of trenches and excavations.	ECO	Monitor as frequently as practically possible.	
PERFORMANCE INDICATOR	Archaeological sites are discovered and mitigated with the minimum amount of unnecessary disturbance.		
MONITORING	Successful location of sites by person/s monitoring.		

7 RECOMMENDATIONS

Previous heritage studies conducted in the Gauteng Province region around Midrand suggest a rich and diverse archaeological landscape but the surroundings of the proposed Modderfontein Fuel Station Development have been transformed by farming, urbanisation and related infrastructure developments. Cognisance should nonetheless be taken of archaeological material that might be present in surface and sub-surface deposits along drainage lines and in pristine areas. The following recommendations are made based on general observations in the proposed Modderfontein Fuel Station Development area:

- A Palaeontological Impact Assessment is recommended where bedrock is to be impacted and, should fossil remains such as fossil fish, reptiles or petrified wood be exposed during construction, these objects should carefully safeguarded and the relevant heritage resources authority (SAHRA) should be notified immediately so that the appropriate action can be taken by a professional palaeontologist.
- Considering the localised nature of heritage remains, the general monitoring of the development progress by an ECO or by the heritage specialist is recommended for all stages of the project. Should any subsurface palaeontological, archaeological or historical material, or burials be exposed during construction activities, all activities should be suspended and the archaeological specialist should be notified immediately
- It is essential that cognisance be taken of the larger archaeological landscape of the area in order to avoid the destruction of previously undetected heritage sites. It should be stated that it is likely that further undetected archaeological remains might occur elsewhere in the Study Area along water sources and drainage lines, fountains and pans would often have attracted human activity in the past. Also, since Stone Age material seems to originate from below present soil surfaces in eroded areas, the larger landscape should be regarded as potentially sensitive in terms of possible subsurface deposits. Burials and historically significant structures dating to the Colonial Period occur on farms in the area and these resources should be avoided during all phases of construction and development, including the operational phases of the development.

In addition to these site-specific recommendations, careful cognizance should be taken of the following:

- As Palaeontological remains occur where bedrock has been exposed, all geological features should be regarded as sensitive.
- Water sources such as drainage lines, fountains and pans would often have attracted human activity in the past. As Stone Age material the larger landscape should be regarded as potentially sensitive in terms of possible subsurface deposits.

8 GENERAL COMMENTS AND CONDITIONS

This AIA report serves to confirm the extent and significance of the heritage landscape of the proposed Modderfontein Fuel Station Development area. The larger heritage horizon encompasses rich and diverse archaeological landscapes and cognisance should be taken of heritage resources and archaeological material that might be present in surface and sub-surface deposits. If, during construction, any possible archaeological material culture discoveries are made, the operations must be stopped and a qualified archaeologist be contacted for an assessment of the find. Such material culture might include:

- Formal Earlier Stone Age stone tools.
- Formal MSA stone tools.
- Formal LSA stone tools.
- Potsherds
- Iron objects.
- Beads made from ostrich eggshell and glass.
- Ash middens and cattle dung deposits and accumulations.
- Faunal remains.
- Human remains/graves.
- Stone walling or any sub-surface structures.
- Historical glass, tin or ceramics.
- Fossils.

If such sites were to be encountered or impacted by any proposed developments, recommendations contained in this report, as well as endorsement of mitigation measures as set out by Gauteng-PHRA, SAHRA, the National Resources Act and the CRM section of ASAPA will be required.

It must be emphasised that the conclusions and recommendations expressed in this archaeological heritage sensitivity investigation are based on the visibility of archaeological sites/features and may not therefore, represent the area's complete archaeological legacy. Many sites/features may be covered by soil and vegetation and might only be located during sub-surface investigations. If subsurface archaeological deposits, artefacts or skeletal material were to be recovered in the area during construction activities, all activities should be suspended and the archaeological specialist should be notified immediately (**cf. NHRA (Act No. 25 of 1999), Section 36 (6)**). It must also be clear that Archaeological Specialist Reports will be assessed by the relevant heritage resources authority (SAHRA).

9 BIBLIOGRAPHY

Acocks, J.P.H. 1988. Veld types of South Africa (3rd edition). Memoirs of the Botanical Survey of South Africa 57: 1-146

Bergh, J.S. (ed.). 1999. Geskiedenis Atlas van Suid-Afrika: Die Vier Noordelike Provinsies. J.L. van Schaik. Pretoria

Deacon, J. 1996. Archaeology for Planners, Developers and Local Authorities. National Monuments Council. Publication no. P021E.

Deacon, J. 1997. Report: Workshop on Standards for the Assessment of Significance and Research Priorities for Contract Archaeology. In: Newsletter No 49, Sept 1998. Association for Southern African Archaeologists.

Deacon HJ and J. Deacon (1999): Human beginnings in South Africa: uncovering the secrets of the Stone Age. David Philip. Cape Town

Esterhuysen, A., 2007. The Earlier Stone Age. In Bonner, P., Esterhuysen, A., Jenkins, T. (eds.): A Search for Origins: Science, History and South Africa's 'Cradle of Humankind'. Johannesburg: Wits University Press. Pg 110 -121.

Evers, T.M. 1988. The recognition of Groups in the Iron Age of Southern Africa. PhD thesis. Johannesburg: University of the Witwatersrand.

Huffman, T.N. 2002 Archaeological Assessment for the Gautrain University of the Witwatersrand - Archaeological Resources Management

Huffman, T.N. 2007. Handbook to the Iron Age. Pietermaritzburg: University of Kwazulu-Natal Press

Kruger, N. 2015. Archaeological Impact Assessment for the K101 Road Upgrade Project, Midrand, Gauteng. Exigo Sustainability.

Maggs, T.M.O. 1976. Iron Age Communities of the Southern Highveld. Pietermaritzburg: University of Natal Press.

Maggs, T. The Iron Age farming communities. In Duminy, A. and Guest, B. 1989. Natal and Zululand: from Earliest Times to 1910. A New History. Pg. 28-46. University of Natal Press. Pietermaritzburg

Mitchell, P. 2002. The Archaeology of Southern Africa. Cambridge Africa Collection. Cambridge: Cambridge University Press.

Raper, P.E. 2004. South African place names. Johannesburg: Jonathan Ball Publishers

Swanepoel, N. et al (Eds.) 2008. Five hundred years rediscovered. Johannesburg: Wits University Press

Van der Ryst, M.M. 1996. The later Stone Age Prehistory of the Waterberg, with special reference to Goergap Shelter. MA Thesis: Department of Archaeology, University of the Witwatersrand.

Van der Walt, J. 2015. Archaeological Impact Assessment For the proposed Midridge Park Ext. 25 Township Development, Midrand, Gauteng. Heritage Contracts and Archaeological Consulting

Van Schalkwyk, J.A. 1999. A Survey of Cultural Resources in the Midrand Municipal Area National Cultural History Museum

Van Schalkwyk, J.A. 2006. Addendum to the heritage impact assessment for the proposed Gautrain Rapid Rail Link, Gauteng Province, South Africa, Unpublished report 2006/JvS/070. Pretoria

Van Warmelo, N.J. 1935. A Preliminary Survey of the Bantu Tribes of South Africa. Department of Native Affairs, Ethnological Publications Vol. V. Pretoria: Government Printer.

Human Tissue Act and Ordinance 7 of 1925, Government Gazette, Cape Town

National Heritage Resources Act No.25 of 1999, Government Gazette, Cape Town

SAHRA, 2005. *Minimum Standards for the Archaeological and the Palaeontological Components of Impact Assessment Reports, Draft version 1.4.*

www.sahra.org.za/sahris

Accessed 2017-02-10

<http://csg.dla.gov.za/index.html>

Accessed 2017-02-10

10 ADDENDUM 1: HERITAGE LEGISLATION BACKGROUND

10.1 CRM: Legislation, Conservation and Heritage Management

The broad generic term *Cultural Heritage Resources* refers to any physical and spiritual property associated with past and present human use or occupation of the environment, cultural activities and history. The term includes sites, structures, places, natural features and material of palaeontological, archaeological, historical, aesthetic, scientific, architectural, religious, symbolic or traditional importance to specific individuals or groups, traditional systems of cultural practice, belief or social interaction.

10.1.1 Legislation regarding archaeology and heritage sites

The South African Heritage Resources Agency (SAHRA) and their provincial offices aim to conserve and control the management, research, alteration and destruction of cultural resources of South Africa. It is therefore vitally important to adhere to heritage resource legislation at all times.

d. National Heritage Resources Act No 25 of 1999, section 35

According to the National Heritage Resources Act of 1999 a historical site is any identifiable building or part thereof, marker, milestone, gravestone, landmark or tell older than 60 years. This clause is commonly known as the "60-years clause". Buildings are amongst the most enduring features of human occupation, and this definition therefore includes all buildings older than 60 years, modern architecture as well as ruins, fortifications and Iron Age settlements. "Tell" refers to the evidence of human existence which is no longer above ground level, such as building foundations and buried remains of settlements (including artefacts).

The Act identifies heritage objects as:

- objects recovered from the soil or waters of South Africa including archaeological and palaeontological objects, meteorites and rare geological specimens
- visual art objects
- military objects
- numismatic objects
- objects of cultural and historical significance
- objects to which oral traditions are attached and which are associated with living heritage
- objects of scientific or technological interest
- any other prescribed category

With regards to activities and work on archaeological and heritage sites this Act states that:

"No person may alter or demolish any structure or part of a structure which is older than 60 years without a permit by the relevant provincial heritage resources authority." (34. [1] 1999:58)

and

"No person may, without a permit issued by the responsible heritage resources authority-

- (d) *destroy, damage, excavate, alter, deface or otherwise disturb any archaeological or palaeontological site or any meteorite;*
- (e) *destroy, damage, excavate, remove from its original position, collect or own any archaeological or palaeontological material or object or any meteorite;*

- (f) *trade in, sell for private gain, export or attempt to export from the Republic any category of archaeological or palaeontological material or object, or any meteorite; or*
- (g) *bring onto or use at an archaeological or palaeontological site any excavation equipment or any equipment which assist in the detection or recovery of metals or archaeological and palaeontological material or objects, or use such equipment for the recovery of meteorites. (35. [4] 1999:58)."*

and

"No person may, without a permit issued by SAHRA or a provincial heritage resources agency-

- (h) *destroy, damage, alter, exhume or remove from its original position or otherwise disturb the grave of a victim of conflict, or any burial ground or part thereof which contains such graves;*
- (i) *destroy, damage, alter, exhume, remove from its original position or otherwise disturb any grave or burial ground older than 60 years which is situated outside a formal cemetery administered by a local authority;*
- (j) *bring onto or use at a burial ground or grave referred to in paragraph (a) or (b) and excavation equipment, or any equipment which assists in the detection or recovery of metals (36. [3] 1999:60)."*

e. Human Tissue Act of 1983 and Ordinance on the Removal of Graves and Dead Bodies of 1925

Graves 60 years or older are heritage resources and fall under the jurisdiction of both the National Heritage Resources Act and the Human Tissues Act of 1983. However, graves younger than 60 years are specifically protected by the Human Tissues Act (Act 65 of 1983) and the Ordinance on the Removal of Graves and Dead Bodies (Ordinance 7 of 1925) as well as any local and regional provisions, laws and by-laws. Such burial places also fall under the jurisdiction of the National Department of Health and the Provincial Health Departments. Approval for the exhumation and re-burial must be obtained from the relevant Provincial MEC as well as the relevant Local Authorities.

10.1.2 Background to HIA and AIA Studies

South Africa's unique and non-renewable archaeological and palaeontological heritage sites are 'generally' protected in terms of the National Heritage Resources Act (Act No 25 of 1999, section 35) and may not be disturbed at all without a permit from the relevant heritage resources authority. Heritage sites are frequently threatened by development projects and both the environmental and heritage legislation require impact assessments (HIAs & AIAs) that identify all heritage resources in areas to be developed. Particularly, these assessments are required to make recommendations for protection or mitigation of the impact of the sites. HIAs and AIAs should be done by qualified professionals with adequate knowledge to (a) identify all heritage resources including archaeological and palaeontological sites that might occur in areas of developed and (b) make recommendations for protection or mitigation of the impact on the sites.

The National Heritage Resources Act (Act No. 25 of 1999, section 38) provides guidelines for Cultural Resources Management and prospective developments:

"38. (1) Subject to the provisions of subsections (7), (8) and (9), any person who intends to undertake a

development categorised as:

- (a) the construction of a road, wall, powerline, pipeline, canal or other similar form of linear development or barrier exceeding 300m in length;*
- (b) the construction of a bridge or similar structure exceeding 50m in length;*
- (c) any development or other activity which will change the character of a site:*
 - (i) exceeding 5 000 m² in extent; or*
 - (ii) involving three or more existing erven or subdivisions thereof; or*
 - (iii) involving three or more erven or divisions thereof which have been consolidated within the past five years; or*
 - (iv) the costs of which will exceed a sum set in terms of regulations by SAHRA or a provincial heritage resources authority;*
- (d) the re-zoning of a site exceeding 10 000 m² in extent; or*
- (e) any other category of development provided for in regulations by SAHRA or a provincial heritage resources authority,*

must at the very earliest stages of initiating such a development, notify the responsible heritage resources authority and furnish it with details regarding the location, nature and extent of the proposed development."

And:

"The responsible heritage resources authority must specify the information to be provided in a report required in terms of subsection (2)(a): Provided that the following must be included:

- (k) The identification and mapping of all heritage resources in the area affected;*
- (l) an assessment of the significance of such resources in terms of the heritage assessment criteria set out in section 6(2) or prescribed under section 7;*
- (m) an assessment of the impact of the development on such heritage resources;*
- (n) an evaluation of the impact of the development on heritage resources relative to the sustainable social and economic benefits to be derived from the development;*
- (o) the results of consultation with communities affected by the proposed development and other interested parties regarding the impact of the development on heritage resources;*
- (p) if heritage resources will be adversely affected by the proposed development, the consideration of alternatives; and*
- (q) plans for mitigation of any adverse effects during and after the completion of the proposed development (38. [3] 1999:64)."*

Consequently, section 35 of the Act requires Heritage Impact Assessments (HIAs) or Archaeological Impact Assessments (AIAs) to be done for such developments in order for all heritage resources, that is, all places or objects of aesthetics, architectural, historic, scientific, social, spiritual, linguistic or technological value or significance to be protected. Thus any assessment should make provision for the

protection of all these heritage components, including archaeology, shipwrecks, battlefields, graves, and structures older than 60 years, living heritage, historical settlements, landscapes, geological sites, palaeontological sites and objects. Heritage resources management and conservation

10.2 Assessing the Significance of Heritage Resources

Archaeological sites, as previously defined in the National Heritage Resources Act (Act 25 of 1999) are places in the landscape where people have lived in the past – generally more than 60 years ago – and have left traces of their presence behind. In South Africa, archaeological sites include hominid fossil sites, places where people of the Earlier, Middle and Later Stone Age lived in open sites, river gravels, rock shelters and caves, Iron Age sites, graves, and a variety of historical sites and structures in rural areas, towns and cities. Palaeontological sites are those with fossil remains of plants and animals where people were not involved in the accumulation of the deposits. The basic principle of cultural heritage conservation is that archaeological and other heritage sites are valuable, scarce and *non-renewable*. Many such sites are unfortunately lost on a daily basis through development for housing, roads and infrastructure and once archaeological sites are damaged, they cannot be re-created as site integrity and authenticity is permanently lost. Archaeological sites have the potential to contribute to our understanding of the history of the region and of our country and continent. By preserving links with our past, we may not be able to revive lost cultural traditions, but it enables us to appreciate the role they have played in the history of our country.

- Categories of significance

Rating the significance of archaeological sites, and consequently grading the potential impact on the resources is linked to the significance of the site itself. The significance of an archaeological site is based on the amount of deposit, the integrity of the context, the kind of deposit and the potential to help answer present research questions. Historical structures are defined by Section 34 of the National Heritage Resources Act, 1999, while other historical and cultural significant sites, places and features, are generally determined by community preferences. The guidelines as provided by the NHRA (Act No. 25 of 1999) in Section 3, with special reference to subsection 3 are used when determining the cultural significance or other special value of archaeological or historical sites. In addition, ICOMOS (the Australian Committee of the International Council on Monuments and Sites) highlights four cultural attributes, which are valuable to any given culture:

- *Aesthetic value:*

Aesthetic value includes aspects of sensory perception for which criteria can and should be stated. Such criteria include consideration of the form, scale, colour, texture and material of the fabric, the general atmosphere associated with the place and its uses and also the aesthetic values commonly assessed in the analysis of landscapes and townscape.

- *Historic value:*

Historic value encompasses the history of aesthetics, science and society and therefore to a large extent underlies all of the attributes discussed here. Usually a place has historical value because of some kind of influence by an event, person, phase or activity.

- *Scientific value:*

The scientific or research value of a place will depend upon the importance of the data involved, on its rarity, quality and on the degree to which the place may contribute further substantial information.

- *Social value:*

Social value includes the qualities for which a place has become a focus of spiritual, political, national or other cultural sentiment to a certain group.

It is important for heritage specialist input in the EIA process to take into account the heritage management structure set up by the NHR Act. It makes provision for a 3-tier system of management including the South Africa Heritage Resources Agency (SAHRA) at a national level, Provincial Heritage Resources Authorities (PHRAs) at a provincial and the local authority. The Act makes provision for two types or forms of protection of heritage resources; i.e. formally protected and generally protected sites:

Formally protected sites:

- Grade 1 or national heritage sites, which are managed by SAHRA
- Grade 2 or provincial heritage sites, which are managed by the provincial HRA (MP-PHRA).
- Grade 3 or local heritage sites.

Generally protected sites:

- Human burials older than 60 years.
- Archaeological and palaeontological sites.
- Shipwrecks and associated remains older than 60 years.
- Structures older than 60 years.

With reference to the evaluation of sites, the certainty of prediction is definite, unless stated otherwise and if the significance of the site is rated high, the significance of the impact will also result in a high rating. The same rule applies if the significance rating of the site is low. The significance of archaeological sites is generally ranked into the following categories.

Significance	Rating Action
No significance: sites that do not require mitigation.	None
Low significance: sites, which may require mitigation.	2a. Recording and documentation (Phase 1) of site; no further action required 2b. Controlled sampling (shovel test pits, augering), mapping and documentation (Phase 2 investigation); permit required for sampling and destruction
Medium significance: sites, which require mitigation.	3. Excavation of representative sample, C14 dating, mapping and documentation (Phase 2 investigation); permit required for sampling and destruction [including 2a & 2b]
High significance: sites, where disturbance should be avoided.	4a. Nomination for listing on Heritage Register (National, Provincial or Local) (Phase 2 & 3 investigation); site management plan; permit required if utilised for education or tourism
High significance: Graves and burial places	4b. Locate demonstrable descendants through social consulting; obtain permits from applicable legislation, ordinances and regional by-laws; exhumation and reinterment [including 2a, 2b & 3]

Furthermore, the significance of archaeological sites was based on six main criteria:

- Site integrity (i.e. primary vs. secondary context),
- Amount of deposit, range of features (e.g., stonewalling, stone tools and enclosures),
- Density of scatter (dispersed scatter),
- Social value,
- Uniqueness, and
- Potential to answer current and future research questions.

A fundamental aspect in assessing the significance and protection status of a heritage resource is often whether or not the sustainable social and economic benefits of a proposed development outweigh the conservation issues at stake. When, for whatever reason the protection of a heritage site is not deemed necessary or practical, its research potential must be assessed and mitigated in order to gain data / information, which would otherwise be lost.

11 ADDENDUM 2: GRAVE RELOCATION AND SITE MANAGEMENT: STATUTORY MANDATE

11.1 Archaeology, graves and the law

Note that four categories of graves can be identified. These are:

- Graves younger than 60 years;
- Graves older than 60 years, but younger than 100 years;
- Graves older than 100 years; and
- Graves of victims of conflict or of individuals of royal descent

In terms of Section 36(3) of the National Heritage Resources Act, no person may, without a permit issued by the relevant heritage resources authority:

- (a) destroy, damage, alter, exhume or remove from its original position or otherwise disturb the grave of a victim of conflict, or any burial ground or part thereof which contains such graves;
- (b) destroy, damage, alter, exhume or remove from its original position or otherwise disturb any grave or burial ground older than 60 years which is situated outside a formal cemetery administered by a local authority; or
- (c) bring onto or use at a burial ground or grave referred to in paragraph (a) Or (b) any excavation, or any equipment which assists in the detection or recovery of metals.

Human remains that are less than 60 years old are subject to provisions of the Human Tissues Act (Act 65 of 1983) and to local regulations. Exhumation of graves must conform to the standards set out in the Ordinance on Excavations (Ordinance no. 12 of 1980) (replacing the old Transvaal Ordinance no. 7 of 1925). Permission must also be gained from the descendants (where known), the National Department of Health, Provincial Department of Health, Premier of the Province and local police. Furthermore, permission must also be gained from the various landowners (i.e. where the graves are located and where they are to be relocated) before exhumation can take place.

A registered undertaker can only handle human remains or an institution declared under the Human Tissues Act (Act 65 of 1983 as amended).

Unidentified/unknown graves are also handled as older than 60 until proven otherwise.

Summary of applicable legislation and legal requirements:

- Human Tissue Act (Act 65 of 1983 as amended).
- Removal of Graves and Dead Bodies Ordinance (Ordinance no. 7 of 1925)
- Ordinance on Excavations (Ordinance no. 12 of 1980)
- Local and regional provisions, laws and by-laws
- National Heritage Resources Act (Act no. 25 of 1999)
- Permit from SAHRA for removal of human remains

11.2 Graves: necessary procedures

When graves are located in an area demarcated for development, the following mitigation options might be considered:

- **Conservation:** The establishment of a 50 meter buffer zone around the burial place which is fenced off and, maintained and conserved. *This option is generally recommended as the relocation of burial places is an extremely complicated, time consuming and sensitive process.*

- **Mitigation and relocation:** In the event where impact on the burial place will occur, mitigation measures may entail full grave relocation. Such a relocation process must be undertaken by suitably qualified individuals with a proven track record. The relocation must also be undertaken in full cognisance of all relevant legislation, including the specific requirements of the National Heritage Resource Act (Act no. 25 of 1999). Furthermore, a concerted effort must also be made to identify all buried individuals and to contact their relatives and descendants. Other legislative measures which may be of relevance include the Removal of Graves and Dead Bodies Ordinance (Ordinance no. 7 of 1925), the Human Tissues Act (Act no. 65 of 1983, as amended), the Ordinance on Excavations (Ordinance no. 12 of 1980) as well as any local and regional provisions, laws and by-laws that may be in place.

Methodology for grave relocations:

- **Documentation:** Physical documentation of graves and determining context of graves prior to exhumation: Photographic, GPS, Site Map, Historical Background.
- **Public Notices:** In order to locate and notify descendant families, notices (in compliance with the National Heritage Resources Act) must be placed on the site/s, indicating the intent of relocation. These notices, translated into at least 3 languages, have to remain in place for a minimum of 60 days. Additionally, newspaper adverts and notices on local radio stations announcements are required.
- **Social consultation:** If any descendant families were located during initial consultation/public participation phases, a full social consultation action will be lodged.
- **Permit application:** Application for a permit from SAHRA can only be obtained after all necessary consent documents from descendant families, landowners and relevant authorities have been secured.
- **Exhumation & relocation**
The exhumation, investigation and reburial of the burial place may commence after SAHRA has issued relevant permits and permissions

12 ADDENDUM 3: CONVENTIONS USED TO ASSESS THE SIGNIFICANCE OF HERITAGE

12.1 Site Significance Matrix

According to the NHRA, Section 2(vi) the **significance** of heritage sites and artefacts is determined by its aesthetic, architectural, historical, scientific, social, spiritual, linguistic or technical value in relation to the uniqueness, condition of preservation and research potential. It must be kept in mind that the various aspects are not mutually exclusive, and that the evaluation of any site is done with reference to any number of these. The following matrix is used for assessing the significance of each identified site/feature.

2. SITE EVALUATION			
2.1 Heritage Value (NHRA, section 2 [3])	High	Medium	Low
It has importance to the community or pattern of South Africa's history or pre-colonial history.			
It possesses unique, uncommon, rare or endangered aspects of South Africa's natural or cultural heritage.			
It has potential to yield information that will contribute to an understanding of South Africa's natural and cultural heritage.			
It is of importance in demonstrating the principle characteristics of a particular class of South Africa's natural or cultural places or objects.			
It has importance in exhibiting particular aesthetic characteristics valued by a particular community or cultural group.			
It has importance in demonstrating a high degree of creative or technical achievement at a particular period.			
It has marked or special association with a particular community or cultural group for social, cultural or spiritual reasons (sense of place).			
It has strong or special association with the life or work of a person, group or organisation of importance in the history of South Africa.			
It has significance through contributing towards the promotion of a local sociocultural identity and can be developed as a tourist destination.			
It has significance relating to the history of slavery in South Africa.			
It has importance to the wider understanding of temporal changes within cultural landscapes, settlement patterns and human occupation.			
2.2 Field Register Rating			
National/Grade 1 [should be registered, retained]			
Provincial/Grade 2 [should be registered, retained]			
Local/Grade 3A [should be registered, mitigation not advised]			
Local/Grade 3B [High significance; mitigation, partly retained]			
Generally Protected A [High/Medium significance, mitigation]			
Generally protected B [Medium significance, to be recorded]			
Generally Protected C [Low significance, no further action]			
2.3 Sphere of Significance	High	Medium	Low
International			
National			
Provincial			
Local			
Specific community			

12.2 Impact Assessment Criteria

The following table provides a guideline for the rating of impacts and recommendation of management actions for sites of heritage potential.

Significance of the heritage resource

This is a statement of the nature and degree of significance of the heritage resource being affected by the activity. From a heritage management perspective it is useful to distinguish between whether the significance is embedded in the physical fabric or in associations with events or persons or in the experience of a place; i.e. its visual and non-visual qualities. This statement is a primary informant to the nature and degree of significance of an impact and thus needs to be thoroughly considered. Consideration needs to be given to the significance of a heritage resource at different scales (i.e. sitespecific, local, regional, national or international) and the relationship between the heritage resource, its setting and its associations.

Nature of the impact

This is an assessment of the nature of the impact of the activity on a heritage resource, with some indication of its positive and/or negative effect/s. It is strongly informed by the statement of resource significance. In other words, the nature of the impact may be historical, aesthetic, social, scientific, linguistic or architectural, intrinsic, associational or contextual (visual or non-visual). In many cases, the nature of the impact will include more than one value.

Extent

Here it should be indicated whether the impact will be experienced:

- On a site scale, i.e. extend only as far as the activity;
- Within the immediate context of a heritage resource;
- On a local scale, e.g. town or suburb
- On a metropolitan or regional scale; or
- On a national/international scale.

Duration

Here it should be indicated whether the lifespan of the impact will be:

- Short term, (needs to be defined in context)
- Medium term, (needs to be defined in context)
- Long term where the impact will persist indefinitely, possibly beyond the operational life of the activity, either because of natural processes or by human intervention; or
- Permanent where mitigation either by natural process or by human intervention will not occur in such a way or in such a time span that the impact can be considered transient.

Of relevance to the duration of an impact are the following considerations:

- Reversibility of the impact; and
- Renewability of the heritage resource.

Intensity

Here it should be established whether the impact should be indicated as:

- Low, where the impact affects the resource in such a way that its heritage value is not affected;
- Medium, where the affected resource is altered but its heritage value continues to exist albeit in a modified way; and
- High, where heritage value is altered to the extent that it will temporarily or permanently be damaged or destroyed.

Probability

This should describe the likelihood of the impact actually occurring indicated as:

- Improbable, where the possibility of the impact to materialize is very low either because of design or historic experience;
- Probable, where there is a distinct possibility that the impact will occur;
- Highly probable, where it is most likely that the impact will occur; or
- Definite, where the impact will definitely occur regardless of any mitigation measures

Confidence

This should relate to the level of confidence that the specialist has in establishing the nature and degree of impacts. It relates to the level and reliability of information, the nature and degree of consultation with I&AP's and the dynamic of the broader socio-political context.

- High, where the information is comprehensive and accurate, where there has been a high degree of consultation and the socio-political context is relatively stable.

- Medium, where the information is sufficient but is based mainly on secondary sources, where there has been a limited targeted consultation and socio-political context is fluid.
- Low, where the information is poor, a high degree of contestation is evident and there is a state of socio-political flux.

Impact Significance

The significance of impacts can be determined through a synthesis of the aspects produced in terms of the nature and degree of heritage significance and the nature, duration, intensity, extent, probability and confidence of impacts and can be described as:

- Low, where it would have a negligible effect on heritage and on the decision
- Medium, where it would have a moderate effect on heritage and should influence the decision.
- High, where it would have, or there would be a high risk of, a big effect on heritage. Impacts of high significance should have a major influence on the decision;
- Very high, where it would have, or there would be high risk of, an irreversible and possibly irreplaceable negative impact on heritage. Impacts of very high significance should be a central factor in decision-making.

12.3 Direct Impact Assessment Criteria

The following table provides an outline of the relationship between the significance of a heritage context, the intensity of development and the significance of heritage impacts to be expected

HERITAGE CONTEXT	TYPE OF DEVELOPMENT			
	CATEGORY A	CATEGORY B	CATEGORY C	CATEGORY D
CONTEXT 1 High heritage Value	Moderate heritage impact expected	High heritage impact expected	Very high heritage impact expected	Very high heritage impact expected
CONTEXT 2 Medium to high heritage value	Minimal heritage impact expected	Moderate heritage impact expected	High heritage impact expected	Very high heritage impact expected
CONTEXT 3 Medium to low heritage value	Little or no heritage impact expected	Minimal heritage impact expected	Moderate heritage impact expected	High heritage impact expected
CONTEXT 4 Low to no heritage value	Little or no heritage impact expected	Little or no heritage impact expected	Minimal heritage value expected	Moderate heritage impact expected

NOTE: A DEFAULT "LITTLE OR NO HERITAGE IMPACT EXPECTED" VALUE APPLIES WHERE A HERITAGE RESOURCE OCCURS OUTSIDE THE IMPACT ZONE OF THE DEVELOPMENT.

HERITAGE CONTEXTS	CATEGORIES OF DEVELOPMENT
<p>Context 1: Of high intrinsic, associational and contextual heritage value within a national, provincial and local context, i.e. formally declared or potential Grade 1, 2 or 3A heritage resources</p> <p>Context 2: Of moderate to high intrinsic, associational and contextual value within a local context, i.e. potential Grade 3B heritage resources.</p> <p>Context 3: Of medium to low intrinsic, associational or contextual heritage value within a national, provincial and local context, i.e. potential Grade 3C heritage resources</p> <p>Context 4: Of little or no intrinsic, associational or contextual heritage value due to disturbed, degraded conditions or extent of irreversible damage.</p>	<p>Category A: Minimal intensity development</p> <ul style="list-style-type: none"> - No rezoning involved; within existing use rights. - No subdivision involved. - Upgrading of existing infrastructure within existing envelopes - Minor internal changes to existing structures - New building footprints limited to less than 1000m2. <p>Category B: Low-key intensity development</p> <ul style="list-style-type: none"> - Spot rezoning with no change to overall zoning of a site. - Linear development less than 100m - Building footprints between 1000m2-2000m2 - Minor changes to external envelop of existing structures (less than 25%) - Minor changes in relation to bulk and height of immediately adjacent structures (less than 25%). <p>Category C: Moderate intensity development</p> <ul style="list-style-type: none"> - Rezoning of a site between 5000m2-10 000m2.

	<ul style="list-style-type: none"> - Linear development between 100m and 300m. - Building footprints between 2000m2 and 5000m2 - Substantial changes to external envelop of existing structures (more than 50%) - Substantial increase in bulk and height in relation to immediately adjacent buildings (more than 50%) <p>Category D: High intensity development</p> <ul style="list-style-type: none"> - Rezoning of a site in excess of 10 000m2 - Linear development in excess of 300m. - Any development changing the character of a site exceeding 5000m2 or involving the subdivision of a site into three or more erven. - Substantial increase in bulk and height in relation to immediately adjacent buildings (more than 100%)
--	--

12.4 Management and Mitigation Actions

The following table provides a guideline of relevant heritage resources management actions is vital to the conservation of heritage resources.

<p>No further action / Monitoring</p> <p>Where no heritage resources have been documented, heritage resources occur well outside the impact zone of any development or the primary context of the surroundings at a development footprint has been largely destroyed or altered, no further immediate action is required. Site monitoring during development, by an ECO or the heritage specialist are often added to this recommendation in order to ensure that no undetected heritage\ remains are destroyed.</p> <p>Avoidance</p> <p>This is appropriate where any type of development occurs within a formally protected or significant or sensitive heritage context and is likely to have a high negative impact. Mitigation is not acceptable or not possible. This measure often includes the change / alteration of development planning and therefore impact zones in order not to impact on resources.</p> <p>Mitigation</p> <p>This is appropriate where development occurs in a context of heritage significance and where the impact is such that it can be mitigated to a degree of medium to low significance, e.g. the high to medium impact of a development on an archaeological site could be mitigated through sampling/excavation of the remains. Not all negative impacts can be mitigated.</p> <p>Compensation</p> <p>Compensation is generally not an appropriate heritage management action. The main function of management actions should be to conserve the resource for the benefit of future generations. Once lost it cannot be renewed. The circumstances around the potential public or heritage benefits would need to be exceptional to warrant this type of action, especially in the case of where the impact was high.</p> <p>Rehabilitation</p> <p>Rehabilitation is considered in heritage management terms as a intervention typically involving the adding of a new heritage layer to enable a new sustainable use. It is not appropriate when the process necessitates the removal of previous historical layers, i.e. restoration of a building or place to the previous state/period. It is an appropriate heritage management action in the following cases:</p> <ul style="list-style-type: none"> - The heritage resource is degraded or in the process of degradation and would benefit from rehabilitation. - Where rehabilitation implies appropriate conservation interventions, i.e. adaptive reuse, repair and maintenance, consolidation and minimal loss of historical fabric. - Where the rehabilitation process will not result in a negative impact on the intrinsic value of the resource. <p>Enhancement</p> <p>Enhancement is appropriate where the overall heritage significance and its public appreciation value are improved. It does not imply creation of a condition that might never have occurred during the evolution of a place, e.g. the tendency to sanitize the past. This management action might result from the removal of previous layers where these layers are culturally of low significance and detract from the significance of the resource. It would be appropriate in a range of heritage contexts and applicable to a range of resources. In the case of formally protected or significant resources, appropriate enhancement action should be encouraged. Care should, however, be taken to ensure that the process does not have a negative impact on the character and context of the resource. It would thus have to be carefully monitored</p>
