

**b: Position of Belmont oak tree c,d: Remains of veranda and cellars 20 March 2012.  
(oral history by Mr T Butterworth)**

Mrs Wendy Butterworth (nèe Clark) of Goodhope Cycles, Grahamstown, the daughter of Mrs Enid Clark, grew up on Belmont. The three sons, Gerald, Stanley and Keith Clark each inherited a third of the farm. Fairyvale went to Vivienne McLean (nee Clark) – the only female to inherit a farm. Stanley’s portion went to his daughter, Sheila and James Coetzer; Gerald’s portion was sold to Colin de Jong. Keith Reginald Clark was the only one who stayed on his portion until his death in 1982. His wife, Mrs Enid Clark, then took over Belmont. (interview and notes from Wendy Butterworth)

Mrs Butterworth further stated that her mother, Mrs Enid Clark, stayed on the farm until she was attacked in around 1986. She could not remember the exact date of this but stated that the farmhouse had been vandalized after that and then bought by Jimmy Duncan and part by Graham Vroom. She remembered that the curved room was at the back of the house which was on the Belmont Valley road after the railway crossing. Articles appeared in *EP Herald* dated 23 December 1976 (written by Ben MacLennan) and “an architecture book” (W Butterworth) which is probably Lewcock’s book, quoted above. The original house was probably Devonshire cobb, stone and thatch as were most of the first Settler houses.

Gill Wylie remembers the farmhouse was there in the 1970s but the Duncans knocked the house down when they bought the farm from Mrs Clark. The late Mrs Eileen Wylie of Upper Gletwyn was a Clark grandchild, the daughter of Vivienne Clark and Daniel Thoms McLean. Peter Wylie grew up on Fairyvale, the home of Daniel and Vivienne McLean who lived there for 11 years. Daniel McLean also farmed Willow Glen along with his Eileen’s brother, Graham McLean.  
(see Gill Wylie’s email reply, Feb 2012).

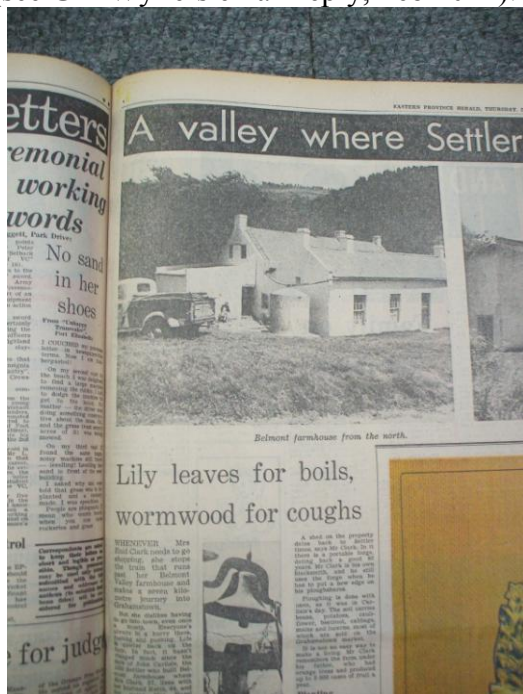

**service for judge**

He was born at Mansfield in the Bedfordshire district in 1881 and attended the Bedford grammar school in the town. He then went to the University of Manchester where he obtained his BA in 1904 and his LLB in 1907. He served in the Indian Army and was awarded the DSO in 1915. He was later appointed a judge in the High Court of Justice in 1925. He died in 1976 at the age of 95.

**Fertile**

The fertile Belmont Valley farmhouses and make a seven kilometre journey into Grahamstown.

But she declines having any more children. A son, in a hurry three, and a daughter, in a hurry three, are the only children she has. In fact, it hasn't occurred since the late 19th century when the settler who built Belmont farmhouses, where Mrs Clark, 87, lives with her husband, 84, and her sister Mrs Hazel Adams.

Mr Clark's family has lived in Belmont Valley for three generations. His grandfather took it over from John Carlisle, who was the first settler in the area. The farm was built in 1834 and was one of the first of the many built in the area. It was built by a settler who had a rough idea of what he wanted. He built the house for himself as a stock farmer and established himself in the area. The house has since been passed on to his descendants.

**Planting**

"You'd plant the trees, turn the ground where you'd been working, and water it and within no time the trees were white with blossoms."

But the war came and the trees grew old and died. The memories remain though.

The Clarks look back days in their own words, tracing down to the start for a month at a time. In a tiny schoolhouse still standing above the farm Mr Clark was taught by a succession of seven schoolmistresses, two of whom married his elder brothers.

**Marriage**

Mr Clark married Edith here in 1911. They still use traditional recipes handed down by Mr Clark's grandmother — fromilly leaves to draw boria, wattlewood for conchy and omelette and an onion-like plant to bind omelette and more.

In the evening Mrs Clark rings the old farm bell outside the kitchen to signal the end of the day, as has been done for almost a century.

The spirit of the Settler is still strong in Belmont Valley.

—By—  
**Ben MacLennan**

The farm bell.

In BELMONT'S sitting room (left to right) Mrs Clark and Mr and Mrs Clark, with Patsy, the spaniel.

**Figure 14: Article by B MacLennan: “A Valley where Settler Traditions Survive” (EP Herald 23 December 1976) showing Belmont farmhouse from the road with the one newer extension and the front (south view) with the bow window and veranda. (note oak trees)**

**Other structures on Belmont (see appendix 5 – Mrs Butterworth’s diagram and readings)**

**Workshop where family lived when house was “full” - brick and stone under zinc roof.**

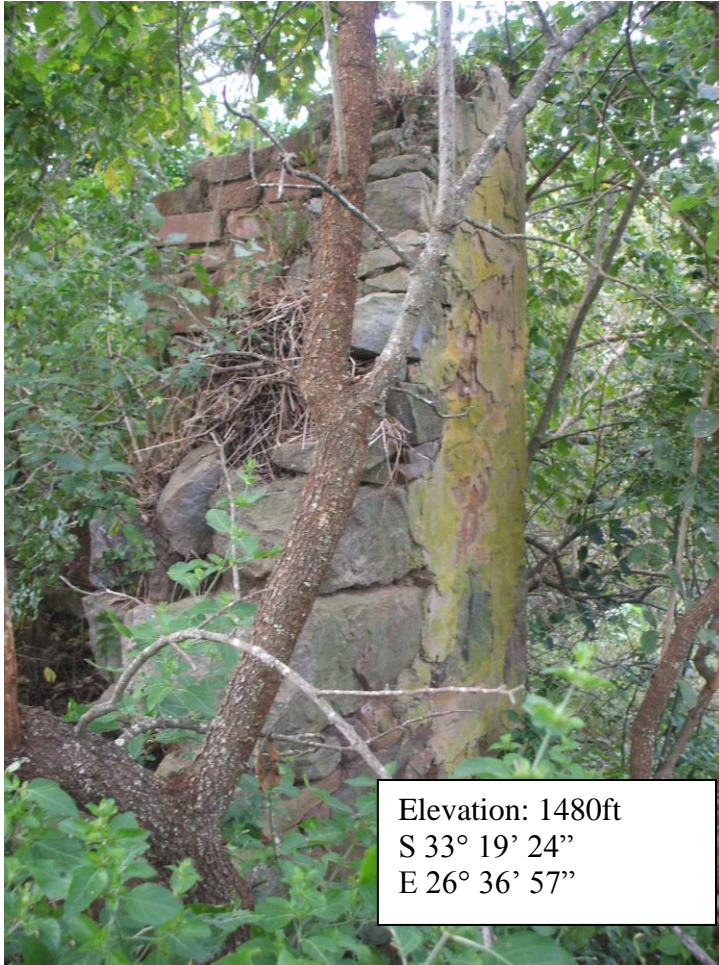

**Figure 15: the corner of the workshop**

**The Oak Valley Railway siding and track (part of the Kowie line)  
The use of this railway line ended in 1986 with the last train trip from  
Grahamstown to Port Alfred. Mrs Wendy Butterworth (nee Clark) grew up at  
Belmont and caught the Kowie train to school on Monday morning and returned to  
Belmont on Friday afternoon. The train also carried citrus and vegetables for the  
Grahamstown Market which was on the Market Square. The structure was one  
room with a cement platform against the line for loading (this section of line is  
missing). An access road from the Valley road went to the siding and then rejoined  
the road further south (not visible today)**

***Recommendations: The siding falls outside the area designated for the Belmont  
Development and Golf Course.***

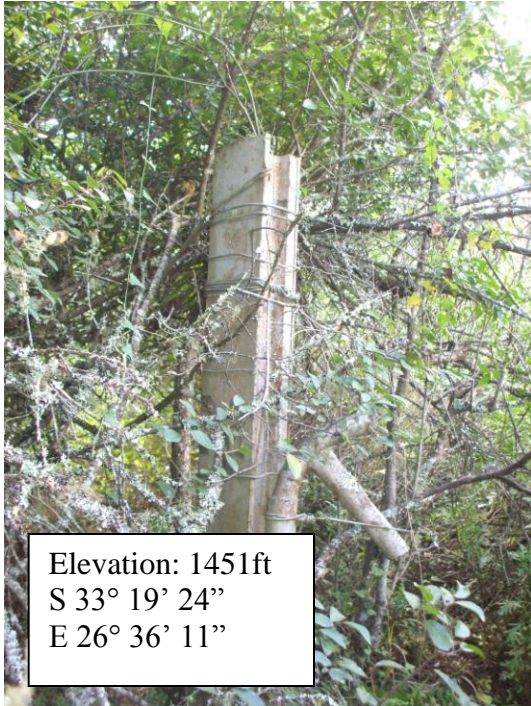

Elevation: 1451ft  
 S 33° 19' 24"  
 E 26° 36' 11"

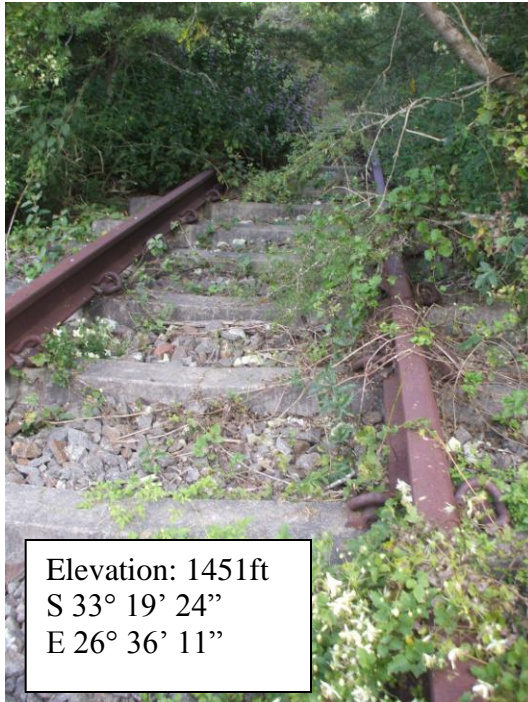

Elevation: 1451ft  
 S 33° 19' 24"  
 E 26° 36' 11"



Elevation: 1460ft  
 S 33° 19' 24"  
 E 26° 36' 10"

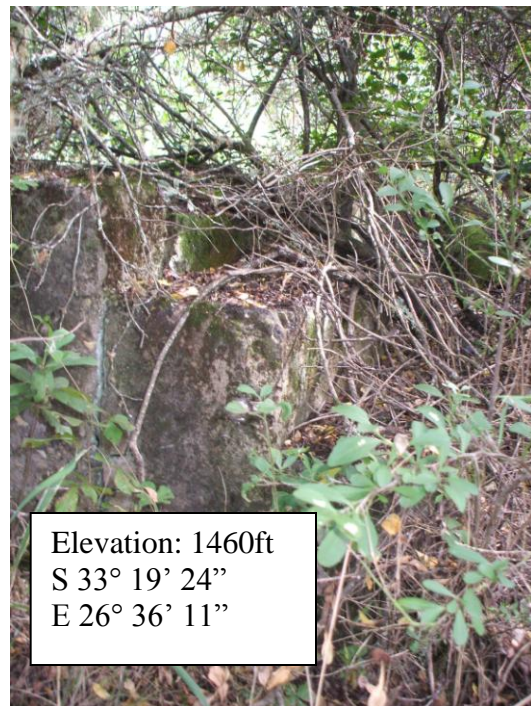

Elevation: 1460ft  
 S 33° 19' 24"  
 E 26° 36' 11"

**Figure 16:** Clockwise: a Gate post entrance to **Oak Valley/Belmont railway siding**, b.section of railway track, c. one side wall and d. steps to other side of the Oak Valley Railway Siding building.  
Grahamstown - Port Alfred Railway line: opened on 21 October 1881 and first train ran at the beginning of October 1884. First the Port Alfred Railway company ran the railway then the Kowie Railway Co Lt. The famous Blaauwkrantz Train Disaster happened on 22 April 1911.

The railway track runs through Belmont will have to be preserved. It is the property of Transnet.

**Recommendation: The railway track needs to be preserved.**

<i>Railway track</i>	<i>Local</i>	<i>Regional</i>	<i>National</i>	<i>International</i>
<i>Architectural</i>	<i>low</i>	<i>low</i>	<i>low</i>	<i>low</i>
<i>Historical</i>	<i>High</i>	<i>medium</i>	<i>low</i>	<i>low</i>
<i>Technical</i>	<i>medium</i>	<i>medium</i>	<i>low</i>	<i>low</i>
<i>Social</i>	<i>low</i>	<i>low</i>	<i>low</i>	<i>low</i>
<i>Scientific</i>	<i>low</i>	<i>low</i>	<i>low</i>	<i>low</i>

### Farm graves

“Belmont had a graveyard for farm workers situated between the railway siding and the road.” (Wendy Butterworth) These graves need to be located and protected by a fence. (Heritage Resources Act 1999) No graves were located on 20 March 2012 or two subsequent visits. However there were stones piled up between the siding and the road.



Elevation: 1451ft  
S 33° 19' 24"  
E 26° 36' 11"

**Figure 17: Stones along road.**

**Recommendations: The pile of stones may or may not be the graves mentioned; this however, falls on the boundary of the area designated for the Belmont Development and Golf Course. Any further development has to take into account the possibility of a farm or church cemetery. All graves are protected under the Heritage Act Section 36.**

### Belmont school building

Mrs Wendy Butterworth attended school in this building; later her mother, Mrs Enid Clark, ran a shop here and then the building was used as an African church.

The foundations remain and piles of stones and brick. There is no information as to how many rooms there were and when the building was demolished.

**Recommendations:** *The school ruin falls outside the area designated for the Belmont Development and Golf Course.*



**Figure 18a: Remains of school building alongside road;** only foundations visible and some bricks and stones  
Elevation: 1513ft  
S 33° 19' 21"  
E 26° 36' 11"



**Figure 18b: Church building alongside road;** near Varnam  
Elevation: 1421 ft  
S 33° 19' 33.8"  
E 26° 38' 17.4"

**Figure 18 a** ruins of School/Church; **b.** Very early stone church (or Settler dwelling) with zinc roof near Varnam. This church may be one of the original Howard's Party homes (part of the village allotment) as Mrs Rilda Duncan quoting from Pamela Barnes' book *Through the Checkered Path* said "Howard's Party was not very religious"

**Recommendations:** *The house, school and siding fall outside the area designated for the Belmont Development and Golf Course. The research takes account the original farm called "Belmont" Only portions 6 is part of this HIA and the rest of Belmont adjoins the property to be developed. The church near Varnam (Figure 17b is shown to complement the ruin that was the school/church structure on Belmont. The Heritage Act protects all buildings or structures older than 60 years. (Section 34(1))*

**B.2 Willow Glen and Willow Glen Annexe (Morgan's Party)**

Dr Nathaniel Morgan, leader of his London party farmed here – see Deed QRR4/69 indicating 538 hectares of land. Morgan and William Howard travelled together on the ship *Ocean*. William Howard's grant adjoined Willow Glen, Morgan's allotment and today is part of David Duncan's property. Thomas Stubbs (1832) recalls working at Willow Glen, "I was 24 years old and took a farm in Morgan's Party in partnership with John Kestell." This did not last long.

Dr CJ Skead in the notes on Morgan's Party describes it as "a large allocation in two parts running across the bed of the Blaauwkrantz River over the southern escarpment and down to the southern boundary on the Kowie River. It consisted of 19 allotments and has a small group of villa allotments on the south bank of the Blaauwkrantz River". The title deed in the Cape Town Deeds Office reads "Mr Nathaniel Morgan and his party of Settlers 23 January 1824. S to the Grahamstown Mountains W to Mr Carlisle's Location N towards Grobbelaarskloof E to Mr Howard's Location.

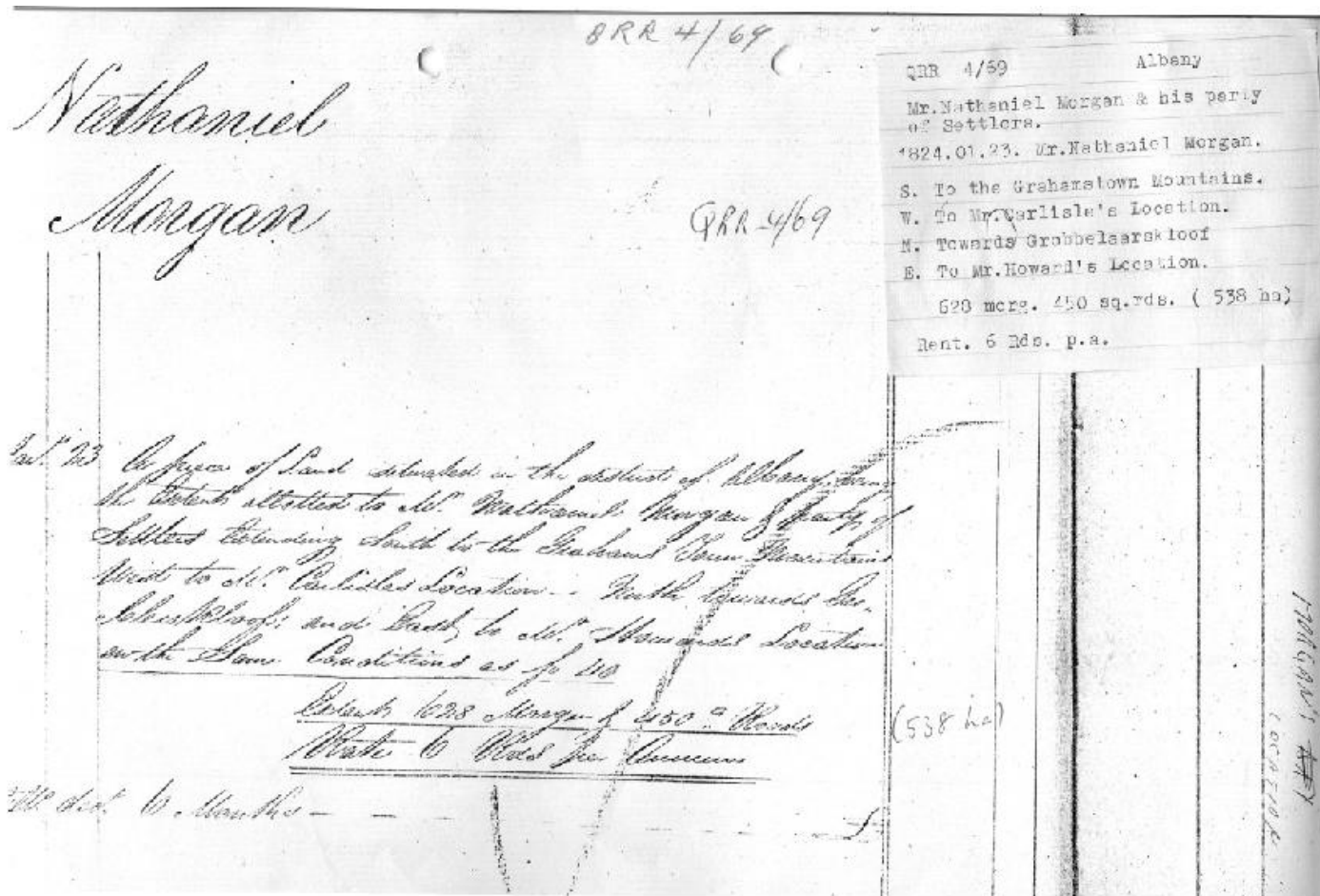

**Figure 19: Morgan's Deed of Transfer**

**DISTRICT OF ALBANY—FARMERS.****DISTRICT ALBANY—GRAHAMSTOWN.**

Armstrong, J, Brent's hoek	Mashmubi, K, Featherstone's kloof
Bokolo, N, Klip drift	Marei, P, Gletwyn
Brittain, J A, Burnt kraal	McGuire, R, Brookhuizen's poort
Cckiso, M, Paarde kraal	Michael, K, Sunnyside
Clarke, C, Belmont	Mountford, H W, Manley's flats
Clarke, E W, Belmont	Mountford, H, Manley's flats
Coets, T, Lavinder valley	Mountford, H W A, Nurney
Deld, J, Botha's hill	Mountford, R, Nurney
Douglas, N, Paarde kraal	Munro, A W, Slaai kraal
Drake, J, Woest hill	Niemand, P, Burnt kraal
Drake, B, Woest hill	Nobepi, P, Banana grove
Dredge, T, Coomsfontein	Page, A C, Botha's hill
Dredge, J, Coomsfontein	Palmer, G, Cypherfontein
Driver, E, Stoney valley	Palmer, C G, Cypherfontein
Ferd, J, Manley's flats	Palmer, F C G, Cypherfontein
Ford, S, Manley's flats	Palmer, T, Bruit hoek
Ford, F, Paarde kraal	Pannell, J R, Botha's hill
Frost, C, Coomb's valley	Pannell, R, Botha's hill
Futter, J H, Willow glen	Potgieter, F, Burnt kraal
Futter, T J, Willow glen	Preddy, A, Sunnyside
Glass, J, Coldstream	Preddy, W S, Sunnyside
Gonduka, C, Featherstone's kloof	Purvis, T, Eland's kloof
Goula, O, Paarde kraal	Reid, H, Rosedale
Harper, C G, Paarde kraal	Riley, J, Willow glen
Harper, G, Trutham park	Searle, W, Brookhuizen's poort
Harper, J, Banana grove	Sellers, J, Howard's party
Harper, W J, Howard's party	Umkosi, S, Manley's flats
Heatley, J, Liversage's party	Vroom, E A, Thorn farm
Hill, O, Botha's hill	Vroom, W, Thorn farm
Horne, J, Morgan's party	Wallace, H, Collingham
Horne, R, Melrose	Wallace, R, Beggars bush
Horne, J, New Essex	Watbridge, W J, Willow park
Horne, S, New Essex	Webb, C H, Burnt kraal
Hoole, R G, Collingham	Webb, T, Burnt kraal
Inkolo, B, Klip drift	Webb, W G, Burnt kraal
Lamont, L, Howard's party	Webb, J O, Burnt kraal
Lloyd, A E, Glenstone	Wicks, W, Pigot park
Manan, R, Burnt kraal	

**Figure 19a: Border Entries 1901 page 3a (Cory Library); Clark (e) Clement and Eric W at Belmont and Futter, JH and TJ at Willow Glen and Riley, J at Willow Glen Annexe. Thomas John Futter (1835 – 1906) and his son, John Henry (1856 – 1922) farmed Willow Glen. John Henry and his wife Sarah Sophia McLean farmed there until 1922 after which Daniel Thomas McLean took over.**



**FIELD CORNETCY OF GRAHAMSTOWN. WARD ONE** (Continued).

No.	Name.	Place.	Property.	Qualification
1	Bosanquet, Edward B. C.,	Governor's Kop	Farm	Owner
2	Bosch, Johannes, H.,	Stoneyvale	Farm	Owner
3	Clark, Clem F.,	Belmont	Farm	Owner
4	Clark, E. Will T.,	Fairy Vale	Farm	Owner
5	Clark, Edward F. G.,	Morgan's Party	Farm	Tenant
6	Chapman, James G. I.,	Varnham	Farm	Owner
7	Currie, W. L.,	Geelhoutboom	Farm	Tenant
8	Delpert, Joh. Hendrick,	Frasers Camp	Farm	Owner
9	Dredge, John H.,	Coombesfontein	Farm	Owner
10	Dredge, Henry,	Coombesfontein	Farm	Tenant
11	Dredge, Herbert J.,	Gilead	Farm	Tenant
12	Dold, Walter J.,	Tempe	Farm	Owner
13	Douglass, Charles H.,	Governor's Kop	Farm	Tenant
14	Elliott, H.,	Mount View	Shop	Tenant
15	Farndell, Arthur J.,	Governor's Kop	Farm	Owner
16	Ford, Beecher,	Radway Green	Farm	Owner
17	Ford, Stephen,	Radway Green	Farm	Owner
18	Ford, William J.,	Radway Green	Farm	Tenant
19	Frost, Charles,	Coombesvale	Farm	Tenant
20	Futter, Arthur J.,	Belmont	Farm	Tenant
21	Futter, Clifford G.,	Belmont	Farm	Tenant
22	Futter, J. H.,	Belmont	Farm	Tenant
23	Gilbert, H. C.,	Melrose	Farm	Tenant
24	Glanville, Vivian P.,	Elands Kloof	Farm	Tenant
25	Gradwell, Levi D.,	Wai Nek	Farm	Tenant
26	Glass, James,	Coldspring	Farm	Owner
27	Greener, Alfred,	Green Hills	Farm	Tenant
28	Goddard, J.,	Willow Park	Farm	Tenant
29	Hards, Harry H.,	Sunnyside	Farm	Owner
30	Harper, R. Gilbert,	Howards Party	Farm	Owner
31	Harper, Walter O.,	Howards Party	Farm	Owner
32	Heatley, John F.,	Manley Flats	Farm	Owner
33	Hoole, Robert G.,	Collingham	Farm	Owner
34	Horne, John,	New Essex	Farm	Owner
35	Horne, Alfred S.,	New Essex	Farm	Tenant
36	Horne, Joseph,	Pigott Park	Farm	Tenant
37	Horne, William J. B.,	Trentham Park	Farm	Tenant
38	Horne, Edward D.,	Pigott Park	Farm	Tenant
39	Jolly, John,	Gletwyn	Farm	Owner
40	Keeton, Fred J.,	Rosedale	Farm	Tenant
41	Kidson, J. C.,	Geelhoutboom	Farm	Tenant

**Figure 19b: Farm entries for Ward One (1916 Voter's Roll; Albany Museum Library) shows Clement Frederick Clark (born 3/11/1895 died Grahamstown 13/7/1962) as the owner of Belmont farm and Eric William Thomas Clark (born**

1926 – died 23/11/1965 Springs) as the owner of Fairy Vale. John Henry Futter, his sons, Arthur James and Clifford George, were tenants on Belmont. Edward FG Clark was a tenant farmer on Morgan's Party.

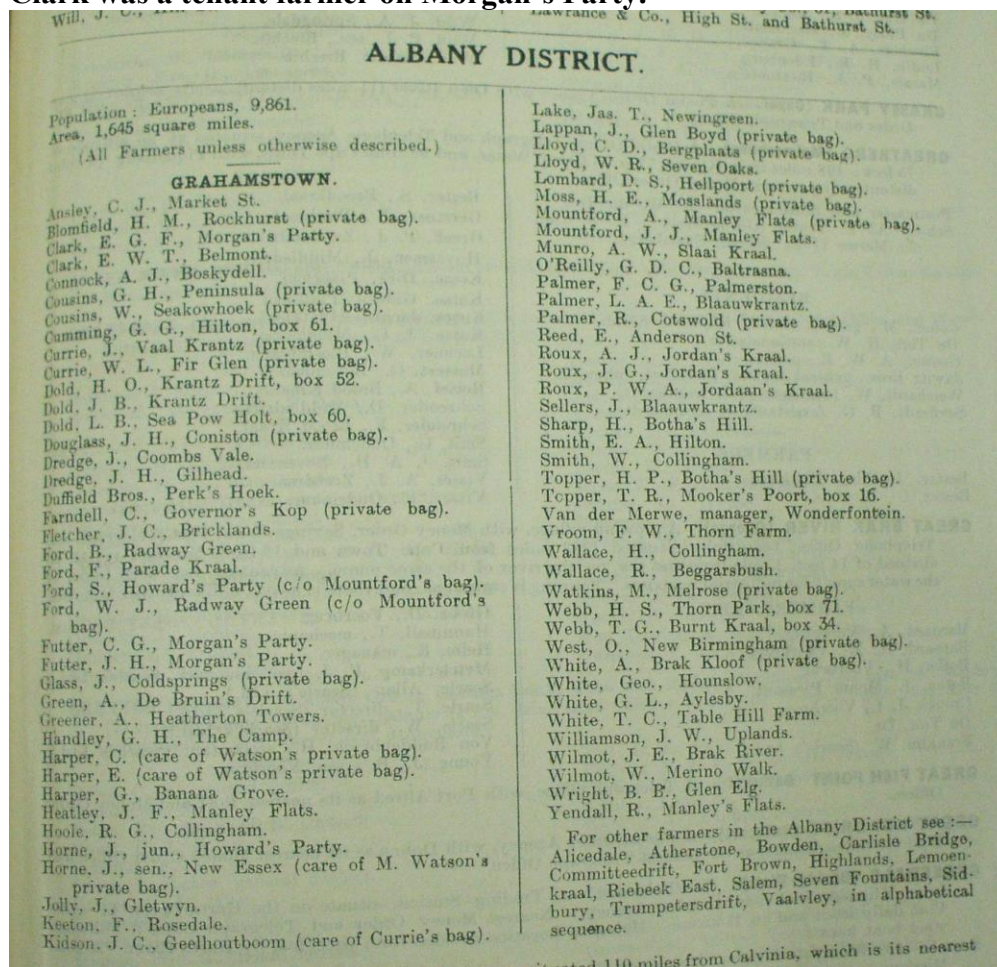

The name of Willow Glen is not used.

**Figure 19c: In the East London and Frontier Directory of 1924, Futtters, Clarks and Hornes mentioned. Eric William Thomas Clark was the owner of Belmont and EGF (Edward FG in previous document) Clark (Willow Glen Annexe), CG and JH Futter (father and son at Willow Glen) at Morgan's Party.**

The McLeans arrived later at Willow Glen. In Skead's farm survey of 1971, Daniel Thomas ("Dan") McLean and Vivienne Clark owned 358,4 ha of Willow Glen and Tony Lombard 150,5 ha of Willow Glen Annexe (as Mrs Rilda Duncan calls this section) Daniel Thomas McLean died on 16 February 1974; his son Graham died in the 1980s. Gill Wylie stated the Duncans bought Willow Glen Annexe from Neville Myer and a farm further down the river (records indicate the Duncans owned Varnam from Howard's Grant). Clement Clark junior, nicknamed "Sonny" farmed the portion of Willow Glen that Lombard bought. In an auction of 1982 the owner of Willow Glen is indicated as CJ Meyers (same as N Myer?) (*Grocott's Mail* 23 November 1982). The location of the area of Willow Glen is shown on this photograph:



Willow Glen Annexe: arrow indicates ruins of farmhouse of Clement Clark junior “Sonny” Clark’s from the road; the gate and road to the house (photographs by F Way-Jones)

**This farmhouse has the following coordinates (from EIA report):**  
 S 33°19'30.0"  
 E 26°36'37.7"

**Gate entrance:**  
 Elevation: 1476ft  
 S 33° 19' 16"  
 E 26° 36' 45"

**Figure 20: photograph of Sonny Clark’s farm on hillside south east of Diepdraai valley:**

**This farmhouse is where Mr Davies plans to build the Clubhouse for the Belmont Golf Course. It is therefore important to record the structure. Mr Graham Vroom said that he visited the house as a teenager in 1968 and that there was a wooden veranda. He could not recall any other details about the house. However, the house burnt down when Bosman owned it. Mrs Rilda Duncan stated that she had never visited this house. Mr Peter Wylie said that the house had bay windows but could not remember anything else as the McLean and the Clarks did not “see eye to eye”. He recalled that the house and farm belonged to “Sonny” Clark and later the late Mr Tony Lombard of the Citrus Board.**

*Recommendations: Further historical research when the ground around the farmhouse ruin is cleared. The writer has been unable to contact descendants of Sonny Clark or the Lombards in order to date the house on the hill.*

<i>Willow Glen farmhouse</i>	<i>Local</i>	<i>Regional</i>	<i>National</i>	<i>International</i>
<i>Architectural</i>	<i>low</i>	<i>low</i>	<i>low</i>	<i>low</i>
<i>Historical</i>	<i>Medium*</i>	<i>low</i>	<i>low</i>	<i>low</i>
<i>Technical</i>	<i>low</i>	<i>low</i>	<i>low</i>	<i>low</i>

<i>Social</i>	<i>low</i>	<i>low</i>	<i>low</i>	<i>low</i>
<i>Scientific</i>	<i>low</i>	<i>low</i>	<i>low</i>	<i>low</i>

- According to available information from Mr G Vroom. Mrs Rilda Duncan stated that Mr Tony Lombard had died; Mr Bosman was not available for comment.



Arrow indicates railway bridge from road.

Figure 21a: Railway Bridge over Kowie River. (photograph by F Way-Jones 30 March 2012); below: Figure 21b railway track and Figure 21c “45” mile sign.

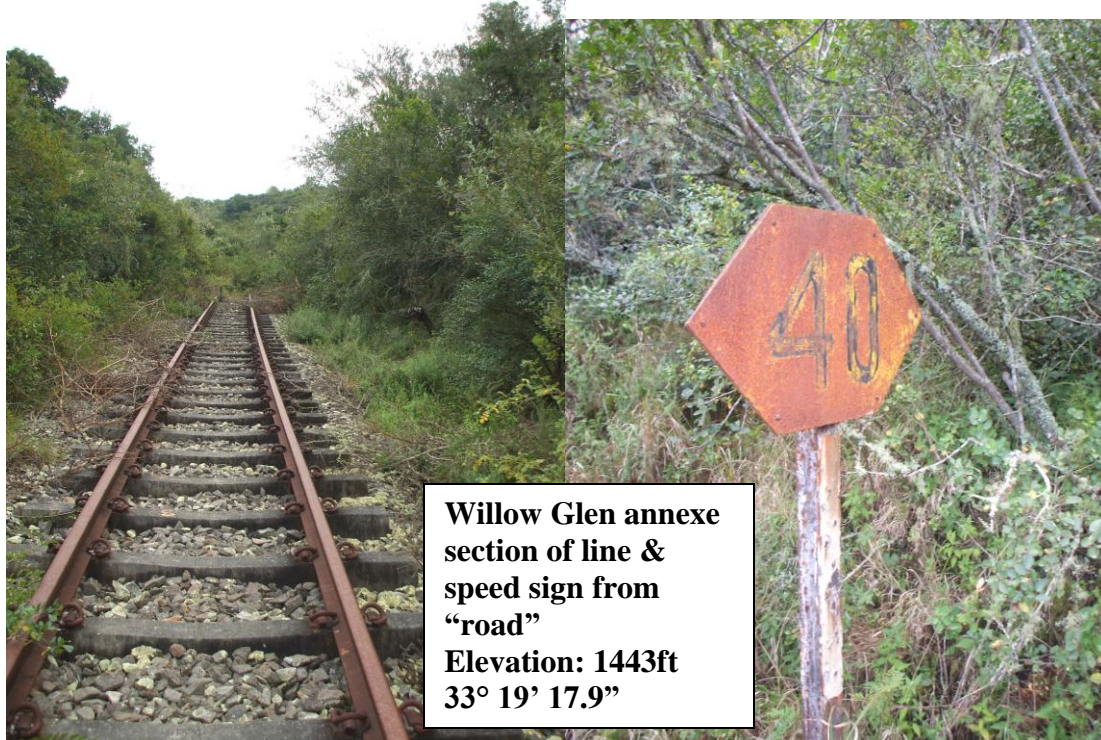

Willow Glen annexe section of line & speed sign from “road”  
Elevation: 1443ft  
33° 19’ 17.9”

The railway track running through Willow Glen will have to be preserved. Mrs Duncan remembered the train bringing the mail and goods; it ran twice a day. The area of the railway track, the siding, signage are the property of Transnet. There were two railway sidings in the valley: Oak Valley (a ruin on Belmont) and Harper’s Halt on Lower Melrose (the property of Jannie Zakarillis who has left the country)

**Recommendation: The railway track, signs and bridges need to be preserved.**

<i>Railway track sign &amp; bridge</i>	<i>Local</i>	<i>Regional</i>	<i>National</i>	<i>International</i>
<i>Architectural</i>	<i>low</i>	<i>low</i>	<i>low</i>	<i>low</i>
<i>Historical</i>	<i>High</i>	<i>medium</i>	<i>medium</i>	<i>low</i>
<i>Technical</i>	<i>medium</i>	<i>medium</i>	<i>medium</i>	<i>low</i>
<i>Social</i>	<i>low</i>	<i>low</i>	<i>low</i>	<i>low</i>
<i>Scientific</i>	<i>low</i>	<i>low</i>	<i>low</i>	<i>low</i>



**Willow Glen annexe cement slipway on “road”**  
**Elevation: 1443ft**  
**33° 19’ 17.9”**  
**26° 36’ 46.1”**

**Figure 22a: Cement slipway?**

<i>Cement Slipway</i>	<i>Local</i>	<i>Regional</i>	<i>National</i>	<i>International</i>
<i>Architectural</i>	<i>low</i>	<i>low</i>	<i>low</i>	<i>low</i>
<i>Historical</i>	<i>unknown</i>	<i>unknown</i>	<i>Low</i>	<i>low</i>
<i>Technical</i>	<i>medium</i>	<i>medium</i>	<i>low</i>	<i>low</i>
<i>Social</i>	<i>low</i>	<i>low</i>	<i>low</i>	<i>low</i>
<i>Scientific</i>	<i>low</i>	<i>low</i>	<i>low</i>	<i>low</i>



**Willow Glen annexe  
weir on Kowie  
River:  
Elevation: 1406ft  
33° 19' 20.9"  
26° 36' 48.9"**

**Figure 22b: broken weir on Willow Glen Annexe**

<i>Weir over Kowie River</i>	<i>Local</i>	<i>Regional</i>	<i>National</i>	<i>International</i>
<i>Architectural</i>	<i>low</i>	<i>low</i>	<i>low</i>	<i>low</i>
<i>Historical</i>	<i>medium</i>	<i>medium</i>	<i>Low</i>	<i>low</i>
<i>Technical</i>	<i>medium</i>	<i>medium</i>	<i>low</i>	<i>low</i>
<i>Social</i>	<i>low</i>	<i>low</i>	<i>low</i>	<i>low</i>
<i>Scientific</i>	<i>low</i>	<i>low</i>	<i>low</i>	<i>low</i>

***Recommendations:***

*According to the Heritage Act, all structures older than 60 years may not be demolished without a permit (Section 34(1)). The cement slipway and broken weir are already in an unsound condition. The weir serves no purpose as it stands; it restricts the water flow and the two round culverts are on the bank of the Kowie river. The cement slipway may have connections with the loading on the railway of the citrus s it is just below the railway line and above the river but the road to and from Willow Glen Annexe ends at this point. There is no oral evidence or proof of the use of cement slipway.*

### **The McLean section of Willow Glen**

**(Notes from Russell McLean (born 1960), grandson of Daniel Thomas McLean and Vivienne Clark.)**

The farm was bought from the Fitters (probably after 1922 when John Henry Fitter died). Russell thought the farm belonged to the McLeans from 1959. The farm was from a dam to the tall trees on the north side of the road. It bordered Lombard's property. There was another farm called Sheepdam (where I Reed farms today). From the road the farm road to Willow Glen goes along the dead trees and then does a 90° turn and the farmhouse is 60 metres further. Russell remembered the house as having a "C" shape with interleading rooms (with steps down to each room): two bedrooms, a kitchen, lounge, another lounge and two more bedrooms, one over a cellar. There was a veranda with a sunroom – west facing to catch the winter sun. Russell Mclean left the Grahamstown area between 1976 and 1979. David Duncan bought the farm from the McLeans and farms pepperdews on the farm north of the farmhouse. Mrs Rilda Duncan stated that the farmhouse was radically altered: pitch roof replaced with "shed roof" and stoep "cemented in".

The shop and additional room on Willow Glen today:



**Figure 23: Readings  
for cash store: 1479 ft  
33° 19' 16.6"  
26° 37' 25.6"**

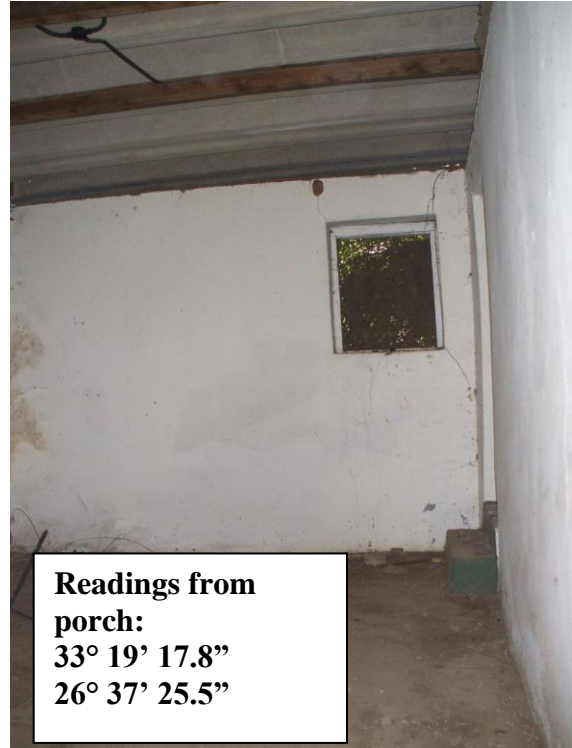

**Readings from  
porch:  
33° 19' 17.8"  
26° 37' 25.5"**

**Figure 23 a Cash Store and Figure 23 b Willow Glen the farmhouse with a flat roof (pitched roof removed):**

**Front of house and one of the bedrooms (interleading) with a wooden ceiling and window frame and characteristics steps to each room. (see plan of house in Appendix 5)**

*Recommendations: The house falls outside the area designated for the Grahamstown Golf Course but the area where the sheds were lies on the south west boundary, south of the road. The research takes account the original farm called "Willow Glen" Only Willow Glen portions 1 and 2 (includes Willow Glen Annexe) are part of this HIA.*