

PHASE 1 ARCHAEOLOGICAL IMPACT ASSESSMENT
PROPOSED DEVELOPMENT
ERF 23347
PAARL

Prepared for

DAVID HELBIG AND ABRAHAMSE LAND SURVEYORS

On behalf of

Messrs Enslin & Van Zyl Boutrust

By

Jonathan Kaplan
Agency for Cultural Resource Management

PO Box 159

Riebeeck West

7306

Ph/Fax: 022 461 2755

Mobile: 082 321 0172

Email: acrm@wcaccess.co.za

APRIL
2003

1. INTRODUCTION

1.1 Background and brief

David Hellig and Abrahamse Land Surveyors requested, on behalf of Messrs Enslin & Van Zyl Boutrust that the Agency for Cultural Resource Management, undertake a Phase 1 Archaeological Impact Assessment (AIA) of Erf 23347 Paarl.

The proposed development of Erf 23347 envisages 13 group-housing units.

The aim of the AIA is to locate, identify and map archaeological remains that may be negatively impacted by the proposed project, and to propose measures to mitigate against the impact.

2. TERMS OF REFERENCE

The terms of reference for the study were:

1. to determine whether there are likely to be any archaeological sites of significance within the proposed site;
2. to identify and map any sites of archaeological significance within the proposed site;
3. to indicate the sensitivity and conservation significance of archaeological sites potentially affected by the proposed development;
4. to assess the status and significance of any impacts resulting from the proposed development;
5. to identify mitigatory measures to protect and maintain any valuable archaeological sites that may exist within the site, and

3. APPROACH TO THE STUDY

3.1 Method of survey

The approach followed in the AIA entailed a detailed foot survey of Erf 23347.

Cultural historian, Ms Margaret Neethling has undertaken a heritage review of the property.

4. THE STUDY AREA

A plan of the proposed development is illustrated in Figure 1.

The site is located alongside Erf 23346, in School Street, Paarl.

The site is in a fairly degraded state. The entire site is covered with exotic Kikuyu grass. Dune mole rat activity also occurs. Piles of old building rubble and debris, and river cobbles, and other dumped building and domestic material cover a substantial portion of the property. A ± 5-m long trench has been excavated in the southern portion of the site.

Some of the building rubble on the site probably relates to the remains of the St. Stephen Anglican Church rectory, school and caretakers cottages, which were previously sited on the adjoining property (Erf 23346) (Reverend R.D. Cox pers. comm.). The ruins are testament to a Group Areas Act removal in the 1970s.

The effected property (Erf 23347) formed part of the St. Stephen's Church cemetery (Reverend R.D. Cox, pers. comm.). According to the developer, Mr J. Enslin (pers. comm.), all the graves were removed from the site, when the Church property was demolished in the 1970's. However, according to Reverend Cox (pers. comm.), only the headstones and grave-related items and partial exhumation of some burials took place. The majority of graves/burials are still on the site.

It is important to note that about 54 graves and the partial remains of 16 humans were excavated and removed from Erf 23346 by archaeologists from the Archaeology Contracts Office (ACO) at the University of Cape Town (Dave Halkett pers. comm.).

According to Mr Halkett (pers. comm.), a study of a 1940's orthophoto of the site indicates that up to 1000 burials may be located on the site, although some may have been removed during exhumation in the 1970's.

The probability of human remains being uncovered or exposed during earthworks on Erf 23347, is therefore likely to be very high. Most of the burials are also likely to be older than 60 years of age, thus falling under the protection of the National Heritage Resources Act (No. 25 of 1999). The portion of the cemetery that the ACO worked in, is dated to the late 19th/ early 20th century (Halkett pers. comm.).

5. LEGISLATIVE REQUIREMENTS

5.1 The National Heritage Resources Act (Act No. 25 of 1999)

5.1.1 Burial grounds and graves (Section 36 (3))

No person may, without a permit issued by the South African Heritage Resources Agency (SAHRA), destroy, damage, alter, exhume or remove from its original position or otherwise disturb any grave or burial ground older than 60 years, which is situated outside a formal cemetery administered by a local authority.

5.2 Application requirements and procedure

Permit applications must be made on the official form:

- *Application for permit: Burial Grounds and Graves.*

Permit application forms are available from SAHRA.

6. IDENTIFICATION OF POTENTIAL RISKS

The following project actions may impact negatively on archaeological sites.

The actions are likely to occur during the construction phase of the proposed project.

- Bulk earthworks and excavations for services may very likely expose or uncover graves, human burials, or burial remains.

7. IMPACT ASSESSMENT AND DESCRIPTION

One incomplete Early Stone Age¹ (ESA) handaxe was located next to a pile of building rubble and river cobbles in the north-eastern portion of the site. One chunk and one small flaked cobble were also found among a pile of rubble and river cobbles on the site.

These tools are not considered to be important finds.

Two unmarked granite headstones, one plain, the other scrolled, were found lying alongside the 5-m long trench in the northern portion of the site. Halkett (pers. comm.) believes that many of headstones and grave-related items may have been buried on the site when the cemetery was demolished in the 1970's.

The trench cutting and associated spoil material was searched for human bone, but none was found. However, the trench is only about 2-3 feet deep and not deep enough to reveal the presence of human graves or human remains.

The dune mole rat spoils were also sieved for any skeletal material but none was found.

8. IMPACT STATEMENT

The impact of the proposed project on archaeological remains may be potentially high.

Human burials or burial remains, graves and grave-related items may very likely be uncovered or exposed during bulk earthworks and excavation for services.

¹ A term referring to a period between 2 million and 200 000 years ago.

9. RECOMMENDATIONS

With regard to the proposed development and subdivision of Erf 23347 Paarl, the following recommendations, are made.

- A digger loader should be employed to excavate a series of trial trenches on the property, in order to check for human burial remains, or graves. The trenches should be at least 2 metres deep. This should be done well in advance of formal bulk earthworks commencing on the site. This activity must be monitored by a professional archaeologist.
- Should any human remains or graves be exposed or uncovered during trial excavations, these should immediately be reported to Reverend R.D. Cox of the St. Stephen's Anglican Church and the South African Heritage Resources Agency (SAHRA).
- In the event of burials being uncovered during trial excavations, the developer is requested to make a concerted effort to contact and consult with communities and individuals that have an interest in such graves.
- An investigation will be need to be conducted for the purpose of obtaining information on whether or not the grave(s) are protected in terms of the Heritage Resources Act, or is of significance to any community.
- That an agreement is reached with the Church, representing individuals or communities, and the developer(s), regarding the future of such graves
- Individuals or groups who claim an interest in the burials must contact the Church.
- If a grave(s) is protected or significant, assistance must be provided to any individual or community that is a direct descendant to make arrangements for exhumation, cremation and/or re-interment of the contents of the graves.
- The developer, through the Church, SAHRA, and Interested and Affected Parties, must arrange temporary storage of skeletal remains until community decisions are made concerning reburial and memorialization.
- A notice informing the community of the pending development should also be placed in the legal section of a National newspaper, as well as an editorial of interest. The local Paarl newspaper should also carry the editorial inviting the community to contact the Church with information. A 60-day mandatory waiting period is required to afford Interested and Affected Parties the opportunity to claim interest in the burial ground.
- Formal bulk earthworks and excavations must be monitored by a professional archaeologist, in case additional graves or human remains are uncovered.

- Should additional graves or human remains be uncovered or exposed during the development, the developer should impose a Cease Work Order. The agreement reached between the Church and the developer regarding the future of the graves, should be implemented.
- Contractors and plant operators should be briefed what to look out for during bulk earthworks and excavations.
- Human burials or human burial remains uncovered or disturbed during trial excavations, and bulk earthworks should not be removed or disturbed until inspected by a professional archaeologist.
- Burial remains should be treated sensitively at all times.

PLAN OF SUBDIVISION

PROPERTY : Erf 23347 Paarl
SITUATE IN : The Drakenstein Municipality, Admin District of Paarl

Scale 1/500

Ref: 1) S.G. Noting 885
 2) Co-ordinate System Lo 19°

Ptn No	Extent (m ²)
1	± 334
2	± 246
3	± 334
4	± 275
5	± 205
6	± 188
7	± 255
8	± 305
9	± 281
10	± 277
11	± 240
12	± 229
13	± 1535
TOTAL	4679

NOTES:

G denotes Garage
 P denotes Parking bay

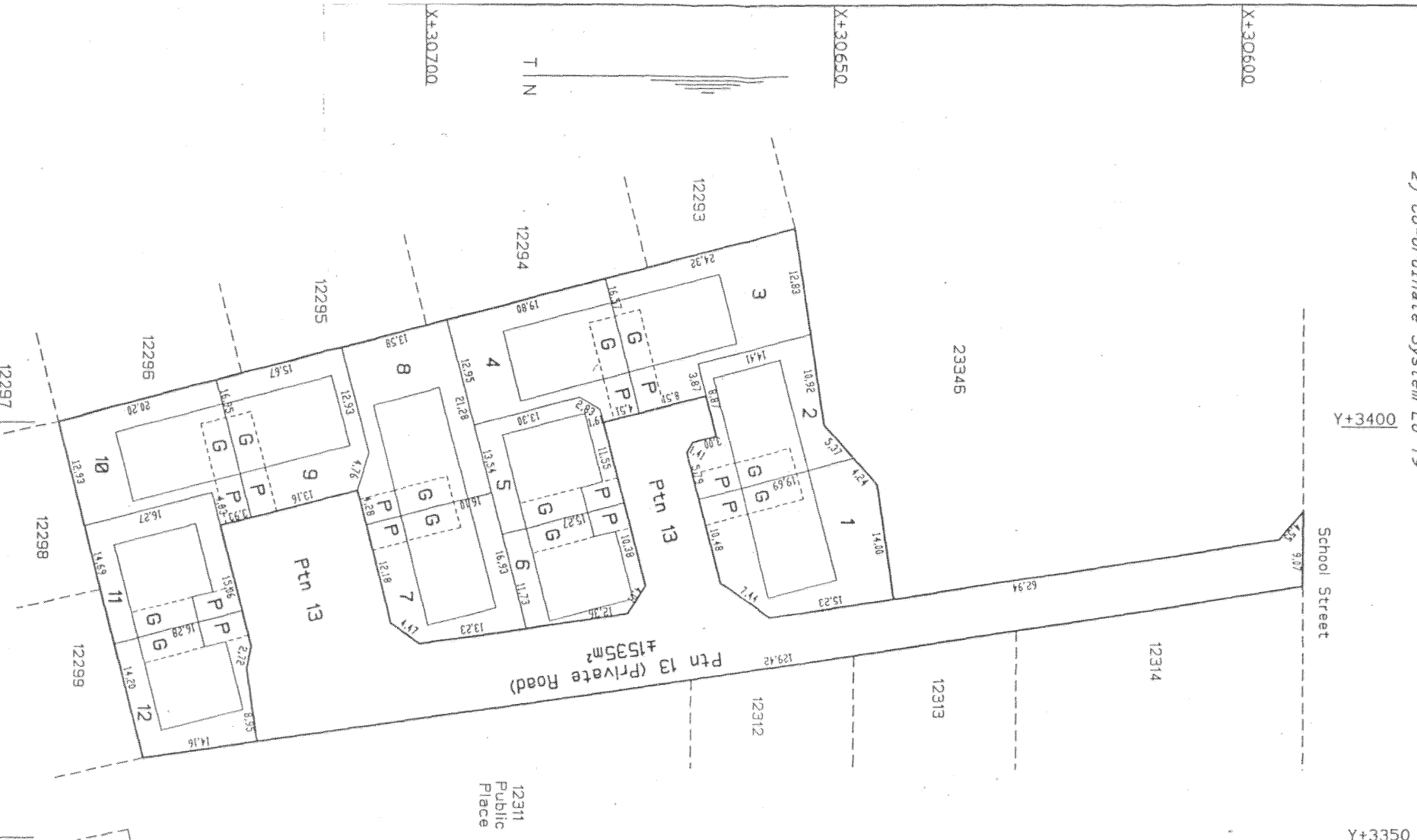

Prepared by

DAVID HELLIG & ABRAHAMSE
 LAND SURVEYORS
 P. O. BOX 18
 PAARL

DATE : July 2002

FILE : P1956/85(2) PLAN No 1

31 March 2003

David Hellig
David Hellig & Abrahamse
PO Box 18
Paarl
7622

Dear David

REPORT PHASE 1 ARCHAEOLOGICAL IMPACT ASSESSMENT ERF 23347 PAARL

Please find a copy of my final report.

I have also enclosed an invoice for the attention of Messrs Enslin & Van Zyl Boutrust

Yours sincerely

Jonathan Kaplan

Invoice 3376

March 31 2003

Att: Messrs Enslin & Van Zyl Boutrust
c/o David Hellig & Abrahamse
PO Box 18
Paarl
7622

PHASE 1 ARCHAEOLOGICAL IMPACT ASSESSMENT
ERF 23347
PAARL

1. Consultation Fieldwork & report: 1 day @ R 1920 p/day	=	R 1 920.00
2. Administrative costs (5%)	=	96.00
<hr/>		
TOTAL	=	R 2 016.00

agency for cultural resource management

From: "David Halkett" <dlh@age.uct.ac.za>
To: "agency for cultural resource management"
Sent: 02 April 2003 01:07
Subject: Re: erf 23346 paarl
Hi Jonathan,

I am well, just returned from a month in the diamond area so finding it difficult to readjust to the office!!

The whole erf 23346 thing is messy. The cemetery was supposedly exhumed in 1970's but we found that in fact very few bodies had been removed despite the protestations of the developers. It seems that an attempt was made to remove the gravestones and other grave related items and some were simply buried on site. The portion we worked on dates to the late 19th/early 20th c. From an early aerial photograph that I tracked down I estimate that there may be up to a thousand graves on the portion that you have been asked to look, at but as I have not done testing there I cannot say if any/all were exhumed. It is likely that they may not have been. You need to test the area extensively to see what is there (requires a permit). If anything remains, go to phase 2. Need to negotiate with the church, SAHRA etc. I was able to get around the 60 day advertising period because the advertising had been done in the 70's in accordance with the Provincial ordinance, but you may need to revisit this issue with SAHRA. You had better advise your client of the high possibility that there will be graves. When we did the exhumation, we had an arrangement through the client with an undertaker who removed the remains for correct disposal after we had excavated them. I suggest that you or your client contact Gavin Blows of the Survey Partnership, who I did the work for, in connection with the project (tel 021-872-1427 fax 021-872-5590 cell 082 859 0226 e-mail vgi@iafrica.com). Similarly, please obtain permission from Gavin Blows with regards to receiving the Phase 1 report (Phase 2 not yet complete). I feel that if I am to offer more detailed information on how to go about an exhumation, it should be subject to a consultancy agreement between us.

I hope this helps

Cheers

agency for cultural resource management wrote:

- >
- > | - Message autoforwarded from DLH@SCIENCE (DLH@science.uct.ac.za) -|
- >
- > | - Message autoforwarded from DLH@BEATTIE (dlh@beatie.uct.ac.za) -|
- >
- > dear dave - hi. hope you are well.
- > ive had a bit of correspondence with tim re some work i am doing in hout
- > bay, but i am writing to you with regard to a site i have been asked to look
- > at in paarl. a proposed development, and subdivision of erf 23347. which was
- > originally part of the property owned by st. stephens church
- > i came into the project quite late, via a recommendation from margaret

- > neethling that a phase 1 of the property be done. margaret did the heritage
- > review, but it is extremely brief.
- > it turns out, after speaking to reverend cox of the st. stephens church that
- > you excavated about 18 burials from the adjacent erf 23346, and in fact the
- > proposed subdivision (erf 23347) is the site of the original cemetery.
- >
- > while my client is saying all the graves were removed, the good reverend is
- > saying that to his knowledge no burials were removed, and that the cemetery
- > was just demolished sometime in the late 70's.
- >
- > so it is very likely that human remains will come up in the course of
- > earthworks and excavations.
- >
- > would it be possible to email, or post a copy of your report to me, i would
- > be very interested to see how you approached this, and of course to cite
- > your work.
- >
- > i think the developer is going to get a big skrik if burials come out, and
- > find that he is responsible for paying for the removal and reburial.
- >
- > no public participation has taken place and the church, or heritage
- > authorities have not been consulted with regard to the project. margaret
- > does mention that the site was a cemetery, but did not take it further.
- >
- > there is some urgency to this.
- >
- > regards
- > jonathan
- >
- > Jonathan Kaplan
- > PO Box 159
- > Riebeeck West, 7306
- > SOUTH AFRICA
- > Cell phone 082 321 0172