



AFRICAN HERITAGE CONSULTANTS CC

2001/077745/23

DR. UDO S KÜSEL

Tel/fax: (012) 567 6046
Cell: 082 498 0673
E-mail: udo.heritage@absamail.co.za

P.O. Box 652
Magalieskruin
0150

6 October 2006

CULTURAL HERITAGE RESOURCES IMPACT ASSESSMENT OF DEVELOPMENT SITE ON THE CORNER OF RUITER AND MORGAN STREETS LYDENBURG MPUMALANGA

1. DEFINITION

The broad generic term *Cultural Heritage Resources* refers to any physical and spiritual property associated with past and present human use or occupation of the environment, cultural activities and history. The term includes sites, structures, places, natural features and material of palaeontological, archaeological, historical, aesthetic, scientific, architectural, religious, symbolic or traditional importance to specific individuals or groups, traditional systems of cultural practice, belief or social interaction.

2. PROTECTED SITES IN TERMS OF THE NATIONAL HERITAGE RESOURCES ACT, ACT NO. 25 OF 1999

The following are the most important sites and objects protected by the National Heritage Act:

- 2.1 Structures or parts of structures older than 60 years.
- 2.2 Archaeological sites and objects.
- 2.3 Palaeontological sites.
- 2.4 Meteorites.
- 2.5 Ship wrecks.
- 2.6 Burial grounds.
- 2.7 Graves of victims of conflict.
- 2.8 Public monuments and memorials.

- 2.9 Structures, places and objects protected through the publication of notices in the Gazette and Provincial Gazette.
- 2.10 Any other places or object, which are considered to be of interest or of historical or cultural significance.
- 2.11 Geological sites of scientific or cultural importance.
- 2.12 Sites of significance relating to the history of slavery in South Africa.
- 2.13 Objects to which oral traditions are attached.
- 2.14 Sites of cultural significance or other value to a community or pattern of South African history.
- 2.15

3, METHODOLOGY

The site was visited, inspected on foot and by vehicle. All appropriate documents on the area were studied.

4. RESULTS

The site is presently overgrown by tall grass. The largest portion of the area has been ploughed for many years. Any archaeological sites in the development area would have been destroyed by this activity.

More or less in the centre of the site (S25° 06' 28.7" and E30° 28' 07.9") is a very dense patch of wattles (see photograph 1). Amongst these wattles is a large cemetery with marked and unmarked graves. Most tombstones are lying on the ground or have been broken. The oldest marked grave dates to 1909. Most graves fall in the period 1917 to 1924 (see photograph 2 and 3). What is interesting is that nearly all graves are those of young children. The number of graves present could not be determined as the dense wattle growth makes it nearly impossible to move through the area. There may be as many as twenty graves or more present. Local people in the vicinity of the cemetery have no oral knowledge of the site and the graveyard, as most of them are relative new in the area. Family names on the tombstones include Coetzen, Keller, Rheerders and Fourie. The tombstones are also very interesting as they have been made of slate and are hand carved. Some of these tombstones have folk art motives (Volkskuns) on them as decoration. These tombstones are typical early Boer tombstones (see photograph 4). The developer intends to preserve the cemetery as a private public space in the new development (see map of proposed township.

South of the cemetery are a number of exotic trees and the remains of an orchid and a dam. Some stonewalling is also present (S25° 06' 32.5 and E30° 28' 04.8"). This site must have been part of the original farm settlement, most probably of the farm Sterkspruit 33 JT. No trace of the original house could be found because of dense grass and wheat (see photograph 5 and map).

5. CONCLUSION

Both identified sites fall within the sixty-year clause of the National Heritage Resources Act, Act No. 25 of 1999 and may not be altered or destroyed without the permission of the Provincial Resources Authority. The cemetery site will be

preserved as part of a private open space within the new development. If the developer wants to demolish the dam site an application for demolishing will be required.

6. RECOMMENDATION

It is recommended that both identified sites be properly cleaned and documented and that the history of the cemetery be researched to try and establish the cause of death of all the young children.

As far as the cemetery is concerned it should be restored and kept as a special feature in the development.

The remains of the orchard, stonewalls and dam should be researched and documented after which an application can be made to the Provincial Resources Authority to destroy the site.

7. REFERENCE

Pretorius C 1992, Volkskuns in Suid Afrika

1/50 000 Map 2530AB Lydenburg

MAP



(1) Cemetery (2) Orchard and dam

PHOTOGRAPHS



No. 1 Wattle Trees in the cemetery



No. 2 One of the slate tombstones still intact



No. 3 One of the broken tombstones



No. 4 Hand carved tombstone with folk art motifs



No. 5 Stonewall with exotic trees and orchard as well as dam

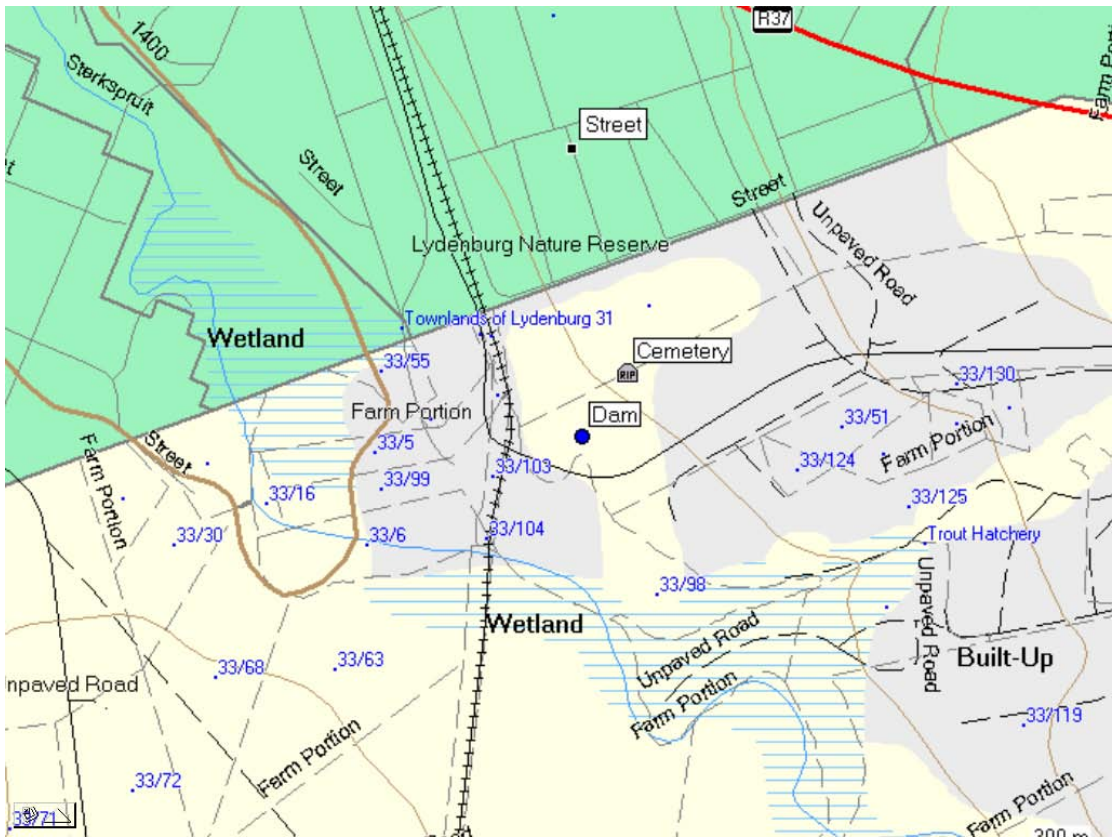

Map No. 1

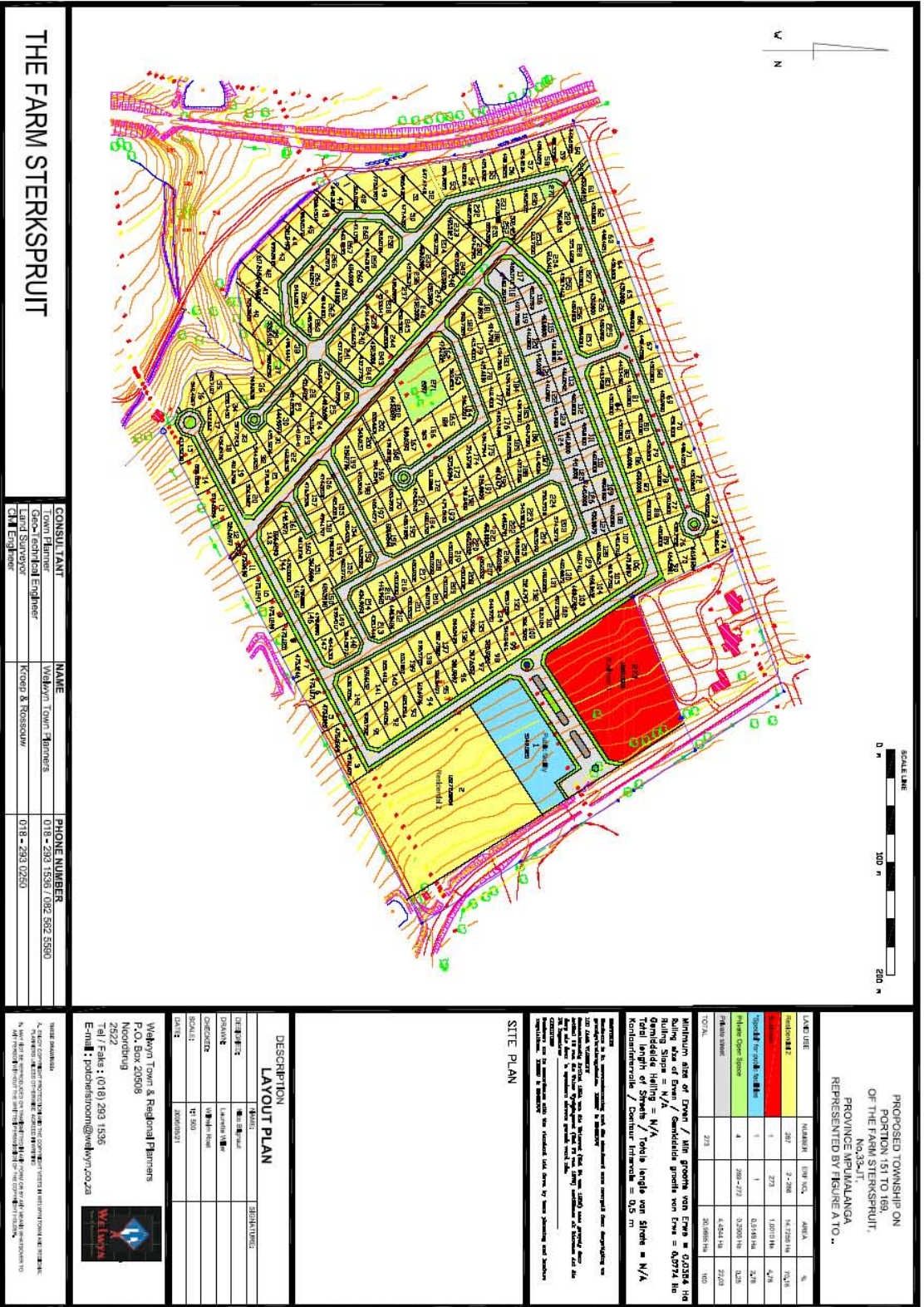

THE FARM STERKSPRUIT

CONSULTANT	NAME	PHONE NUMBER
TOWN PLANNER	WILMAYN TOWN PLANNERS	018 - 293 1536 / 082 592 5590
GRAD-REGISTERED ENGINEER		
LAND SURVEYOR	KRUPP & KRUPP	018 - 293 0250
CIVIL ENGINEER		

PROPOSED TOWNSHIP ON
 PORTION 151 TO 169
 OF THE FARM STERKSPRUIT,
 NO.35-111,
 PROVINCE MPUMALANGA
 REPRESENTED BY FIGURE A TO ..

LAND USE	NUMBER	AREA	%
RESIDENTIAL	287	14,728.14	70.8
ROADS	1	1,000.00	4.9
WATER	1	0.51814	0.02
WATER	1	289.272	1.42
WATER	1	6,824.14	33.2
TOTAL	291	20,842.05	100

Minimum slope of Street / R/RE property with Eaves in 0.025% (6 Bulding slope of Eave / demarcated ground with Eave = 0.0714 for demarcated Helling = N/A
 Total length of Streets / Trench length van Streets = N/A
 Kouderswaaiwaa / Straatwaai verloop = 0.50 m

SITE PLAN

1:100 (Scale of drawing)

1:100 (Scale of drawing)

1:100 (Scale of drawing)

DESCRIPTION LAYOUT PLAN

DESCRIPTION	DATE	APPROVED BY
DESIGNED BY		
DRAWN BY		
CHECKED BY		
SCALE	1:100	
DATE	2008/05/31	

Wilmayn Town & Regional Planners
 P.O. Box 200908
 Noordring
 20522
 Tel / Faks : (018) 293 1536
 E-mail : pcd@wilmayn.co.za



WILMAYN TOWN & REGIONAL PLANNERS
 A MEMBER COMPANY OF WILMAYN GROUP OF COMPANIES
 A MEMBER COMPANY OF WILMAYN GROUP OF COMPANIES
 A MEMBER COMPANY OF WILMAYN GROUP OF COMPANIES
 A MEMBER COMPANY OF WILMAYN GROUP OF COMPANIES

Map No. 2



AFRICAN HERITAGE CONSULTANTS CC

2001/077745/23

DR. UDO S KÜSEL

Tel/fax: (012) 567 6046

Cell: 082 498 0673

E-mail: udo.heritage@absamail.co.za

P.O. Box 652

Magalieskruin

0150

PROJECT DEVELOPMENT DATA

DEVELOPMENT SITE ON THE CORNER OF RUITER AND MORGAN STREETS LYDENBURG MPUMALANGA

Owners contact details: Welwyn Town and Regional Planners:

on behalve of Roebus Beleggings BK

PO Box 20508

Noordburg

2522

Tel: (018) 293 1536

Fax: (018) 293 1536

Developers contact details: Mr. Chris Joubert / Mr. Hennie Lamprecht

Nelesco 136 (PTY) LTD

Postnet Suite 252

Private Bag x 10

Elardus Park

0047

Tel: (086) 111 3149

Fax: (012) 367 7312

e-mail: chrisjoubert@bluezonegroup.com

Consultants contact details: Interdesign Landscape Architects

Claudia Coetzee / Karen Botes

PO Box 74648

Lynwood Ridge

0040

Tel: (012) 348 1922

Cell: 082 8934702

Fax: (012) 348 7154

e-mail: info@ilaweb.co.za

Type of development (e.g. low cost housing project, mining etc.)

Township establishment

Whether rezoning and/or subdivision of land is involved:

Yes, rezoning

Full location of Province, Magisterial District/Local Authority, property (e.g. farm, erf name and number):

Lydenburg Extension 67, situated next to the existing Lydenburg (south of Ruiters street)

Location map must have the polygon of the area to be surveyed on it and full geographical coordinates for all relevant points and where applicable indication of the area to be developed (footprint):

