



AFRICAN HERITAGE CONSULTANTS CC

2001/077745/23

DR. UDO S KÜSEL

Tel/fax: (012) 567 6046

Cell: 082 498 0673

E-mail: udo.heritage@absamail.co.za

P.O. Box 652

Magalieskruin

0150

26 September 2006

CULTURAL HERITAGE RESOURCES IMPACT ASSESSMENT OF PORTION 3 OF THE FARM GLENCOE 210 KT HOEDSPRUIT LIMPOPO PROVINCE

1. DEFINITION

The broad generic term *Cultural Heritage Resources* refers to any physical and spiritual property associated with past and present human use or occupation of the environment, cultural activities and history. The term includes sites, structures, places, natural features and material of palaeontological, archaeological, historical, aesthetic, scientific, architectural, religious, symbolic or traditional importance to specific individuals or groups, traditional systems of cultural practice, belief or social interaction.

2. PROTECTED SITES IN TERMS OF THE NATIONAL HERITAGE RESOURCES ACT, ACT NO. 25 OF 1999

The following are the most important sites and objects protected by the National Heritage Act:

- 2.1 Structures or parts of structures older than 60 years.
- 2.2 Archaeological sites and objects.
- 2.3 Palaeontological sites.
- 2.4 Meteorites.
- 2.5 Ship wrecks.
- 2.6 Burial grounds.
- 2.7 Graves of victims of conflict.
- 2.8 Public monuments and memorials.

- 2.9 Structures, places and objects protected through the publication of notices in the Gazette and Provincial Gazette.
- 2.10 Any other places or object, which are considered to be of interest or of historical or cultural significance.
- 2.11 Geological sites of scientific or cultural importance.
- 2.12 Sites of significance relating to the history of slavery in South Africa.
- 2.13 Objects to which oral traditions are attached.
- 2.14 Sites of cultural significance or other value to a community or pattern of South African history.

3, METHODOLOGY

The site was visited, inspected on foot and by vehicle. All appropriate documents on the area were studied.

4. RESULTS

The farm vegetation is typical Combretum bushveld with shallow rocky soils. No indication of any cultural heritage resources could be found on the farm except for a few Early Stone Age artefacts, which were exposed during ploughing (see photograph). The area has been ploughed over a long period of time, destroying any possible archaeological sites. The Early Stone Age material is out of context because of ploughing. The topsoil is also only 30 cm deep and no indications of a Stone Age site could be found.

As far as oral history is concerned there are no farm workers living on the farm. The present owner bought the farm less than ten years ago and also has no knowledge of the oral history of the farm.

5. CONCLUSION

There are no important cultural history resources on Portion 3 of the farm Glencoe 210 KT. The few Early Stone Age artefacts found are out of context and not worth preserving.

6. RECOMMENDATION

There is no objection to the development of Portion 3 of the farm Glencoe 210KT from a cultural heritage resources point of view.

PHOTOGRAPHS





AFRICAN HERITAGE CONSULTANTS CC

2001/077745/23

DR. UDO S KÜSEL

Tel/fax: (012) 567 6046

Cell: 082 498 0673

E-mail: udo.heritage@absamail.co.za

P.O. Box 652

Magalieskruin

0150

PROJECT DEVELOPMENT DATA

ASSESSMENT OF PORTION 3 OF THE FARM GLENCOE 210 KT HOEDSPRUIT LIMPOPO PROVINCE

Owners contact details:	
Mr. Tjaard Olivier	Tel: No. (015) 793 0562
Boshoff Trust	Cell No. 072 363 7111
P.O. Box 4	
Hoedspruit	
1380	
Developers contact details:	
Mr. Tjaard Olivier	Tel. No: (015) 793 0562
Boshoff Trust	Cell No. 072 363 7111
P.O. Box 4	
Hoedspruit	
1380	
Consultants contact details:	
African EPA	Tel. No: (012) 366 0100
Johan Goosen	Fax No: (012) 366 0111
P.O. Box 13776	
Hatfield	
Pretoria	
0028	
Type of development (e.g. low cost housing project, mining etc.)	
Estate Development	
Whether rezoning and/or subdivision of land is involved:	
Rezoning and Subdivision	

Full location of Province, Magisterial District/Local Authority, property (e.g. farm, erf name and number:

Limpopo – Hoedspruit Portion 3 Glencoe 210 KT

Location map must have the polygon of the area to be surveyed on it and full geographical coordinates for all relevant points and where applicable indication of the area to be developed (footprint):

If possible an aerial photograph of the specific area showing the location of all site.

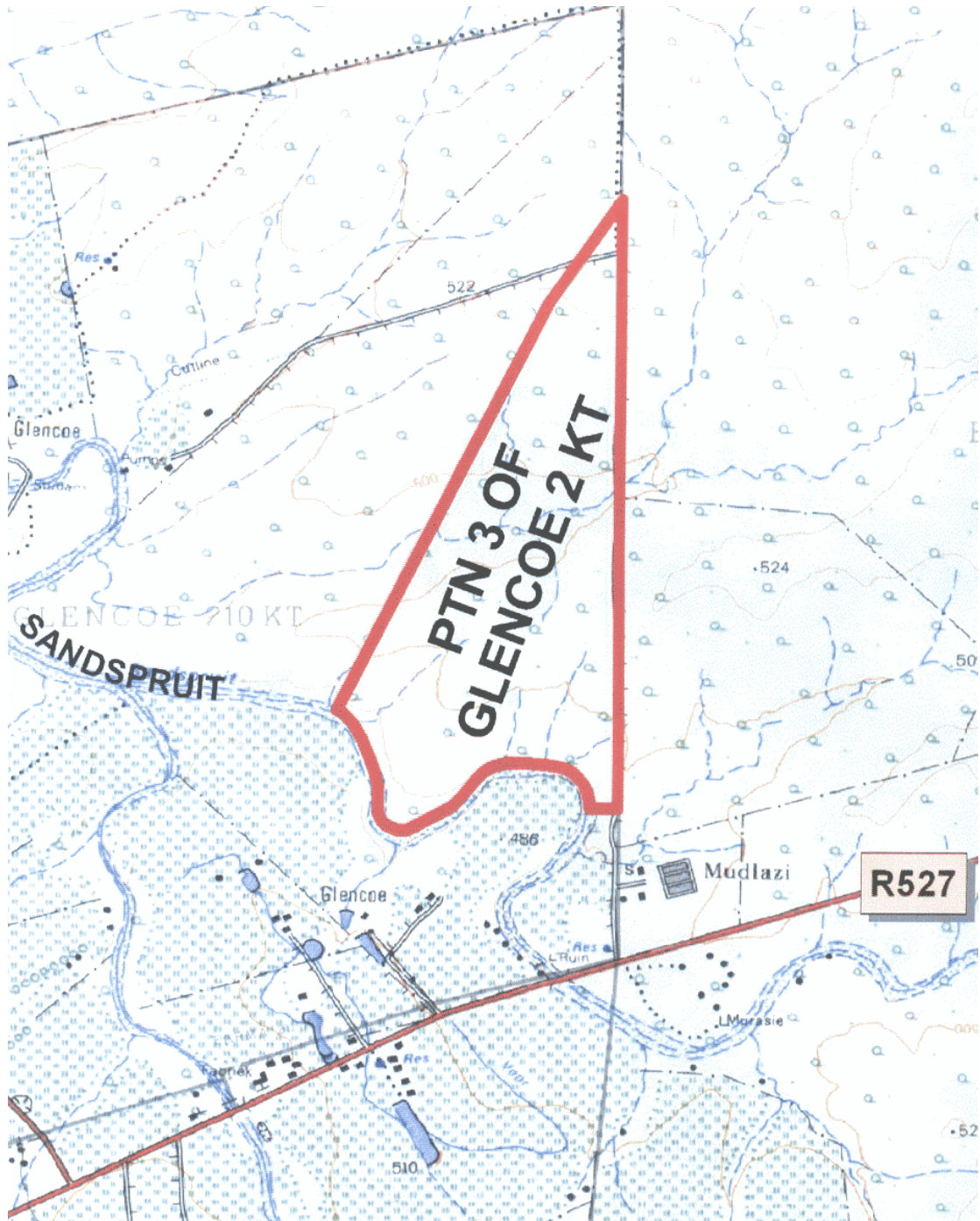

Map Glencoe