



AFRICAN HERITAGE CONSULTANTS CC

2001/077745/23

DR. UDO S KÜSEL

Tel/fax: (012) 567 6046
Cell: 082 498 0673
E-mail: udo.heritage@absamail.co.za

P.O. Box 652
Magalieskruin
0150

11 October 2007

CULTURAL HERITAGE RESOURCES IMPACT ASSESSMENT OF HOLDING 265 PRESIDENT PARK AGRICULTURAL HOLDINGS MIDRAND GAUTENG

1. DEFINITION

The broad generic term *Cultural Heritage Resources* refers to any physical and spiritual property associated with past and present human use or occupation of the environment, cultural activities and history. The term includes sites, structures, places, natural features and material of palaeontological, archaeological, historical, aesthetic, scientific, architectural, religious, symbolic or traditional importance to specific individuals or groups, traditional systems of cultural practice, belief or social interaction.

2. PROTECTED SITES IN TERMS OF THE NATIONAL HERITAGE RESOURCES ACT, ACT NO. 25 OF 1999

The following are the most important sites and objects protected by the National Heritage Act:

- a. Structures or parts of structures older than 60 years.
- b. Archaeological sites and objects.
- c. Palaeontological sites.
- d. Meteorites.
- e. Ship wrecks.
- f. Burial grounds.
- g. Graves of victims of conflict.

- h. Public monuments and memorials.
- i. Structures, places and objects protected through the publication of notices in the Gazette and Provincial Gazette.
- j. Any other places or object, which are considered to be of interest or of historical or cultural significance.
- k. Geological sites of scientific or cultural importance.
- l. Sites of significance relating to the history of slavery in South Africa.
- m. Objects to which oral traditions are attached.
- n. Sites of cultural significance or other value to a community or pattern of South African history.

3. METHODOLOGY

All relevant maps and documents on the site were studied. The site was visited and visually inspected.

4. RESULTS

The site is a vacant piece of land with typical Highveld grassland vegetation. No indications of any cultural heritage resources or graves are present on the site.

5. CONCLUSION

There are no important heritage resources or graves present on the site.

6. RECOMMENDATIONS

There is no objection to the proposed development from a cultural heritage resources point of view. Should any cultural heritage resources or graves be found during construction all work has to be stopped till the site has been inspected and mitigated by a cultural heritage resources practitioner.

7. SITE INFORMATION

Owners contact details: VCR Properties (Pty) Ltd PO Box 2500, Brooklyn Square 0075 Tel (012) 667 9808 Fax (012) 667 2041
Developers contact details: Same as above

<p>Consultants contact details:</p> <p>African EPA PO Box 13776 Hatfield, 0028 Tel (012) 366 0100 Fax (012) 366 0111</p>
<p>Type of development (e.g. low cost housing project, mining etc.) Residential Development</p>
<p>Whether rezoning and/or subdivision of land is involved: Agricultural to residential</p>
<p>Full location of Province, Magisterial District/Local Authority, property (e.g. farm, erf name and number): President Park Holding 265</p>
<p>Location map must have the polygon of the area to be surveyed on it and full geographical coordinates for all relevant points and where applicable indication of the area to be developed (footprint):</p>
<p>If possible an aerial photograph of the specific area showing the location of all site.</p>

8. REFERENCES

- Archaeological database of the National Cultural History Museum Pretoria
- 1/50 000 Map 2528 CC Centurion

MAPS

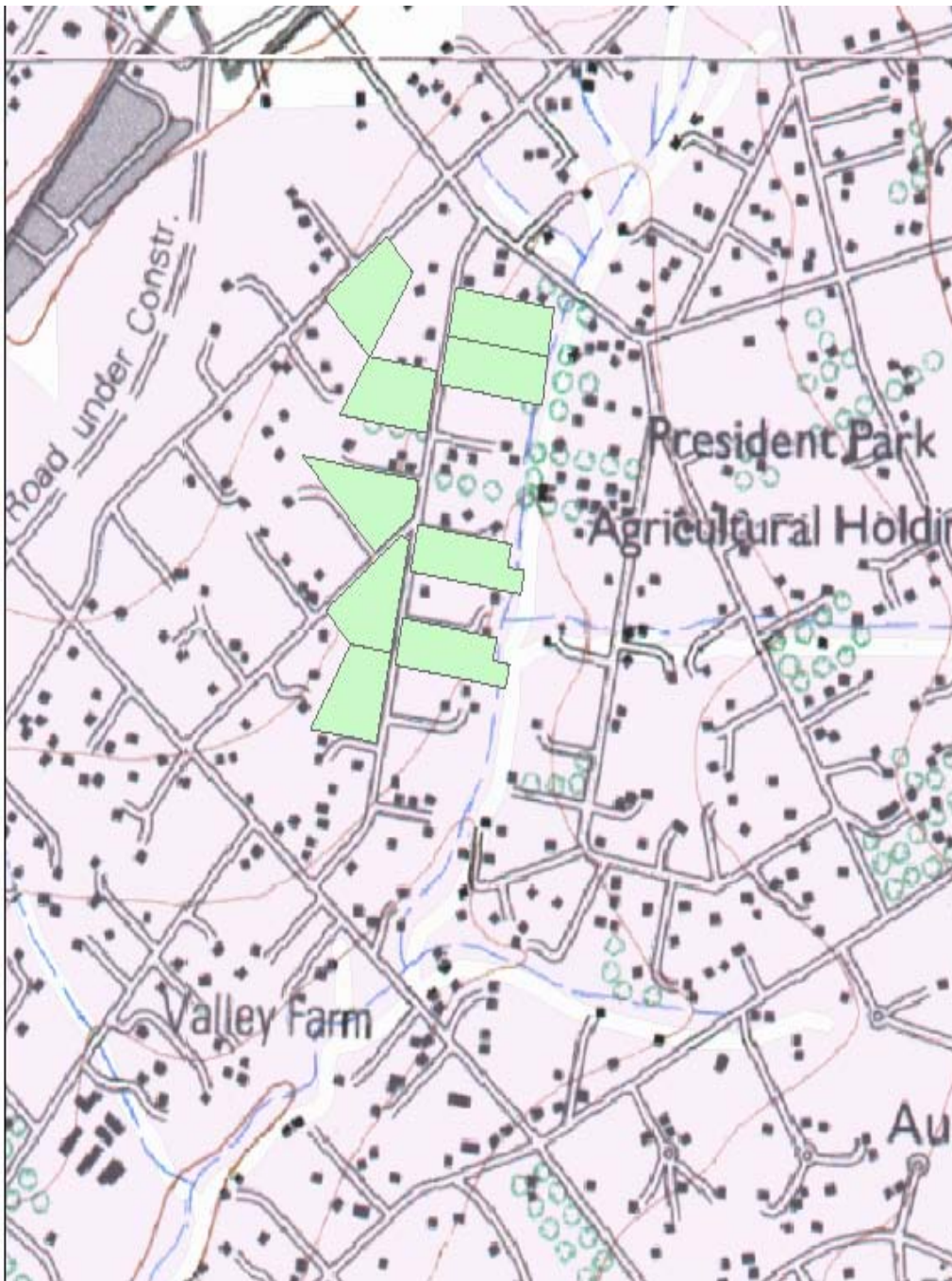

The stand is the marked green in the middle left pointing west, northwest

LEGEND

-  Rivers
-  Ecological Production
-  Wetland
-  Subject Property
-  High Agricultural Potential
-  Agricultural Hubs
-  Ridge Areas
-  Important
-  Irreplaceable
-  High Ecological Significance

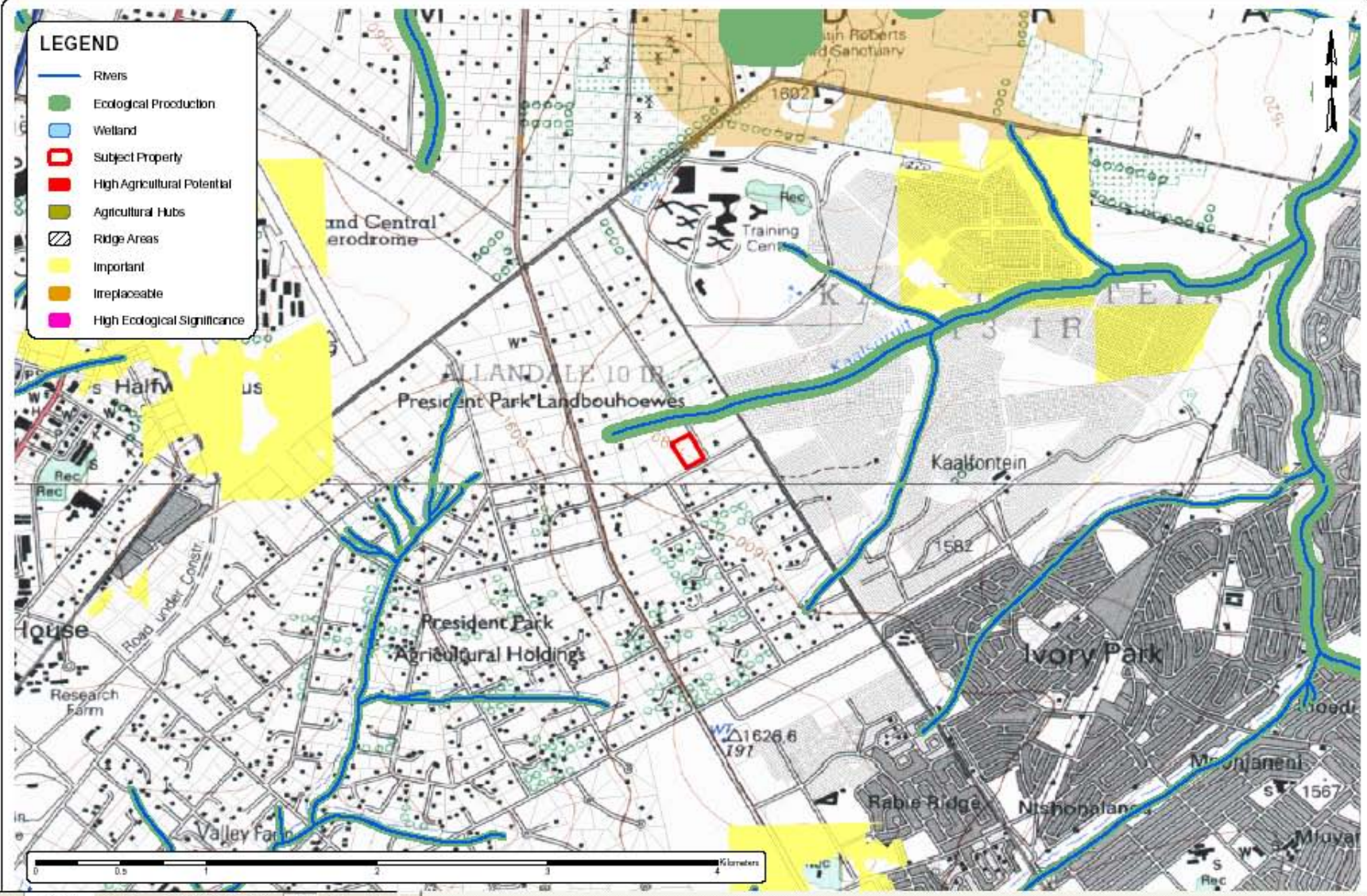

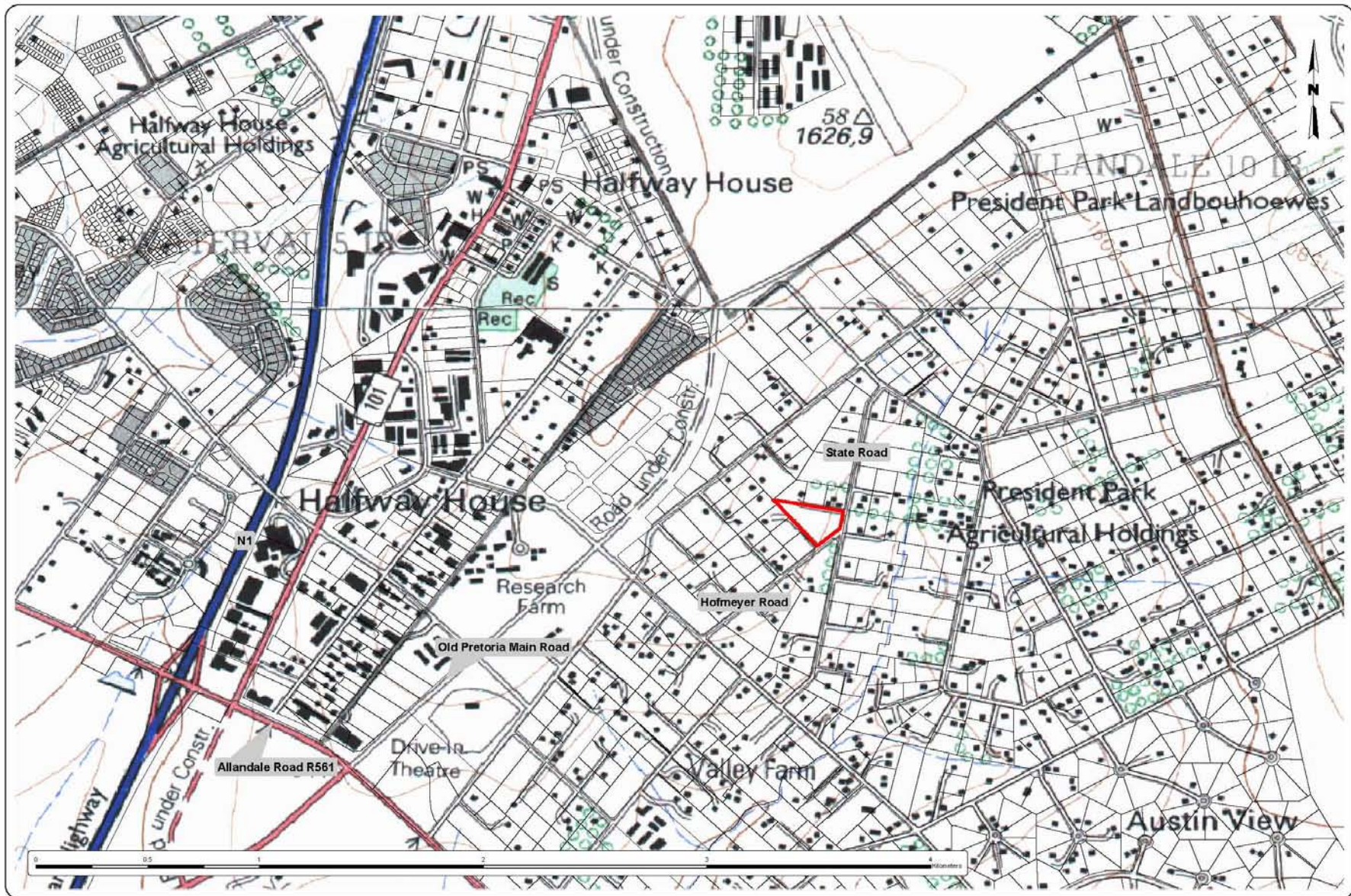

PRESIDENT PARK HOLDING 265
SCALE 1:15,000

FIGURE 001
LOCALITY

