

9/11/2004
80/12/198/207/51

REPORT

ON THE RELOCATION OF FOUR (4) GRAVES FROM THE PROPERTY OF LONMIN PLATINUM (ROOIKOPPIES 297 JQ)

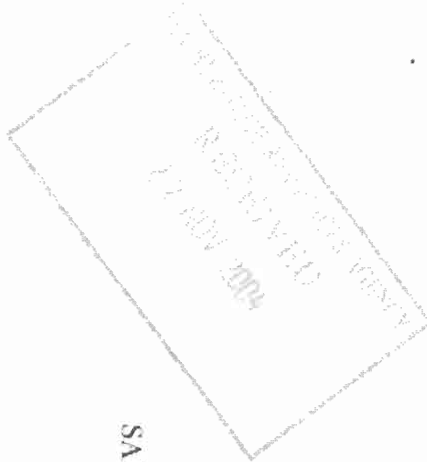

SAHRA PERMIT NO. 80/04/08/007/51

Reference: Lon-Rel-3
Compiled by: H. Steyn & C. Nienaber
Date: 22 September 2004



Professional Grave Solutions (Pty) Ltd
P O Box 14706
Halfeld 0028
Tel: +27 12 333 7142
Fax: +27 12 333 7213
E-mail: herk@grave.co.za

**REPORT ON FOUR GRAVES RELOCATED FROM THE PROPERTY OF
LONMIN PLATINUM**

Report compiled by: H.S. Steyn and W.C. Nienaber

Date of report: 22 September 2004

THE RELOCATION OF 4 GRAVES FROM THE PROPERTY OF LONMIN PLATINUM

This report is submitted in fulfilment of the requirements of:

- The agreement between *Professional Grave Solutions (Pty) Ltd* and *Lonmin Platinum* for the completion of the Project: *Lonmin Grave Relocation Project* 3.
- **The South African Heritage Resources Agency Permit No. 80/04/08/007/511** issued under Section 36(3) of the National Heritage Resources Act, Act no. 25 of 1999 to W.C. Nienaber (in association with H. Steyn).

This report covers the exhumation of the human remains of 4 individuals from the property of Lonmin Platinum on the farm Rooikoppies 2971Q in the Rustenburg district, Northwest Province on 24 - 25 August 2004 and the re-interment of the remains at the Tlapa Community Cemetery (Rustenburg District) on the 25th August 2004. The social consultation process is also discussed.

TABLE OF CONTENTS

1. Introduction	1
2. Social Consultation	1
3. Legal Compliance.....	1
4. Methodology	2
4.1 <i>Method of excavation</i>	2
5. Exhumation of remains and details of deceased.	3
Refer Appendix C – Photographs.....	3
5.1 <i>Lon 3/1</i>	3
5.2 <i>Lon 3/2</i>	4
5.3 <i>Lon3/3</i>	6
5.4 <i>Lon 3/4</i>	7
6. Conclusion	8
Literature cited.....	9
APPENDIX A – LOCALITY MAP.....	11
APPENDIX B – SITE LAYOUT MAP	12
APPENDIX C – PHOTOGRAPHS.....	13
APPENDIX D – PERMITS AND RELEVANT DOCUMENTATION	19

1. Introduction

Professional Grave Solutions (Pty) Ltd was contracted by *Lommin Platinum* to relocate 4 graves from their property (a portion of the farm Rooikoppies 2975Q). These graves needed to be relocated as they were directly affected by the expansion of the mining activities of the Karoo Mine section of Lommin Platinum. The graves were exhumed on 24 – 25 August 2004 and the remains of the deceased were reburied in the Tlapa Community Cemetery, Rustenburg District on the 25th August 2004.

2. Social Consultation

Professional Grave Solutions (Pty) Ltd appointed a local NGO, *Maditlokwa Integrated Community Development Projects*, to assist with the identification and tracking down of the affected families. Legal notices were placed at the cemetery as well as at the entrance to the mine. Newspaper notices were also placed in two local publications (*Rustenburg Herald* and *Britspost*). Only one enquiry were received in response to these notices but were not relevant to the graves in question.

Extensive social consultation was undertaken during July 2004 in order to identify and consult with the affected family members of the deceased. After the next of kin was located in a nearby village, the closest family member, Mr. Samuel N. Mangesi, identified the graves as that of his family and gave permission for the remains of his mother (Annie Mangesi), brother (Koos Mangesi) and son (not named, died when he was 10 days old) to be relocated. Although he was unsure about the identity of the fourth grave, one of the family members claimed that the grave belongs to Shirley Mangesi, a relative of Mr. Samuel Mangesi. This information were followed up but no further information could be found to confirm the identity of the grave.

It should be noted that Mr. Mangesi were never in any doubt that the graves were those of his family. Various older people in the vicinity supported his family's claim to the graves.

3. Legal Compliance

Exhumation and re-iniement is governed by Ordinance 12 of 1980 (Exhumations Ordinance), while handling and transportation of human remains are subject to the stipulations of Act 65 of 1983 (Human Tissues Act) as well as relevant Department of Health regulations. The graves and mortal remains of victims of conflict and graves older than 60 years in a burial ground not administered by a local authority, as well as all graves older than 100 years, are also subject to the stipulations of National Heritage Resources Act (Act 25 of 1999). All local laws and by-laws regarding cemeteries must also be adhered to.

In order to comply with the above, and taking into account the extreme urgency of the situation, permissions to exhume and re-inter the human remains and associated grave dressings and cultural remains were obtained from:

- South African Heritage Resources Agency

- The South African Police Services at Mooimooi were informed of the planned exhumations before work commenced. They were also reminded by fax of the exhumation on the day before it took place.
- Third Schedule Notices of Interment and Department of Home Affairs, Republic of South Africa Burial Orders were prepared for re-interment in the Tlapa Community Cemetery.
- Permission for reburial was obtained from the Headman of Tlapa Village, Mr. Reuben Manyaka.

4. Methodology

4.1 Method of excavation

The methods employed during exhumation aimed to recover all the remains, to minimise damage to the remains, to record the three-dimensional context of the remains and to preserve and respect the dignity of the buried individual. All evidence that might allude to the events leading to the death of the individual and circumstances regarding the event were recorded and interpreted. The information gathered was presented in a technical report.

The excavation methods employed accomplished the *in situ* exposure of the burial and associated artefacts (Nienaber and Steyn, 1999). The focus was on accurate and complete documentation (Nienaber, 1997). Various methods for the excavation of graves have been proposed by different authors (Hester, 1975; Joukowsky, 1980; Krogman and Iscan, 1986; Morse, 1978) and all stress the need for adequate workspace around the exposed remains and a systematic approach to the removal of individual bones. The archaeological method, including extensive test trenching to prevent damage to the remains, was employed. This approach was largely similar to that of forensic archaeology where buried body cases are concerned. The approach was adapted for each situation since graves vary in shape, size, depth and content (Nienaber, 1999). The methods used in forensic archaeology are discussed by Steyn, et.al. (2000).

In each case, the surface features of the grave were cleaned and documented. Hereafter the cultural material associated with the surface dressing were collected and catalogued, if they occurred. All observations regarding construction, materials and characteristics of the surface features were documented.

After the removal of the surface features the extent of the burial pit was ascertained through excavation and observation of differences in the matrix. After the indications of the presence and characteristics of the burial pit were documented, the in-fill was excavated to expose the human remains and associated cultural materials. Removal of the matrix of the burial pit was accomplished through the test-trench approach whereby a narrow trench (25-30 cm wide) is excavated with a trowel to a depth of between 15 and 20 cm in the lower third of the burial pit (in this instance the lower third usually constituted the eastern side of the grave). This area is chosen since it is most likely that the femurs of the skeleton occur in this part of the grave. Since the femur is a robust bone, it is usually not easily damaged through excavation. If no indications of the presence of human remains are observed in the test trench the remaining in-fill matrix, down to the depth of the test trench, was removed with a

shovel. The removed matrix was carefully screened to retrieve any possible cultural artefacts associated with the burial. This process was repeated until indications of the presence of human remains were observed.

As soon as human remains were encountered, care was taken to leave as much of the skeleton as possible covered in order to protect the remains from damage by excavation and to preserve the integrity of the context of the skeletal elements and possible associated cultural remains. The extent and characteristics of the burial pit were now documented and the workspace was assessed and enlarged if not sufficient. This was only done after documentation of the features of the burial pit and without sacrificing any vital information.

The excavation then continued with the aim of ascertaining the extent of the skeletal remains and the location of the different skeletal elements. As soon as the location and extent of the skeleton was established, a trench was dug around the remains so that the skeleton was enclosed in a low pedestal of matrix. The remains were then uncovered, starting from the middle and working outwards. This method again ensures the minimum disturbance of the remains and associated cultural materials. As soon as the skeleton was uncovered, it was documented *in situ*, removed, and packed for analysis, where this was required. A further test trench of 15 cm deep was dug in the area directly underlying the location of the remains to ensure that all possible remains and artefacts were found and recovered.

5. Exhumation of remains and details of deceased.

Refer Appendix C – Photographs

5.1 Lon 3/1

Details of deceased

Name:	Annie
Surname:	Mangesi
Age at death:	Unknown, probably in her 80's
Date of death:	1980's
Name of family representative:	Mr. Samuel N. Mangesi
New grave number:	Tlapa Community Cemetery, no number

Location of grave

The grave was part of an informal cemetery consisting of four graves arranged in a north/south line (**refer Appendix B – Site Layout Map**). The cemetery is situated on a portion of the farm Rooikoppies 297 JQ, on the border with the farm Spruitfontein (**refer Appendix A – Locality map**). The exact co-ordinates of the cemetery was:

27. 439409 E
-25. 715058 S

Surface features

The surface features of the grave consisted of several small to medium sized rocks, loosely scattered over an area measuring about 2.3 x 2.0m. No offering goods were found on the grave and the dressing was aligned along an east/west axis. No formal headstone was associated with the grave (**refer Appendix C, photograph 1**).

Excavation of grave and description of contents and features

After the grave dressing was removed, the excavation followed the extent of the surface features until cultural material in the form of a piece of corrugated iron was found at a depth of 1,45m. The nature of the soil was such that no grave pit could be discerned from the surrounding matrix. The burial pit was excavated by pick and shovel until the first indications of cultural material was found after which a trowel and brush were used. The extreme hardness of the soil also necessitated the use of a chisel to free the remains without damage.

Grave goods consisted of a number of rusted coffin nails as well as small wooden pieces of the coffin. A piece of rusted corrugated iron, placed on top of the coffin at the time of the burial, covered the remains

Human remains were found at a depth of 1.50m below the surface. The remains were very well preserved. The deceased were buried on his/her back in the extended position with the head to the west and the legs extended to the east. The arms were extended alongside the body and the legs were bent at the knees. (**refer Appendix C, photograph 2**). The exhumed remains were clearly those of a baby of undeterminable sex.

All human remains were recovered from the grave and placed in the new coffin.

Synthesis of evidence

According to the family representative, Mr Samuel Mangesi, the grave belonged to his mother, Annie Mangesi. This claim proved not to be true as the exhumed remains were clearly those of a very young child or a baby. The remains were buried on 25 August 2004 in the Tlapa Community Cemetery. The family representative, Mr Mangesi, was present at the exhumation and reburial. The headman of Tlapa Village, Mr. Reuben Manyaka, attended the reburial proceedings

5.2 Lon 3/2

Details of deceased

Name:	Koos
Surname:	Mangesi
Age at death:	Unknown, probably in his 30's
Date of death:	1970's
Name of family representative:	Mr. Samuel N. Mangesi
New grave number:	Tlapa Community Cemetery, no number

Location of grave

The grave was part of an informal cemetery consisting of four graves arranged next to each other along a north/south axis (**refer Appendix B – Site Layout Map**). The cemetery is situated on a portion of the farm Rooikoppies 297 JQ, on the border with the farm Spruitfontein (**refer Appendix A – Locality map**). The exact co-ordinates of the cemetery was:

27. 439409 E
-25. 715058 S

Surface features

The surface features of the grave consisted of a number of medium sized rocks, arranged to form a oval shaped stone outline. The inside of the dressing was filled with small stones and soil. The headstone consists of a single roughly rectangular slab of rock bearing no inscription. No offering goods were found on the grave. The dressing measured approximately 2.1m x 1.2m x .035m and was orientated east/west. (**refer Appendix C, photograph 3**).

Excavation of grave and description of contents and features

After the grave dressing was removed, the excavation followed the extent of the surface features until cultural material (rusted coffin nails) was found at a depth of 1,4m. The nature of the soil was such that no grave pit could be discerned from the surrounding matrix. The burial pit was excavated by pick and shovel until the first indications of cultural material was found after which a trowel and brush were used. The extreme hardness of the soil also necessitated the use of a chisel to free the remains without damage.

Human remains were found at a depth of 1.55m below the surface. The remains were relatively well preserved although the cranium suffered some damage due to the pressure of the soil. The deceased was buried on his/her back in the extended position with the head to the west and the legs extended straight to the east. The arms were extended alongside the body (**refer Appendix C, photograph 4**). The exhumed remains were clearly those of a very young child of undeterminable sex.

All human remains were recovered from the grave.

Synthesis of evidence

According to Mr. Samuel Mangesi, the family representative, the grave was those of his brother, Mr Koos Mangesi who died in the 1970's. As the remains recovered from the grave were clearly those of a young child, the information received from Mr. Mangesi appears to be incorrect. The remains were reburied on 25 August 2004 in the Tlapa Community Cemetery. The family representative, Mr Mangesi, was present at the exhumation and reburial. The headman of Tlapa Village, Mr. Reuben Manyaka, attended the reburial proceedings

No skeletal analyses were performed as the reburial has already be arranged for the same day as the exhumation and analyses was not requested by the family.

5.3 Lon3/3

Details of deceased

Name:	Shirley
Surname:	Mangesi
Age at death:	Unknown
Date of death:	Unknown
Name of family representative:	Mr. Samuel Mangesi
New grave number:	Tlapa Community Cemetery, no number

Location of grave

The grave was part of an informal cemetery consisting of four graves arranged next to each other along a north/south axis (**refer Appendix B – Site Layout Map**). The cemetery is situated on a portion of the farm Rooikoppies 297 JQ, on the border with the farm Spruitfontein (**refer Appendix A – Locality map**). The exact co-ordinates of the cemetery was:
27. 439409 E
-25. 715058 S

Surface features

The surface features of the grave consisted of a number of big and medium sized stones, arranged to form elongated grave dressing. No formal headstone was observed. No grave goods were found on the grave. The dressing measured 2.2m x 1.4m x 0.4m and was orientated east/west. (**refer Appendix C, photograph 5**).

Excavation of grave and description of contents and features

After the grave dressing was removed, the excavation followed the extent of the surface features until cultural material (rusted coffin nails) was found at a depth of 1.4m. The nature of the soil was such that no grave pit could be discerned from the surrounding matrix. The burial pit was excavated by pick and shovel until the first indications of cultural material was found after which a trowel and brush were used.

Human remains were found at a depth of 1.5m below the surface The preservation of the remains was very poor. Only a few small fragments of bone were recovered, making an estimate of the age and sex of the individual impossible. Due to the poor preservation the burial position could not be discerned. **refer Appendix C, photograph 6**).

All human remains were recovered from the grave.

Synthesis of evidence

According to members of the Mangesi family, the remains were those of a distant relative, Shirley Mangesi. Neither Mr. Mangesi, nor his brother Mr. Alson Mangesi had any further information regarding the identity of the deceased. No additional

information could be gleaned from the human remains recovered from the grave. The remains were reburied in the Tlapa Community Cemetery. The family representative, Mr Mangesi, was present at the exhumation and reburial. The headman of Tlapa Village, Mr. Reuben Manyaka, attended the reburial proceedings

5.4 Lon 3/4

Details of deceased

Name:	Not named (too young)
Surname:	Mangesi
Age at death:	10 days
Date of death:	1960's
Name of family representative:	Mr Samuel Mangesi
New grave number:	Tlapa Community Cemetery, no number

Location of grave

The grave was part of an informal cemetery consisting of four graves arranged next to each other along a north/south axis (**refer Appendix B – Site Layout Map**). The cemetery is situated on a portion of the farm Rooikoppies 297 JQ, on the border with the farm Spruitfontein (**refer Appendix A – Locality map**). The exact co-ordinates of the cemetery was:

27. 439409 E
-25. 715058 S

Surface features

The surface features of the grave consisted of a number of scattered medium sized stones, arranged to form a roughly oval grave dressing. No formal headstone was observed. No grave goods were found on the grave dressing. The dressing measured approximately 2.0m x 1.2m x 0.35m and was orientated east/west. (**refer Appendix C, photograph 7**).

Excavation of grave and description of contents and features

After the grave dressing was removed, the excavation followed the extent of the surface features until cultural material (a piece of corrugated iron) was found at a depth of 1,55m. The nature of the soil was such that no grave pit could be discerned from the surrounding matrix. The burial pit was excavated by pick and shovel until the first indications of cultural material was found after which a trowel and brush were used. A chisel was used to free the remains from the surrounding soil.

Grave goods consisted of a number of rusted coffin nails. A piece of rusted corrugated iron, placed on top of the coffin at the time of the burial, covered the human remains

Human remains were found at a depth of 1.55m below the surface. The remains were well preserved. The deceased was buried on his/her back in the extended position with

the head to the west and the legs extended to the east. The right arm was bent at the elbow and the hand rested next to the pelvic area. The exact position of the left arm could not be discerned (**refer Appendix C, photograph 8**). The remains were those of a small child.

All human remains were recovered from the grave.

Synthesis of evidence

According to Mr. Mangesi, the remains were those of his son who died in the 1960's approximately 10 days after birth. The boy died without being named. The remains were reburied in the Tlapa Community Cemetery. The family representative, Mr Mangesi, was present at the exhumation and reburial. The headman of Tlapa Village, Mr. Reuben Manyaka, attended the reburial proceedings.

6. Conclusion

During the relocation process four graves were identified for relocation. The social consultation process identified the next of kin to be Mr. Samuel Mangesi. His relation to the deceased were confirmed by various persons in the community. The consultants accompanied Mr. Mangesi to the cemetery to be relocated and he (Mr. Mangesi) identified the graves without hesitation.

The exhumation took place on 24-25 august 2004. The remains recovered from Lon 3/1, 3/2 and 3/4 were those of very small children while the remains from Lon 3/3 were too poorly preserved to reliably observe its age or sex.

Mr. Mangesi was at a loss to explain the discrepancy between the information he gave to the consultants regarding the age of the deceased and the actual age of the remains. He explained that he was very young when these people died and could have been mistaken when he named the deceased. The social consultation process is continuing in order to address this issue.

All the remains were reburied in the Tlapa Community Cemetery on the 25th of August 2004.

Literature cited

- Aufderheide, A.C. & Rodriguez-Martin, C. 1998. *The Cambridge Encyclopedia of Human Paleopathology*. Cambridge: Cambridge University Press.
- Buikstra, J.E. & Ubelaker, D.H. 1994. Standards for data collection from human skeletal remains. *Arkansas Archaeological Survey Research Series*. no.: 44.
- De Villiers, H. 1968. *The skull of the South African Negro*. Johannesburg: Witwaterstrand University Press.
- Ferembach, D., Schwiderzky, I. & Stloukal, M. 1980. Recommendations for age and sex diagnoses of skeletons. *Journal of Human Evolution*. 9:517-549.
- Hester, T.R. *et al.* 1975. *A Guide to Field Methods in Archaeology*. Palo Alto.
- Joukowsky, M. 1980. *A Complete Manual of Field Archaeology*. Engelwood Cliffs.
- Krogman, W.M. & Iscan, M.Y. 1986. *The Human Skeleton in Forensic Medicine*. Springfield: Charles C. Thomas.
- Loth, S. & Henneberg, M. 1996. Mandibular ramus flexure: a new morphologic indicator of sexual dimorphism in the human skeleton. *American Journal of Physical Anthropology*. 99:473-485.
- Olivier, G Aaron C, Fully G, Tissier G. 1978. New estimation of stature and cranial capacity in modern man. *Journal of Human Evolution* 7:513-518.
- Morse, D. (ed.). 1978. *Handbook of Forensic Archaeology and Anthropology*. Tallahassee.
- Nienaber, W.C. 1997. Exhumation and Reinterment of Burgher C.G. Naude. *South African Journal of Culture History*. 11(1):123-133.
- Nienaber, W.C. and Steyn, M. 1999. Exhumation and Analysis of the Remains of a Black Native Participant in the Anglo-Boer war (1899-1902), KwaZulu-Natal. *South African Journal of Culture History*. 13(2):94-110.
- Ortner, D.J. & Putschar, W.G.J. 1981. *Identification of pathological conditions in human skeletal remains*. Washington, D.C.: Smithsonian Institution Press.
- Scheuer, L. & Black, S. 2000. *Developmental Juvenile Osteology*. San Diego: Academic Press.
- Steinbock, R.T. 1976. *Paleopathological diagnosis and interpretation*. Illinois: Charles C. Thomas.

- Steyn, M., Nienaber, W.C. and Iscan, M.Y. 2000. Excavation and Retrieval of Forensic Remains. In: Siegel, J.A., Saukko, P.J. and Knupfer, G.C. (eds.). *Encyclopaedia of Forensic Sciences*. Sidcup: Academic Press. 235-242.
- Steyn, M. & Iscan M.Y. 1999. Osteometric variation in the humerus: sexual dimorphism in South Africans. *Forensic Science International*. 106(2):77-85
- Steyn, M., Iscan, M.Y. 1997. Sex determination from the femur and tibia in South African whites. *Forensic Science International* 90:111-119
- Steyn, M., Iscan, M.Y. 1998. Sexual dimorphism of the crania and mandibles of South African whites. *Forensic Science International* 98:9-16
- Steyn, M., Meiring, J.H., Nienaber, W.C. & Loots, M. 2002. Large fontanelles in an early 20th century rural population from South Africa. *International Journal of Osteoarchaeology* 12:291-296.

APPENDIX A – LOCALITY MAP

APPENDIX B – SITE LAYOUT MAP

LONMIN GRAVE RELOCATION PROJECT 3: SITE LAYOUT MAP

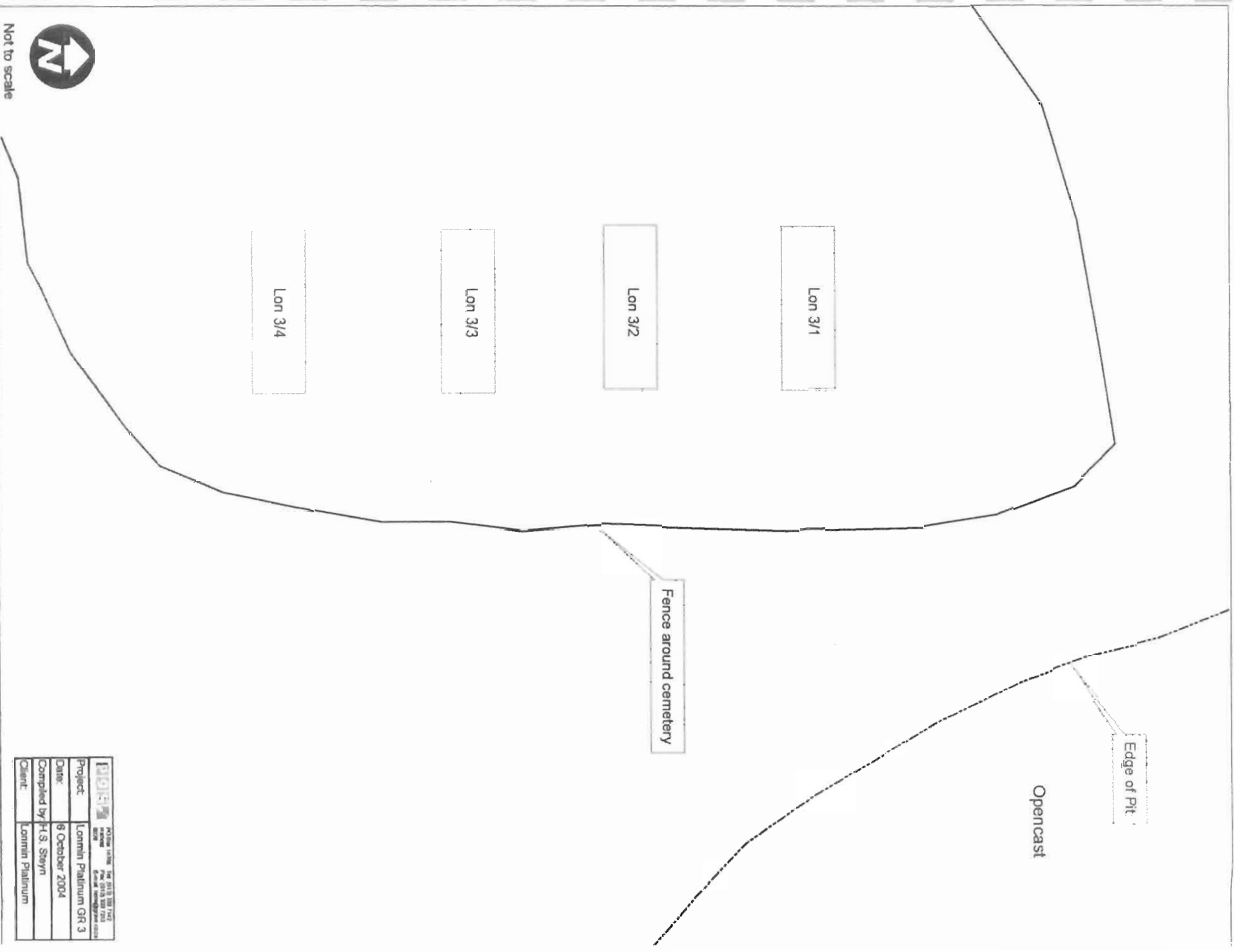

	PROJECT NAME Lon 3/1, 3/2, 3/3, 3/4
Project	Lonmin Platinum GR 3
Date	9 October 2004
Compiled by	H.S. Steyn
Client	Lonmin Platinum

APPENDIX C – PHOTOGRAPHS



Photograph 1: LON 3/1 Dressing



Photograph 2: LON 3/1 Remains



Photograph 3: LON 3/2 Dressing

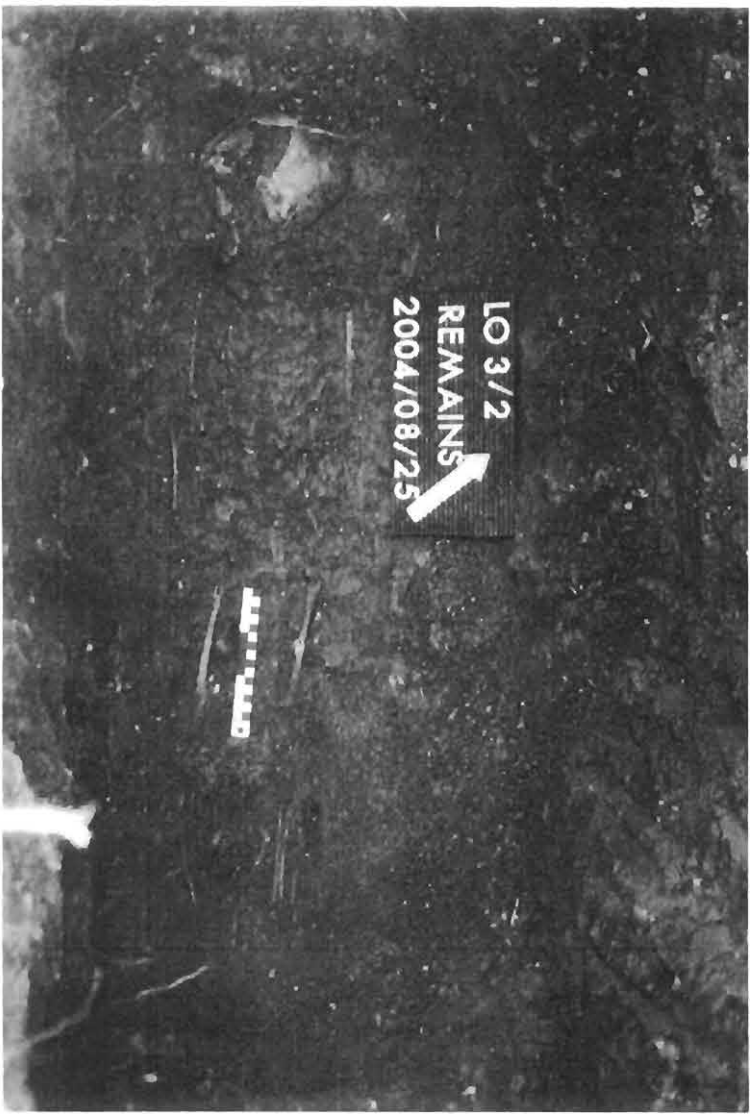

Photograph 4: LON 3/2 Remains



Photograph 5: LON 3/3 Dressing

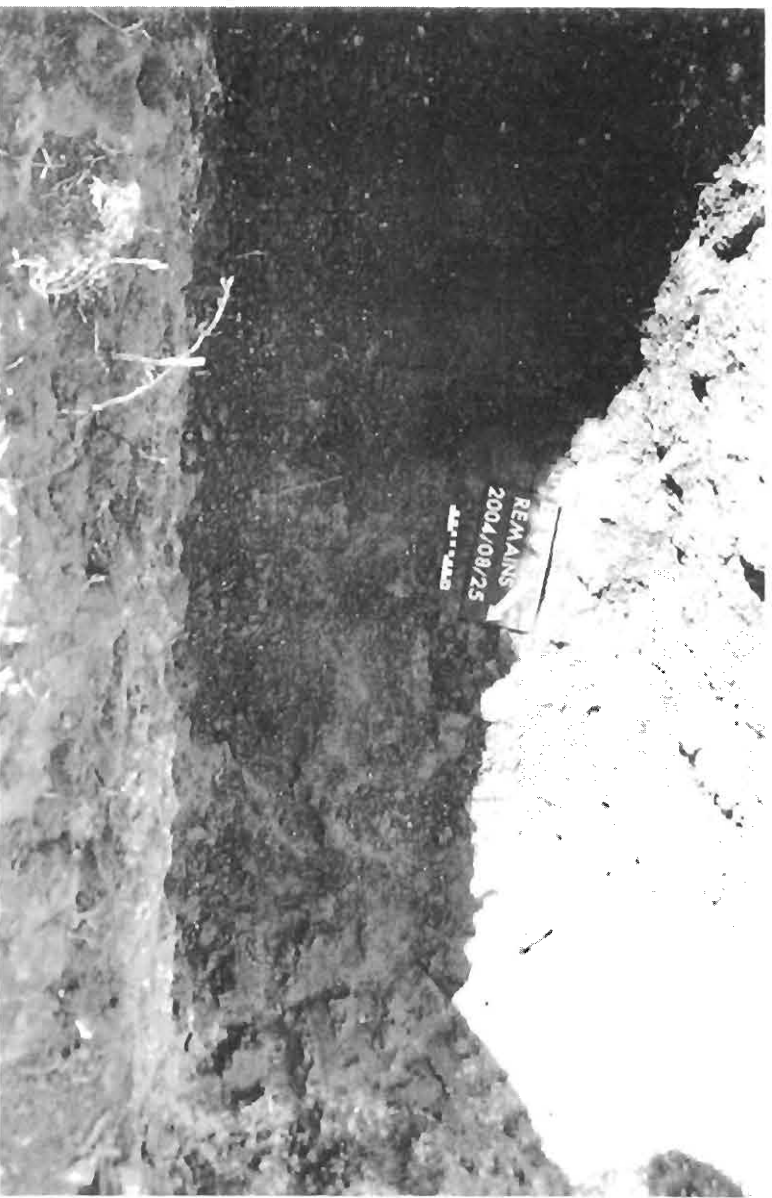

Photograph 6: LON 3/3 Remains

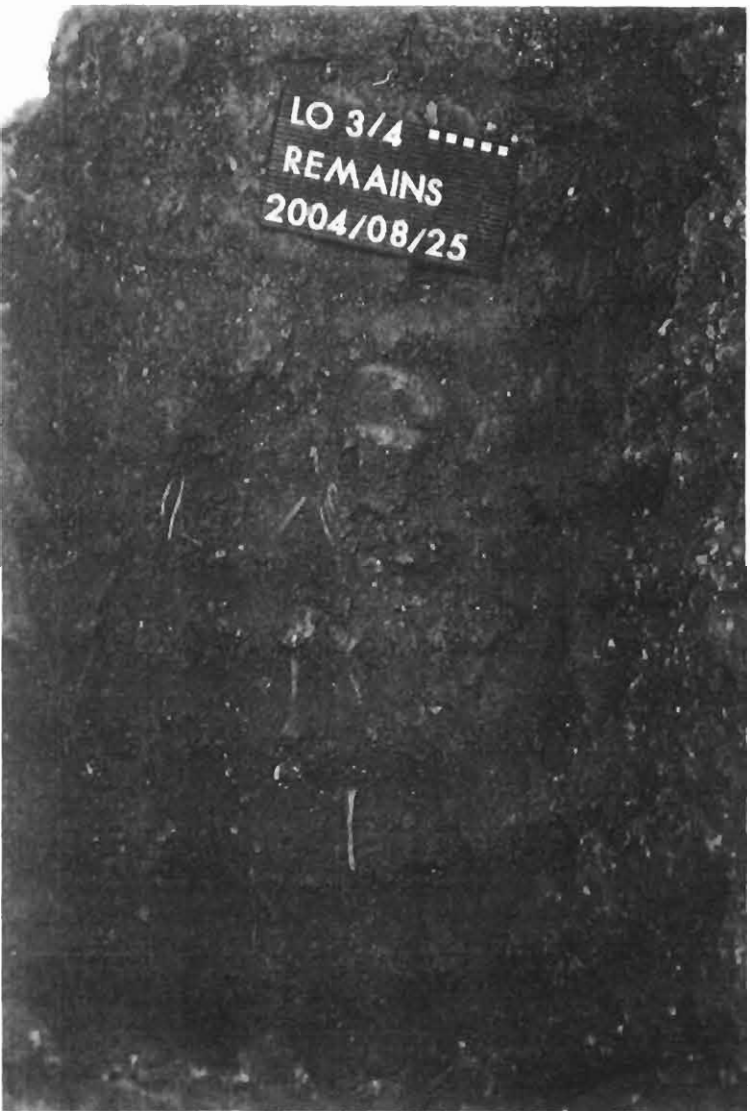

Photograph 8: LON 3/4 Remains



Photograph 7: LON 3/4 Dressing



Photograph 9: Due to the extreme hardness of the soil, a chisel had to be used to free the remains



Photograph 10: Mr. Samuel Mangesi (indicated by the arrow) at the reburial site.

APPENDIX D – PERMITS AND RELEVANT DOCUMENTATION



Survey no. of grave: LON 31 / 103

Relation to deceased: _____

Age at death: _____

Cause of death: _____

LONMIN OPEN CAST MINE

Request for Exhumation and Re-interment

Re-interment at: Tlapa Cemetery

Herewith I, Samuel Ntsokolo Manyosi
(Full names and surname)

Our (the family's) motivation for this request is the development of the open cast mine that cannot continue unless the remains of our family member is exhumed and re-interred in a cemetery in a location not affected by the proposed development.

I.D. no.: 26 05 18 01 79 081

I declare that this request was not made under duress.

Acting as a representative of the family of the deceased, and with the full knowledge and approval of all family members, request the exhumation and re-interment of the remains of:

Signed: _____ at _____

Shirley Manyosi
(Full names and surname of the deceased)

on this _____ day of _____ 20 _____

Witness: _____

Sex of deceased: M F

Comments: Family member was interviewed at his home

Date of death: _____ / _____ / _____
(YYYY) (MM) (DD)



Survey no. of grave: LON 3 / 102

Relation to deceased: Deceased's brother

LONMIN OPEN CAST MINE

Age at death: 30's

Request for Exhumation and Re-interment

Cause of death: Illness

Herewith I, Samuel Mtsokolo Manguzi
(Full names and surname)

Re-interment at: Thapa Cemetery

Our (the family's) motivation for this request is the development of the open cast mine that cannot continue unless the remains of our family member is exhumed and re-interred in a cemetery in a location not affected by the proposed development.

I.D. no.: 26 05 18 01 790 81

I declare that this request was not made under duress.

Acting as a representative of the family of the deceased, and with the full knowledge and approval of all family members, request the exhumation and re-interment of the remains of:

Signed: SAMUEL at Lehgalong

on this 21st day of July 200004

Koos Manguzi
(Full names and surname of the deceased)

Witness: Chuthuran

Comments: Family members believe was interred at his home.

Sex of deceased: M F

Date of death: 1970 (YYYY) \ (MM) \ (DD)



Survey no. of grave: LON 3 / / 04

Relation to deceased: Deceased father

Age at death: 10 days

Cause of death: Illness

LONMIN OPEN CAST MINE

Request for Exhumation and Re-interment

Re-interment at: Thupa Cemetery

Herewith I, Samuel N. Mangesi
(Full names and surname)

Our (the family's) motivation for this request is the development of the open cast mine that cannot continue unless the remains of our family member is exhumed and re-interred in a cemetery in a location not affected by the proposed development.

I.D. no.: 26 05 18 01 79081

I declare that this request was not made under duress.

Acting as a representative of the family of the deceased, and with the full knowledge and approval of all family members, request the exhumation and re-interment of the remains of:

Signed: C. GOMI VEV at Lebyaleng

Baby (Unnamed) Mangesi
(Full names and surname of the deceased)

on this 21st day of July 20 04

Witness: Guthura

Sex of deceased: M F

Comments: _____

Date of death: 1960^s \ \
(YYYY) (MM) (DD)



Survey no. of grave: LON 3 / 101

Relation to deceased: Deceased's son

Age at death: Unknown, probably in his 50's

Cause of death: Allness

LONMIN OPEN CAST MINE

Request for Exhumation and Re-interment

Re-interment at: Thapa Cemetery

Herewith I, Samuel N. Mangesi
(Full names and surname)

Our (the family's) motivation for this request is the development of the open cast mine that cannot continue unless the remains of our family member is exhumed and re-interred in a cemetery in a location not affected by the proposed development.

I.D. no.: 26 05 18 01 79 081

I declare that this request was not made under duress.

Acting as a representative of the family of the deceased, and with the full knowledge and approval of all family members, request the exhumation and re-interment of the remains of:

Signed: Samuel N. Mangesi at Lekya long

Anne Mangesi
(Full names and surname of the deceased)

on this 21st day of July 2004

Witness: Chathware

Sex of deceased: M F

Comments: _____

Date of death: 1980's / /
(YYYY) (MM) (DD)



DEPARTMENT: HOME AFFAIRS
REPUBLIC OF SOUTH AFRICA
BURIAL ORDER

NB: Print in black pen.

*Serial Number of death register *Low 3/3*

DECEASED

*Identity number	W / b .									Date of birth						
Surname	MENDUM															
Forenames in full																
Gender	M															
Place of death (town/city)	KUS TENGURU G.															
Cause of death	MORTAL															
Intended place of burial/cremation	TLAGA.															

Date of death/still-birth *1952*

AUTHORITY FOR REMOVAL OF CORPSE/BURIAL

This certificate grants the authority for the burial, and if necessary, the removal of the corpse from the magisterial district in which the death occurred to a place outside the particular magisterial district.

[Signature]
Director-General: Home Affairs

(Person authorized in terms of section 4 of Act 51 of 1982)

THUSANANG / HELPMEKAAR
ONDERTAKERS / ONDERNEMERS
 BK 87/20143/23
 MICHAEL BRINK STR. 894
 P.O. BOX 26062
 VILLIERIA - PRETORIA
 TEL : (012) 331-1948

Rank/Force No./Designation No. *P068/96*

Date issued *23/8/64*

Address

THUSANANG / HELPMEKAAR
ONDERTAKERS / ONDERNEMERS
 BK 87/20143/23
 MICHAEL BRINK STR. 894
 P.O. BOX 26062

NOTE: This order must be delivered to the Registrar of Burial and Cremation in the place of burial/crematorium.
 * Not applicable in the case of a stillbirth.



DEPARTMENT: HOME AFFAIRS
REPUBLIC OF SOUTH AFRICA

BURIAL ORDER

NB: Print in black pen.

*Serial Number of death register LON 3/1

DECEASED

*Identity number

1410

Date of birth

ADULT

Surname

MANGESI

Forenames in full

ANNIE

Gender

FEMALE

Date of death/still-birth

1950

Place of death (town/city)

RUSTENBURG

Cause of death

NATURAL

Intended place of burial/cremation

TLAPA

AUTHORITY FOR REMOVAL OF CORPSE/BURIAL

This certificate grants the authority for the burial, and if necessary, the removal of the corpse from the magisterial district in which the death occurred to a place outside the particular magisterial district.

Director-General: Home Affairs

Rank/Force No./Designation No.

P068/96

(Person authorized in terms of section 4 of Act 51 of 1992)

THUSANANG/HELPMENKAAR
UNDERTAKERS/ONDERNEMERS
BK 87/20143/23
MICHAEL BRINK STR. 894
P.O. BOX 26062
VILLIERIA - PRETORIA
TEL : (012) 331-1948

Date issued

23/8/04

Address

THUSANANG/HELPMENKAAR
UNDERTAKERS/ONDERNEMERS
BK 87/20143/23
MICHAEL BRINK STR. 894
P.O. BOX 26062
VILLIERIA - PRETORIA
TEL : (012) 331-1948

NOTE: This order must be delivered to the person in charge of the place of burial/crematorium.

* Not applicable in the case of a still birth.

TSEBIŠO:

**GO EPOLLA LE GO BOLOKA LEFSA ĞA BAHU BA BA BOLOKILWEGO
DIRAPENG TŠE DI AMEGAGO MO PROJEKENG YA GO TŠWETŠA PELE
OPENCASPT PITS YA LONMIN PLATINUM MO DIKAROLWANENG TŠA
DIPOLASA TŠA ROOKOPPIES 297 JQ (25° 42' 54,2" S, 27° 26' 22,4"E)**

24 June 2004

Go tsebišwa gore Professional Grave Solutions Pty Ltd ye e šomago bjalo ka barerišani legatong la Lonmin Platinum ba šišinya go dira kgopelo ka lengwalo, go ya ka Molawana wa Go šuthiša ga Mabitla le Batho ba ba hlokoferisego (Molawana 7 wa 1925); le Kgaolo ya 35 le 36 tša Molao wa Bosetšhaba wa Ditlabelwa tša Bohwa (Molao 25 wa 1999) gammogo le melawana ye mengwe ya tshapedišo ya Taolo ya Profense ya North West, go hwetša tumelelo ya go epolla le go boloka lefša mašaledi a bahu ba ba angwago ke projeke ye e boletšwego ka mo godimo. Bahu ba tlo bolokwa mabitleng a kgauswi bjalo ka ge go laeditšwe.

Batho le ditšhaba ka moka tše di tswalanego le batho ba ba bolokiwego lefelong le gammogo le batho le ditšhaba ka moka tše go ya ka setšo di amanago le mabitla a ba mengwa go kgatha tema mo morerong wo wa go šuthiša mabitla gomme ba swanetše go romela tshedimošo ya bona ya boitsebišo atreseng ye e filwego ka mo tlase.

Ge e le gore go na le ba ba lego kgahlanong le projeke ye ya go epolla le go boloka bahu ka lefša, ba swanetše go ngwalela:

Henk Steyn, Professional Grave Solutions (Pty) Ltd, PO Box 14706, Hatfield, 0028

Mogala: (012) 333 7142 **Fekse:** (012) 333 7243

Emelle: henk@grave.co.za

lebakeng la dibeke tše 6 morago ga go amogela tsebišo ye.

NOTICE:
**EXHUMATION AND REINTERMENT OF INDIVIDUALS BURIED IN
GRAVES**

**(25° 42' 54,2" S, 27° 26' 22,4"E) AFFECTED BY THE PROPOSED
DEVELOPMENT OF THE OPENCAST PITS OF LONMIN PLATINUM ON
PORTIONS OF THE FARM ROOIKOPPIES 297 JQ**

24 June 2004

Notice is hereby given that *Professional Grave Solutions (Pty) Ltd* acting as consultant for *Lonmin Platinum* intends applying in terms of The Removal of Graves and Dead Bodies Ordinance (Ord. No. 7 of 1925); The Exhumations Ordinance (Ord. No. 12 of 1980); and Section 35 and 36 of the National Heritage Resources Act (Act 25 of 1999) as well as the relevant local regulations to the North West Provincial Administration for approval to exhume the remains of the individuals affected by the above mentioned development for re-interment in local cemeteries.

All persons and communities descendant from the buried individuals as well as all persons and communities by tradition concerned with the graves are invited to partake in the process of relocation and must forward their contact particulars to the address listed below.

Any objections to the proposed exhumation and reinterment of the individuals must also be submitted to:

Henk Steyn, Professional Grave Solutions Pty Ltd, PO Box 14706, Hatfield, 0028

Tel no.: (012) 333 7142 **Fax:** (012) 333 7213

E-mail: henk@grave.co.za

within 6 weeks of the date of this notice.



Professional Grave Solutions

Pretoria Office:
P O Box 14 706
Hatfield, 0028
Tel: (012) 333-7142
Fax: (012) 333-7213
henk@grave.co.za

Krugerdsorp Office:
P O Box 431
Paardekraal, 1752
Tel: (011) 954-0560
Fax: (011) 954-3568
wouter@grave.co.za

26 July 2004

The Manager
SAHRA Northwest Office
PO Box 3054
Mmabato
2735

cc: Me M Leslie

Dear Sir / Madam,

RE: DISCOVERY OF GRAVES

Herewith we are reporting the discovery of previously unknown graves not located in a cemetery administered by a recognized local authority as required by Section 36(6) of Act 25 of 1999.

The 4 graves, affected by proposed mining activities are located on the boundary of portions of the farms Spruitfontein 341JQ and Rooikoppies 297 JQ, district Rustenburg, Northwest Province (see attached map). We intend to apply for permission to relocate these graves on behalf of Lonmin Platinum Limited, the owners of the property.

Would you please advise us on any heritage related issues pertaining to the graves? The discovery of the graves will also be reported to the SAPS at Mooimooi.

To clarify matters we have provisionally allocated the affected graves to the following categories:

Graves older than 100 years (Section 35 of Act 25 of 1999):	none
Graves older than 60 years (Section 36 of Act 25 of 1999):	4
Graves of victims of conflict (Section 36 of Act 25 of 1999):	none
Graves of individuals of royal descent (Section 36 of Act 25 of 1999):	none
Graves younger than 60 years (Ord 7 of 1925):	none
Unknown:	none

We are currently undertaking social consultations (as required by ACT 25 of 1999) to identify the unknown buried individuals and to obtain permission for exhumation and re-interment from affected families, communities and other *bona fide* interested and affected parties.

Detailed information on the graves as it becomes available can be obtained from the above address.

Yours sincerely,

H. Steyn
Project Manager

Pretoria Office:
P O Box 14706
Hatfield, 0028
Tel: (012) 333-7142
Fax: (012) 333-7213
henk@grave.co.za

Krugerdsorp Office:
P O Box 431
Paardekraal, 1752
Tel: (011) 954-0560
Fax: (011) 954-3568
wouter@grave.co.za

27 July 2004

The Station Commander
Moolinooi SAPS
Private Bag X1036
Moolinooi
0325

ATT: Inspector Marx

Dear Sir,

RE: DISCOVERY OF GRAVES

Herewith we are reporting the discovery of 4 previously unknown graves not located in a cemetery administered by a recognized local authority as required by Section 36(6) of Act 25 of 1999.

The 4 graves, affected by proposed mining activities are located on the boundary of portions of the farms Spruitfontein 341JQ and Rooikoppies 297 JQ, district Rustenburg, Northwest Province. We intend to apply for permission to relocate these graves on behalf of Lonmin Platinum Limited, the owners of the property.

Would you please advise us on whether any criminal or judicial issues are related to the graves. The discovery of the graves will also be reported to SAHRA Mpumalanga Province.

To clarify matters we have provisionally allocated the affected graves to the following categories:

Graves older than 100 years (Section 35 of Act 25 of 1999):	none
Graves older than 60 years (Section 36 of Act 25 of 1999):	4
Graves of victims of conflict (Section 36 of Act 25 of 1999):	none
Graves of individuals of royal descent (Section 36 of Act 25 of 1999):	none
Graves younger than 60 years (Ord 7 of 1925):	none
Unknown:	none

We are currently undertaking social consultations (as required by ACT 25 of 1999) to identify the unknown buried individuals and to obtain permission for exhumation and re-interment from affected families, communities and other *bona fide* interested and affected parties.

Detailed information on the graves as it becomes available can be obtained from the above address.

Please note that you will be informed of the date of exhumation at least one week in advance.

Yours sincerely,

H. Steyn
Project Manager

TAPA Council
P. O. Box 135
TAPA.
0287

TO WHOM IT MAY CONCERN
I REUBEN MANUAKA HEADMAN
OF TAPA VILLAGE I AM GIVING
PERMISSION TO MANUKEZI FAMILY TO
BURY THEIR DECEASED BONES IN OUR
VILLAGE TAPA.

Yours FAITHFULLY,
Reuben Manuaka,

TAPA ... COLINDIA
P.O. BOX 72
MARIKANA 0288

DATE	23/8/2004
SECRETARY	
HEADMAN	

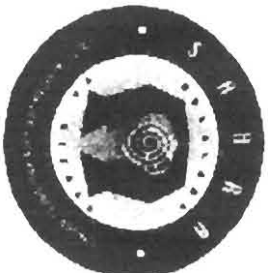

SOUTH AFRICAN HERITAGE RESOURCES AGENCY
111 HARRINGTON STREET, CAPE TOWN, 8000, PO BOX 4607, CAPE TOWN, 8000
TEL. (021) 462 4522 FAX. (021) 462 4599

9/2/263/3

PERMIT

No. 80/04/08/007/51

Issued under Section 36(3) of the National Heritage Resources Act, Act No. 25 of 1999. Permission is hereby given:

to: Dr W/C Nienaber in association with Mr H Steyn,
of: Professional Grave Solutions (Pty) Ltd, PO Box 14706, Hatfield, 0028,
for: exhumation and re-interment of graves that will be directly impacted by mining activities at Western Platinum mines near Marakana.
at: Rooikoppies, at approximately 27.439470E, 25.715085S,
on: the erf 2977/Q,
in: the Rustenburg District, North-West Province.

The following conditions apply:

1. If the permit holder is not to be present on the site at all times then SAHRA must be provided with the names and qualifications of the authorised representatives.
 2. Adequate recording methods as specified in the Regulations and Guidelines pertaining to the National Heritage Resources Act must be used. Note that the position of the grave must be marked on a plan of the site, and the site marked on a 1:50 000 map.
 3. A standard site record form must be lodged with the National Cultural History Museum.
 4. Human remains must at all times be handled with respect and graves should not be disturbed except where unavoidable. The consultation procedures as indicated in the gazetted regulations of the National Heritage Resources Act (Act No. 25 of 1999) must be observed as appropriate. The recommendations for removal of graves and exhumations and for re-burial made in SAHRA's Policy 'What to do when graves are uncovered', section 3, must be observed as far as possible.
 5. Field notes and records must be kept at the National Cultural History Museum.
 6. A report on the excavation must be submitted to SAHRA on or before 1 September 2005.
 7. Reprints of all published papers, or copies of theses or reports resulting from this work must be lodged with the relevant Provincial Heritage Resources Authority and SAHRA.
 8. If a published report has not appeared within three years of the lapsing of this permit, the report required in terms of the permit will be made available to researchers on request.
 9. It is the responsibility of the permit holder to obtain permission from the landowner for each visit, and conditions of access imposed by the landowner must be observed.
 10. It is the responsibility of the permit holder to fill in excavations and protect sites during and after excavation to the satisfaction of the SAHRA and the landowner.
 11. SAHRA shall not be liable for any losses, damages or injuries to persons or properties as a result of any activities in connection with this permit.
 12. SAHRA reserves the right to cancel this permit upon notice to the permit holder.
- This permit is valid until 1 September 2005.
SAHRA: ARCHAEOLOGY, PALEONTOLOGY & METEORITE UNIT.....

Date: 20 August 2004

Place: Cape Town

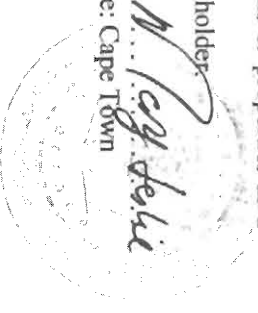



Professional Grave Solutions

Pretoria Office:
P O Box 14706
Hatfield, 0028
Tel: (012) 333-7142
Fax: (012) 333-7213
henk@grave.co.za

Krugersdorp Office:
P O Box 431
Paardekraal, 1752
Tel: (011) 954-0560
Fax: (011) 954-3568
wouter@grave.co.za

18 March 2004

The Station Commander
Moolinooi SAPS
Private Bag X1036
Moolinooi
0325

ATT: Inspector Marx

Dear Sir,

RE: RELOCATION OF GRAVES

Our correspondence to your office dated 27 July 2004 has reference.

Please take note that the exhumation of the 4 graves to be relocated from the property of Lonmin Platinum will take place on 23/08/2004. The mortal remains from these graves will be reburied in the Tlapa Cemetery on 24/08/2004.

The graves consist of 2 known and 2 unknown graves. The family of the 2 known graves will be present at the exhumation and reburial.

Yours sincerely,

H. Steyn
Project Manager