



# **COBUS DREYER**

**Pr. Archaeologist/Heritage Resource Specialist**

**P.O. Box 12910  
BRANDHOF 9324  
Bloemfontein  
dreyerj@telkomsa.net**

**Tel: 051-444 1187  
Fax: 051-444 4395  
Cell: 083 357 7982**

10 JULY 2006

## **FIRST PHASE ARCHAEOLOGICAL AND CULTURAL HERITAGE ASSESSMENT OF THE PROPOSED RESIDENTIAL DEVELOPMENTS AT CLIFTON 530, CLARENS, FREE STATE**

### **EXECUTIVE SUMMARY**

New residential developments are planned on the farm Clifton 530, Clarens, Free State.

Archaeological and cultural remains occurred in the form of Later Iron Age stone-walls and ash heaps with undecorated pottery.

I recommend that the planning of the residential area could proceed, but the area where the stone-walls occur should be avoided. In the case of the discovery of any cultural or human skeletal material, work should be stopped for investigation by the archaeologist.

### **INTRODUCTION AND DESCRIPTION**

#### **INVESTIGATION**

The site for the proposed new township developments at Clifton 530, Clarens, was visited on 3 March 2006. Dr Johan du Preez of MDA Environmental Consultants, Bloemfontein and Jako Viviers of LMV Environmental Specialists, Kroonstad, took me to the site. At the farm Mr Rob Martin and Mr Jaap Boonstra, Architect from Clarens, took us to the different sites.

The area was examined for possible archaeological and historical material and to establish the potential impact on any cultural material that might be found. The Heritage Impact Assessment (HIA) is done in terms of the National Heritage Resources Act (NHRA), (25 of 1999) and under the Environmental Conservation Act, (73 of 1989).

## LOCALITY

The farm Clifton 530 is located to the south of Clarens along R711 main road to Fouriesburg (Map 1).

Clifton 530 lies adjacent to Pietersdal 1207 and Letsoanastad 347 (Map 2).

The following GPS coordinates (Cape scale) were taken (2828AD) (Surveyor-General 1973):

|                  |   |
|------------------|---|
| Stands 1&2       | 28°33'09"S. 028°26'15"E Altitude 1774m (Fig.1). |
| Stone walls      | 28°33'10"S. 028°26'14"E Altitude 1778m (Fig.2). |
| Stone enclosures | 28°33'12"S. 028°26'17"E Altitude 1786m (Fig.5). |
| Stands 3&4       | 28°33'14"S. 028°26'20"E Altitude 1790m (Fig.3). |
| Stand 6 (kraal)  | 28°33'18"S. 028°26'22"E Altitude 1799m (Fig.4). |

Residential stands will be placed along the foot of the hill (Map 3).

## RESULTS

Late Iron Age stone-walls were found in the area of the proposed residential developments (Figs.1-5).

A stone-walled enclosure occurs on the specific locality of stand 6 (Fig.4).

The settlement pattern resembles the Type V layout, which consists of several relatively large stone enclosures with connecting walls to form a large single enclosure. Houses made out of perishable materials with their associated ash heaps were usually placed in a rough circle around the central cluster of enclosures (Maggs 1976).

## IMPACT ASSESSMENT

The proposed residential developments at Clifton 530 will have a serious effect on the Late Iron Age stone-walled structures and other cultural remains at the site.

## **RECOMMENDATIONS**

The development of the site should be allowed to proceed, but will have to be moved lower down the slope from the immediate area of the stone-walls. No planning of any developments should take place near the stone-walls.

It should be kept in mind that there is a strong possibility that archaeological finds in the form of stone-walls or ash heaps with potsherds could be found. In case of the discovery of any material, it should be considered that every archaeological site is unique and should be protected as an exceptional cultural entity. Special care should be taken during the construction process not to damage any archaeological feature. In the case of the discovery of archaeological material during building operations, the process should be stopped to inform the archaeologist.

People should also be discouraged to use any stones from the walls for building purposes.

## **MITIGATION**

Concerning the area for the proposed developments, firm mitigation measures will be required in the case of the developments near the stone-walls. In case of the discovery of stone-walls or cultural material such as potsherd or human skeletal material, control should be taken of the site for investigation by the archaeologist.

## **ACKNOWLEDGEMENTS**

I thank Dr Johan du Preez of MDA Environmental Consultants, Bloemfontein and Jako Viviers of LMV Environmental Specialists, Kroonstad, for taking me to the site.

**SELECT BIBLIOGRAPHY:**

DEACON, J. 1992. Archaeology for Planners, Developers and Local Authorities. Cape Town: National Monuments Council.

DREYER, J.J.B. 1992. The Iron Age Archaeology of Doornpoort, Winburg, Orange Free State. Navorsing van die Nasionale Museum, Bloemfontein, Vol.8(7):262-390.

DEYER, J. 1999. Historical Gazeteer for the Free State. Unpublished place name data base. Bloemfontein.

DREYER, J. 1996. Introduction to Free State Iron Age Archaeology. In: Guide to archaeological sites in the Free State and Lesotho. Southern African Association of Archaeologists (SA3), 14th Biennial Conference, Bloemfontein, Post-conference tour 5-8 July 1996. Bloemfontein: National Museum.

DREYER, J. 2000. Mountains and Rivers of the Free State - Manual for field research / Berge en Riviere van die Vrystaat – Handleiding vir veldnavorsing. Bloemfontein: University of the Free State, Department of Anthropology, Occasional Paper No. 2.

ELLENBERGER, D.F. 1912. History of the Basuto. London:Caxton Publishing Co.

HUMPHREYS, A.J.B. 1986. Searching for the past. Cape Town: David Philip.

MACGREGEOR, J.C. 1905. Basuto Traditions. Cape Town: UCT Library Reprint Series No. 12, 1957.

MAGGS, T.M. 1976. Iron Age Communities of the Southern Highveld. Pietermaritzburg: Natal Museum.

PISTORIUS, J.C.C. 1994. Eskom Archaeological Site Identification Guide. Johannesburg: Eskom.

SURVEYOR-GENERAL O.F.S. 1973. Index of Orange Free State Farms. Bloemfontein.

VAN RENSBURG, A.P.J. 1968. Golden Gate – Die geskiedenis van twee plase wat 'n Nasionale Park geword het. Koedoe 11:83-138.

## LIST OF ILLUSTRATIONS



Map 1 Locality of Clarens in relation to Fouriesburg, Bethlehem and Golden Gate.



Map 2 Locality of Clifton 530, south of Clarens (2828CB).

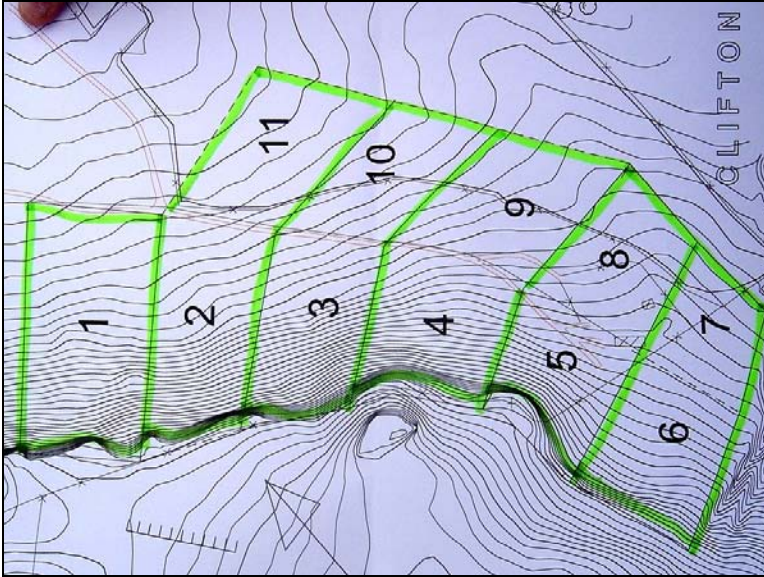

Map 3 Layout plan of the proposed residential developments at Clifton 530, Clarens.



Fig.1 View of the stone enclosure wall at Clifton 530, Clarens, facing south.



Fig.2 Base of a stone-wall at Clifton.



Fig.3 Ash heap near the stone-wall at Clifton.



Fig.4 Elliptical stone-walled structure.



Fig.5 More stone-walls at Clifton, Clarens.