



COBUS DREYER

Pr. Archaeologist/Heritage Specialist

**P.O. Box 12910
BRANDHOF 9324
Bloemfontein
dreyerj@telkomsa.net**

**Tel: 051-444 1187
Fax: 051-444 4395
Cell: 083 357 7982**

21 April 2006

FIRST PHASE ARCHAEOLOGICAL AND CULTURAL HERITAGE INVESTIGATION OF THE PROPOSED RESIDENTIAL DEVELOPMENTS AT LUCKHOFF, FREE STATE

INVESTIGATION

The site for the proposed housing development at Luckhoff was visited on 20 October 2005. Mr Piet de Bie from Phethogo Consulting, Bloemfontein, directed me to the site.

The site was examined for any possible traces of cultural and historical remains to establish the potential impact of the developments on any archaeological and cultural historical material. The significance of certain structures was examined and the possibility of archaeological remains was also investigated. The Heritage Impact Assessment (HIA) is done in terms of the National Heritage Resources Act (NHRA), (25 of 1999) and under the Environmental Conservation Act, (73 of 1989).

LOCALITY

The land for the proposed residential developments is located on the town lands to the west of Luckhoff (Map 1) and is bordered by the R48 road from Luckhoff to Koffiefontein and the S572 entrance road into Luckhoff (Map 2).

The land is grass covered with scattered shrubs and trees. It seems as if the soil had been disturbed in various ways including roads and electricity installations. Cattle posts are still visible in one part along the northern fence of the area.

The following GPS co-ordinates (Cape scale) were taken (Surveyor-General O.F.S. Bloemfontein.):

GWK Trade Centre 29°44'49"S 024°47'14"E Altitude 1265m (Fig.1).

Concrete slabs	29°44'33"S 024°47'16"E Altitude 1265m (Fig.4).
Brick-walled shed	29°44'34"S 024°47'19"E Altitude 1275m (Fig.5).
Cattle pens	29°44'32"S 024°47'21"E Altitude 1275m (Fig.6).
Northern corner	29°44'26"S 024°47'19"E Altitude 1271m.
Corner R48&S572	29°44'27"S 024°47'01"E Altitude 1265m (Fig.7).

FINDS

A variety of the remains of previous structures and activities such as a road camp (Fig.3), corrugated iron roofed shed (Fig.5), cattle pens (Fig.6) and a sand quarry (Fig.10) were found on the surface.

No remains of archaeological and any other material of cultural and historical importance could be found on the site.

DISCUSSION

The disturbances by previous activities and agricultural developments made it unlikely that any remains of early human occupation could have survived.

RECOMMENDATIONS

There is no obvious reason to delay the commencement of further planning and development of the site.

I recommend that the proposed developments may proceed.

MITIGATION

Concerning the area for the proposed development, no mitigation measures are needed.

ACKNOWLEDGEMENTS

Mr Piet de Bie from Phethogo Consulting, Bloefontein, gave directions to the site.

SELECT BIBLIOGRAPHY

DEACON, J. 1992. Archaeology for Planners, Developers and Local Authorities. Cape Town: National Monuments Council.

DREYER, J.J.B. 1992. The Iron Age Archaeology of Doornpoort, Winburg, Orange Free State. Navorsing van die Nasionale Museum, Bloemfontein, Vol.8(7):262-390.

DREYER, J. 1996. Introduction to Free State Iron Age Archaeology. In: Guide to archaeological sites in the Free State and Lesotho. Southern African Association of Archaeologists (SA3), 14th Biennial Conference, Bloemfontein, Post-conference tour 5-8 July 1996. Bloemfontein: National Museum.

DREYER, J. 2000. Mountains and Rivers of the Free State - Manual for field research / Berge en Riviere van die Vrystaat – Handleiding vir veldnavorsing. Bloemfontein: University of the Free State, Department of Anthropology, Occasional Paper No. 2.

HUMPHREYS, A.J.B. 1986. Searching for the past. Cape Town: David Philip.

MAGGS, T.M. 1976. Iron Age Communities of the Southern Highveld. Pietermaritzburg: Natal Museum.

PISTORIUS, J.C.C. 1994. Eskom Archaeological Site Identification Guide. Johannesburg: Eskom.

SURVEYOR-GENERAL O.F.S. 1973. Index of Orange Free State Farms. Bloemfontein.

LIST OF ILLUSTRATIONS:

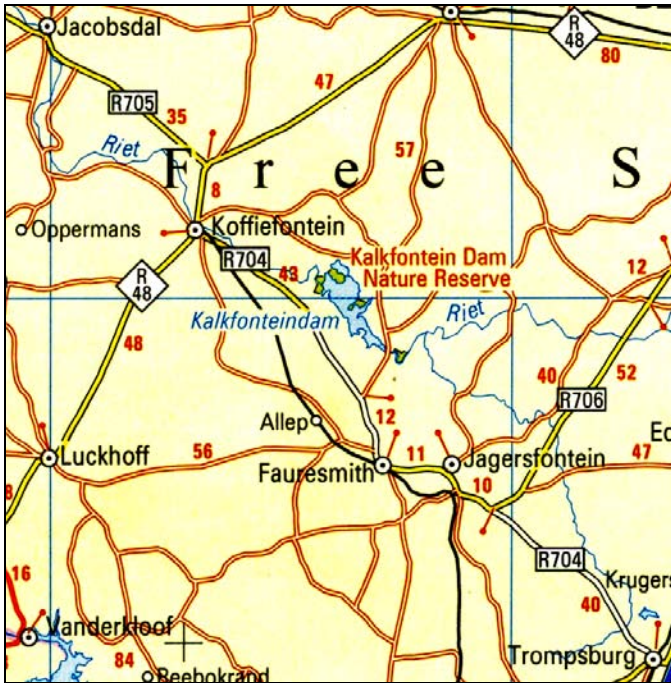

Map 1 Locality of Luckhoff in relation to Koffiefontein, Jacobsdal and Trompsburg.

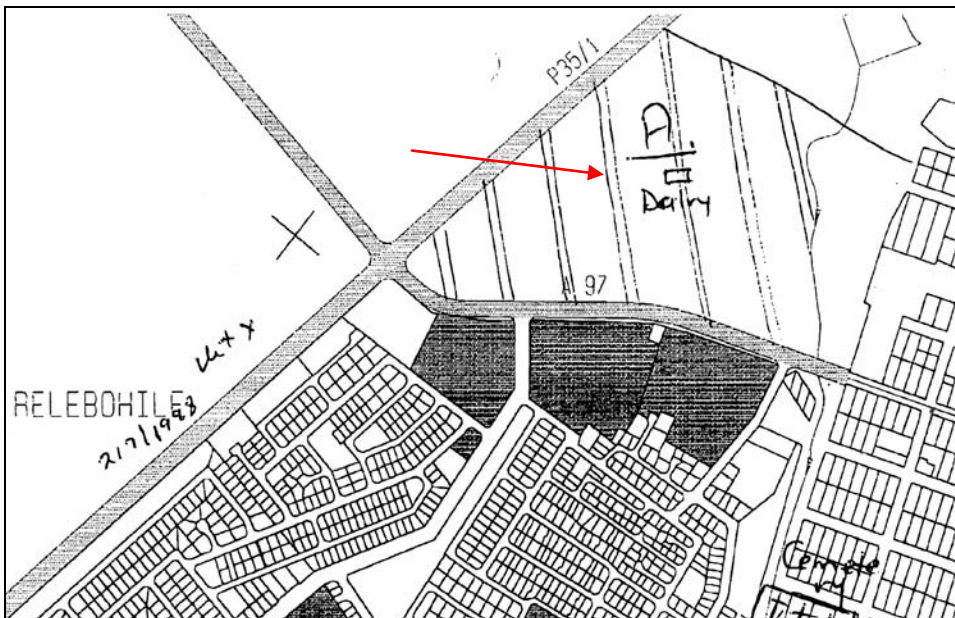

Map 2 Locality of the proposed developments indicated by A.



Fig.1 View of the GWK shopping centre on the outskirts of Luckhoff.



Fig.2 View along the S572 entrance road from the R48 main road facing west.



Fig.3 Remains of an old road camp.



Fig.4 Floors of former pre-fabricated housing at the old road camp.



Fig.5 Shed for unknown purpose in the proposed area.



Fig.6 Temporary cattle kraals in the area.



Fig.7 Crossing of the R48 & S572 outside Luckhoff forms the southern and western borders of the site.



Fig.8 General view of the vegetation at the site.



Fig.9 Red soil and calcrete from test pit.



Fig.10 Sand quarry in the area.