

Heritage impact survey report for the  
**PROPOSED DEVELOPMENT ON PORTIONS  
OF THE FARM ZANDSPRUIT 191IQ,  
KRUGERSDORP MAGISTERIAL DISTRICT,  
GAUTENG PROVINCE**

**THE PROJECT:**

Development of industrial properties.

**THIS REPORT:**

HERITAGE IMPACT SURVEY REPORT FOR THE PROPOSED DEVELOPMENT  
ON PORTIONS OF THE FARM ZANDSPRUIT 191IQ, KRUGERSDORP  
MAGISTERIAL DISTRICT, GAUTENG PROVINCE

**Report No:** 2008/JvS/093  
**Status:** Final  
**Revision No:** 0  
**Date:** October 2008

**Prepared for:**

HOLGATE, MEYER & Associates  
Representative: Ms. T Kneidinger

Postal Address: P O Box 641, Featherbrooke Estate, Mogale City, 1746  
Tel: (011) 662 2276  
E-mail: tanya@holgate.co.za

**Prepared by:**

J van Schalkwyk (D Litt et Phil), Heritage Consultant  
ASAPA Registration No.: 168  
Principal Investigator: Iron Age, Colonial Period, Industrial Heritage

Postal Address: 62 Coetzer Avenue, Monument Park, 0181  
Mobile: 076 790 6777  
Fax: 012 347 7270  
E-mail: jvschalkwyk@mweb.co.za

## **EXECUTIVE SUMMARY**

### **HERITAGE IMPACT SURVEY REPORT FOR THE PROPOSED DEVELOPMENT ON PORTIONS OF THE FARM ZANDSPRUIT 191IQ, KRUGERSDORP MAGISTERIAL DISTRICT, GAUTENG PROVINCE**

Industrial development is planned for various Portions of the farm Zandspruit 191IQ, located in the Mostyn Park Agricultural Holdings area of the Krugersdorp magisterial district. This development is to be known as Mostyn Park Extension 1.

The aim of the survey was to locate, identify, evaluate and document sites, objects and structures of cultural significance found within the area in which it is proposed to develop industrial sites.

Past activities on the property consisted of farming, with mining activities in adjacent areas. Currently the study area is vacant.

One site of cultural heritage significance was identified:

- An informal cemetery with approximately 15 graves. Although most graves look to be forgotten, a formal headstone was recently erected on one of the graves, indicating that it is still known and visited by descendants. The graves are therefore judged to have a high significance on a local level.

Therefore, based on what was found and its evaluation, it is recommended that development can continue in the area, on condition of acceptance of the following recommendations:

- The graves should be kept in place and the area should be formalised by fencing it off, with a gate to allow access to descendants. The vegetation should also be controlled annually.
- If construction takes place and archaeological sites are exposed, it should immediately be reported to a museum, preferably one at which an archaeologist is available, so that an investigation and evaluation of the finds can be made.

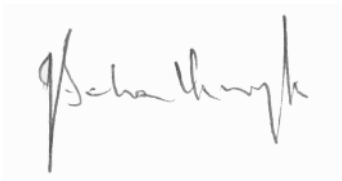

J A van Schalkwyk  
Heritage Consultant

**TECHNICAL SUMMARY**

<b>Property details</b>						
Province	Gauteng					
Magisterial district	Krugersdorp					
Topo-cadastral map	2627BB					
Closest town	Johannesburg					
Farm name & no.	Zandspruit 191IQ					
Portions/Holdings	Holding 14 & 15, Mosty Park A.H. and Portions 116 & 117 of Zandspruit 191IQ					
Coordinates	Polygon (approximate)					
	No	Latitude	Longitude	No	Latitude	Longitude
	1	S 26.00665	E 27.94320	5	S 26.01393	S 27.94673
	2	S 26.00618	E 27.94879	6	S 26.01460	E 27.94328
	3	S 26.01208	E 27.95117	7	S 26.01207	S 27.94344
	4	S 26.01301	E 27.94632	8	S 26.01829	E 27.94578

<b>Development criteria in terms of Section 38(1) of the NHR Act</b>	Yes/No
Construction of road, wall, power line, pipeline, canal or other linear form of development or barrier exceeding 300m in length	Yes
Construction of bridge or similar structure exceeding 50m in length	
Development exceeding 5000 sq m	Yes
Development involving three or more existing erven or subdivisions	
Development involving three or more erven or divisions that have been consolidated within past five years	
Rezoning of site exceeding 10 000 sq m	Yes
Any other development category, public open space, squares, parks, recreation grounds	

<b>Development</b>	
Description	Development of industrial properties
Project name	Mostyn Park Ext. 1

<b>Land use</b>	
Previous land use	Agriculture/Small holdings
Current land use	Small holdings/Industrial

<b>Heritage sites assessment</b>		
<i>Site type</i>	<i>Site significance</i>	<i>Site grading (Section 7 of NHRA)</i>
Informal cemetery	High on a local level	III
<b>Impact assessment</b>		
<i>Impact</i>	<i>Mitigation</i>	<i>Permits required</i>
Yes	Retain	None

**TABLE OF CONTENTS**

	Page
EXECUTIVE SUMMARY .....	II
TECHNICAL SUMMARY .....	III
TABLE OF CONTENTS .....	IV
LIST OF FIGURES.....	IV
GLOSSARY OF TERMS AND ABBREVIATIONS.....	V
1. INTRODUCTION.....	1
2. TERMS OF REFERENCE .....	1
3. DEFINITIONS AND ASSUMPTIONS .....	1
4. STUDY APPROACH AND METHODOLOGY .....	2
5. DESCRIPTION OF THE AFFECTED ENVIRONMENT .....	3
6. SITE SIGNIFICANCE AND ASSESSMENT .....	4
7. IDENTIFICATION OF RISK SOURCES .....	5
8. RECOMMENDED MANAGEMENT MEASURES.....	6
9. RECOMMENDATIONS.....	6
10. REFERENCES.....	8
APPENDIX 1: CONVENTIONS USED TO ASSESS THE IMPACT OF PROJECTS ON HERITAGE RESOURCES .....	9
APPENDIX 2. RELEVANT LEGISLATION .....	11
APPENDIX 3: SURVEY RESULTS .....	13
APPENDIX 4: ILLUSTRATIONS.....	15

**LIST OF FIGURES**

	Page
Fig. 1. Location of the study area (green polygon) in regional context .....	3
Fig. 3. The study area, outlined in green. ....	13
Fig. 4. Aerial photograph of the study area.....	15
Fig. 5. View of the site from the west. ....	16
Fig. 6. View of the site from the north. ....	16
Fig. 7. Area where the building rubble has been dumped. ....	<b>Error! Bookmark not defined.</b>

**GLOSSARY OF TERMS AND ABBREVIATIONS****STONE AGE**

Early Stone Age	2 000 000 - 150 000 Before Present (BP)
Middle Stone Age	150 000 - 30 000 BP
Late Stone Age	30 000 - until c. AD 200

**IRON AGE**

Early Iron Age	AD 200 - AD 900
Middle Iron Age	AD 900 - AD 1300
Late Iron Age	AD 1300 - AD 1830

**HISTORIC PERIOD**

Since the arrival of the white settlers - c. AD 1840 in this part of the country

ASAPA	Association of Southern African Professional Archaeologists
EIA	Early Iron Age
ESA	Early Stone Age
LIA	Late Iron Age
LSA	Late Stone Age
MSA	Middle Stone Age
NHRA	National Heritage Resources Act
PHRA	Provincial Heritage Resources Agency
SAHRA	South African Heritage Resources Agency

# HERITAGE IMPACT SURVEY REPORT FOR THE PROPOSED DEVELOPMENT ON PORTIONS OF THE FARM ZANDSPRUIT 191IQ, KRUGERSDORP MAGISTERIAL DISTRICT, GAUTENG PROVINCE

## 1. INTRODUCTION

Industrial development is planned for various Portions of the farm Zandspruit 191IQ, located in the Mostyn Park Agricultural Holdings area of the Krugersdorp magisterial district. This development is to be known as Mostyn Park Extension 1.

An independent heritage consultant was appointed by **Holgate, Meyer and Associates** to conduct a survey to locate, identify, evaluate and document sites, objects and structures of cultural importance found within the boundaries of the area where the proposed development is to take place.

This HIA report forms part of the Environmental Impact Assessment (EIA) as required by the EIA Regulations in terms of the National Environmental Management Act, 1998 (Act No. 107 of 1998) and was done in accordance with Section 38 of the National Heritage Resources Act, No. 25 of 1999 and is intended for submission to the South African Heritage Resources Agency (SAHRA).

## 2. TERMS OF REFERENCE

The scope of work consisted of conducting a Phase 1 archaeological survey of the site in accordance with the requirements of Section 38(3) of the National Heritage Resources Act (Act 25 of 1999).

This include:

- Conducting a desk-top investigation of the area
- A visit to the proposed development site

The objectives were to

- Identify possible archaeological, cultural and historic sites within the proposed development areas;
- Evaluate the potential impacts of construction, operation and maintenance of the proposed development on archaeological, cultural and historical resources;
- Recommend mitigation measures to ameliorate any negative impacts on areas of archaeological, cultural or historical importance.

## 3. DEFINITIONS AND ASSUMPTIONS

The following aspects have a direct bearing on the survey and the resulting report:

- *Cultural resources* are all non-physical and physical human-made occurrences, as well as natural occurrences that are associated with human activity. These include all

sites, structures and artefacts of importance, either individually or in groups, in the history, architecture and archaeology of human (cultural) development.

- The *significance* of the sites and artefacts are determined by means of their historical, social, aesthetic, technological and scientific value in relation to their uniqueness, condition of preservation and research potential. It must be kept in mind that the various aspects are not mutually exclusive, and that the evaluation of any site is done with reference to any number of these.
- Sites regarded as having low significance have already been recorded in full and require no further mitigation. Sites with medium to high significance require further mitigation.
- The latitude and longitude of archaeological sites are to be treated as sensitive information by the developer and should not unduly be disclosed to members of the public.

## 4. STUDY APPROACH AND METHODOLOGY

### 4.1 Extent of the Study

This survey and impact assessment covers the area as presented in Section 5 and as illustrated in Figure 1 - 3.

### 4.2 Methodology

#### 4.2.1 Preliminary investigation

##### 4.2.1.1 Survey of the literature

A survey of the relevant literature was conducted with the aim of reviewing the previous research done and determining the potential of the area. In this regard, various anthropological, archaeological and historical sources were consulted - see the list of references below.

##### 4.2.1.2 Data bases

The *Heritage Atlas Database*, the *Environmental Potential Atlas* and the *National Archives of South Africa* were consulted.

A number of documents relating to the farm Zandspruit 91 (old number) were traced in the National Archives of South Africa. One seems to be of interest, i.e. a Crown Grant was issued in 1934 to a PJ Bosman in respect of certain Portions of the farm Zandspruit 91 (old number), but it does not state why this happened.

##### 4.2.1.3 Other sources

Aerial photographs and topocadastral and other maps were also studied - see the list of references below.

#### 4.2.2 Field survey

The field survey was done according to generally accepted archaeological practices, and was aimed at locating all possible sites, objects and structures. The area that had to be investigated, was identified by members of **Holgate, Meyer And Associates** by means of maps. The area was investigated by walking across it in a number of transects. Special



attention was given to topographical occurrences such as trenches, holes, outcrops and clusters of trees were investigated.

#### 4.2.3 Documentation

All sites, objects and structures that are identified are documented according to the general minimum standards accepted by the archaeological profession. Coordinates of individual localities are determined by means of the *Global Positioning System (GPS)*<sup>1</sup> and plotted on a map. This information is added to the description in order to facilitate the identification of each locality.

Map datum used: Hartebeeshoek 94 (WGS84).

#### 4.3 Limitations

None at present.

### 5. DESCRIPTION OF THE AFFECTED ENVIRONMENT

#### 5.1 Site location

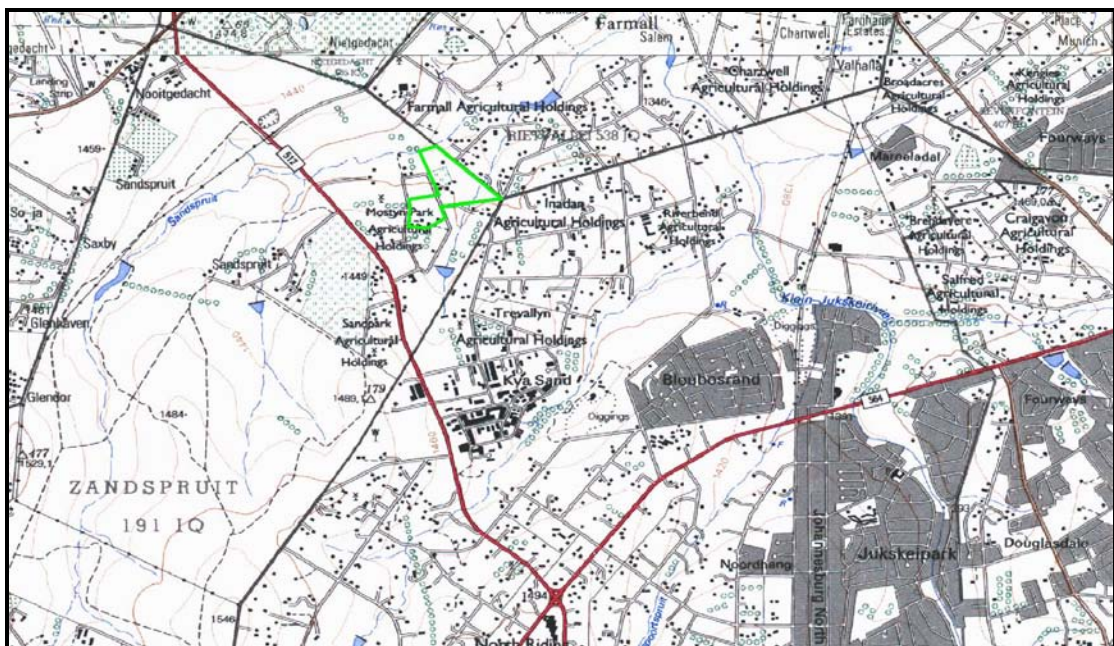

Fig. 1. Location of the study area (green polygon) in regional context.

(Map 2627BB: Chief Directorate Survey and Mapping.)

<sup>1</sup> According to the manufacturer a certain deviation may be expected for each reading. Care was, however, taken to obtain as accurate a reading as possible, and then to correlate it with reference to the physical environment before plotting it on the map.

The study area is Holding 14 & 15, Mosty Park A.H. and Portions 116 & 117 of Zandspruit 1911Q in the Krugersdorp magisterial district. For more detail, please see the Technical Summary presented above.

## 5.2 Site description

The geology of the area is made up of granite. The original vegetation is classified as Rocky Highveld Grassland, but has been replaced due to farming activities and urbanisation. The Sandspruit forms the northern border of the property. A smaller stream, known as the Farmall Spuit, crosses the study area. Apart from this no features (e.g. hills, outcrops or rock shelters) that usually drew people to settle in its vicinity, occurs in the study area.

## 5.3 Regional overview

The study area falls within that zone usually located on the front edge of urban-sprawl where the land previously used for agricultural use have become subdivided into small holdings. What may used to be a large single agricultural unit or farm now consists of tens of small properties. These units do not have their economic base in traditional agriculture but are sustained by a variety of land uses and economic activities with strong urban associations. This phenomenon happened in the past thirty years. Therefore most of the built fabric, date from this period. The result was that any historic farmsteads older than 60 years that may have existed, have either disappeared or have been 'upgraded'.

## 5.4 Identified sites

### 5.4.1 Stone Age

No sites, features or objects of cultural significance dating to the Stone Age were identified in the study area.

### 5.4.2 Iron Age

No sites, features or objects of cultural significance dating to the Iron Age were identified in the study area.

### 5.4.3 Historic period

A small informal cemetery with approximately 15 graves was identified close to the southern boundary of the study area.

## 6. SITE SIGNIFICANCE AND ASSESSMENT

### 6.1 Statement of significance

According to the NHR Act, Section 2(vi), the **significance** of heritage sites and artefacts is determined by its aesthetic, architectural, historical, scientific, social, spiritual, linguistic or technical value in relation to the uniqueness, condition of preservation and research potential. It must be kept in mind that the various aspects are not mutually exclusive, and that the evaluation of any site is done with reference to any number of these.

Sites regarded as having low significance are viewed as been recorded in full after identification and would require no further mitigation. Sites with a medium to high significance would require mitigation. Mitigation, in most cases the excavation of a site, is in essence destructive and therefore the impact can be viewed as high and as permanent.

One site of cultural heritage significance was identified (see Appendix 3):

- **An informal cemetery with approximately 15 graves. Although most graves look to be forgotten, a formal headstone was recently erected on one of the graves, indicating that it is still known and visited by descendants. The graves are therefore judged to have a high significance on a local level.**

In terms of Section 7 of the NHR Act, No. 25 of 1999, these features are viewed to have a Grade III significance.

## 6.2 Impact assessment

Impact analysis of cultural heritage resources under threat of the proposed development, are based on the present understanding of the development.

- As the identified site (graves), is located close to the southern border of the proposed development, it would be easy to retain it in place and isolated it from the proposed development.

## 7. IDENTIFICATION OF RISK SOURCES

A Heritage Impact Assessment is focused on two phases of a proposed development: **the construction** and **operation phases**. The following project actions may impact negatively on archaeological sites and other features of cultural importance. The actions are most likely to occur during the construction phase of a project.

### Construction phase:

Possible Risks	Source of the risk
Actually identified risks	
- damage to sites	Construction work
Anticipated risks	
- looting of sites	Curious workers

### Operation phase:

Possible Risks	Source of the risk
Actually identified risks	
- damage to sites	Not keeping to management plans
Anticipated risks	
- damage to sites	Unscheduled construction/developments
- looting of sites	Visitors removing objects as keepsakes

## 8. RECOMMENDED MANAGEMENT MEASURES

Heritage sites are fixed features in the environment, occurring within specific spatial confines. Any impact upon them is permanent and non-reversible. Those resources that cannot be avoided and that are directly impacted by the development can be excavated/recorded and a management plan can be developed for future action. Those sites that are not impacted on can be written into the management plan, whence they can be avoided or cared for in the future.

### 8.1 Objectives

- Protection of archaeological, historical and any other site or land considered being of cultural value within the project boundary against vandalism, destruction and theft.
- The preservation and appropriate management of new discoveries in accordance with the National Heritage Resources Act (Act No. 25 of 1999), should these be discovered during construction.

#### 8.2.1 Construction phase

General management objectives and commitments:

- To avoid disturbing sites of heritage importance; and
- To avoid disturbing burial sites.

The following shall apply:

- Known sites should be clearly marked in order that they can be avoided during construction activities.
- The contractors and workers should be notified that archaeological sites might be exposed during the construction work.
- Should any heritage artefacts be exposed during excavation, work on the area where the artefacts were discovered, shall cease immediately and the Environmental Control Officer shall be notified as soon as possible;
- All discoveries shall be reported immediately to a museum, preferably one at which an archaeologist is available, so that an investigation and evaluation of the finds can be made. Acting upon advice from these specialists, the Environmental Control Officer will advise the necessary actions to be taken;
- Under no circumstances shall any artefacts be removed, destroyed or interfered with by anyone on the site; and
- Contractors and workers shall be advised of the penalties associated with the unlawful removal of cultural, historical, archaeological or palaeontological artefacts, as set out in the National Heritage Resources Act (Act No. 25 of 1999), Section 51. (1).

## 9. RECOMMENDATIONS

The aim of the survey was to locate, identify, evaluate and document sites, objects and structures of cultural significance found within the area in which it is proposed to develop industrial sites.

Past activities on the property consisted of farming, with mining activities in adjacent areas. Currently the study area is vacant.

One site of cultural heritage significance was identified:

- An informal cemetery with approximately 15 graves. Although most graves look to be forgotten, a formal headstone was recently erected on one of the graves, indicating that it is still known and visited by descendants. The graves are therefore judged to have a high significance on a local level.

Therefore, based on what was found and its evaluation, it is recommended that development can continue in the area, on condition of acceptance of the following recommendations:

- The graves should be kept in place and the area should be formalised by fencing it off, with a gate to allow access to descendants. The vegetation should also be controlled annually.
- If construction takes place and archaeological sites are exposed, it should immediately be reported to a museum, preferably one at which an archaeologist is available, so that an investigation and evaluation of the finds can be made.

## 10. REFERENCES

### 10.1 Data bases

Chief Surveyor General

Environmental Potential Atlas, Department of Environmental Affairs and Tourism.

Heritage Atlas Database, Pretoria.

National Archives of South Africa

### 10.2 Literature

Acocks, J.P.H. 1975. *Veld Types of South Africa*. Memoirs of the Botanical Survey of South Africa, No. 40. Pretoria: Botanical Research Institute.

Van Schalkwyk, J.A. 2005. *Heritage impact assessment: Zandspruit extension 30 development*. Unpublished report 2005KH120. Pretoria: National Cultural History Museum.

### 10.3 Maps

1: 50 000 Topocadastral maps – 2627BB

### 10.4 Archival records

SAB, URU, 1416, 607, 1934

## APPENDIX 1: CONVENTIONS USED TO ASSESS THE IMPACT OF PROJECTS ON HERITAGE RESOURCES

### Significance

According to the NHRA, Section 2(vi) the **significance** of a heritage sites and artefacts is determined by it aesthetic, architectural, historical, scientific, social, spiritual, linguistic or technical value in relation to the uniqueness, condition of preservation and research potential. It must be kept in mind that the various aspects are not mutually exclusive, and that the evaluation of any site is done with reference to any number of these.

Matrix used for assessing the significance of each identified site/feature

<b>1. Historic value</b>				
Is it important in the community, or pattern of history				
Does it have strong or special association with the life or work of a person, group or organisation of importance in history				
Does it have significance relating to the history of slavery				
<b>2. Aesthetic value</b>				
It is important in exhibiting particular aesthetic characteristics valued by a community or cultural group				
<b>3. Scientific value</b>				
Does it have potential to yield information that will contribute to an understanding of natural or cultural heritage				
Is it important in demonstrating a high degree of creative or technical achievement at a particular period				
<b>4. Social value</b>				
Does it have strong or special association with a particular community or cultural group for social, cultural or spiritual reasons				
<b>5. Rarity</b>				
Does it possess uncommon, rare or endangered aspects of natural or cultural heritage				
<b>6. Representivity</b>				
Is it important in demonstrating the principal characteristics of a particular class of natural or cultural places or objects				
Importance in demonstrating the principal characteristics of a range of landscapes or environments, the attributes of which identify it as being characteristic of its class				
Importance in demonstrating the principal characteristics of human activities (including way of life, philosophy, custom, process, land-use, function, design or technique) in the environment of the nation, province, region or locality.				
<b>7. Sphere of Significance</b>		High	Medium	Low
International				
National				
Provincial				
Regional				
Local				
Specific community				
<b>8. Significance rating of feature</b>				
1.	Low			
2.	Medium			
3.	High			

**Significance of impact:**

- low where the impact will not have an influence on or require to be significantly accommodated in the project design
- medium where the impact could have an influence which will require modification of the project design or alternative mitigation
- high where it would have a “no-go” implication on the project regardless of any mitigation

**Certainty of prediction:**

- Definite: More than 90% sure of a particular fact. Substantial supportive data to verify assessment
- Probable: More than 70% sure of a particular fact, or of the likelihood of that impact occurring
- Possible: Only more than 40% sure of a particular fact, or of the likelihood of an impact occurring
- Unsure: Less than 40% sure of a particular fact, or the likelihood of an impact occurring

**Recommended management action:**

For each impact, the recommended practically attainable mitigation actions which would result in a measurable reduction of the impact, must be identified. This is expressed according to the following:

- 1 = no further investigation/action necessary
- 2 = controlled sampling and/or mapping of the site necessary
- 3 = preserve site if possible, otherwise extensive salvage excavation and/or mapping necessary
- 4 = preserve site at all costs

**Legal requirements:**

Identify and list the specific legislation and permit requirements which potentially could be infringed upon by the proposed project, if mitigation is necessary.



## APPENDIX 2. RELEVANT LEGISLATION

All archaeological and palaeontological sites, and meteorites are protected by the National Heritage Resources Act (Act no 25 of 1999) as stated in Section 35:

(1) Subject to the provisions of section 8, the protection of archaeological and palaeontological sites and material and meteorites is the responsibility of a provincial heritage resources authority: Provided that the protection of any wreck in the territorial waters and the maritime cultural zone shall be the responsibility of SAHRA.

(2) Subject to the provisions of subsection (8)(a), all archaeological objects, palaeontological material and meteorites are the property of the State. The responsible heritage authority must, on behalf of the State, at its discretion ensure that such objects are lodged with a museum or other public institution that has a collection policy acceptable to the heritage resources authority and may in so doing establish such terms and conditions as it sees fit for the conservation of such objects.

(3) Any person who discovers archaeological or palaeontological objects or material or a meteorite in the course of development or agricultural activity must immediately report the find to the responsible heritage resources authority, or to the nearest local authority offices or museum, which must immediately notify such heritage resources authority.

(4) No person may, without a permit issued by the responsible heritage resources authority-

(a) destroy, damage, excavate, alter, deface or otherwise disturb any archaeological or palaeontological site or any meteorite;

(b) destroy, damage, excavate, remove from its original position, collect or own any archaeological or palaeontological material or object or any meteorite;

(c) trade in, sell for private gain, export or attempt to export from the Republic any category of archaeological or palaeontological material or object, or any meteorite; or

(d) bring onto or use at an archaeological or palaeontological site any excavation equipment or any equipment which assist in the detection or recovery of metals or archaeological and palaeontological material or objects, or use such equipment for the recovery of meteorites.

In terms of cemeteries and graves the following (Section 36):

(1) Where it is not the responsibility of any other authority, SAHRA must conserve and generally care for burial grounds and graves protected in terms of this section, and it may make such arrangements for their conservation as it sees fit.

(2) SAHRA must identify and record the graves of victims of conflict and any other graves which it deems to be of cultural significance and may erect memorials associated with the grave referred to in subsection (1), and must maintain such memorials.

(3) No person may, without a permit issued by SAHRA or a provincial heritage resources authority-

(a) destroy, damage, alter, exhume or remove from its original position or otherwise disturb the grave of a victim of conflict, or any burial ground or part thereof which contains such graves;

(b) destroy, damage, alter, exhume, remove from its original position or otherwise disturb any grave or burial ground older than 60 years which is situated outside a formal cemetery administered by a local authority; or

(c) bring onto or use at a burial ground or grave referred to in paragraph (a) or (b) any excavation equipment, or any equipment which assists in the detection or recovery of metals.

(4) SAHRA or a provincial heritage resources authority may not issue a permit for the destruction or damage of any burial ground or grave referred to in subsection (3)(a) unless it is satisfied that the applicant has made satisfactory arrangements for the exhumation and re-interment of the contents of such graves, at the cost of the applicant and in accordance with any regulations made by the responsible heritage resources authority.

The National Heritage Resources Act (Act no 25 of 1999) stipulates the assessment criteria and grading of archaeological sites. The following categories are distinguished in Section 7 of the Act:

- **Grade I:** Heritage resources with qualities so exceptional that they are of special national significance;
- **Grade II:** Heritage resources which, although forming part of the national estate, can be considered to have special qualities which make them significant within the context of a province or a region; and
- **Grade III:** Other heritage resources worthy of conservation, and which prescribes heritage resources assessment criteria, consistent with the criteria set out in section 3(3), which must be used by a heritage resources authority or a local authority to assess the intrinsic, comparative and contextual significance of a heritage resource and the relative benefits and costs of its protection, so that the appropriate level of grading of the resource and the consequent responsibility for its management may be allocated in terms of section 8.

Presenting archaeological sites as part of tourism attraction requires, in terms 44 of the Act, a Conservation Management Plan as well as a permit from SAHRA.

(1) Heritage resources authorities and local authorities must, wherever appropriate, co-ordinate and promote the presentation and use of places of cultural significance and heritage resources which form part of the national estate and for which they are responsible in terms of section 5 for public enjoyment, education, research and tourism, including-

- (a) the erection of explanatory plaques and interpretive facilities, including interpretive centres and visitor facilities;
- (b) the training and provision of guides;
- (c) the mounting of exhibitions;
- (d) the erection of memorials; and
- (e) any other means necessary for the effective presentation of the national estate.

(2) Where a heritage resource which is formally protected in terms of Part I of this Chapter is to be presented, the person wishing to undertake such presentation must, at least 60 days prior to the institution of interpretive measures or manufacture of associated material, consult with the heritage resources authority which is responsible for the protection of such heritage resource regarding the contents of interpretive material or programmes.

(3) A person may only erect a plaque or other permanent display or structure associated with such presentation in the vicinity of a place protected in terms of this Act in consultation with the heritage resources authority responsible for the protection of the place.

### APPENDIX 3: SURVEY RESULTS

See Appendix 1 for an explanation of the conventions used in assessing the cultural remains.

Map datum used: Hartebeeshoek 94 (WGS84).

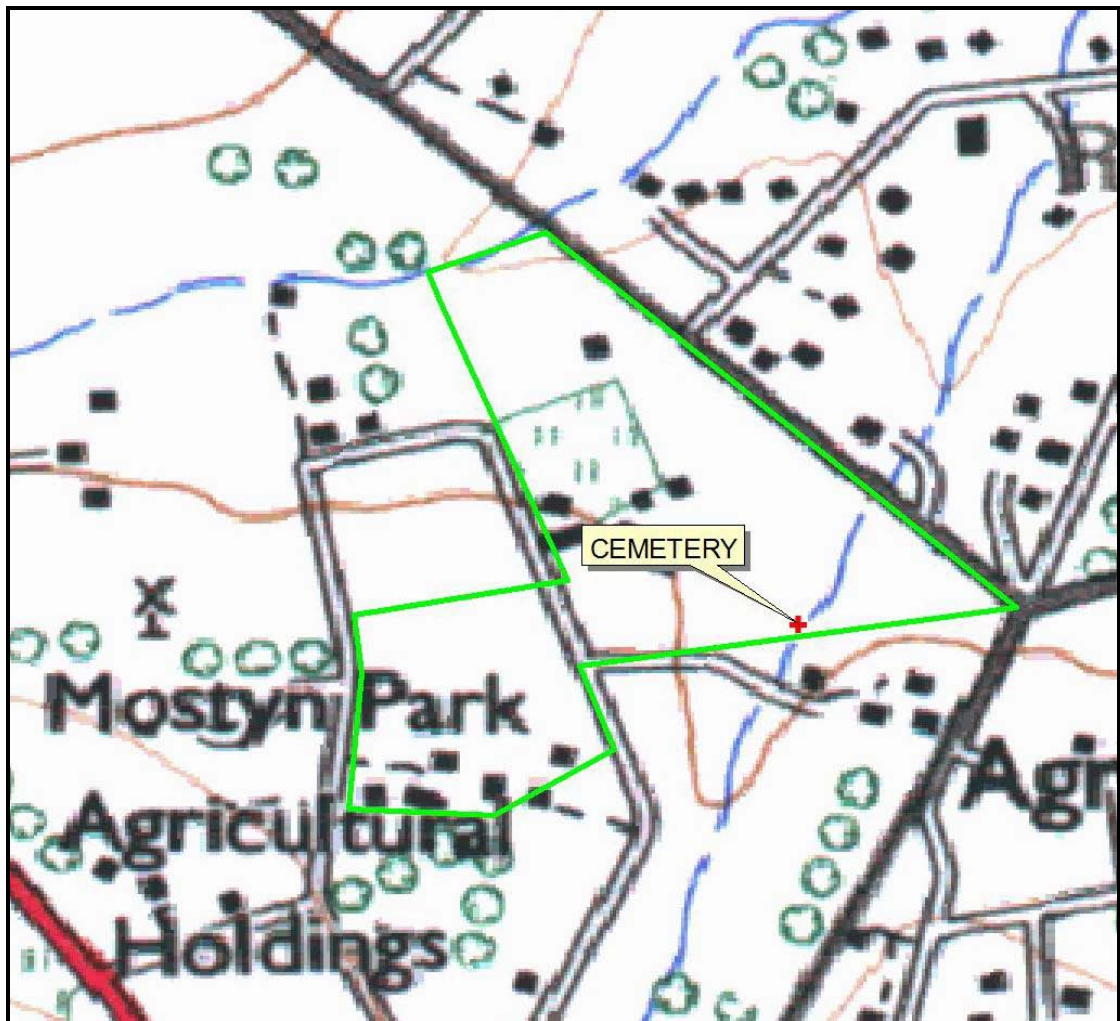

Fig. 2. The study area, outlined in green.

(Map 2627BB: Chief Directorate Survey and Mapping.)

1. Location: Zandspruit 1911Q – S 26.01225, E 27.94863

Description: Approximately 15 graves marked with stone. Only one has a formal headstone with inscription: John Leornard (sic) Banda: 1924-1988. Although most of the graves seem to be forgotten, the headstone was erected in recent times, indicating that there are still people visiting the site.

Discussion: As the identified site is close to the border of the proposed development area, it would be easy to retain it in place by isolating it.

Evaluation of significance: High on a local level

Significance of impact: High

Certainty of prediction: Probable

Recommended management action: 5 = retain/relocate graves

Legal requirements: Consultation, notification, permits from police, Dept of Health SAHRA



Fig. 3. The graves in the informal cemetery.

APPENDIX 4: ILLUSTRATIONS



Fig. 4. Aerial photograph of the study area.  
(Photo: Courtesy of Google Earth.)



Fig. 5. View of the site from the east.



Fig. 6. View of the site from the south.