



COBUS DREYER

Pr. Archaeologist/Heritage Specialist

**P.O. Box 12910
Brandhof
9324
dreyerj@telkomsa.net**

**Tel: 051-444 1187
Fax: 051-444 4395
Cell: 083 357 7982**

28 JUNE 2007

**FIRST PHASE ARCHAEOLOGICAL AND CULTURAL HERITAGE
ASSESSMENT OF THE PROPOSED NEW PRISON AT PARYS,
FREE STATE**

EXECUTIVE SUMMARY

A new penal complex is planned adjacent to the old prison at Parys, Free State.

The area proposed for development consists of vegetable gardens and grazing fields on the outskirts of town.

No graves or other historical or cultural remains could be found on the surface.

I recommend that the planning and development of the proposed new prison complex may proceed.

The old prison building dates back for more than one hundred years and it will probably be developed into a museum.

Concerning the old prison building I recommend that a permit should be obtained from the Free State Provincial Heritage Resources Agency (PHRA) and that the Free State Branch of the South African Heritage Resources Agency (SAHRA) in Bloemfontein, should also be involved before any renovations and alterations will be done to the old building.

INTRODUCTION AND DESCRIPTION

INVESTIGATION

The site for the proposed new prison at Parys was visited on 26 June 2007. The area was investigated on foot, GPS coordinates were taken on the peripheral points, and the features were recorded on camera. The different measuring points are the results of my own allocation.

The area was examined for possible archaeological and historical material and to establish the potential impact on any cultural material that might be found. The Heritage Impact Assessment (HIA) is done in terms of the National Heritage Resources Act (NHRA), (25 of 1999) and under the Environmental Conservation Act, (73 of 1989).

LOCALITY

The proposed new prison complex is planned on the outskirts of the town to the east of the existing prison (Map 2) (Map 1).

The following GPS coordinates (Cape scale) were taken (2627CD):

A (Bore hole)	26°54'03"S 027°28'07"E Altitude 1403m (Fig.1).
B (Reservoir)	26°54'01"S 027°28'08"E Altitude 1405m (Fig.2).
C	26°54'00"S 027°28'08"E Altitude 1413m (Figs.3&4).
D	(Figs.5&6).
E	26°53'58"S 027°28'17"E Altitude 1415m (Figs.7&8).
F	26°54'02"S 027°28'19"E Altitude 1420m (Figs.9&10).
G	26°54'05"S 027°28'15"E Altitude 1414m (Figs.11&12).
H	26°54'08"S 027°28'10"E Altitude 1409m (Figs.13&14).

HISTORY OF THE OLD PRISON, PARYS

I could not find anything in writing about the history of the old prison. However, during a telephonic conversation with Mr Tienie van Rensburg, the prison commander, and with Mr André Ludwick, caretaker of the Parys Municipal Museum, I was able to learn a number of basic facts.

The middle part of the old prison building (Figs.15&16) dates from 1896 and is older than a hundred years. It also seems that the central part was later enclosed by a stone-wall, which had been built-up with the addition of a brick wall and covered in places by a corrugated roof.

FINDS

No graves or any other cultural or historical material were found in the area of development.

The old water irrigation furrow could date from earlier times, but will not be affected by the present developments.

ASSESSMENT OF IMPACT

The proposed developments will have no impact on any cultural and historical heritage remains at the Old Prison in Parys.

RECOMMENDATIONS

I recommend that the planning of the proposed developments at the prison at Parys could proceed.

I further recommend that the history and significance of the Old Prison at Parys should be investigated and that this should be taken into consideration during the restoration and renovation of the building.

MITIGATION

Concerning the area for the proposed developments, no mitigation measures will be required.

There are no obvious reasons to delay the commencement of further planning and development of the site.

I recommend that the proposed developments may proceed.

ACKNOWLEDGEMENTS

I thank Erika van der Westhuizen from Spatial Solutions Incorporated Environmental Consultants, Bloemfontein, for involving me in the project. I also owe gratitude to Tienie van Rensburg and Ig Ferreira of the Department of Correctional Services at Parys, for the supply of information and for showing me the site. Likewise, I thank André Ludwick of the Parys Museum for information on the history of the Old Prison.

SELECT BIBLIOGRAPHY:

DEACON, J. 1992. Archaeology for Planners, Developers and Local Authorities. Cape Town: National Monuments Council.

HUMPHREYS, A.J.B. 1986. Searching for the past. Cape Town: David Philip.

MAGGS, T.M. 1976. Iron Age Communities of the Southern Highveld. Pietermaritzburg: Natal Museum.

PISTORIUS, J.C.C. 1994. Eskom Archaeological Site Identification Guide. Johannesburg: Eskom.

LIST OF ILLUSTRATIONS

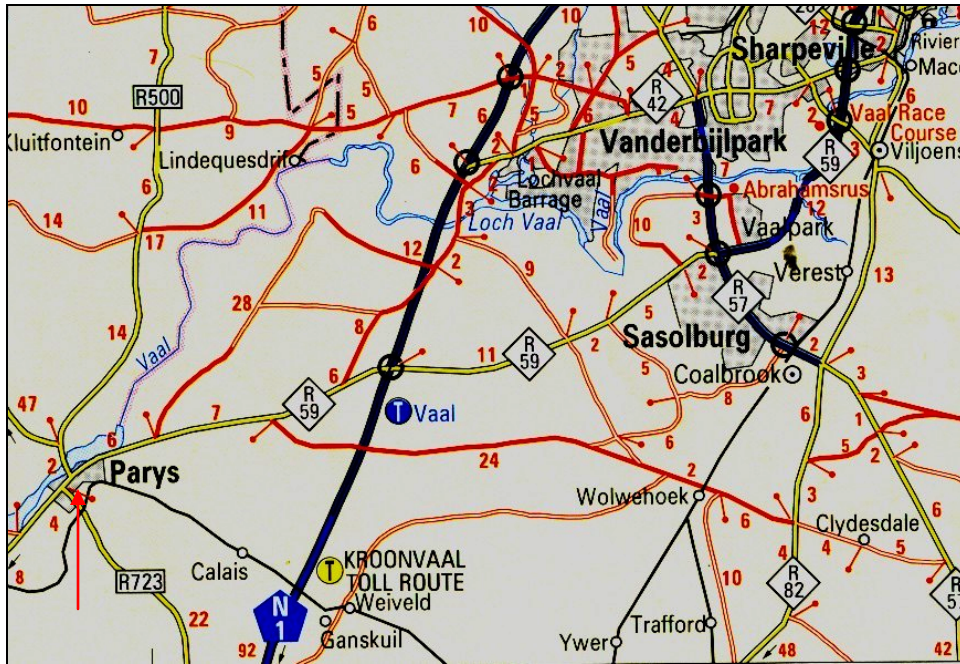

Map 1 Locality of Parys in relation to other town in the Vaal Triangle.

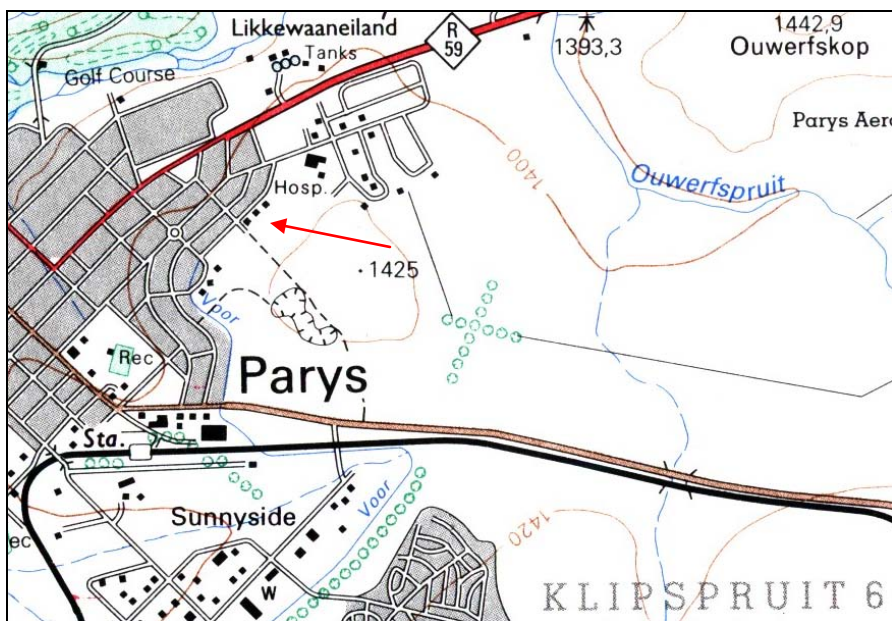

Map 2 Locality of the proposed new prison development on the outskirts of Parys.

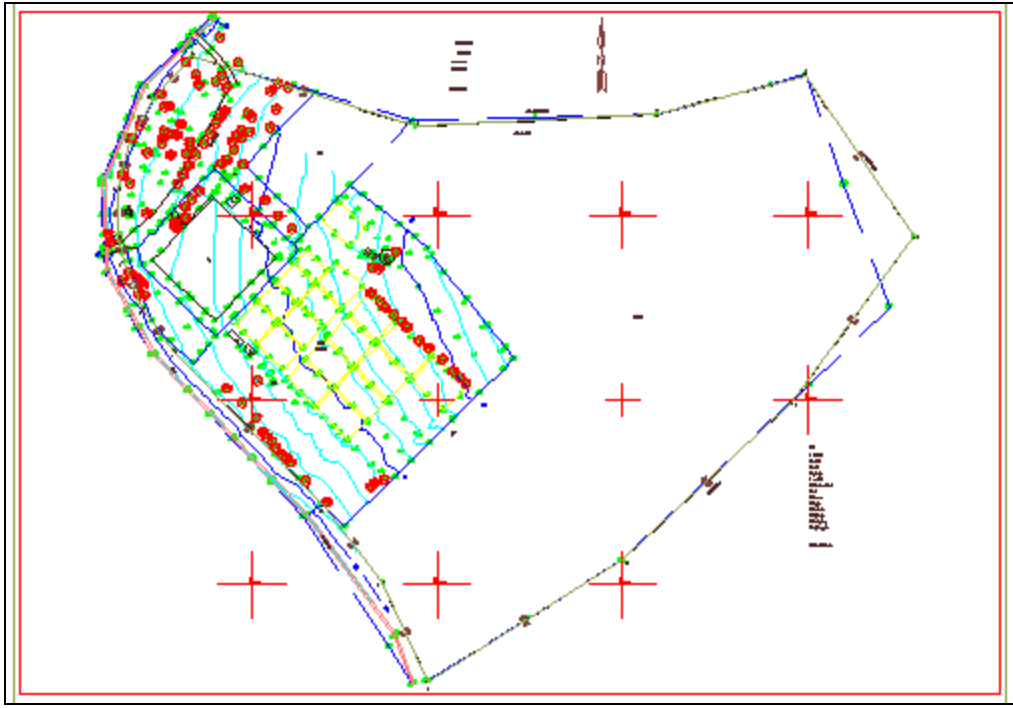

Map 3 Plan of the existing prison site with land for the proposed extensions to the east.

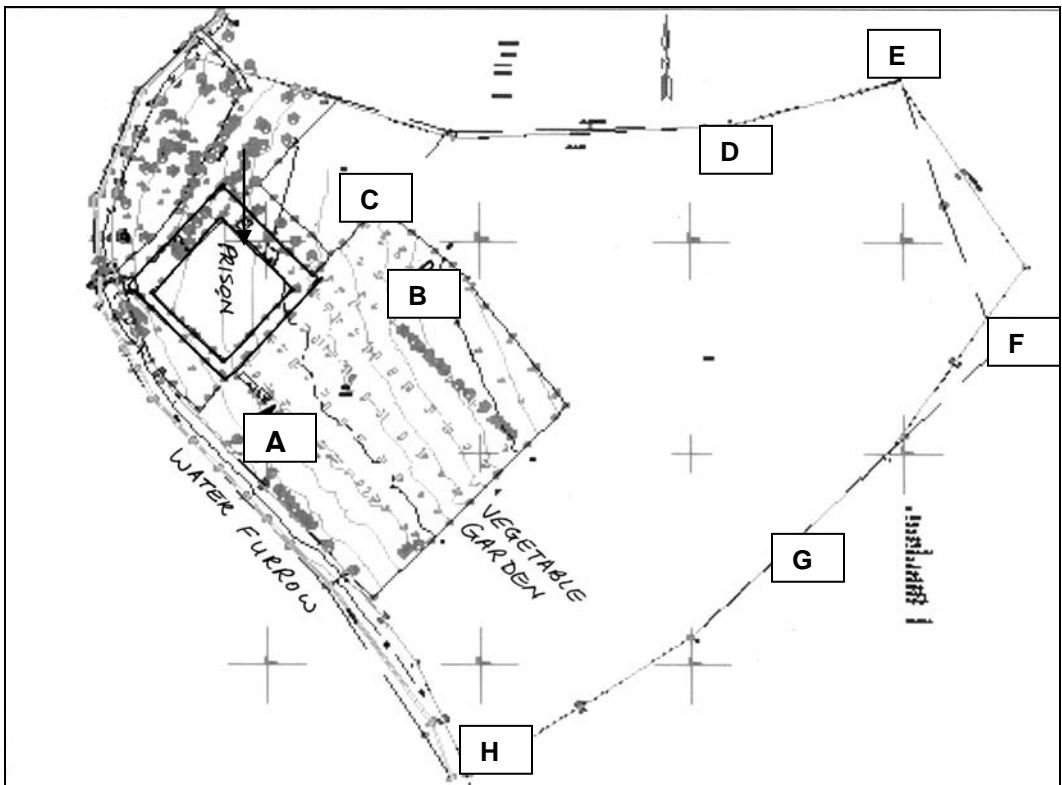

Map 4 Locality of the GPS coordinate points. New prison, Parys.



Fig.1 View from the bore hole at Point A facing across the vegetable garden.



Fig.2 Point B facing east towards the water supply tower and the second bore hole.



Fig.3 Point C facing south towards the old prison.



Fig.4 Point C facing north.



Fig.5 Point D facing south towards the old prison.



Fig.6 Point D facing north.



Fig.7 Point E facing east.



Fig.8 Point E facing south.



Fig.9 Point F facing south.



Fig.10 Point F showing damage to the soils surface.



Fig.11 Point G.



Fig.12 Point G facing west towards the old prison.



Fig.13 Point H facing the residential area located to the south of the prison.



Fig.14 View from Point H facing north.



Fig.15 Rear end (eastern view) of the old prison.



Fig.16 Front (west) view of the old prison.



Fig.17 A concrete irrigation furrow runs along the southern border of the old prison.