



wits enterprise

**Wits Commercial Enterprise
(Pty) Limited**

(Registration No: 2002/008461/07)
5th floor, Senate House, Jorissen Street,
2001 Braamfontein
Private Bag 3, 2050 Wits
South Africa

**PRISM
ENVIRONMENTAL
MANAGEMENT
SERVICES**

Wilgeheuwel Ext 26

**Proposed residential
development on
Holdings 14, 15 and
16 Aanwins A.H,
Johannesburg,
Gauteng Province**

Version 1.0

24 August 2007

Service provider



MATAKOMA - ARM
HERITAGE CONTRACTS UNIT

UNIVERSITY OF THE WITWATERSRAND
SCHOOL OF GEOGRAPHY, ARCHAEOLOGY AND
ENVIRONMENTAL STUDIES
PRIVATE BAG 3, P O WITS 2050
TEL: +27 82 851 3575 / +27 82 373 8491,
FAX: +27 11 717 6578
EMAIL: INFO@MATAKOMA.CO.ZA

ACKNOWLEDGEMENT OF RECEIPT

CLIENT: Prism Environmental Management Services

CONTACT PERSON: Mr James Hendricks, Prism Environmental
Management Services,
Tel: 011 672 9505
Fax: 011 672 9505

SIGNATURE: _____

LEADING CONSULTANT: MATAKOMA-ARM Heritage Contracts Unit

CONTACT PERSON: Wouter Fourie

SIGNATURE: _____

Copyright

Copyright in all documents, drawings and records whether manually or electronically produced, which form part of the submission and any subsequent report or project document shall vest in MATAKOMA-ARM. None of the documents, drawings or records may be used or applied in any manner, nor may they be reproduced or transmitted in any form or by any means whatsoever for or to any other person, without the prior written consent of MATAKOMA-ARM.

The Client, on acceptance of any submission by MATAKOMA-ARM and on condition that the Client pays to Wits Commercial Enterprise (Pty) Ltd the full price for the work as agreed, shall be entitled to use for its own benefit and for the specified project only:

- The results of the project;
- The technology described in any report
- Recommendations delivered to the Client.

EXECUTIVE SUMMARY

As we know from legislation the surveying, capturing and management of heritage resources is an integral part of the greater management plan laid down for any major development or historic existing operation. With the proclamation of the National Heritage Resources Act 1999 (Act 25 of 1999) this process has been laid down clearly. This legislation aims to underpin the existing legislation, which only addresses this issue at a glance, and gives guidance to developers and existing industries to the management of their Heritage Resources.

The importance of working with and following the guidelines laid down by the South African Heritage Resources Agency cannot be overemphasised. This document forms part of the Environmental Impact Assessment for the proposed new Township development on Holdings 14, 15 and 16 Aanwins A.H, Johannesburg, Gauteng Province.

The following outline the findings of the report:

One site of significance was found.

Site **MHC001** consists of five graves. The relocation of these graves must be done according to the guidelines provided in the report, in the event that preservation of the site is deemed impossible.

If these recommendations are adhered to there is from a Heritage point of view no reason why the development can not commence.

General

If during construction any possible finds are made, the operations must be stopped and a qualified archaeologist be contacted for an assessment of the find.

CONTENTS

EXECUTIVE SUMMARY

- 1. INTRODUCTION.....5
- 1. INTRODUCTION.....5
- 2. APPROACH AND METHODOLOGY5
- 2.1 PHYSICAL SURVEYING 6
- 3. WORKING WITH LEGISLATION6
- 4. ASSESSMENT CRITERIA7
- 4.1 IMPACT..... 8
- 4.1.1 Nature and existing mitigation 8
- 4.2 EVALUATION..... 8
- 4.2.1 Site Significance..... 8
- 4.2.2 Certainty 9
- 4.2.3 Duration..... 9
- 5. HISTORICAL BACKGROUND OF AREA 10
- 6. SITES OF SIGNIFICANCE..... 11
- 6.1 2627BB-MHC001 11
- 7. ASSUMPTIONS AND LIMITATIONS 15
- 8. LEGAL AND POLICY REQUIREMENTS 15
- 9. ASSESSMENT AND RECOMMENDATIONS 17
- 10. LIST OF PREPARES..... 19
- 11. REFERENCES 19
- 11.1 ARCHAEOLOGICAL PAPERS 19
- 11.2 CULTURAL HERITAGE PAPERS..... 19

ANNEXURE

Annexure A – Locality Map

FIGURES

- Figure 1: Photo of cemetery 12*
- Figure 2: General site photo 14*
- Figure 3: Photo of demolished buildings 14*

1. INTRODUCTION

Matakoma Heritage Consultants (Pty) Ltd was contracted by Prism Environmental Management Services to conduct a Heritage Scoping Assessment for the proposed new Township development on Holdings 14, 15 and 16 Aanwins A.H, Johannesburg, Gauteng Province.

The aim of the study is to identify all heritage sites, document, and assess their importance within Local, Provincial and national context. From this we aim to assist the developer in managing the discovered heritage resources in a responsible manner, in order to protect, preserve, and develop them within the framework provided by the National Heritage Resources Act of 1999 (Act 25 of 1999).

The report outlines the approach and methodology utilised before and during the survey, which includes in Phase 1: Information collection from various sources and public consultations; Phase 2: Physical surveying of the area on foot and by vehicle; and Phase 3: Reporting the outcome of the study.

During the survey, one cultural heritage site of significance was identified. General site conditions and features on site were recorded by means of photos, GPS location, and description. Possible impacts were identified and mitigation measures are proposed in the following report.

This report must also be submitted to SAHRA provincial office for scrutiny.

2. APPROACH AND METHODOLOGY

The aim of the study is to extensively cover all data available to compile a background history of the study area; this was accomplished by means of the following phases.

2.1 PHYSICAL SURVEYING

Due to the nature of cultural remains, the majority that occur below surface, a physical walk through of the study area was conducted. MATAKOMA-ARM was appointed to conduct a survey of the proposed development area together with access routes and entrances to the proposed residential development. The total area of impact comprised an area of approximately 4ha in total. The study area was surveyed over one day, by means of vehicle and extensive surveys on foot by MATAKOMA-ARM.

Aerial photographs and 1:50 000 maps of the area were consulted and literature of the area were studied before undertaking the survey. The purpose of this was to identify topographical areas of possible historic and pre-historic activity. All sites discovered both inside and bordering the proposed development area was plotted on 1:50 000 maps and their GPS co-ordinates noted. 35mm photographs on digital film were taken at all the sites.

3. WORKING WITH LEGISLATION

It is very important that cultural resources be evaluated according to the National Heritage Recourse Act. In accordance with the Act, we have found the following:

- These sites are classified as important based on evaluation of the National Heritage Recourses Act 1999 (Act No 25 of 1999) section 3 (3).

A place or object is to be considered part of the national estate if it has cultural significance or other special value because of-

- (a) its importance in the community, or pattern of South Africa's history;
- (b) its possession of uncommon, rare or endangered aspects of South Africa's natural or cultural heritage;
- (c) its potential to yield information that will contribute to an understanding of South Africa's natural or cultural heritage;

- (d) its importance in demonstrating the principal characteristics of a particular class of South Africa's natural or cultural places or objects;
- (e) its importance in exhibiting particular aesthetic characteristics valued by a community or cultural group;
- (f) its importance in demonstrating a high degree of creative or technical achievement at a particular period;
- (g) its strong or special association with a particular community or cultural group for social, cultural or spiritual reasons;
- (h) its strong or special association with the life or work of a person, group or organisation of importance in the history of South Africa; and
- (i) sites of significance relating to the history of slavery in South Africa.

(Refer to Section 9 of this document for assessment)

These sites should be managed through using the National Heritage Recourses Act 1999 (Act No 25 of 1999) sections 4,5 and 6 and sections 39-47.

Please refer to Section 9 for Management Guidelines.

4. ASSESSMENT CRITERIA

This chapter describes the evaluation criteria used for the sites listed below.

The significance of archaeological sites was based on four main criteria:

- **site integrity** (i.e. primary vs. secondary context),
- **amount of deposit, range of features** (e.g., stonewalling, stone tools and enclosures),
- **uniqueness** and
- **potential** to answer present research questions.

Management actions and recommended mitigation, which will result in a reduction in the impact on the sites, will be expressed as follows:

A - No further action necessary;

B - Mapping of the site and controlled sampling required;

C - Preserve site, or extensive data collection and mapping of the site; and

D - Preserve site

Impacts on these sites by the development will be evaluated as follows

4.1 IMPACT

The potential environmental impacts that may result from the proposed development activities.

4.1.1 Nature and existing mitigation

Natural conditions and conditions inherent in the project design that alleviate (control, moderate, curb) impacts. All management actions, which are presently implemented, are considered part of the project design and therefore mitigate against impacts.

4.2 EVALUATION

4.2.1 Site Significance

The significance rating scale is as follows:

HIGH: Must be mitigated or not impacted on at all.

LOW - MEDIUM: May require further work before development can commence.

NO SIGNIFICANCE: Do not require mitigation.

4.2.2 Certainty

DEFINITE: More than 90% sure of a particular fact. Substantial supportive data exist to verify the assessment.

PROBABLE: Over 70% sure of a particular fact, or of the likelihood of impact occurring.

POSSIBLE: Only over 40% sure of a particular fact or of the likelihood of an impact occurring.

UNSURE: Less than 40% sure of a particular fact or likelihood of an impact occurring.

4.2.3 Duration

SHORT TERM: 0 to 5 years

MEDIUM: 6 to 20 years

LONG TERM: more than 20 years

DEMOLISHED: site will be demolished or is already demolished

Example

Evaluation

IMPACT	SIGNIFICANCE	CERTAINTY	DURATION	MITIGATION
Negative	high negative	definite	long	C

5. HISTORICAL BACKGROUND OF AREA

As heritage surveys deal with the locating of heritage resources in a prescribed cartographic landscape, the study of archival and historical data, and especially cartographic material, can represent a very valuable supporting tool in finding and identifying such heritage resources.

The historical background and timeframe can be divided into the Stone Age, Iron Age and Historical timeframe. These can be divided as follows:

Stone Age

The Stone Age is divided in Early; Middle and Late Stone Age and refers to the earliest people of South Africa who mainly relied on stone for their tools.

Early Stone Age: The period from \pm 2.5 million yrs - \pm 250 000 yrs ago. Acheulean stone tools are dominant.

Middle Stone Age: Various lithic industries in SA dating from \pm 250 000 yrs – 22 000 yrs before present.

Late Stone Age: The period from \pm 22 000-yrs before present to the period of contact with either Iron Age farmers or European colonists.

Iron Age

The Iron Age as a whole represents the spread of Bantu speaking people and includes both the Pre-Historic and Historic periods. Similar to the Stone Age it can be divided into three periods:

The Early Iron Age: Most of the first millennium AD.

The Middle Iron Age: 10th to 13th centuries AD

The Late Iron Age: 14th century to colonial period.

Historic Timeframe

The historic timeframe intermingles with the later parts of the Stone and Iron Age, and can loosely be regarded as times when written and oral recounts of incidents became available.

The current owners of the property confirmed that most of the structures on the property were constructed by them in the past twenty years. The main house was constructed in the late 1970' early 1980's.

6. SITES OF SIGNIFICANCE

Wilgeheuwel Extension 26 is currently utilised as dumping site for garden and building rubbish from the vicinity. The remains of an building with outhouses are evident in the north eastern corner of the site.

None of the structures are of heritage value.

One cemetery with at least five graves are present on site.

6.1 2627BB-MHC001

Description of Site:			
Site Number	MHC001		
Map reference	Topo-sheet number	Number of Map in report	
	2627BB	Annexure A	
GPS coordinates: Indicate Model and datum - WGS 84	X	Y	
Garmin 38, WGS 84	-26.10296	27.88452	
Site Data	Description		
Type of site (e.g. open scatter; shell midden, cave /shelter);	Cemetery, consisting of 5 graves		
Site categories (e.g. Earlier Stone Age, Late Iron Age);	Historic		

<p>Context (i.e. primary or secondary);</p>	<p>Primary</p>
<p>Cultural affinities, approximate age and significant features of the site;</p>	<p>None</p>
<p>Estimation or measurement of the extent (maximum dimensions) and orientation of the site(s);</p>	<p>10 x 10m</p>
<p>Depth and stratification of the site (where shovel test permits have been given), both in the text and through photographs of the sections;</p>	<p>None visible</p>
<p>Possible sources of information about past environments, such as stalactites/ stalagmites, flowstone, dassie middens, peat or organic rich deposits.</p>	<p>None</p>
<p>Photographs and diagrams (Figure numbers)</p>	<div data-bbox="576 1173 1422 1805" data-label="Image"> </div> <p style="text-align: center;">•Figure 1: Photo of cemetery</p>

Statement of Significance <i>(Heritage Value)</i>	The site is of high significance.				
Field Rating <i>(Recommended grading or field significance) of the site:</i>	Generally protected (GP.A)				
Impact Evaluation <i>of development on site</i>	Impact on site is seen as medium negative, through possible destruction of site				
Recommendations <i>including:</i>	The graves must be relocated if required through the appropriate relocation process.				
Summary					
Field Rating	Impact	Impact Significance	Certainty	Duration	Mitigation
Grade GP.A	Negative	High	Possible	Long term	B

(Refer to **Figure 1** for layout of the property.)

No other sites of cultural heritage significance were found during the survey.



• *Figure 2: General site photo*



• *Figure 3: Photo of demolished buildings*

7. ASSUMPTIONS AND LIMITATIONS

Due to the nature of cultural remains that occur, in most cases, below surface, the possibility remains that some cultural remains may not have been discovered during the survey. Although MATAKOMA-ARM surveyed the area as thorough as possible, it is incumbent upon the developer to inform the relevant heritage agency should further cultural remains be unearthed or laid open during the process of development.

8. LEGAL AND POLICY REQUIREMENTS

In areas where there has not yet been a systematic survey to identify conservation worthy places, a permit is required to alter or demolish any structure older than 60 years. This will apply until a survey has been done and identified heritage resources are formally protected.

Archaeological and palaeontological sites, materials, and meteorites are the source of our understanding of the evolution of the earth, life on earth and the history of people. In the new legislation, permits are required to damage, destroy, alter, or disturb them. People who already possess material are required to register it.

The management of heritage resources are integrated with environmental resources and this means that before development takes place heritage resources are assessed and, if necessary, rescued.

In addition to the formal protection of culturally significant graves, all graves, which are older than 60 years and are not in a cemetery (such as ancestral graves in rural areas), are protected. The legislation protects the interests of communities that have interest in the graves: they may be consulted before any disturbance takes place.

The graves of victims of conflict and those associated with the liberation struggle will be identified, cared for, protected and memorials erected in their honour.

Anyone who intends to undertake a development must notify the heritage resource authority and if there is reason to believe that heritage resources will be affected, an impact

assessment report must be compiled at the developer's cost. Thus developers will be able to proceed without uncertainty about whether work will have to be stopped if a heritage resource is discovered.

According to the National Heritage Act (Act 25 of 1999 section 32) it is stated that:

An object or collection of objects, or a type of object or a list of objects, whether specific or generic, that is part of the national estate and the export of which SAHRA deems it necessary to control, may be declared a heritage object, including –

- objects recovered from the soil or waters of South Africa, including archaeological and palaeontological objects, meteorites and rare geological specimens;
- visual art objects;
- military objects;
- numismatic objects;
- objects of cultural and historical significance;
- objects to which oral traditions are attached and which are associated with living heritage;
- objects of scientific or technological interest;
- books, records, documents, photographic positives and negatives, graphic material, film or video or sound recordings, excluding those that are public records as defined in section 1 (xiv) of the National Archives of South Africa Act, 1996 (Act No. 43 of 1996), or in a provincial law pertaining to records or archives; and
- any other prescribed category.

Under the National Heritage Resources Act (Act No. 25 of 1999), provisions are made that deal with, and offer protection, to all historic and pre-historic cultural remains, including graves and human remains.

- Graves younger than 60 years fall under Section 2(1) of the Removal of Graves and Dead Bodies Ordinance (Ordinance no. 7 of 1925) as well as the Human Tissues Act (Act 65 of 1983) and are the jurisdiction of the National Department of Health and the relevant Provincial Department of Health and must be submitted for final approval to the Office of the relevant Provincial Premier. This function is usually delegated to the

Provincial MEC for Local Government and Planning, or in some cases the MEC for Housing and Welfare. Authorisation for exhumation and reinterment must also be obtained from the relevant local or regional council where the grave is situated, as well as the relevant local or regional council to where the grave is being relocated. All local and regional provisions, laws and by-laws must also be adhered to. In order to handle and transport human remains the institution conducting the relocation should be authorised under Section 24 of Act 65 of 1983 (Human Tissues Act).

- Graves older than 60 years, but younger than 100 years fall under Section 36 of Act 25 of 1999 (National Heritage Resources Act) as well as the Human Tissues Act (Act 65 of 1983) and are the jurisdiction of the South African Heritage Resource Agency (SAHRA). The procedure for Consultation Regarding Burial Grounds and Graves (Section 36(5) of Act 25 of 1999) is applicable to graves older than 60 years that are situated outside a formal cemetery administrated by a local authority. Graves in the category located inside a formal cemetery administrated by a local authority will also require the same authorisation as set out for graves younger than 60 years over and above SAHRA authorisation. If the grave is not situated inside a formal cemetery but is to be relocated to one, permission from the local authority is required and all regulations, laws and by-laws set by the cemetery authority must be adhered to.

9. ASSESSMENT AND RECOMMENDATIONS

*A locality map is provided in **Annexure A***

If it is found that the preservation of the cemetery of site MHC001 is impossible, the relocation of the graves must adhere to the guidelines provided by the South African Heritage Resources Agency. These include comprehensive social consultation, permit applications and detailed excavations.

MATAKOMA-ARM can be contacted for further work on this process.

There is from a Heritage point of view no reason why the development can not commence.

General

If during construction any possible finds are made, the operations must be stopped and a qualified archaeologist be contacted for an assessment of the find.

10. LIST OF PREPARES

Wouter Fourie, BA (Hon) Archaeology (Pretoria)

11. REFERENCES

11.1 ARCHAEOLOGICAL PAPERS

Willemse, J. 2002. Bewaar gister vir die nageslag. Rapport, 16 June 2002. S.A.

11.2 CULTURAL HERITAGE PAPERS

Australia ICOMOS. The Burra Charter (The Australian ICOMOS charter for places of cultural significance). 2002.

Standard and Guidance for Archaeological Desk-Based Assessment. 1994.

International Council of Monuments & Site Documents. Conventions, Charters and Guidelines. 2002.

Documents on Cultural Heritage Protection. 2002.

International Council of Monuments & Site Documents. Guidelines to the Burra Charter: Conservation Policy. 1985.

International Council of Monuments & Site Documents. Guidelines to the Burra Charter: Cultural Significance. 1984.

Australian Historic Themes. A Framework for use in Heritage Assessment and Management. Australian Heritage Commission. 2001.

ANNEXURE A: Locality Map

WILGEHEUWEL EXT 26 - HERITAGE SCOPING REPORT

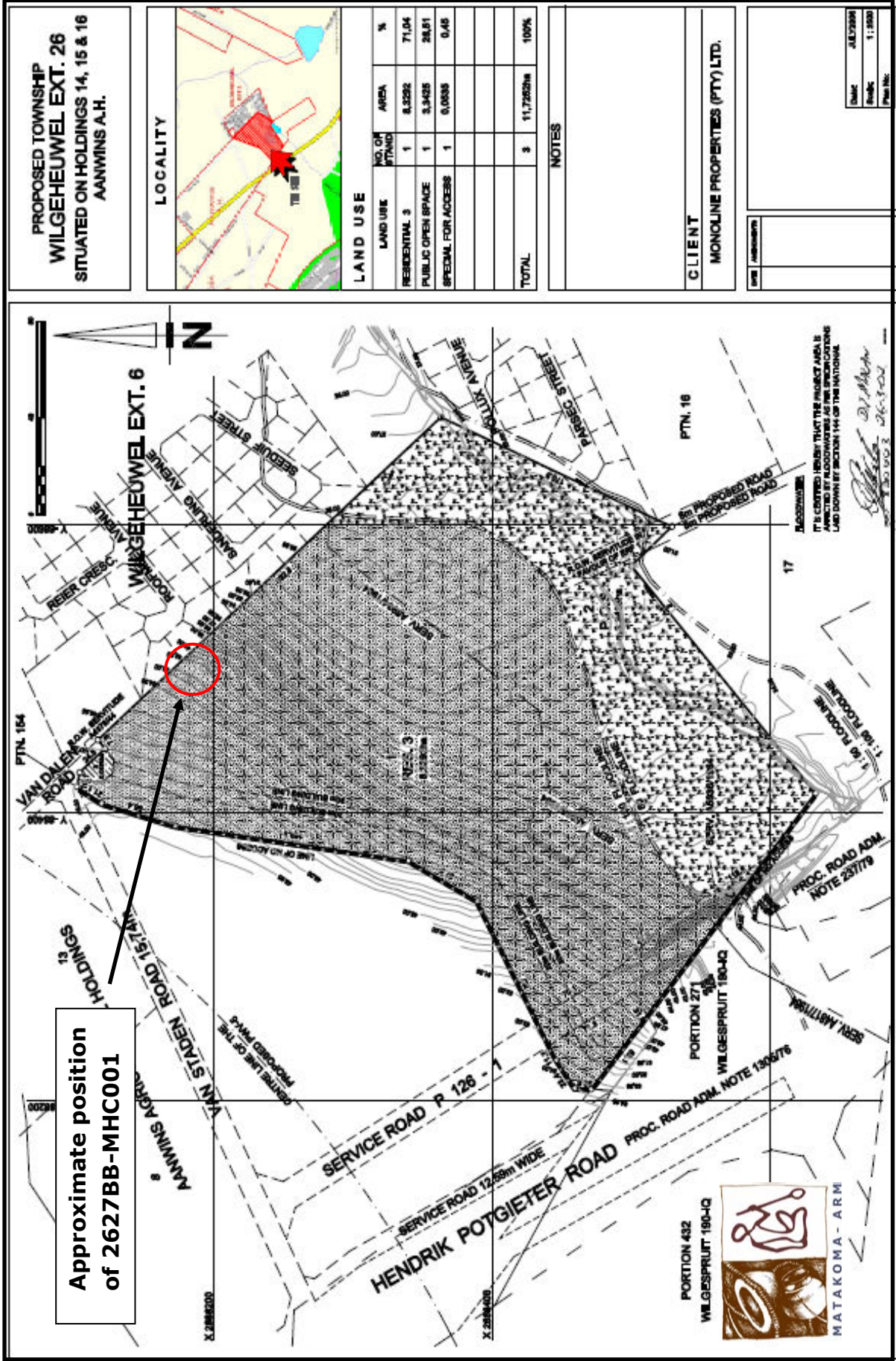

**Approximate position
of 2627BB-MHC001**

PORTION 432
WILGESPRUIT 190-HQ
MATAKOMA - ARM

IT IS NOTED HEREBY THAT THE PROJECT AREA IS
IMPACTED BY ALLOCATIONS AS THE SPECIFIC ZONING
LAND DOWN BY SECTION 144 OF THE NATIONAL
ENVIRONMENTAL MANAGEMENT ACT 106 OF 1998