

# HERITAGE ASSESSMENT FOR THE ZUURBEKOM PROJECT, GAUTENG

A Phase I report prepared for Seaton Thompson & Associates

Professor T.N. Huffman

Archaeological Resources Management  
School of Geography, Archaeology & Environmental Studies  
University of the Witwatersrand  
Johannesburg

February 2008

# HERITAGE ASSESSMENT FOR THE ZUURBEKOM PROJECT, GAUTENG

## EXECUTIVE SUMMARY

Other than the remains of two recent European farms, no archaeological or heritage sites exist within the project area.

## INTRODUCTION

Township Realtors (SA Pty Ltd) intend to develop part of Portion 15, all of Portions 37 and 76 and the remainder of the farm Zuurbekom for an industrial park and low cost housing. The development will incorporate about 91 hectares, largely bordering the West Rand Garden Agricultural Holdings in Gauteng.

The environmental coordinators for the project, Seaton Thompson and Associates, commissioned Archaeological Resources Management (ARM) to examine the project area for sites of archaeological and historical interest. It was ARM's task to assess the significance of any sites in terms of Sections 35 and 38 of the National Heritage Resources Act (Act No. 25 of 1999).

## METHOD

One ARM staff visited the project area on Saturday, 9 February 2008. The area was traversed on foot and by vehicle. Sites were recorded with a handheld GPS instrument calibrated to Garmin WGS 84. The project area occurs on the 1: 50 000 map 2627BD Lenasia (Figure 1).

Site significance is based on five main criteria: site integrity (i.e. primary vs. secondary context), amount of deposit, range of features (e.g., middens, houses and stonewalls), uniqueness (rare vs. common) and potential to answer present research questions. With these criteria, sites with no significance do not require mitigation, low to medium may require further work before development, sites with high significance must be mitigated, while sites with maximum significance should not be disturbed at all. Graveyards automatically have high social significance regardless of historic value.

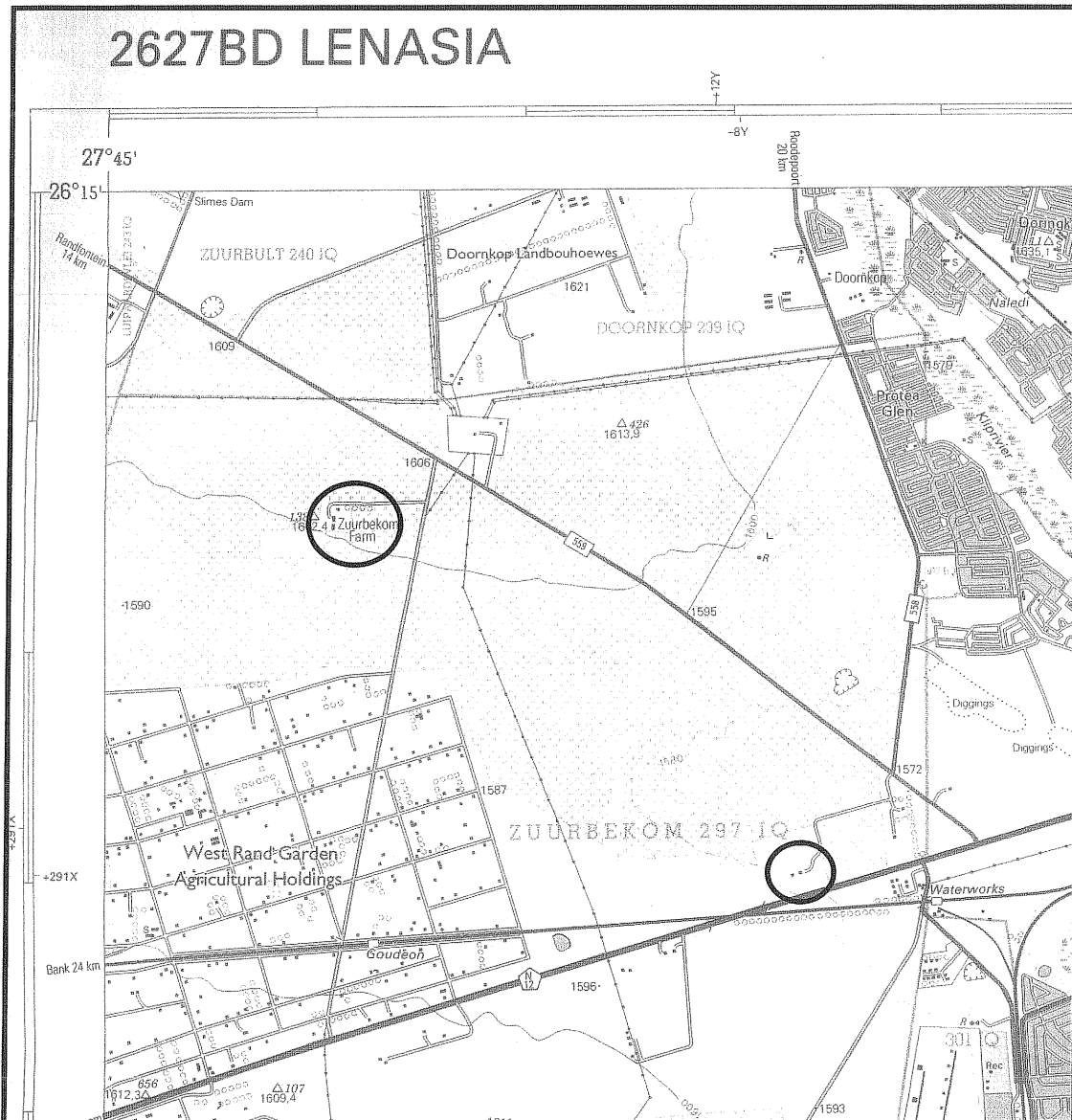

Figure 1. Project area. Note location of two European farms.

## RESULTS

Much of the project area has been under cultivation and is highly disturbed. One stony area lay under the power lines on the southern boundary, near the railway line. The stone, although chert, is not suitable for flaking, and no stone tools or signs of quarrying were noted.

The only visible sites were the remains of two European farms. Both appear on the 1995 edition of the Lenasia map, but both have been subsequently levelled. The first (Site 1: 26

18S; 27 47E) includes the foundations of African housing and standing silos inside a gum tree plantation (Figure 2). The second, the Zuurbekom Farm (Site 2: 26 16S; 27 46E), is marked by the foundation of the main house and a few other structures and trees (Figure 3). In both cases, the farms appear too recent to have had their own cemeteries. They also appear to be less than 60 years old, and thus of no historical significance.



Figure 2. African housing and silos at site 1.



Figure 3. Remains of site 2, Zuurbekom farm.

## RECOMMENDATIONS

No sites of archaeological or heritage significance occur in the project area. In terms of Heritage legislation, there are no compelling reasons why the project should not continue.