

**V&A WATERFRONT
DESALINATION PLANT
LEASE AREA OVER ERVEN REMAINDER
149294 & 173713 CAPE TOWN**

Situate in the City of Cape Town
Administrative District of the Cape
Province of Western Cape

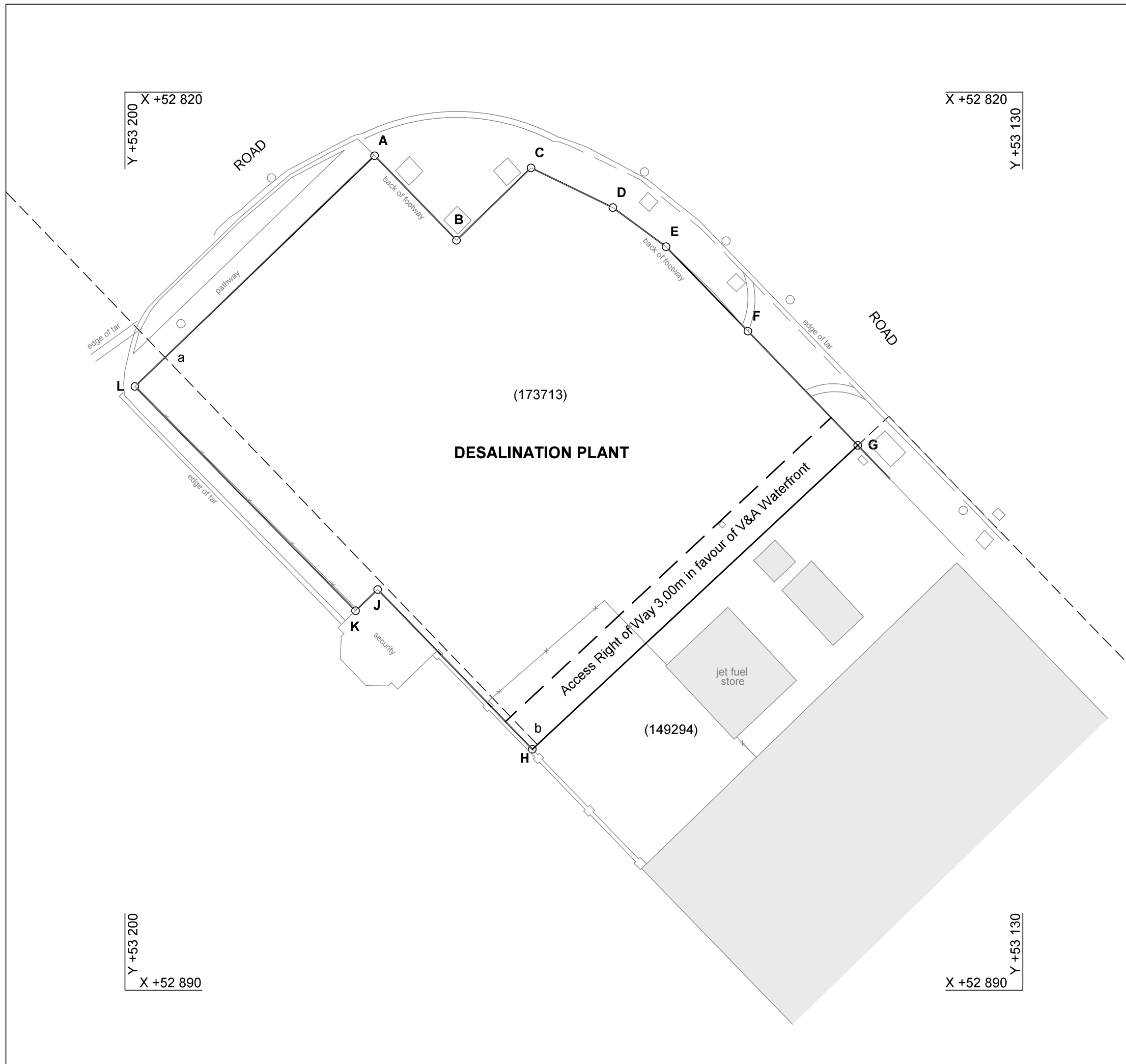
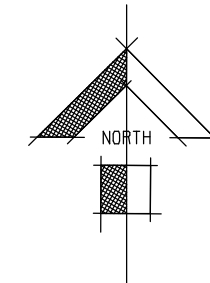

Data

SIDES Metres	ANGLES OF DIRECTION	CO-ORDINATES Y System WG 19° X		
			0,00	+3 700 000,00
AB	9,18	315 53 20	A	+53 180,54 +52 824,96
BC	8,10	225 51 40	B	+53 174,15 +52 831,55
CD	7,09	295 50 50	C	+53 168,34 +52 825,91
DE	5,14	306 22 50	D	+53 161,96 +52 829,00
EF	9,17	315 51 10	E	+53 157,82 +52 832,05
FG	12,35	316 08 00	F	+53 151,43 +52 838,63
GH	34,71	46 58 40	G	+53 142,87 +52 847,54
HJ	17,33	135 55 00	H	+53 168,24 +52 871,22
JK	2,39	46 11 00	J	+53 180,30 +52 858,77
KL	24,53	135 27 10	K	+53 182,02 +52 860,42
LA	25,94	226 05 40	L	+53 199,23 +52 842,94

Area = 1404m²

Notes

1. The figure L a b H J K represents part of the Desalination Plant over Remainder Erf 149294 Cape Town
2. The figure A B C D E F G b a represents part of the Desalination Plant over Erf 173713 Cape Town

date	02 November 2017
scale	1 / 500
drawing ref.	L11955 (fa)
drawing no.	Desalination Plant Lease Area

dh+a david hellig+ abrahamse
professional land surveyors
 2nd floor wale street chambers
 38 wale street, cape town
 Tel : +27 021 426 2613
 info@dhaa.co.za www.dhale.co.za