

ANNEXURE H

1972 - NEW SWIMMING POOL

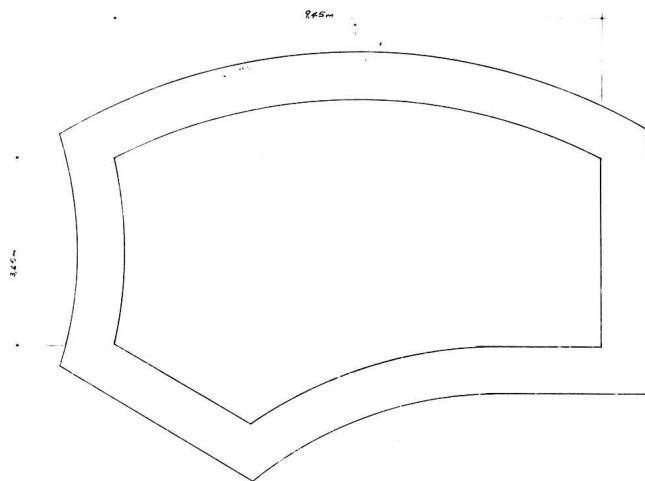

PLAN OF POOL

Reinforced Steel Drawings supplied by: DAVIS, MICHELOW & HARWOOD, Engineers.

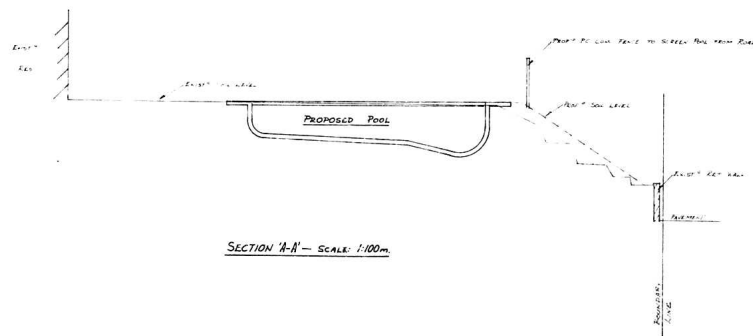

SECTION 'A-A' - SCALE: 1:100m

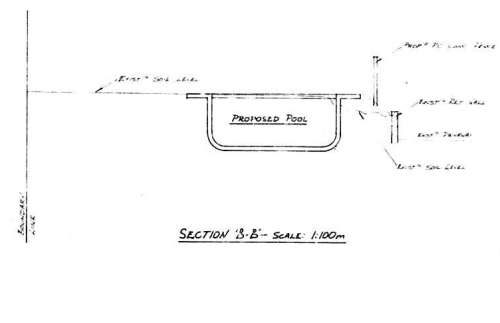

SECTION 'B-B' - SCALE: 1:100m

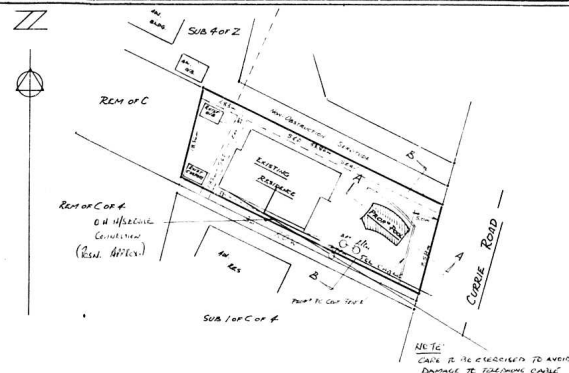

SITE PLAN - SCALE: 1:500m. SUB 1 OF C OF 5, TOWNLANDS

NOTES:

1. WASTE WATER VIA B.P.T. TO EXISTING SEWER MANHOLE.
2. EXCESS SOIL TO BE SPREAD ON SITE.
3. PROPOSED 1.83m HIGH PC CONC FENCE TO SCREEN POOL FROM THE ROAD. PATTERN: "LOUIRE" BY DURBAN PRESTA WALLS.

113 CURRIE ROAD - SWIM. POOL.

SHEET 1/1	COPY 2
CITY OF DURBAN	
PLAN No. 457/5/72	
APPROVED 28 JUN 1972	
C. G. HANDS	DATE
CITY ENGINEER	PER



PENGUIN POOLS (DURBAN)

(Sole Proprietors: Blue Lake Construction (Pty) Ltd)

124 WILLIAMS ROAD - DURBAN
PO BOX 68 - DALBRIDGE
TELEPHONES: 312981 312751

Drawn by: J. KROOK Date: 10-6-72
Shape: "BOLERO" Area: 42.5m²
Drawing No: 98.1 Scale: Shown



Earth leakage protection is to be fitted on electrical supply.
Precautions to be taken in regard to condensate. Pump chamber
to be adequately drained. Electrical equipment to be suitably housed
and prearrangements taken in regard to flooding leakage and drain water.

This drawing is the property and copyright of Blue Lake
Construction (Pty) Ltd and may not be used, copied or borrowed on
any project or other swimming pools without their written consent.

Proposed "PENGUIN" SWIMMING POOL for: Mr. J. R. WHITEHEAD - 113 CURRIE ROAD - DURBAN