

228 (2,83ha)

B2204012 - C1
WHEN IN DOUBT - ASKI

GENERAL:
 Manufacturer or builder must physically check measurements on site. The general measurements on this plan are only for design and not for manufacturing purposes. Any difference or changes in design of any nature must be brought under our attention before manufacturing. This drawing is to be read in conjunction with all relevant construction documents.

CONCRETE:
 1. All concrete to be 25Mpa unless otherwise stated on this drawing.
 2. Reinforcing steel has to be fixed as per this drawing in conjunction with bending schedule.
 3. No site mix of concrete will be allowed unless otherwise stated.
 4. The preparation of concrete slabs to be min. 15mm apart in the joints.
 5. The joints must stay in position for a minimum period of 21 days after casting of concrete.
 6. No formwork can be done on the slab while still propped because settlement will occur when props are removed.

STEEL:
 1. All timber must be the size, type and grading as specified.

SPECIAL RECALLS:
 1. JOINTS cannot be inspected and confirmed to be correct at any stage (lose products)
 2. PROPOSED external to be verified as correct by engineer because of floating bodies (props) as well as removing of loose props after inspection.
 3. STRUCTURAL SPECIALS must be in accordance with SABS and building regulations to ensure that water is directed away from the structure to prevent any excessive settlement of foundations and any damage to the structure.

NO INSPECTION NO CERTIFICATE

A19
 CONSULTING ENGINEERS
 STRUCTURAL / CIVIL

BELLEVILLE OFFICE
 5 Pentia Centre –
 17 Pentia Str – Rossmorepark
 Tel: +27 21 910 1890
 Email: admin@a19.co.za

SOMERSET WEST OFFICE
 Unit 6 – Grey van Pittius Centre –
 c/o Victoria & Neeta Str – Somerset West
 Tel: +27 21 851 6519
 Email: adminsw@a19.co.za

Project: AVEC LA TERRE
 PORTION 11 OF FARM 1426
 PAARL

Client: PLUTUS

Drawing: PROPOSED BULK WATER

Drawing no: B2204012/C/200 Scale: AS SHOWN (A1)

Drawn: M. du Buisson Date: 28 SEPT 2022

Checked: Z.H. Burger REVISION: 0

Signed & Approved:
 Z.H. Burger
 (PR.TECH.ENG. 2018300317)

Signed & Approved:
 I.G. Jansse Van Vuuren
 (PR.TECH.ENG. 200870226)

Signature:

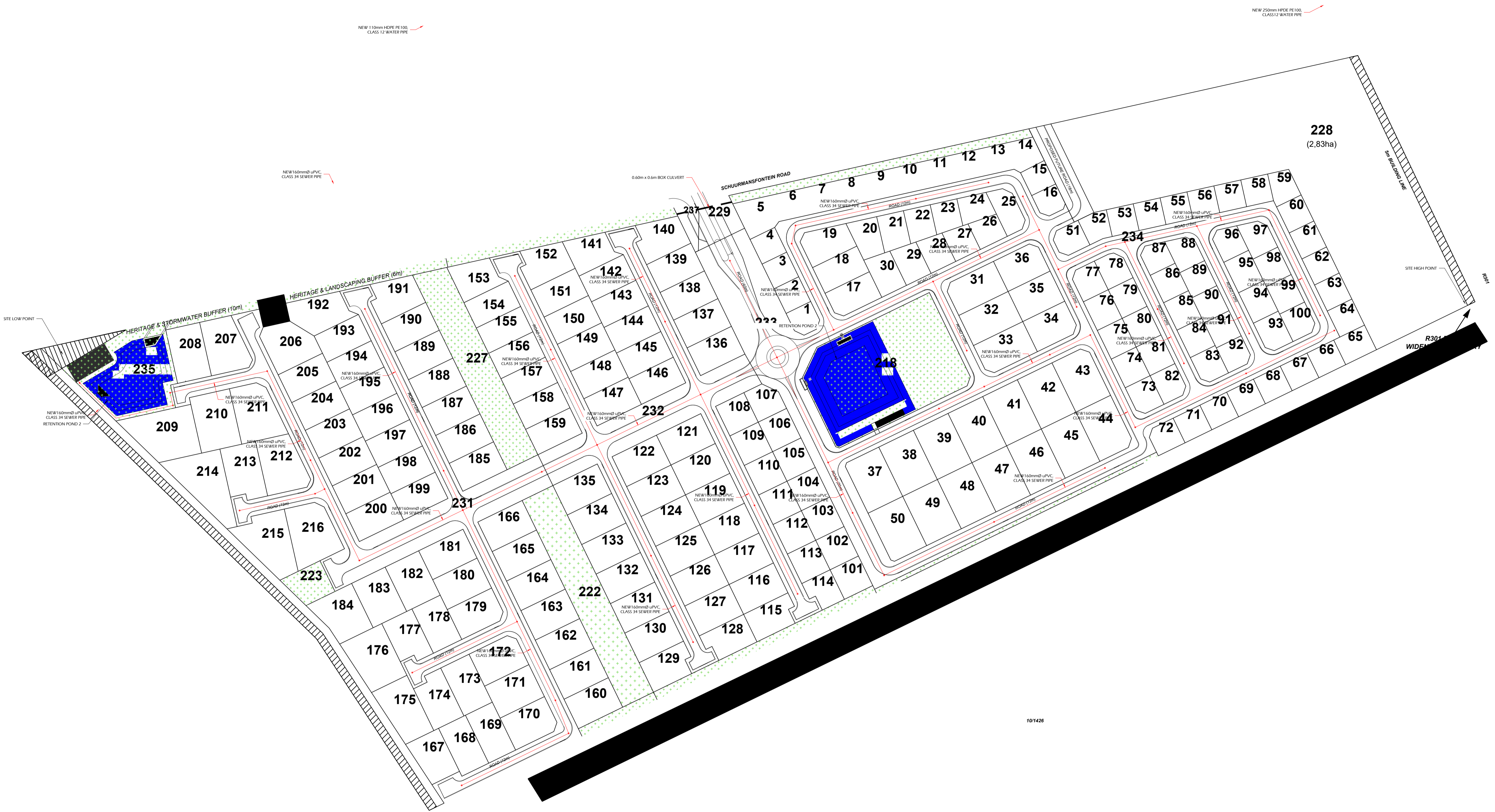

10/1426

B2204012 - C1
WHEN IN DOUBT - ASKI

GENERAL:
 Manufacturer or builder must physically check measurements on site. The principal measurements on this plan are only for design and not for manufacturing purposes. Any difference or changes in design of any nature must be brought under our attention before manufacturing. This drawing is to be read in conjunction with all relevant construction documents.

CONCRETE:
 1. All concrete to be 25MPa unless otherwise stated on this drawing.
 2. Reinforcing steel has to be fixed as per this drawing in conjunction with bending schedule.
 3. No site mix of concrete will be allowed unless otherwise stated.
 4. The preparation of concrete decks to be min. 15mm apart in the joints.
 5. The joints must stay open for a minimum period of 21 days after casting of concrete.
 6. No footings can be done on the deck while still proposed because settlement will occur when props are removed.

STEEL:
 1. All timber must be the size, type and grading as specified.

SPECIAL REQUESTS:
 1. WORKS cannot be inspected and confirmed to be correct at any stage (lose products)
 2. PROPOSED cannot be verified as correct by engineer because of floating bodies (props) as well as removing of some props after inspection.
 3. STRUCTURAL SPECIALS must be in accordance with SABS and building regulations to ensure that water is directed away from the structure to prevent any excessive settlement of foundations and any damage to the structure.

NO INSPECTION NO CERTIFICATE

A19
 CONSULTING ENGINEERS
 STRUCTURAL | CIVIL

BELLEVILLE OFFICE
 5 Perla Centre –
 17 Perla Str – Rosepark
 Tel: +27 21 910 1890
 Email: admin@a19.co.za

SOMERSET WEST OFFICE
 Unit 6 – Grey van Pittius Centre –
 c/o Victoria & Reitz Str – Somerset West
 Tel: +27 21 851 6519
 Email: adminsw@a19.co.za

Project: **AVEC LA TERRE
 PORTION 11 OF FARM 1426
 PAARL**

Client: **PLUTUS**

Drawing: **PROPOSED SEWER RETICULATION**

Drawing no: **B2204012/C/300** Scale: **AS SHOWN (A1)**

Drawn: **M. du Buisson** Date: **28 SEPT 2022**

Checked: **Z.H. Burger** REVISION: 0

Signed & Approved:
Z.H. Burger
 (PR.TECH.ENG. 2018300317)

Signed & Approved:
L.G. Jansen Van Vuuren
 (PR.TECH.ENG. 200870226)

Signature:

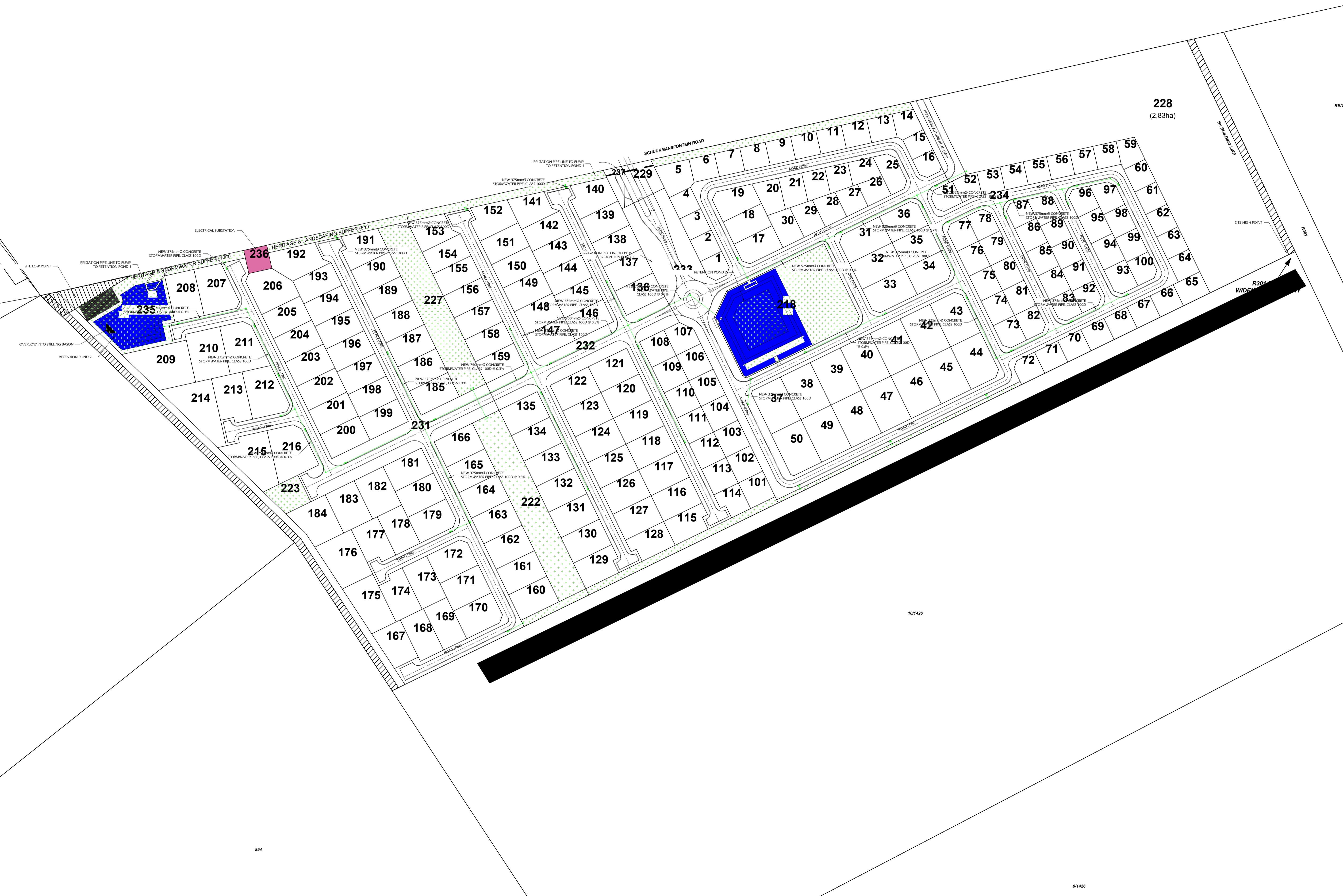

228
(2,83ha)

REV

B2204012 - C1
WHEN IN DOUBT - ASKI

GENERAL:
Manufacturer or builder must physically check measurements on site. The general measurements on the drawing are for design only. No or manufacturing purposes. If any errors or changes in design of any nature must be brought under our attention before manufacturing. This drawing is to be used in conjunction with all relevant construction documents.

CONCRETE:
1. All concrete to be 20Mpa unless otherwise stated on the drawing.
2. Reinforcing steel has to be fixed as per the drawing in conjunction with bending schedule.
3. No site mix of concrete will be allowed unless otherwise stated.
4. The spacing of concrete decks to be min. 1.5m apart in all directions.
5. 21 days after casting of concrete, decks shall still protrude and no backfill can be done on the deck until proper settlement will occur when props are removed.

STEEL:
1. All timber must be the size, type and grading as specified.

SPECIAL REQUEST:
1. GREYER cannot be inspected and confirmed to be correct at any stage (base product).
2. PROPOSED cannot be certified correct by engineer because of building under price as well as removing of some props after inspection.
3. DIMENSIONED OPTICAL system must be in accordance with SANS and building regulations to ensure that water is channelled away from the structure to prevent any excessive settlement of foundations and any damage to the structure.

NO INSPECTION NO CERTIFICATE



5 Ponds Centre -
17 Pasika Str - Rosepark
Tel: +27 21 910 1890
Email: admin@a19.co.za

SOMERSET WEST OFFICE
Unit 6 - Grey van Pittius Centre -
c/o Victoria & Riet Str - Somerset West
Tel: +27 21 851 6519
Email: adminsw@a19.co.za

Project: AVEC LA TERRE PORTION 11 OF FARM 1426 PAARL

Client: PLUTUS

Drawing: PROPOSED ROADS AND STORMWATER LAYOUT

Drawing No: B2204012/C/101 Scale: AS SHOWN (A1)

Drawn: M. du Buisson Date: 28 SEPT 2022

Checked: Z.H. Burger REVISION: 0

Signed & Approved: Z.H. Burger (PR.TECH.ENG. 2018300317)

Signed & Approved: L.G. Janse Van Vuuren (PR.TECH.ENG. 200870226)

Signature:

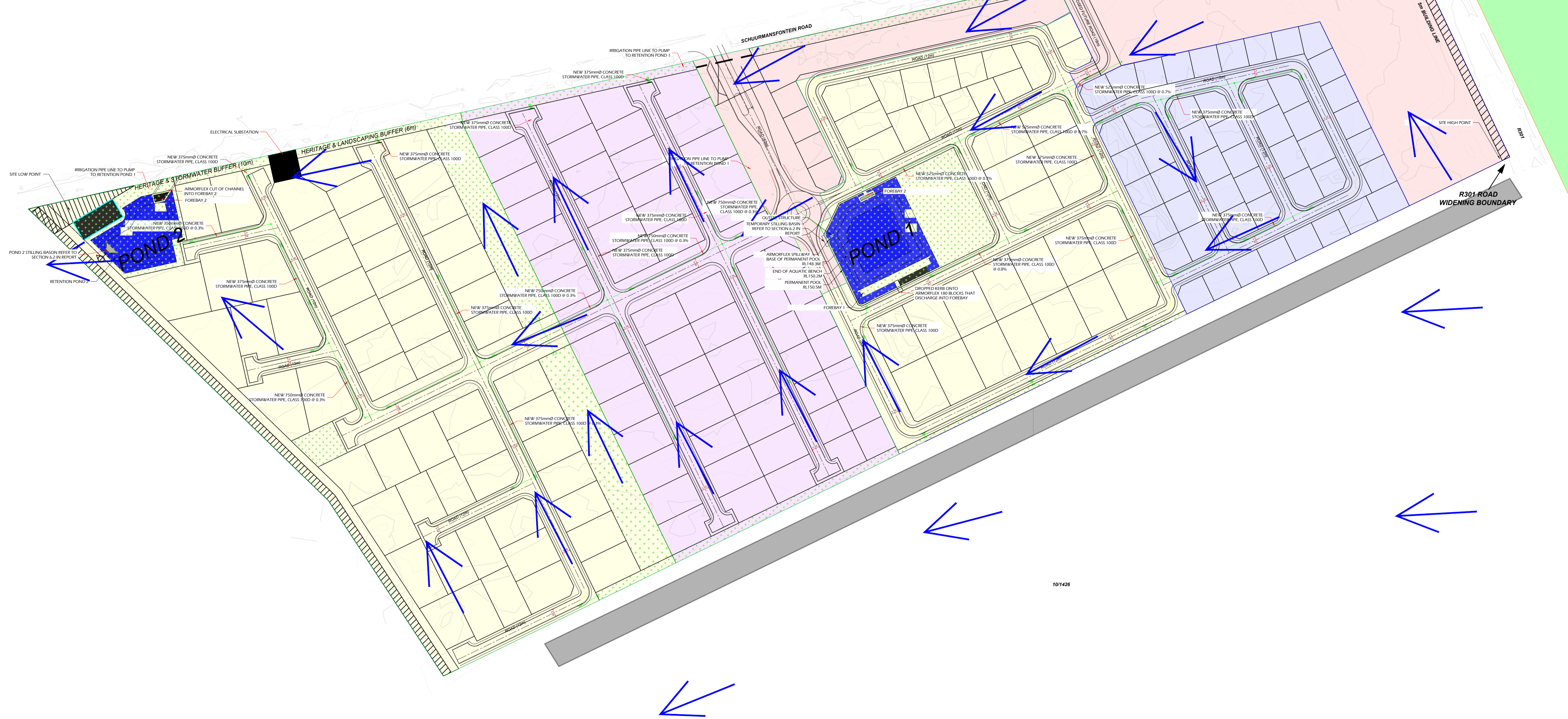
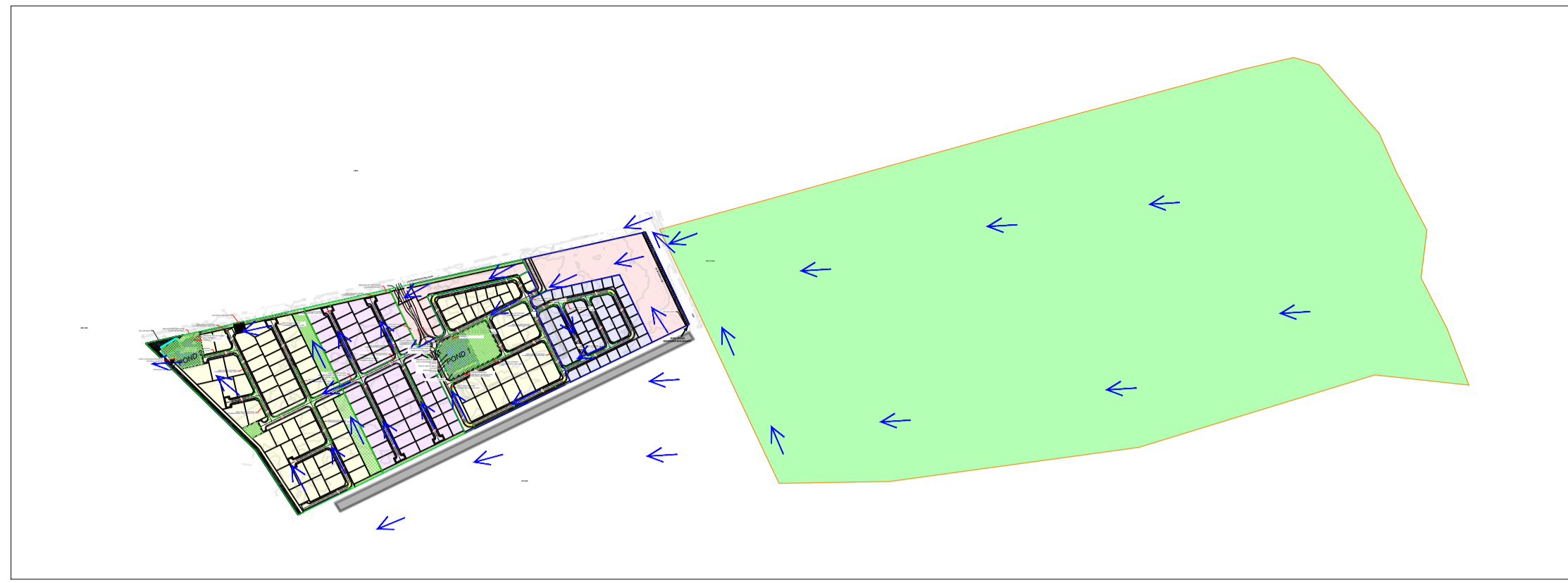

10/1426

B2204012 - C1
WHEN IN DOUBT - ASK!

GENERAL:
 Manufacturer or supplier must physically check measurements on site. The principal measurements on this drawing are only for design and not for manufacturing purposes. Any difference or changes in design of any nature must be brought under our attention before manufacturing. This drawing is to be read in conjunction with all relevant construction documents.

CONCRETE:
 1. All concrete to be 25MPa unless otherwise stated on this drawing.
 2. Reinforcing steel have to be fixed as per this drawing in conjunction with bending schedule.
 3. No site mix of concrete will be allowed unless otherwise stated.
 4. The preparation of concrete decks to be min. 15mm apart in the joints.
 5. The joints must stay open for a minimum period of 21 days after casting of concrete.
 6. No footings can be done on the deck while still prepared because settlement will occur when props are removed.

STEEL:
 1. All member must be the size, type and grading as specified.

SPECIAL REQUISITS:
 1. JOINTS cannot be inspected and confirmed to be correct at any stage (loose products)
 2. PROPOSED external be verified as correct by engineer because of floating bodies (props) as well as removing of loose props after inspection.
 3. STRUCTURAL SPECIALS must be in accordance with SABS and building regulations to ensure that water is directed away from the structure to prevent any excessive settlement of foundations and any damage to the structure.

NO INSPECTION NO CERTIFICATE

A19
 CONSULTING ENGINEERS
 STRUCTURAL | CIVIL

BELLVILLE OFFICE
 5 Perda Centre –
 17 Perda Str – Rossmorepark
 Tel: +27 21 910 1890
 Email: admin@a19.co.za

SOMERSET WEST OFFICE
 Unit 6 – Grey van Pittius Centre –
 c/o Victoria & Rietz Str – Somerset West
 Tel: +27 21 851 6519
 Email: adminsw@a19.co.za

Project: **AVEC LA TERRE PORTION 11 OF FARM 1426 PAARL**
 Client: **PLUTUS**
 Drawing: **PROPOSED SEWER RETICULATION**
 Drawing no: **B2204012/C/SWMP AS SHOWN (A1)** Scale:
 Drawn: **M. du Buisson** Date: **28 SEPT 2022**
 Checked: **Z.H. Burger** REVISION: 0
 Signed & Approved: **Z.H. Burger (PR.TECH.ENG. 2018300317)**
 Signed & Approved: **L.G. Jansse Van Vuuren (PR.TECH.ENG. 200870226)**
 Signature:

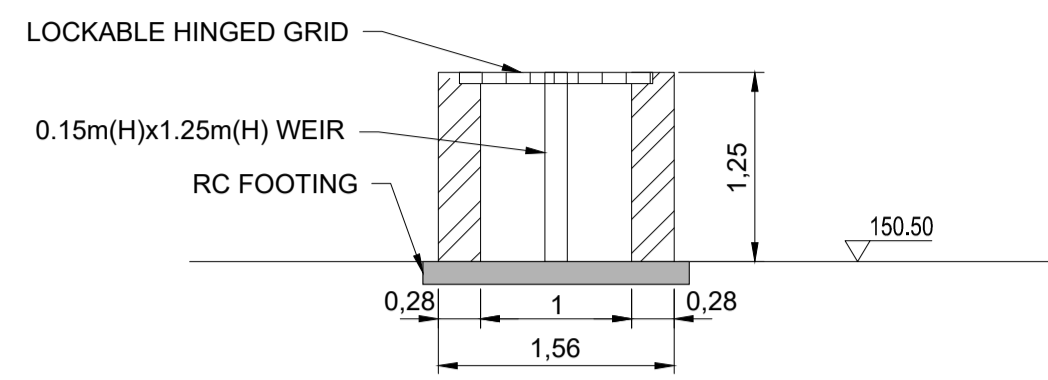

DETAIL 2: POND 1 OUTLET STRUCTURE
SCALE 1:50

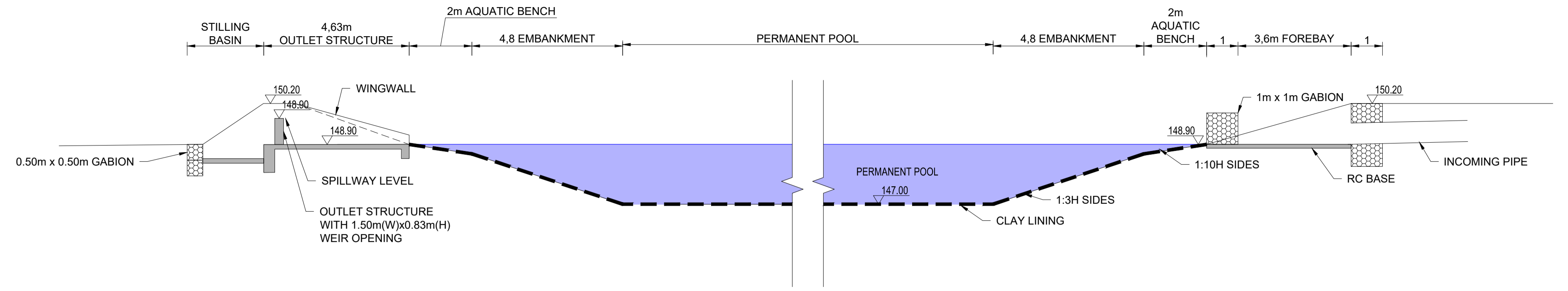

SECTION B-B: POND 2 LONG SECTION
SCALE 1:100

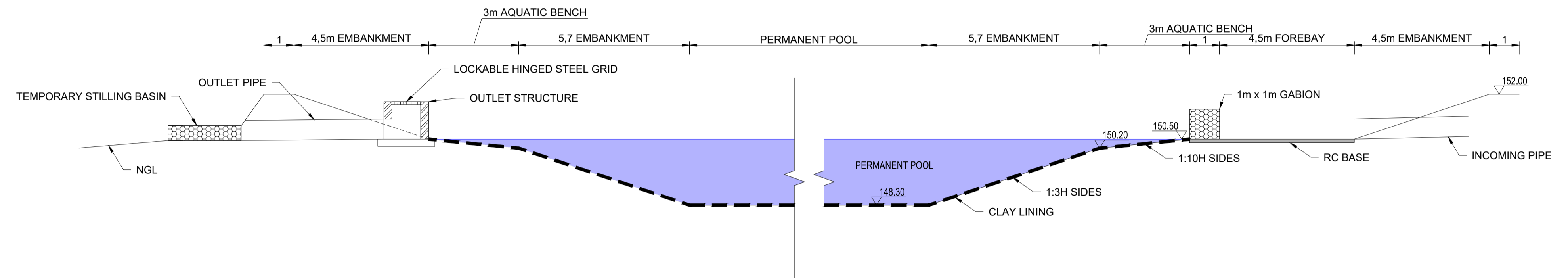

SECTION A-A: POND 1 LONG SECTION
SCALE 1:100

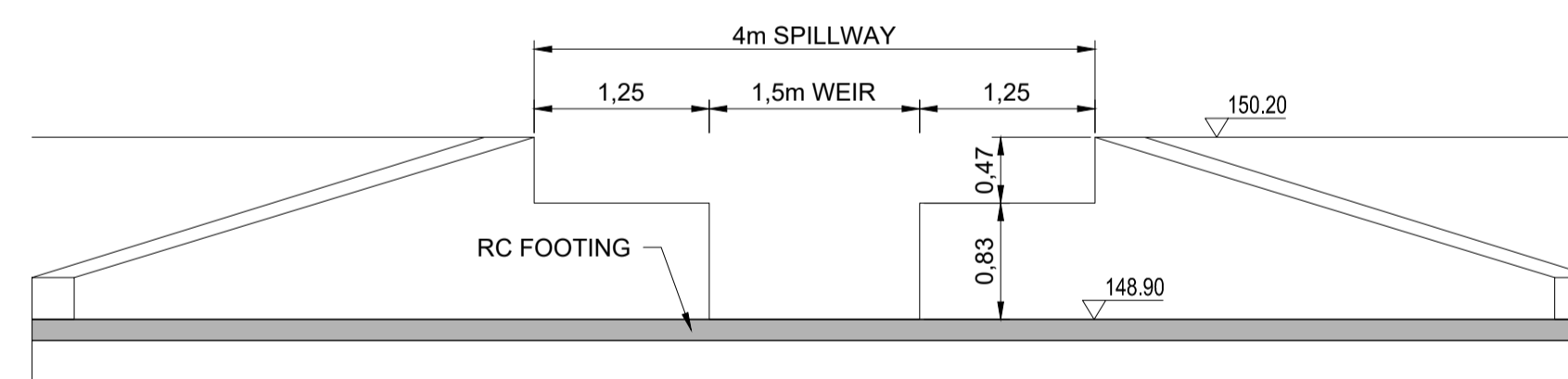

DETAIL 5: POND 2 OUTLET STRUCTURE
SCALE 1:50

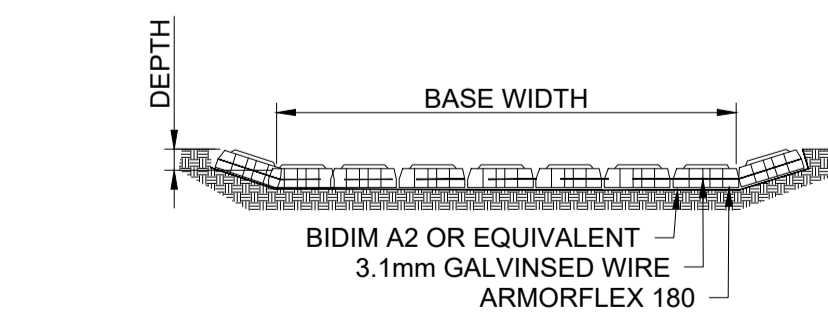

DETAIL 6: TYPICAL ARMORFLEX CHANNEL/ SPILLWAY
SCALE 1:50

B2204012 - C1	
WHEN IN DOUBT - ASK!	
<p>GENERAL:</p> <p>Manufacturer or builder must physically check measurements before construction. The general measurements on this page are only for design and not for manufacturing purposes. Any differences or changes in design of any nature must be brought to our attention before manufacturing. This drawing is to be read in conjunction with all relevant construction documents.</p>	
<p>CONCRETE</p> <ol style="list-style-type: none"> All concrete to be 25MPa unless otherwise stated on this drawing. Reinforcing steel to be as per this drawing in conjunction with bending schedule. No top rail of concrete will be allowed unless otherwise stated. The spacing of concrete decks to be min. 15mm apart in any direction. The props must stay in position for a minimum period of 21 days after casting of concrete. No brickwork can be done on the deck while still propped because settlements will occur when props are removed. 	
<p>TIMBER</p> <ol style="list-style-type: none"> All timber must be the size, type and grading in specification. 	
<p>SPECIAL REQUEST</p> <ol style="list-style-type: none"> JOINTS cannot be inspected and confirmed to be correct. All structural concrete to be checked and confirmed by engineer because of founding below props as well as removing of some props after construction. STORMWATER SPECIAL system must be in accordance with SANS and building regulations to ensure that water is channelled away from the structure to prevent any excessive settlement of foundations and any damage to the structure. 	
NO INSPECTION NO CERTIFICATE	
<p>BELLVILLE OFFICE</p> <p>5 Penta Centre - 17 Pavia Str - Rossenspark Tel: +27 21 910 1890 Email: admin@a19.co.za</p> <p>SOMERSET WEST OFFICE</p> <p>Unit 6 - Gey van Pittius Centre - c/o Victoria & Reitz Str - Somerset West Tel: +27 21 851 6519 Email: adminsw@a19.co.za</p>	
Project	AVEC LA TERRE PORTION 11 OF FARM 1426 PAARL
Client	PLUTUS
Drawing	STORMWATER MANAGEMENT PLAN DETAILS
Drawn	M. du Buisson
Scale	AS SHOWN (A1)
Date	28 SEPT 2022
Checked	Z.H. Burger
Revision	REVISION: 0
Signed & Approved:	Z.H. Burger (PR.TECH.ENG. 2018300317)
Signed & Approved:	L.G. Janse Van Vuuren (PR.TECH.ENG. 200870226)
Signature:	