

# Archaeological Impact Assessment (AIA)

for erf 26, Castle Rock  
Simon's Town

A report prepared for  
KHULA environmental consultants  
[nicksteytler@telkomsa.net](mailto:nicksteytler@telkomsa.net)  
on behalf of their client Mr David Faure of EFG Engineers (PTY) LTD  
[david@efgen.co.za](mailto:david@efgen.co.za)



View of the north east end of Castle Rock Estate

---

DR UTE A SEEMANN  
HERITAGE ARCHAEOLOGIST & CONSULTANT  
1203 Simon's Bay Estate, Oatlands Road, Simon's Town 7975  
Tel (021) 786-3656, cell: 073 1632 754  
e-mail: [useemann@telkomsa.net](mailto:useemann@telkomsa.net)  
January 2011

## 1. EXECUTIVE SUMMARY

---

Dr Ute A Seemann, Heritage Archaeologist & Consultant was commissioned by Nick Steytler of KHULA environmental consultants on behalf of their client Mr David Faure to undertake an Archaeological Impact Assessment (AIA) in connection with the proposed single residential development at erf 26, Castle Rock, Simon's Town.

The property was surveyed by the author and three assistants according to current professional standards on 22 January 2011.

Severe limitations were encountered carrying out the fieldwork. The dense coastal *fynebos* vegetation with several species of aloe and an alien Manatoka tree was impenetrable, except for a narrow footpath across and down the slope to the beach.

The site has never been developed since it was surveyed in 1916.

The steep slope of the property made it unlikely to contain any remains of human habitation. The sandy beach below at the rocky shore to the east and north were and are ideal gathering places for past inhabitants. Miller's Point some hundred meters to the north contains numerous shell middens from pre-historic people and debris from visitors and inhabitants of the last two to three hundred years.

**IMPORTANCE OF THE FINDS: Nil**

**SIGNIFICANCE: Nil**

**RECOMMENDATION: permission for the development to be given by Heritage Western Cape**

## CONTENTS

---

	PAGE
1. Executive summary .....	2
2. Baseline description .....	4
3. Historic notes .....	5
4. Deeds Office Records .....	8
5. The Survey .....	11
6. Conclusions .....	14
7. References .....	15

## LIST OF ILLUSTRATIONS

---

Frontispiece: View of the north east end of Castle Rock Estate	
Fig. 1 Google picture of Castle Rock .....	4
Fig. 2 Photograph, lot 26, erf 26, Castle Rock, 2011.....	6
Fig. 3 Schematic diagram of Castle Rock property owners, 1993 .....	7
Fig. 4 Survey Diagram erf 26, Castle Rock, 1916.....	8
Fig. 5 Survey Diagram erf 72, Castle Rock Estate, 1920 .....	9
Fig. 6 Mr Hugo's original grant, dated 1822 .....	10
Fig. 7 Erf 26 survey diagram 2010 .....	11
Fig. 8 – 11 Survey photographs of erf 26.....	12 - 13

## 2. BASELINE DESCRIPTION

---

Erf 26, Castle Rock, Simon's Town is situated to the south of the well-known recreation area of Miller's Point at the False Bay Coast of the Cape Peninsula. The basic coordinates are 34,23877°S and 18,476122°E (Fig. 1).



Fig. 1. Google photograph of erf 26, Castle Rock, 2011.

The property is facing north east, adjoining a private gravel road and the tarred main road to Cape Point. The site, a steep, rocky slope is densely covered with coastal *fynbos* and some alien vegetation to the 8,5m high water mark. A sandy beach during summers, rocks and boulders make up the lower slope of the hill, this being government property.

### 3. HISTORIC NOTES

---

Before Europeans reached Table Bay to settle permanently in 1652, two groups of indigenous people, the Khoi-San and the Khoi-Khoi herders peopled the Cape Peninsula. The Khoi-Khoi kept fat-tailed sheep and indigenous cattle and adhered to a fixed yearly transhumance migration. Wagon routes followed these cattle tracks, and later contemporary roads (such as the road to Cape Point) were constructed along the same paths.

Hart & Halkett wrote, that

“People have been living on the Cape Peninsula for at least half a million years ... Early Stone Age artefacts have been found at various locations in the Cape Point Nature Reserve ... Late Stone Age People were the ancestors of the San (Bushmen) and the Khoi-Khoi (Hottentots). The San created the shell middens (accumulations of shellfish, bone and stone artifacts) dating to within the last two thousand years, still to be found along the seashores of the Atlantic and False Bay.<sup>1</sup>

These shell middens are still to be found at Miller’s Point.

Hall and Halkett continued:

*“ ... Groups of Khoi-Khoi herders were active in the Peninsula during the early colonial period ...the diary of Jan van Riebeeck makes mention of cattle stolen from the Dutch East India Company (VOC) ... and then driven to Hout Bay and various parts of the Peninsula ... ”.*

Simon’s Town was declared the winter anchorage of the VOC in 1743. The first land grants, made around this time, finally drove the remnants of the Hottentot tribes into what is now the Cape Point Nature Reserve. Informal land grants to Europeans, Hottentots and people of mixed descend were formalized during the first years of the British administration.

In 1822 the authorities at the Cape made a land grant, consisting of 94 morgen, a strip of coastal land south of Miller’s Point, to Pieter Francois Hugo. Margaret Cairns describes this property as such:

---

<sup>1</sup> Hart, Tim & Halkett, Dave, Archaeology Contracts Office, University of Cape Town in Jess Hughes & Associates. 2000, *Environmental Baseline Study of Dido Valley, Cape Peninsula*.

“The ground was steep, unproductive, rocky mountainside, although three streams and several springs did provide water”<sup>2</sup>.

It was accessible by a *doordrift*, a rough cattle track or dirt path with a permanent ‘right-of-way’ to the South Peninsula farms.

During the 19<sup>th</sup> century the property stayed in the Hugo family. Castle Rock became a famous fishing spot on the way to Cape Point. By 1914 a new coastal route<sup>3</sup> made the Castle Rock area a valuable asset. The Hugos employed a surveyor to lay out the estate and the lots were auctioned off in 1916.

Lot 26, (later erf 26)<sup>4</sup> was sold to Jane Aletta Steyn and Evangeline Longley Taylor (Fig. 2).

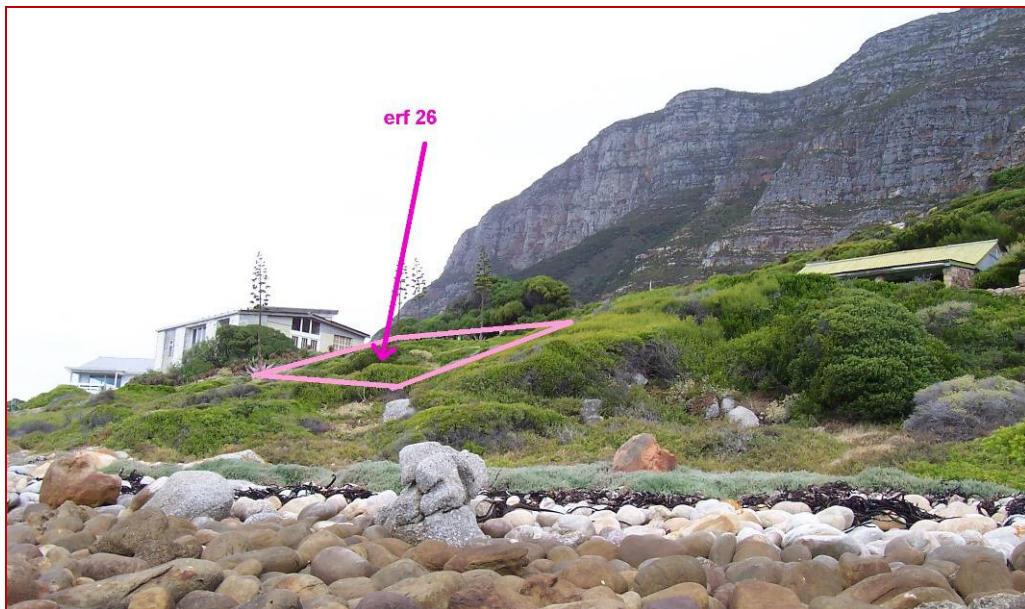

Fig. 2. Lot 26, erf 26, Castle Rock, 2011.

The property was never developed .

The properties at Castle Rock were mostly handed down within certain families. The first cottage at erf 25 adjacent to erf 26 was built in 1919 by WE Jones and it is still there, albeit in changed form. The stone cottage on erf 56, bordering erf 27 was erected in 1927 by D Garlick. Both survived several bushfires down the years.

<sup>2</sup> Cairns, Margaret. 1993. *Chronicles of Castle Rock*. Published privately by the author. ISBN 0-620-18211-3, page 10.

<sup>3</sup> To the light house at Cape point.

<sup>4</sup> Cairns, *ibid*, page 191.

In 1939 erf 26 was transferred to Margret Constance Twentyman Cairns and Patricia Mary Twentyman – Jones in equal shares.

By 1993 the owners of erf 26 were still listed as MCT Cairns (Margaret Cairns, the author of the “Chronicles of Castle Rock” and PMT Lawless, the former PM Twentyman Jones (Fig. 3).

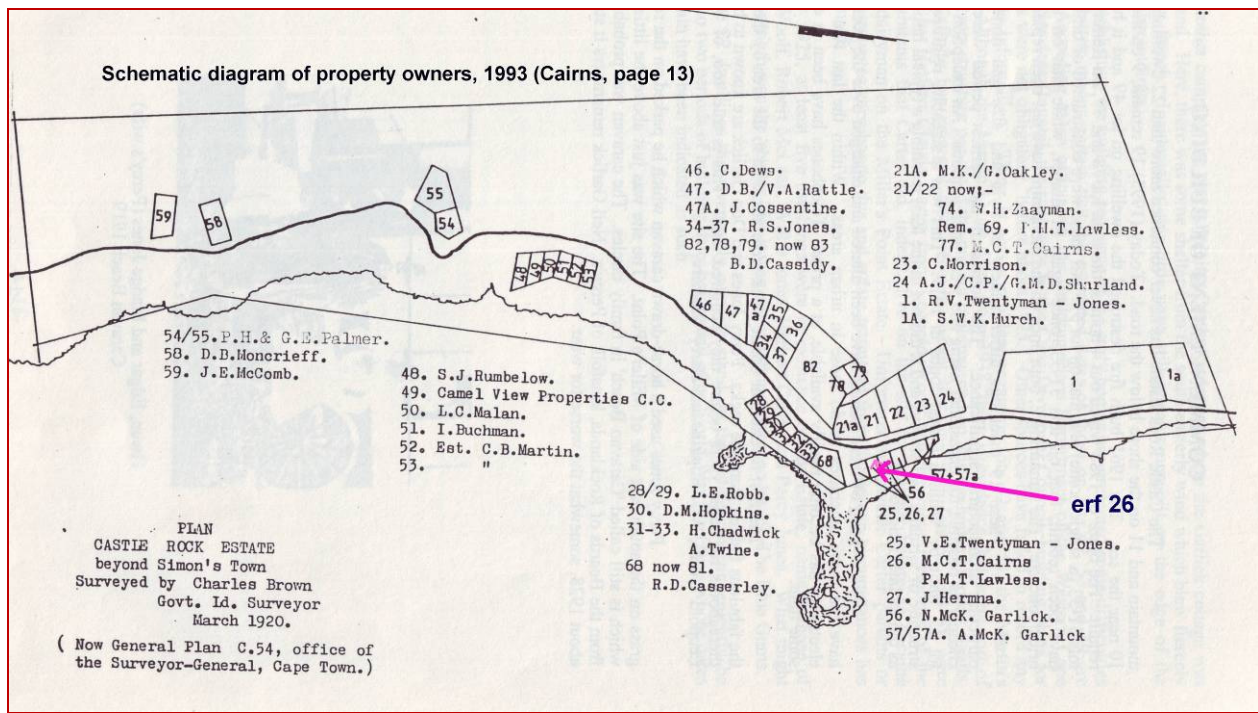

Fig. 3 Schematic diagram of Castle Rock property owners, 1993 (Cairns, page 13).

Patricia Mary Twentyman – Jones (married Lawless) half share in erf 26 was transferred in 1996 to Joseph Michael Lawless, whose estate transferred his share in 2007 to the Lawless Sons Realization Trust.

Margaret Constance Twentyman Cairns bought this half share in erf 26 from the Lawless Sons Realization Trust thus achieving complete ownership of this erf Mr David Faure is the potential owner of erf 26, purchasing it from the estate of the late Margaret Constance Twentyman Cairns.

4. DEEDS OFFICE RECORDS

4.1 Erf 26, Castle Rock, Simon's Town

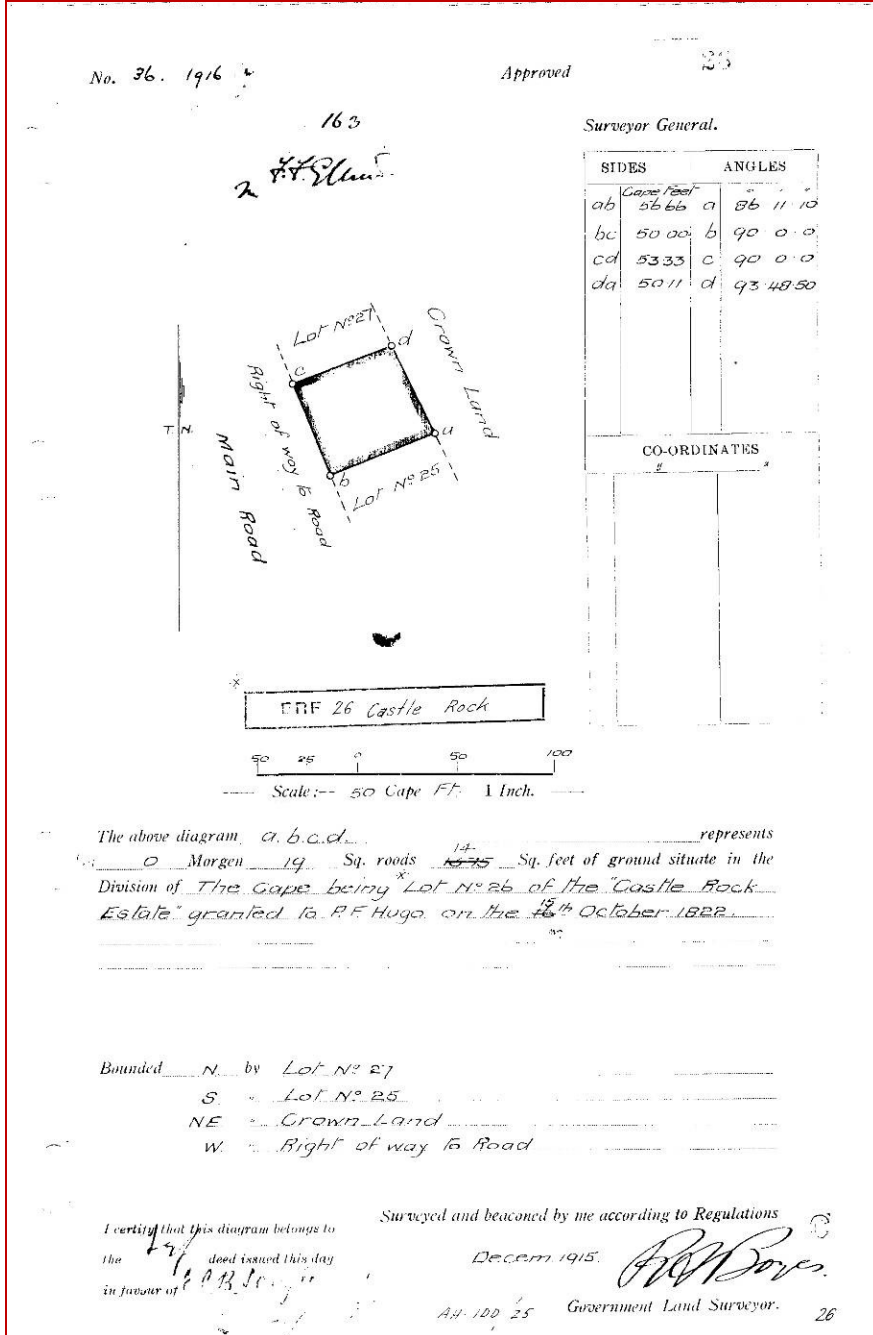

Fig. 4  
 Erf 26 Castle Rock  
 (Reference: Surveyor  
 General, Cape Town,  
 Survey Diagram 36/1916)



4.2 The parent: erf 72, Castle Rock Estate

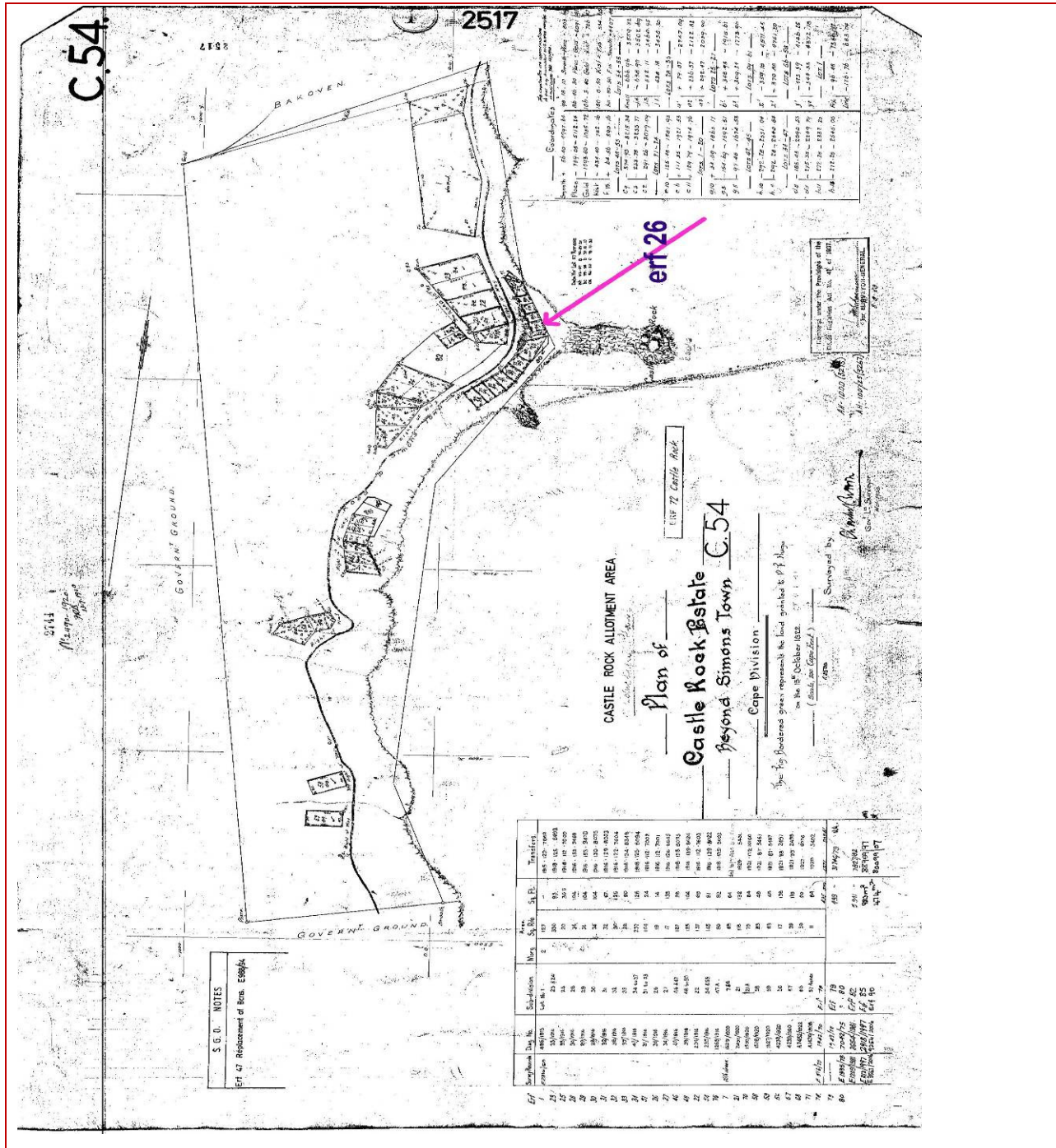

Fig. 5. The parent erf 72, Castle Rock Estate (Reference: Surveyor General, Cape Town, Dgr 2490/1920 and General Plan C.54). On the left the dates and transfer deeds of the buyers of the lots.

### 4.3 The grandparent: Simon's Town Quitrents, Vol. 9, No 43

The above survey diagram (Fig. 5) also outlines the original Simon's Town Quitrent Grant to Mr PF Hugo in 1822, from which the lots 'for sale' were subdivided. The remainder of the property, known as 'remaining extent of erf 72' was disposed of by the Hugo family after 1928.

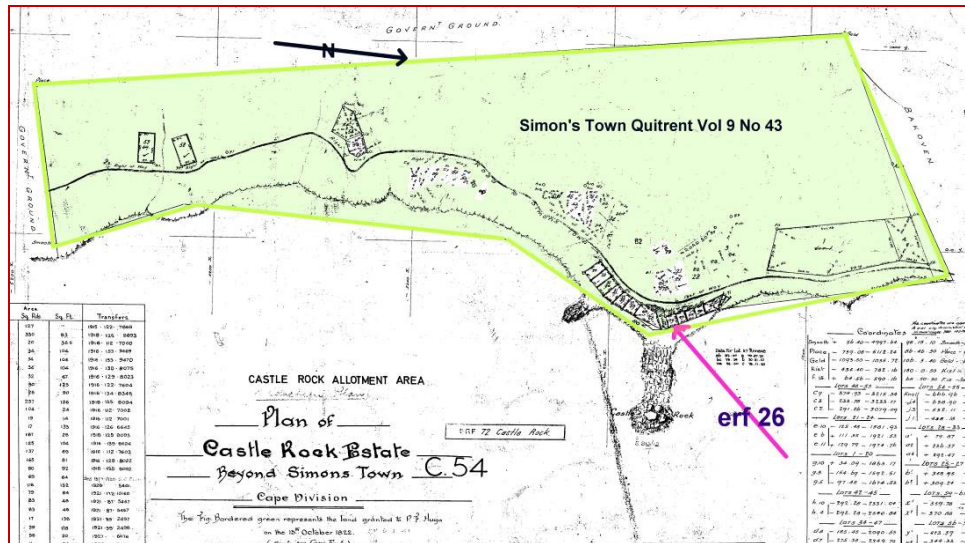

Fig. 6. The original grant to Mr PF Hugo, 1822. (Reference: Surveyor General, Cape Town, Dgr 2490/1920 and General Plan C.54).

### 4.4 Summary

Date	Survey diagram	remarks
Before 1822		Crown Land
1822	Erf 72 Simon's Town	Grant to Mr PF Hugo
		In the Hugo family until 1916
1916	Plan C 54 Castle Rock Estate	Auction of lots to several transferees
1916	36/1916 Lot 26 = erf 26	Transferred to Jane Aletta Steyn and Evangeline Longley Taylor
1939	As above	Transfer T1164/1939 half shares each to Margaret Constance Twentyman Cairns born Jones 26.04.1912 and Patricia Mary Twentyman – Jones born 14.12.1916
1996	As above	Half share Patricia Mary Twentyman – Jones (married Lawless) estate to Joseph Michael Lawless
2007	Survey diagram 36/1916 as above and Title Deed T80652/2007	Half share Joseph Michael Lawless estate to Lawless Sons Realisation Trust. Margaret Constance Twentyman Cairns bought this half share from the Lawless Sons Realisation Trust, achieving complete ownership of erf 26
2010		Mr David Faure potential owner of erf 26, purchasing it

		from the estate of the late Margaret Constance Twentyman Cairns
--	--	---

## 5. THE SURVEY

To determine whether there are likely to be any archaeological sites or artefacts of significance on the property erf 26, Castle Rock, it was traversed on foot as far as was possible by three archaeological field assistants to gather archaeological data by 'direct observation' according to present professional standards.

Limitations experienced in carrying out the fieldwork were:

- dense coastal *fynbos* vegetation with several species of aloe and some invader plants, was impenetrable, except for a narrow footpath across the property.
- The steep slope of the property
- Rock fall during earlier periods of fire.

In other words the property's grounds were intensely disturbed and no artefactual remains could be located.

The following photographs illustrate these points (Figs 7-11)

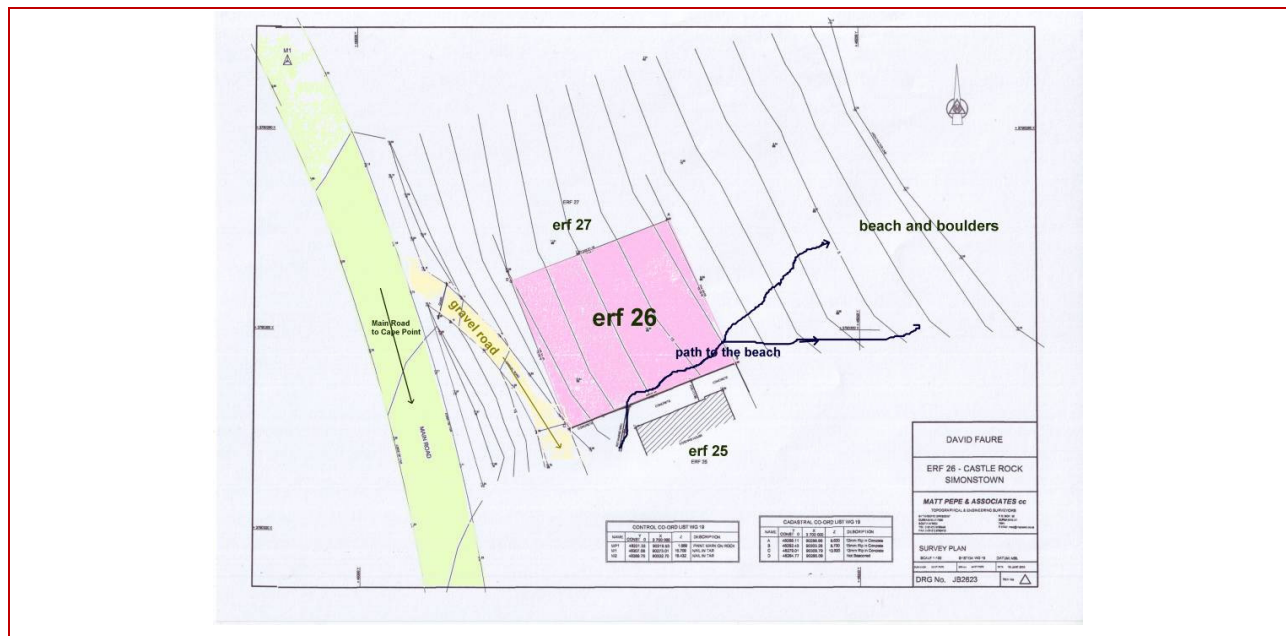

Fig. 7. Erf 26, Castle Rock, survey diagram, 2010

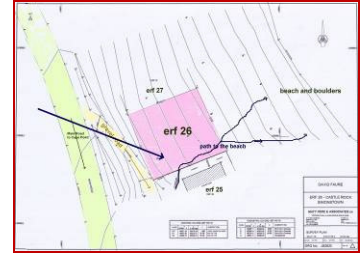

Fig. 8.  
View of erf 26 from the gravel road. The cottage to the right is located on erf 25.  
Note the aloe vera.

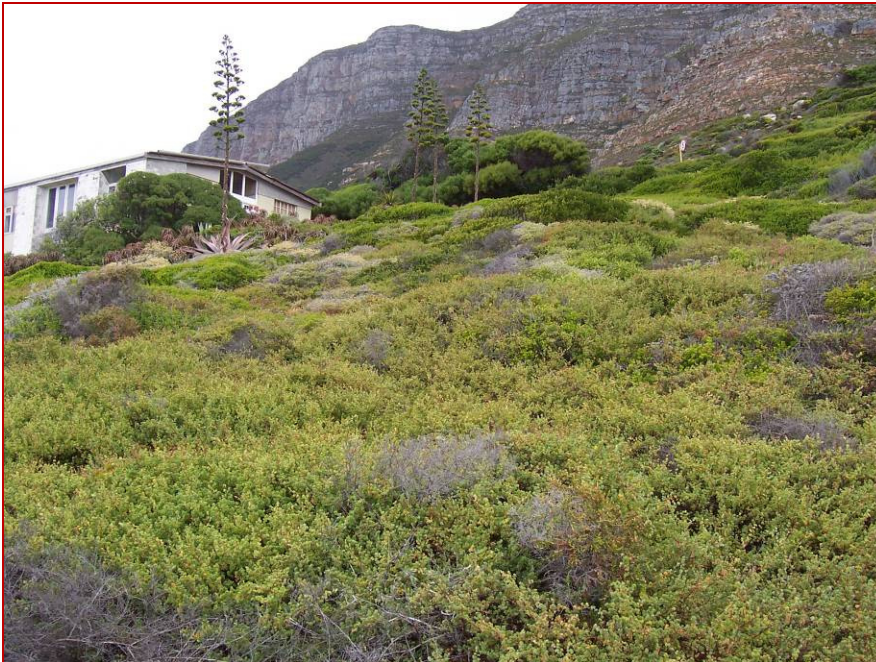

Fig. 9.  
View of erf 26 from below. The property boundaries are in line with the front of the cottage to the left.



Fig. 10.  
View of erf 26 north, from the *stoep* of the cottage at erf 25.  
Note the dense aloes in festation of the plot.

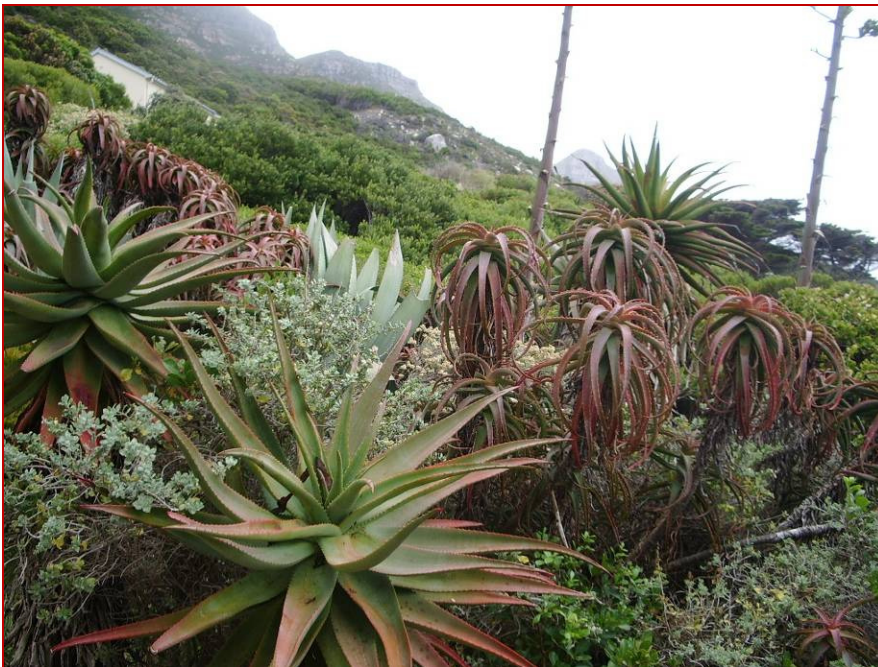

Fig. 11. Close-up of some of the vegetation on erf 26, Castle Rock.

## 5.1 Results of the Survey

- No pre-colonial sites were located due to the inaccessibility and disturbance of the site.
- No historical/architectural remains were found.

## 5.2 Observations

The landscape on erf 26 and generally at Castle Rock has been subjected to several bush fires during the past eighty years or so. The coastal *fynbos* vegetation regenerated itself with the addition of some alien species, such as Manatoka trees after each fire. The removal of the ground cover will not diminish the Heritage value of Castle Rock and surrounds.

## 6. CONCLUSIONS – questions and answers

---

1. Are there any archaeological sites or artefacts of significance on erf 26 Castle Rock?

**NO**

2. Are there any sites of heritage/architectural significance on erf 26 Castle Rock?

**NO**

3. Assessment of the sensitivity and conservation significance of heritage/archaeological sites on erf 26 Castle Rock?

**NO conservation measures needed**

4. Assessment of the status and significance of any impacts on sites or artefacts of heritage importance resulting from the proposed project.

**NO IMPACT**

5. Identify mitigatory measures to protect and maintain any valuable heritage/archaeological sites or artefacts that may exist below the surface on erf 26 Castel Rock.

**None needed**

**IMPORTANCE OF THE FINDS: NIL**

**SIGNIFICANCE: NIL**

**RECOMMENDATION:**

**Permission for the development to be given by Heritage Western Cape**

## 7. REFERENCES

---

Deeds Office, Cape Town

Surveyor Generals Office, Cape Town

Cape Archives

Google Earth satellite photographs

Cairns, Margaret. 1993. *Chronicles of Castle Rock*. Published privately by the author. ISBN 0-620-18211-3.

Hart, Tim & Halkett, Dave, Archaeology Contracts Office, University of Cape Town in Jess Hughes & Associates. 2000, *Environmental Baseline Study of Dido Valley, Cape Peninsula*.