

TERRESTRIAL BIODIVERSITY IMPORTANCE

- | | | | | |
|--|--|---|---|---|
|  Protected |  Irreplaceable |  Highly Significant |  Important & Necessary |  Least Concern |
|  No natural habitat remaining |  Endorheic pan wetlands |  Floodplain and seepage wetlands | | |

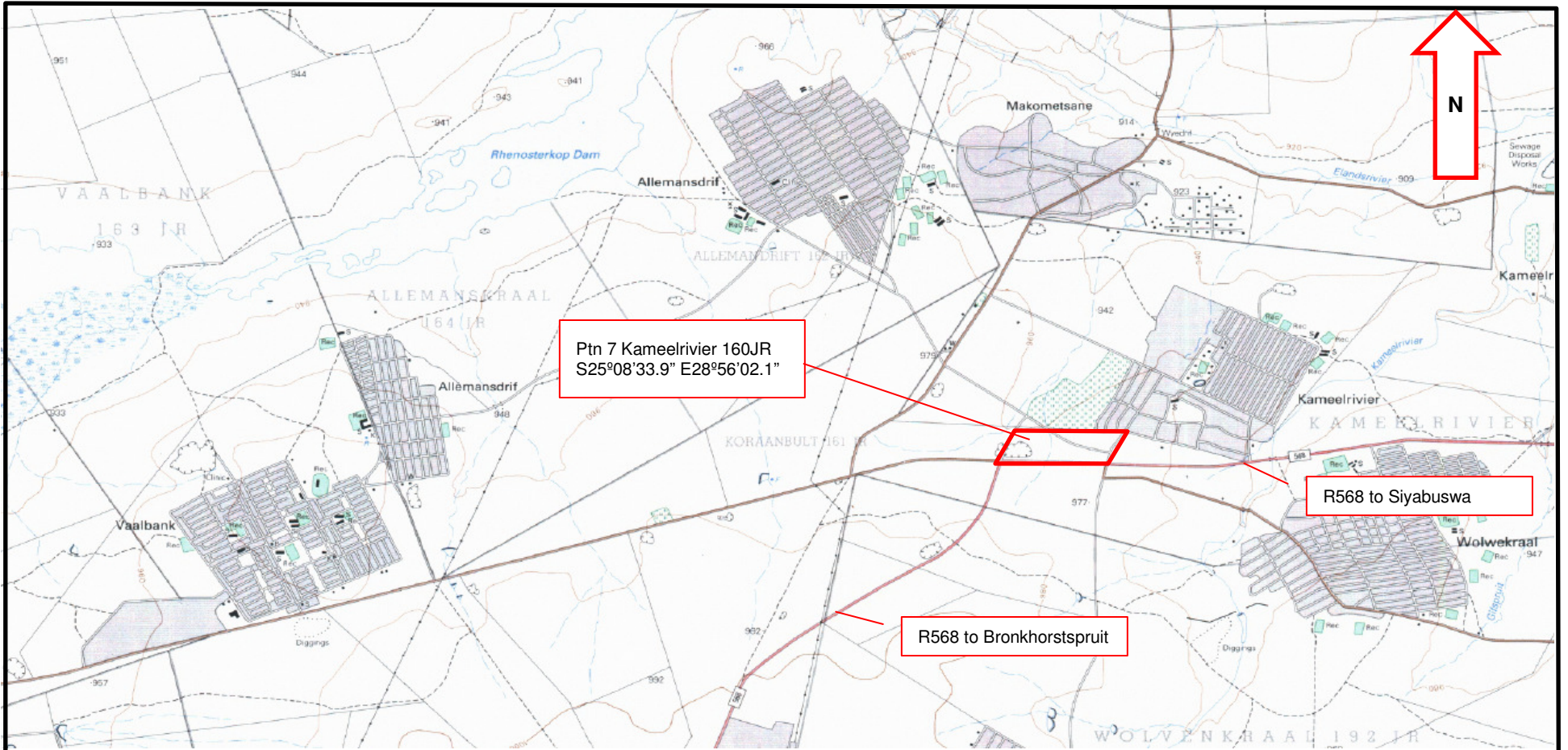

Ptn 7 Kameelrivier 160JR
S25°08'33.9" E28°56'02.1"

R568 to Siyabuswa

R568 to Bronkhorstspuit

LOCALITY (2528BB)