

| SIDES<br>ENGLISH FEET |         | ANGLES<br>OF DIRECTION<br>Constants | CO-ORDINATES<br>Y +10800000X00 |            |
|-----------------------|---------|-------------------------------------|--------------------------------|------------|
| AB                    | 1703.96 | 315.32.30                           | A + 69535.79                   | + 13168.90 |
| BC                    | 2123.19 | 94.59.10                            | B + 68342.34                   | + 14385.12 |
| CA                    | 1383.44 | 221.46.30                           | C + 70457.49                   | + 14200.62 |

S.G.No.4989/6

Approved

*[Signature]*  
Surveyor  
28/11

The Figure G middle of Molweni Stream F E D represents a Pumphouse Servitude vide diagram S.G. No.4577/46 relating to Deed of Transfer The Figure G A H J middle of Molweni Stream G represents a Pipeline Servitude 6 feet wide vide diagram S.G. No.4577/46 relating to Deed of Transfer The Figure K middle of Molweni Stream K represents the middle line of Sewer and Drain Servitude 40 feet wide vide diagram S.G. No. 4991/6;

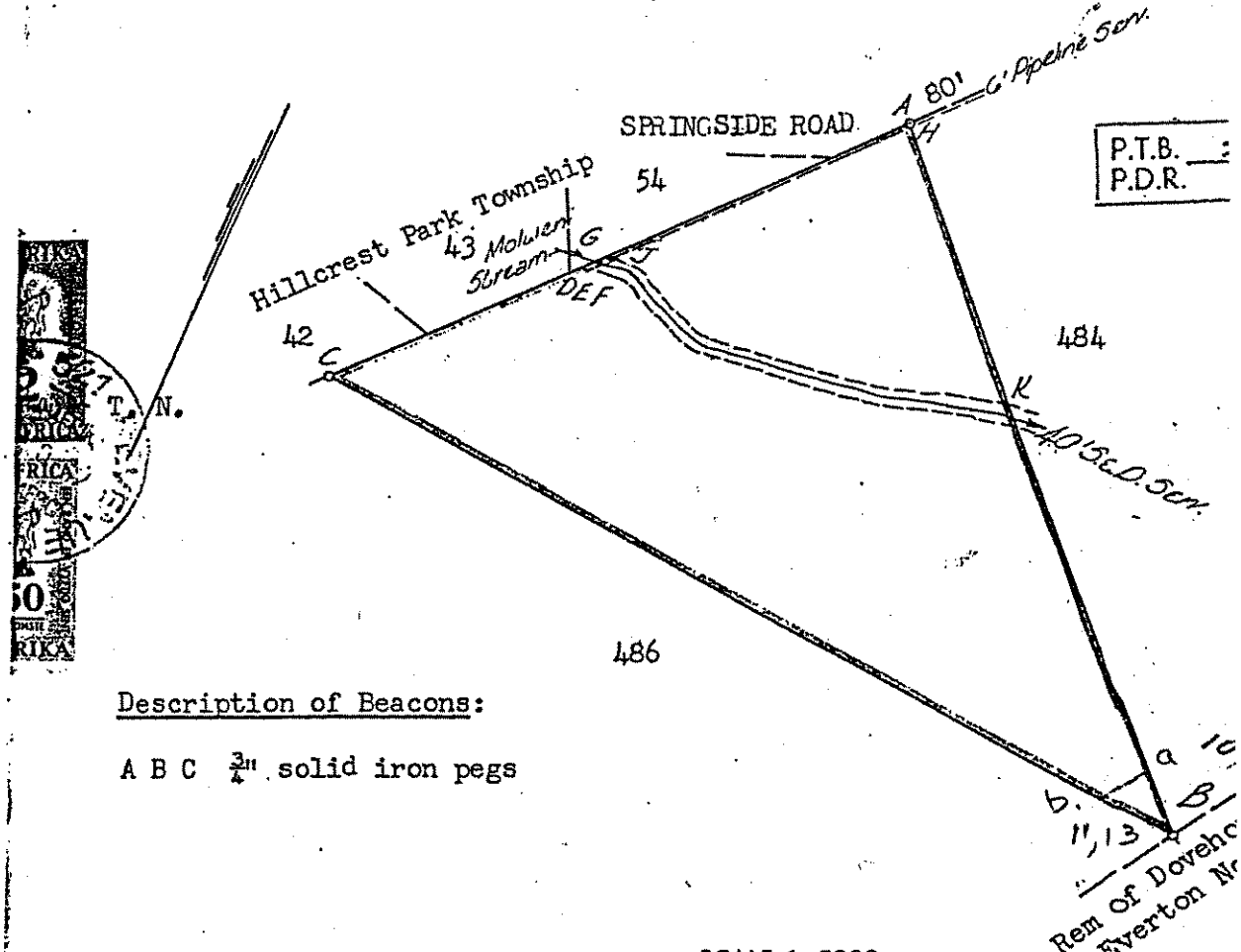

P.T.B. \_\_\_\_\_  
P.D.R. \_\_\_\_\_

Description of Beacons:

A B C  $\frac{3}{4}$ " solid iron pegs

SCALE 1: 5000

The figure A B C  
represents 27.0006 Acres

Sub 485 (a sub of <sup>337</sup> 485) of the farm Albinia No. 957

situate in the County of Durban  
April, 1952 - December, 1953 &  
Surveyed in July, 1962 by me

Rem of Dovehe  
Everton No

|            |  |   |   |
|------------|--|---|---|
| 21-12-1965 | This Diagram relates to <i>Transfer</i><br>No. 17747/65.<br><i>[Signature]</i><br>Registrar of Deeds | Original Diagram is S.G.<br>No. 7436/51<br>Cert.<br>relating to Deed of Reg. Title<br>No. 3776/1952 | File No. 27.<br>Survey Record<br>Compilation A<br>Degree Sheet<br>Tracing<br>General Plan |
|            |  |   |   |

System 10, 31°

S.G.No: 4930/62

| SIDES<br>ENGLISH FEET | ANGLES<br>OF DIRECTION | CO-ORDINATES<br>Constants X |                        |
|-----------------------|------------------------|-----------------------------|------------------------|
|                       |                        | +68,000.00                  | +10,814,000.00         |
| AB 2123.19            | 274.59.10              | A + 2457.49                 | + <sup>08</sup> 200.62 |
| BC 1174.84            | 31.01.20               | B + 342.34                  | + 385.12               |
| CD 297.50             | 39.32.50               | C + 947.85                  | + 1391.92              |
| DE 318.95             | 148.28.50              | D + 1137.27                 | + 1621.32              |
| EF 411.17             | 140.37.30              | E + 1304.01                 | + 1349.43              |
| FG 340.04             | 123.11.30              | F + 1564.85                 | + 1031.59              |
| GH 435.28             | 106.05.10              | G + 1849.41                 | + 845.44               |
| HJ 603.04             | 96.15.20               | H + 2267.65                 | + 724.84               |
| JA 614.81             | 221.46.30              | J + 2867.10                 | + 659.14               |

Approved

*[Signature]*  
Surveyor General  
28.11.1952

P.T.B. 2/16  
P.D.R.

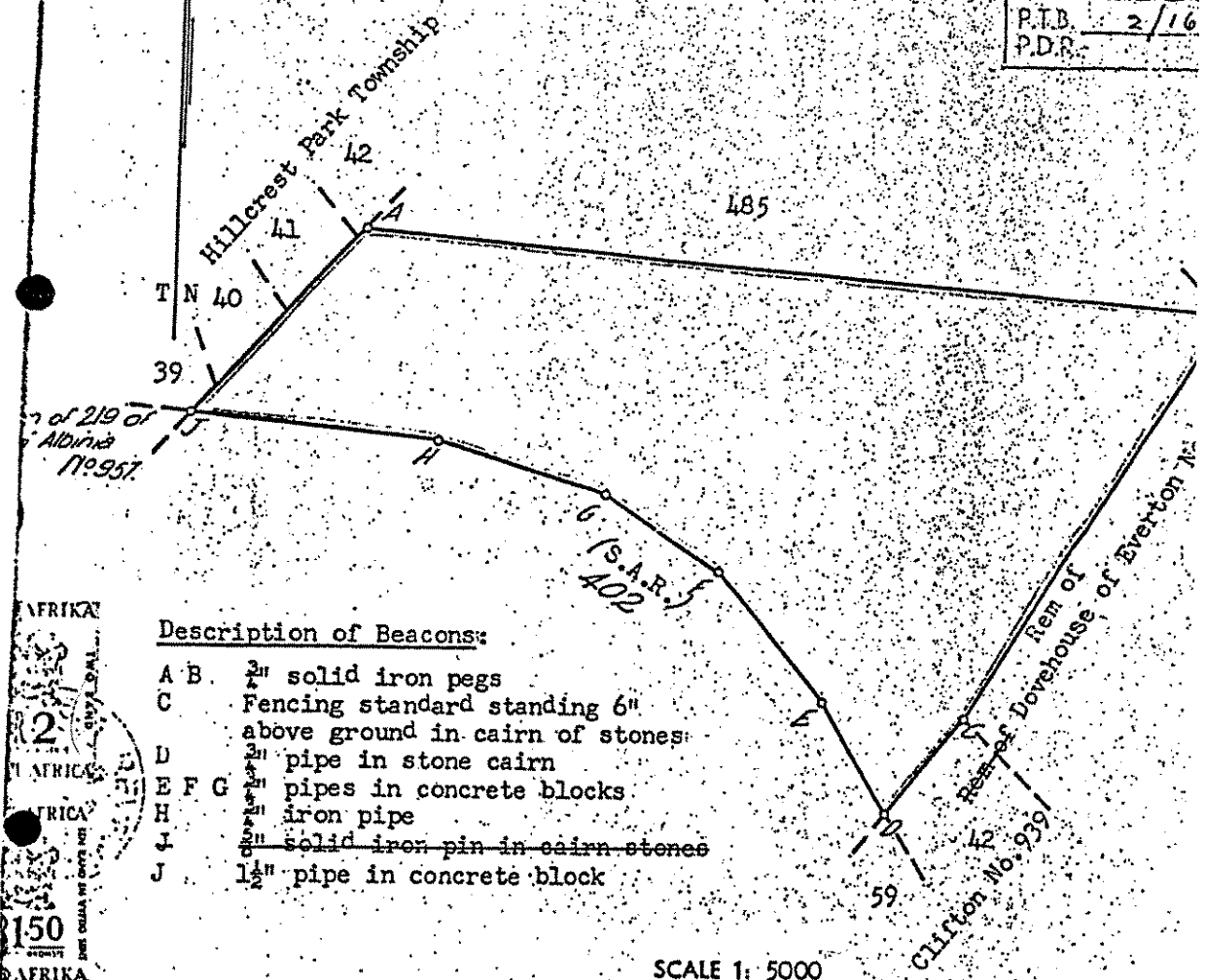

Description of Beacons:

- A B. 3/4" solid iron pegs
- C. Fencing standard standing 6" above ground in cairn of stones
- D. 2 1/2" pipe in stone cairn
- E F G. 2 1/2" pipes in concrete blocks
- H. 2 1/2" iron pipe
- J. 2 1/2" solid iron pin in cairn stones
- J. 1 1/2" pipe in concrete block

SCALE 1: 5000

The figure A B C D E F G H J

represents

36,6461 Acres

of land by

Sub 486 (a sub of <sup>337</sup> 2) of the farm Albinia No. 957

situate in the

County of Durban

Province of Natal

April, 1952 - December, 1953 &

Surveyed in July,

19 62 by me

Land Surveyor

|   |  |   |
|---|--|---|
| This Diagram relates to<br>No. 16401/65<br><i>[Signature]</i><br>Registrar of Deeds | Original Diagram is S.G.<br>No. 7436/51<br>relating to Deed of Reg. Title<br>No. 3776/1952 | File No. 211<br>Survey Record<br>Compilation AB<br>Degree Sheet<br>Tracing<br>General |
|---|--|---|