

RIEKERTS LAAGER 165 JR  
Portion 3



LEEUFONTEIN 188 JR  
Portion 10

LAYOUTPLAN FOR THE SETTLEMENT OF  
**VAALBANK C**  
situated on Portion 3  
of the farm  
RIEKERTS LAAGER  
165 JR  
in DR JS MOROKA LOCAL MUNICIPALITY,  
MPUMALANGA PROVINCE

LOCALITY MAP NOT TO SCALE

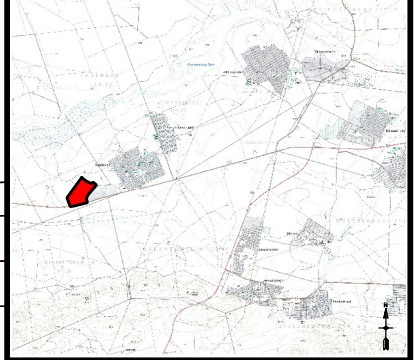

- NOTES:
1. THE TOWNSHIP IS DENOTED BY FIGURE:  
A, B, C, D, E, F, G, H, I, K, L, M, N, P, Q, A.
  2. ALL DIMENSIONS AND AREAS ARE APPROXIMATE AND SUBJECT TO FINAL SURVEY.
  3. STREETS ARE 10m.
  4. CONTOURS ARE IN 20m INTERVALS.
  5. 1 TO 100 YEAR FLOODLINE TO BE DETERMINED.
  6. GEOTECHNICAL SURVEY AND REPORT TO BE DONE.
  7. COORDINATE SYSTEM: Lo 29

LAND USE TABLE:

HATCHING	USE ZONE	NUMBER OF PLOTS	TOTAL AREA (m <sup>2</sup> )	% OF TOWNSHIP AREA	EPF NUMBERS
[Yellow]	RESIDENTIAL 1	476	34.12	68.91	1-476
[Blue]	INSTITUTIONAL	10	4.02	8.08	478-485
[Red]	BUSINESS	6	1.98	2.00	486-488
[Brown]	MUNICIPAL	3	0.88	1.28	484-488
[Green]	PUBLIC OPEN SPACE	4	1.21	2.43	487-490
[White]	ROADS		6.97	16.79	
	TOTAL	500	49.91	100%	

Prepared for:  
**NKANGALA DISTRICT MUNICIPALITY**

Prepared by:  
**SISONKE DEVELOPMENT PLANNERS**  
8 Struik Street  
P.O. Box 2448  
Nelspruit, 1200  
MPUMALANGA PROVINCE  
Tel: 013 - 755 2914 / 4572  
Fax: 013 - 755 2803

IT IS HEREBY CERTIFIED THAT IN ACCORDANCE WITH THE NATIONAL WATER ACT, 1998 (ACT 36 OF 1998) THAT THE LINES ON THIS DRAWING REPRESENT THE MAXIMUM LEVELS THAT WILL PROBABLY BE REACHED DURING A FLOOD WITH A RECURRENCE INTERVAL OF 100 YEARS.

ENGINEER: \_\_\_\_\_ DATE: \_\_\_\_\_  
(P.R. ENG. REG. No. \_\_\_\_\_)

AMENDMENTS

NO.	DESCRIPTION

SCALE: 1:5 000

DATE: \_\_\_\_\_

LOCAL PLAN NUMBER: \_\_\_\_\_

T. Est - Vaalbank C - 01