

Exemption from a Phase 1 Archaeological Impact Assessment for the proposed Bloemside Phase 7 township establishment, Bloemfontein, Free State Province*.

Site: Parts of Farm Rodenbeck 2972 and 2651

Map Ref.: 2926 AB Maselspoort

Site Coordinates: 29°12'2.43"S 26°16'37.59"E

MDA Environmental Consultants requested an archaeological impact assessment for the proposed Bloemside Phase 7 township establishment, Bloemfontein (**Fig. 1 & 2**). After a brief walk-through, it was established that informal residential development and industrial activities (brick-making sites) have noticeably altered the natural condition of the terrain (**Fig. 3 & 4**). Potential archaeological impact resulting from the proposed development is considered non-existent due to the disturbed nature of the area. The affected area is capped by a substantial overburden of geologically recent (Quaternary) alluvial sediments that is extensively disturbed by human activity. It is not considered palaeontologically vulnerable.

It is recommended that the proposed development is exempted from a Phase 1 archaeological impact assessment.

* Report prepared for MDA Environmental Consultants PO Box 20298, Willows 9320 by L. Rossouw, Archaeological Impacts Unit, National Museum Bloemfontein, c/o Aliwal and Charles Street, Bloemfontein 9300.

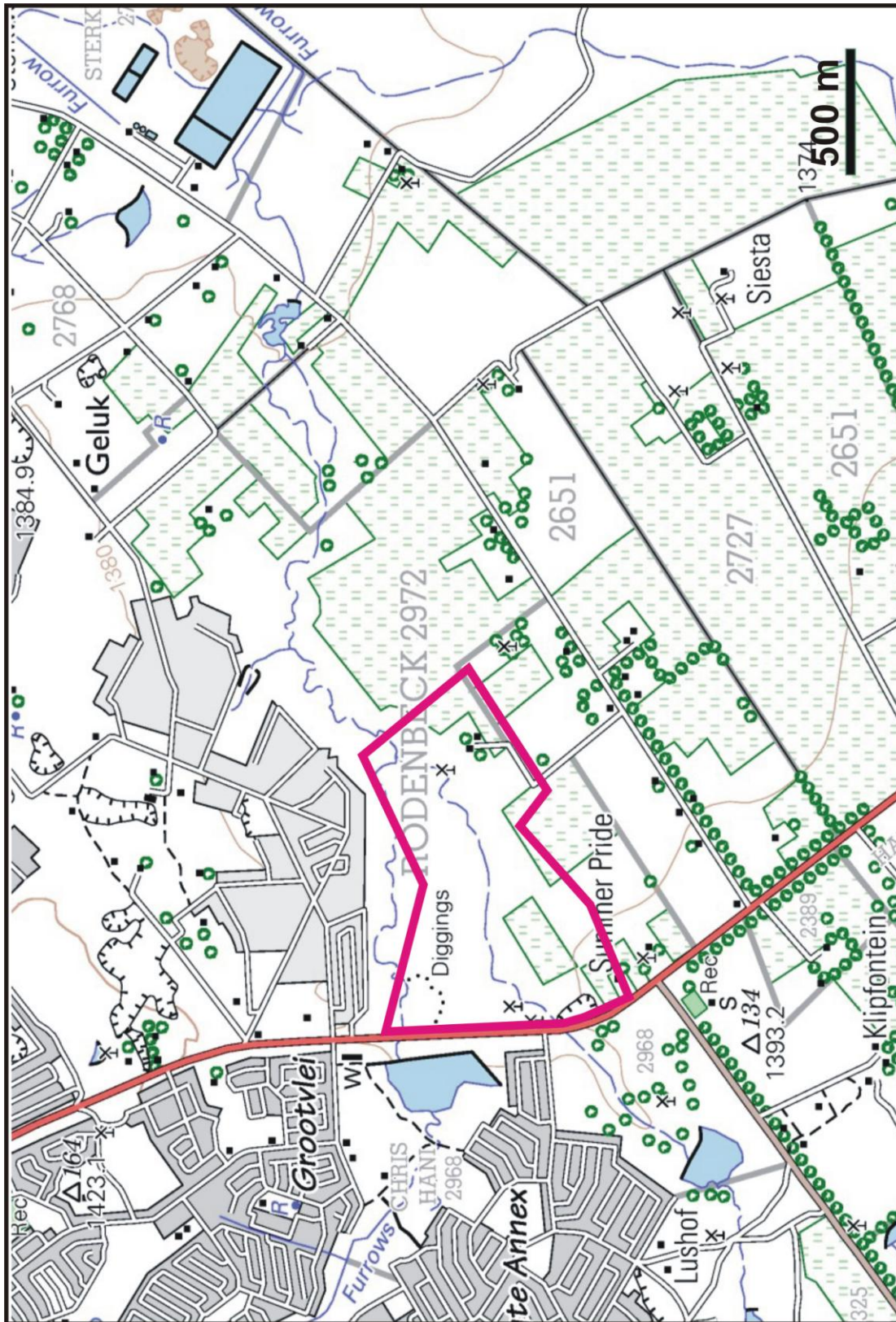

Figure 1. The proposed Bloemside Phase 7 township establishment (portion of 1:50 000 scale topographical map 2926 Maselspoort).



Figure 2. Aerial view of the affected area.



Figure 3. The affected area, looking northeast (above), north (below left) and east (below right).



Figure 4. The site has been impacted by informal residential development and industrial activities (brick-making sites).