



Archaetnos Culture & Cultural
Resource Consultants
BK 98 09854/23

**A REPORT ON A CULTURAL HERITAGE IMPACT ASSESSMENT FOR A
PROPOSED PROSPECTING RIGHTS APPLICATION ON THE FARM
ELANDSFONTEIN 309 JS, CLOSE TO EMALAHLENI, MPUMALANGA
PROVINCE**

For:

GEOVICON
Geovicon@iafrica.com

REPORT NO.: AE01303V

By:

Dr. A.C. van Vollenhoven (L.AKAD.SA.)
Accredited member of ASAPA
Professional member of SASCH

January 2013

Archaetnos
P.O. Box 55
GROENKLOOF
0027
Tel: 083 291 6104
Fax: 086 520 4173
E-mail: antonv@archaetnos.co.za

Member: AC van Vollenhoven BA, BA (Hons), DTO, NDM, MA (Archaeology) [UP], MA (Culture History) [US], DPhil (Archaeology) [UP], Man Dip [TUT], D Phil (History) [US]

SUBMISSION OF REPORT

Please note that the South African Heritage Resources Agency (SAHRA) or one of its subsidiary bodies needs to comment on this report.

It is the client's responsibility to do the submission via the SAHRIS System on the SAHRA website.

Clients are advised not to proceed with any action before receiving the necessary comments from SAHRA.

DISCLAIMER

Although all possible care is taken to identify all sites of cultural importance during the survey of study areas, the nature of archaeological and historical sites are as such that it always is possible that hidden or subterranean sites could be overlooked during the study. Archaetnos and its personnel will not be held liable for such oversights or for costs incurred as a result thereof.

**©Copyright
Archaetnos**

The information contained in this report is the sole intellectual property of Archaetnos CC. It may only be used for the purposes it was commissioned for by the client.

SUMMARY

Archaetnos cc was requested by Geovicon to conduct a cultural heritage impact assessment for a proposed application for prospecting rights on the farm Elandsfontein 309 JS. This is close to Emalahleni in the Mpumalanga Province.

A survey of the available literature was undertaken in order to obtain background information regarding the area. This was followed by the field survey which was conducted according to generally accepted HIA practices, aimed at locating all possible objects, sites and features of cultural significance in the area of the proposed development.

All sites, objects features and structures identified were to be documented according to the general minimum standards accepted by the archaeological profession. Co-ordinates of individual localities were determined by means of a Global Positioning System (GPS). The information was added to photographs and the description in order to facilitate the identification of each locality.

During the survey two sites of cultural heritage significance was located in the area to be developed. These are discussed in the report. One of these is of high cultural significance and will need to be mitigated before the development may continue.

It should be noted however that the subterranean presence of archaeological and/or historical sites, features or artifacts is always a distinct possibility. Care should therefore be taken when the development commences that if any of these are discovered, a qualified archaeologist be called in to investigate.

It should be noted that it is the client's responsibility to do the submission of this report via the SAHRIS System on the SAHRA website. No work on site may commence before receiving the necessary comments from SAHRA.

CONTENTS

	Page
EXECUTIVE SUMMARY	3
CONTENTS.....	4
1. INTRODUCTION	5
2. TERMS OF REFERENCE	7
3. CONDITIONS AND ASSUMPTIONS	7
4. LEGISLATIVE REQUIREMENTS	8
5. THE INTERNATIONAL FINANCE CORPORATIONS' PERFORMANCE STANDARDS FOR CULTURAL HERITAGE	11
6. METHODOLOGY.....	12
7. DESCRIPTION OF THE AREA.....	13
8. HISTORICAL CONTEXT	15
9. DISCUSSION OF SITES IDENTIFIED DURING THE SURVEY .	19
10. CONCLUSIONS AND RECOMMENDATIONS.....	18
11. REFERENCES.....	20
APPENDIX A – DEFENITION OF TERMS.....	22
APPENDIX B – DEFINITION/ STATEMENT OF SIGNIFICANCE	23
APPENDIX C – SIGNIFICANCE AND FIELD RATING	24
APPENDIX D – PROTECTION OF HERITAGE RESOURCES.....	25
APPENDIX E – HERITAGE MANAGEMENT IMPACT ASSESSMENT PHASES	26

1. INTRODUCTION

Archaetnos cc was requested by Geovicon to conduct a cultural heritage impact assessment for a proposed application for prospecting rights. The study area consisted of portion 2, 6 and 7 of the remainder of the farm Elandsfontein 309 JS. This is close to Emalahleni (Witbank) in the Mpumalanga Province (Figure 1-4).

The project is aimed at the eventual mining of coal. Accordingly no mine plan is yet available. The client indicated the area where the proposed development is to take place. The field survey was confined to this area.



Figure 1 Location of the town of Emalahleni in Mpumalanga. North reference is to the top of the map.



Figure 2 Location of the site in relation to Emalahleni. North reference is to the top.

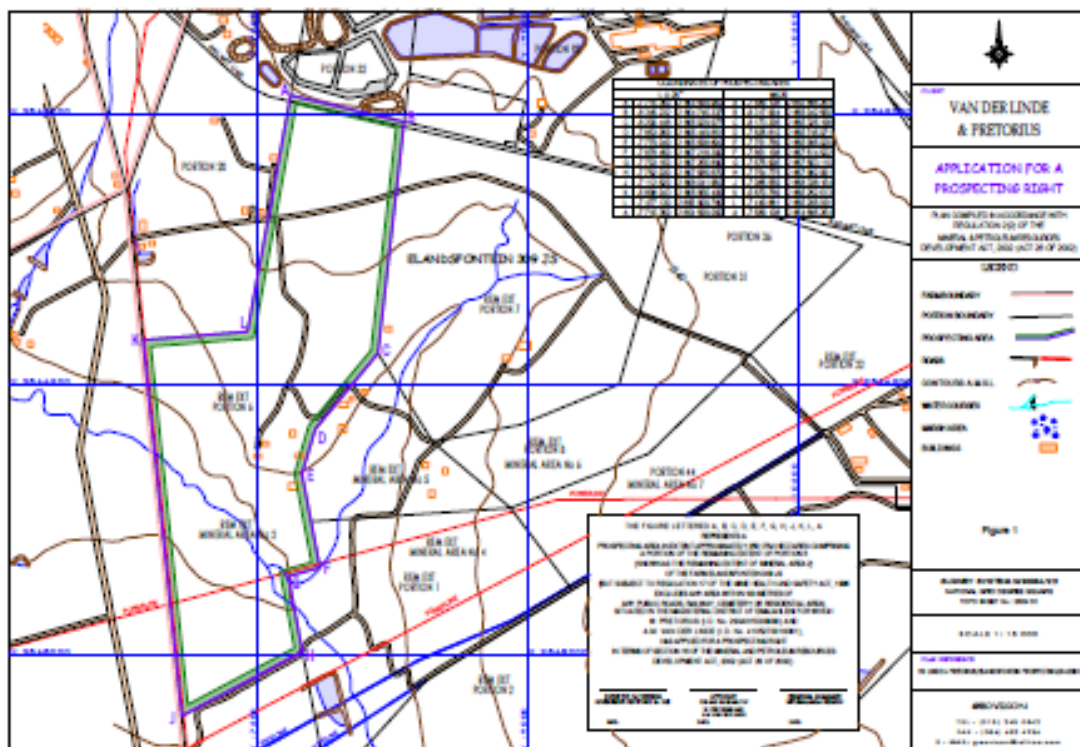

Figure 3 Map of the surveyed area.

2. TERMS OF REFERENCE

The Terms of Reference for the survey were to:

1. Identify objects, sites, occurrences and structures of an archaeological or historical nature (cultural heritage sites) located on the property (see Appendix A).
2. Study background information on the area to be developed.
3. Assess the significance of the cultural resources in terms of their archaeological, historical, scientific, social, religious, aesthetic and tourism value (see Appendix B).
4. Describe the possible impact of the proposed development on these cultural remains, according to a standard set of conventions.
5. Recommend suitable mitigation measures to minimize possible negative impacts on the cultural resources by the proposed development.
6. Review applicable legislative requirements.

3. CONDITIONS & ASSUMPTIONS

The following conditions and assumptions have a direct bearing on the survey and the resulting report:

1. Cultural Resources are all non-physical and physical man-made occurrences, as well as natural occurrences associated with human activity (Appendix A). These include all sites, structure and artifacts of importance, either individually or in groups, in the history, architecture and archaeology of human (cultural) development. Graves and cemeteries are included in this.
2. The significance of the sites, structures and artifacts is determined by means of their historical, social, aesthetic, technological and scientific value in relation to their uniqueness, condition of preservation and research potential. The various aspects are not mutually exclusive, and the evaluation of any site is done with reference to any number of these aspects.
3. Cultural significance is site-specific and relates to the content and context of the site. Sites regarded as having low cultural significance have already been recorded in full and require no further mitigation. Sites with medium cultural significance may or may not require mitigation depending on other factors such as the significance of impact on the site. Sites with a high cultural significance require further mitigation (see Appendix C).

4. The latitude and longitude of any archaeological or historical site or feature, is to be treated as sensitive information by the developer and should not be disclosed to members of the public.
5. All recommendations are made with full cognizance of the relevant legislation.
6. It has to be mentioned that it is almost impossible to locate all the cultural resources in a given area, as it will be very time consuming. Developers should however note that the report should make it clear how to handle any other finds that might occur. In this case certain patches within the surveyed area were densely vegetated which affected archaeological visibility.

4. LEGISLATIVE REQUIREMENTS

Aspects concerning the conservation of cultural resources are dealt with mainly in two acts. These are the National Heritage Resources Act (Act 25 of 1999) and the National Environmental Management Act (Act 107 of 1998).

4.1 The National Heritage Resources Act

According to the above-mentioned act the following is protected as cultural heritage resources:

- a. Archaeological artifacts, structures and sites older than 100 years
- b. Ethnographic art objects (e.g. prehistoric rock art) and ethnography
- c. Objects of decorative and visual arts
- d. Military objects, structures and sites older than 75 years
- e. Historical objects, structures and sites older than 60 years
- f. Proclaimed heritage sites
- g. Grave yards and graves older than 60 years
- h. Meteorites and fossils
- i. Objects, structures and sites of scientific or technological value.

The national estate (see Appendix D) includes the following:

- a. Places, buildings, structures and equipment of cultural significance
- b. Places to which oral traditions are attached or which are associated with living heritage
- c. Historical settlements and townscapes
- d. Landscapes and features of cultural significance
- e. Geological sites of scientific or cultural importance
- f. Archaeological and paleontological importance
- g. Graves and burial grounds
- h. Sites of significance relating to the history of slavery
- i. Movable objects (e.g. archaeological, paleontological, meteorites, geological specimens, military, ethnographic, books etc.)

A Heritage Impact Assessment (HIA) is the process to be followed in order to determine whether any heritage resources are located within the area to be developed as well as the possible impact of the proposed development thereon. An Archaeological Impact Assessment only looks at archaeological resources. The different phases during the HIA process are described in Appendix E. An HIA must be done under the following circumstances:

- a. The construction of a linear development (road, wall, power line canal etc.) exceeding 300m in length
- b. The construction of a bridge or similar structure exceeding 50m in length
- c. Any development or other activity that will change the character of a site and exceed 5 000m² or involve three or more existing erven or subdivisions thereof
- d. Re-zoning of a site exceeding 10 000 m²
- e. Any other category provided for in the regulations of SAHRA or a provincial heritage authority

Structures

Section 34 (1) of the mentioned act states that no person may demolish any structure or part thereof which is older than 60 years without a permit issued by the relevant provincial heritage resources authority.

A structure means any building, works, device or other facility made by people and which is fixed to land, and includes any fixtures, fittings and equipment associated therewith.

Alter means any action affecting the structure, appearance or physical properties of a place or object, whether by way of structural or other works, by painting, plastering or the decoration or any other means.

Archaeology, palaeontology and meteorites

Section 35(4) of this act deals with archaeology, palaeontology and meteorites. The act states that no person may, without a permit issued by the responsible heritage resources authority (national or provincial):

- a. destroy, damage, excavate, alter, deface or otherwise disturb any archaeological or paleontological site or any meteorite;
- b. destroy, damage, excavate, remove from its original position, collect or own any archaeological or paleontological material or object or any meteorite;
- c. trade in, sell for private gain, export or attempt to export from the Republic any category of archaeological or paleontological material or object, or any meteorite; or
- d. bring onto or use at an archaeological or paleontological site any excavation equipment or any equipment that assists in the detection or

- recovery of metals or archaeological and paleontological material or objects, or use such equipment for the recovery of meteorites.
- e. alter or demolish any structure or part of a structure which is older than 60 years as protected.

The above mentioned may only be disturbed or moved by an archaeologist, after receiving a permit from the South African Heritage Resources Agency (SAHRA). In order to demolish such a site or structure, a destruction permit from SAHRA will also be needed.

Human remains

Graves and burial grounds are divided into the following:

- a. ancestral graves
- b. royal graves and graves of traditional leaders
- c. graves of victims of conflict
- d. graves designated by the Minister
- e. historical graves and cemeteries
- f. human remains

In terms of Section 36(3) of the National Heritage Resources Act, no person may, without a permit issued by the relevant heritage resources authority:

- a. destroy, damage, alter, exhume or remove from its original position or otherwise disturb the grave of a victim of conflict, or any burial ground or part thereof which contains such graves;
- b. destroy, damage, alter, exhume or remove from its original position or otherwise disturb any grave or burial ground older than 60 years which is situated outside a formal cemetery administered by a local authority; or
- c. bring onto or use at a burial ground or grave referred to in paragraph (a) or (b) any excavation, or any equipment which assists in the detection or recovery of metals.

Unidentified/unknown graves are also handled as older than 60 until proven otherwise.

Human remains that are less than 60 years old are subject to provisions of the Human Tissue Act (Act 65 of 1983) and to local regulations. Exhumation of graves must conform to the standards set out in the **Ordinance on Excavations (Ordinance no. 12 of 1980)** (replacing the old Transvaal Ordinance no. 7 of 1925).

Permission must also be gained from the descendants (where known), the National Department of Health, Provincial Department of Health, Premier of the Province and local police. Furthermore, permission must also be gained from the various landowners (i.e. where the graves are located and where they are to be relocated) before exhumation can take place. Human remains can only be handled by a

registered undertaker or an institution declared under the **Human Tissues Act (Act 65 of 1983 as amended)**.

4.2 The National Environmental Management Act

This act (Act 107 of 1998) states that a survey and evaluation of cultural resources must be done in areas where development projects, that will change the face of the environment, will be undertaken. The impact of the development on these resources should be determined and proposals for the mitigation thereof are made.

Environmental management should also take the cultural and social needs of people into account. Any disturbance of landscapes and sites that constitute the nation's cultural heritage should be avoided as far as possible and where this is not possible the disturbance should be minimized and remedied.

5. THE INTERNATIONAL FINANCE CORPORATIONS' PERFORMANCE STANDARD FOR CULTURAL HERITAGE

This standard recognizes the importance of cultural heritage for current and future generations. It aims to ensure that clients protect cultural heritage in the course of their project activities.

This is done by clients abiding to the law and having heritage surveys done in order to identify and protect cultural heritage resources via field studies and the documentation of such resources. These need to be done by competent professionals (e.g. archaeologists and cultural historians). Possible chance finds, encountered during the project development, also needs to be managed by not disturbing it and by having it assessed by professionals.

Impacts on the cultural heritage should be minimized. This include the possible maintenance of such sites in situ, or when impossible, the restoration of the functionality of the cultural heritage in a different location. When cultural historical and archaeological artifacts and structures need to be removed is should be done by professionals and by abiding to the applicable legislation. The removal of cultural heritage resources may however only be considered if there are no technically or financially feasible alternatives. In considering the removal of cultural resources, it should be outweighed by the benefits of the overall project to the effected communities. Again professionals should carry out the work and adhere to the best available techniques.

Consultation with affected communities should be engaged in. This entails that access to such communities should be granted to their cultural heritage if this is applicable. Compensation for the loss of cultural heritage should only be given in extra-ordinary circumstances.

Critical cultural heritage may not be impacted on. Professionals should be used to advise on the assessment and protection thereof. Utilization of cultural heritage resources should always be done in consultation with the effected communities in

order to be consistent with their customs and traditions and to come to agreements with relation to possible equitable sharing of benefits from commercialization.

6. METHODOLOGY

6.1 Survey of literature

A survey of literature was undertaken in order to obtain background information regarding the area. Sources consulted in this regard are indicated in the bibliography.

6.2 Field survey

The survey was conducted according to generally accepted HIA practices and was aimed at locating all possible objects, sites and features of cultural significance in the area of proposed development. One regularly looks a bit wider than the demarcated area, as the surrounding context needs to be taken into consideration.

If required, the location/position of any site was determined by means of a Global Positioning System (GPS)¹, while photographs were also taken where needed. The survey was undertaken by a physical survey via off-road vehicle and on foot (Figure 4). Four hours were spent in the field.



Figure 4 GPS track of the surveyed area. North reference is to the top.

¹ A Garmin Oregon 550 with an accuracy factor of a few meters.

6.3 Oral histories

People from local communities are interviewed in order to obtain information relating to the surveyed area. It needs to be stated that this is not applicable under all circumstances. When applicable, the information is included in the text and referred to in the bibliography.

6.4 Documentation

All sites, objects features and structures identified were documented according to the general minimum standards accepted by the archaeological profession. Co-ordinates of individual localities were determined by means of the Global Positioning System (GPS). The information was added to the description in order to facilitate the identification of each locality.

6.5 Evaluation of Heritage sites

The evaluation of heritage sites is done by giving a field rating of each (see Appendix C) using the following criteria:

- The unique nature of a site
- The integrity of the archaeological deposit
- The wider historic, archaeological and geographic context of the site
- The location of the site in relation to other similar sites or features
- The depth of the archaeological deposit (when it can be determined or is known)
- The preservation condition of the site
- Uniqueness of the site and
- Potential to answer present research questions.

7. DESCRIPTION OF THE AREA

The portions of the farm Elandsfontein on which the survey was carried out, has been disturbed to a large extent by recent human activities. In certain areas the grass cover is fairly short, but in others it is reasonably long and quite dense (Figure 5). Accordingly the archaeological visibility varies between reasonable in the north to bad in the south. A few trees, mainly alien species were identified. Almost the entire farm was ploughed in the past. The western portion still hosts maize fields (Figure 6).

The farm now is mostly used for cattle grazing. The southern part thereof, on the opposite side of a marshland, is used for sand mining. The mentioned marshland covers a large stretch in the south.

The topography is fairly even with a slight fall towards the marshland in the south. A number of fountains used to exist on the farm, but these have dried up in recent

years, mostly due to mining activities on adjacent farms. A few rock outcrops are visible.



Figure 5 General view of the surveyed area.



Figure 6 Another view of the surveyed area showing maize crops.

8. HISTORICAL CONTEXT

Two sites of cultural heritage significance were located in the surveyed area. In order to enable the reader to understand these, the history of the broader geographical area as well as possible finds that could be unearthed during construction activities, it is necessary to give a background regarding the different phases of human history.

8.1 Stone Age

The Stone Age is the period in human history when lithic material was mainly used to produce tools (Coertze & Coertze 1996: 293). In South Africa the Stone Age can be divided in three periods. It is, however, important to note that dates are relative and only provide a broad framework for interpretation. The division for the Stone Age according to Korsman & Meyer (1999: 93-94) is as follows:

Early Stone Age (ESA) 2 million – 150 000 years ago
Middle Stone Age (MSA) 150 000 – 30 000 years ago
Late Stone Age (LSA) 40 000 years ago – 1850 - A.D.

No Stone Age sites are indicated on a map contained in a historical atlas of this area (Bergh 1999: 4). The closest known Stone Age occurrence to the surveyed area, is that of rock art close to the Olifants River to the south of Witbank (Bergh 1999: 5). This however should rather be seen as a lack of research in the area and not as an indication that such features does not occur.

However, no natural shelters were seen during the survey and therefore it is possible that these people did not stay here for long times. The close vicinity of water sources and ample grazing would have made it a prime spot for hunting and obtaining water during the past. Therefore one may assume that Stone Age people probably would have moved through the area. In fact, some Middle Stone Age artifacts were identified out of context, within the study area.

8.2 Iron Age

The Iron Age is the name given to the period of human history when metal was mainly used to produce metal artifacts (Coertze & Coertze 1996: 346). In South Africa it can be divided in two separate phases according to Van der Ryst & Meyer (1999: 96-98), namely:

Early Iron Age (EIA) 200 – 1000 A.D.
Late Iron Age (LIA) 1000 – 1850 A.D.

Huffman (2007: xiii) however, indicates that a Middle Iron Age should be included. His dates, which now seem to be widely accepted in archaeological circles, are:

Early Iron Age (EIA) 250 – 900 A.D.
Middle Iron Age (MIA) 900 – 1300 A.D.
Late Iron Age (LIA) 1300 – 1840 A.D.

No Iron Age sites are indicated in a historical atlas around the town of Witbank, but this may only indicate a lack of research. The closest known Iron Age occurrences to the surveyed area are Late Iron Age sites that have been identified to the west of Bronkhorstspuit and in the vicinity of Bethal (Bergh 1999: 7-8). Late Iron Age sites were however identified during a previous survey on the farm Middelburg Town and Townlands 287 JS (Archaetnos database).

The good grazing and access water in the area would have provided a good environment for Iron Age people although building material seem to be reasonably scarce. One would therefore expect that Iron Age people may have utilized the area. This is the same reason why white settlers moved into this environment later on.

8.3 Historical Age

The Historical Age started with the first recorded oral histories in the area. It includes the in-migration of people that were able to read and write. The first white people to move through this area were the party of the traveler, Robert Scoon who passed through during 1836 (Bergh 1999: 13). Although the Voortrekkers moved across the Vaal River during the 1830's, it seems as if white people only settled here after 1850 (Bergh 1999: 14-15).

During the Anglo-Boer War (1899-1902) there was a battle on the farm Donkerhoek only a few kilometers to the west of where the development is to take place. The battle lasted between 11 and 12 June 1900. Other skirmishes also took place here during this war (Bergh 1999: 52-53). Blockhouses were also erected in the vicinity by the British (Van Vollenhoven & Van den Bos 1997: 42-46). One may therefore expect to find farm buildings and objects as well as artifacts related to the Anglo-Boer War during construction activities.

9. DISCUSSION OF SITES FOUND DURING THE SURVEY

Two sites of cultural heritage importance were identified. Both date to the Historical Age. It seems as if only site no. 2 is to be impacted on by the development and needs to be mitigated.

As indicated there always is a possibility that some sites may have been missed. In such a case it should be handled in accordance with the recommendations in this report.

9.1 Site 1 – historical farm house

This is a farm house that was built in 1901 (Personal communication: Mr. Peet van der Linde). The house has been changed over the years and does not contain much of the original fabric (Figure 7).

GPS: 25°54.605'S
29°04.518'E

Therefore, although the house is older than 60 years, it only is regarded as having a **low** cultural significance. It received a field rating of General Protection C (IVC). This report is seen as ample mitigation and the buildings may therefore be demolished, if necessary.

It is most likely not necessary as the coal seam does not go this far. However should it be demolished, a permit needs to be acquired from the Provincial Heritage Resources Agency of Mpumalanga.



Figure 7 The farm house.

9.2 Site 2 – Grave yard

This is a site containing at least 63 graves (Figure 8). Two of these have granite borders and headstones. Some are stone packed with or without stone headstones. A few have brick borders, but most have cement borders and headstones.

Not many of the graves have legible information. Surnames identified include Sikhosana, Rankune and Khumalo. Dates identified vary between 1918 and 1998. Most of the graves have no dates of death indicated. Therefore three categories of graves exist being those older than 60 years, those younger than 60 years and unknown graves.

GPS: 25°54.443'S
29°04.633'E

Graves are always regarded as having a **high** cultural significance. The field rating thereof is Local Grade III B. It should be included in the heritage register, but may

be mitigated. It therefore is important that the mine should indicate whether indeed there will be an impact on the graves.

Two possibilities exist. The first option would be to fence the graves in and have a management plan drafted for the sustainable preservation thereof. This should be written by a heritage expert.

The second option is to exhume the mortal remains and then to have it relocated. For this a specific procedure should be followed which includes social consultation. For graves younger than 60 years only an undertaker is needed. For those older than 60 years and unknown graves an undertaker and archaeologist is needed. Permits should be obtained from the Burial Grounds and Graves unit of SAHRA. This procedure is quite lengthy.



Figure 8 Some of the graves found at site no. 2.

10. CONCLUSION AND RECOMMENDATIONS

Two sites of cultural importance were identified during the survey (Figure 13). The survey of the indicated area was completed successfully.

The following is recommended:

- The proposed development may continue, but only after implementation of the management measures indicated in this report.

- Site no. 1, the ruins of buildings may be demolished, if needed. For this a destruction permit should be obtained from the Provincial Heritage Resources Agency of the Mpumalanga Province.
- Site no. 2, the graves, should be mitigated. It should be included in the heritage register.
- It therefore is important that the mine should indicate whether indeed there will be an impact on the graves so that the correct option is chosen.
- The first option would be to fence the graves in and have a management plan drafted for the sustainable preservation thereof. This should be written by a heritage expert.
- The second option is to exhume the mortal remains and then to have it relocated. For this a specific procedure should be followed which includes social consultation. For graves younger than 60 years only an undertaker is needed. For those older than 60 years and unknown graves an undertaker and archaeologist is needed. Permits should be obtained from the Burial Grounds and Graves unit of SAHRA.
- It should be noted that the subterranean presence of archaeological and/or historical sites, features or artifacts is always a distinct possibility. Care should therefore be taken when development commences that if any of these are discovered, a qualified archaeologist be called in to investigate the occurrence.



Figure 13 Google image indicating the sites found during the survey.

11. REFERENCES

Archaetnos database.

Bergh, J.S. (red.). 1999. **Geskiedenisatlas van Suid-Afrika. Die vier noordelike provinsies.** Pretoria: J.L. van Schaik.

Coertze, P.J. & Coertze, R.D. 1996. **Verklarende vakwoordeboek vir Antropologie en Argeologie.** Pretoria: R.D. Coertze.

Huffman, T.N. 2007. **Handbook to the Iron Age: The Archaeology of Pre-Colonial Farming Societies in Southern Africa.** Scottsville: University of KwaZulu-Natal Press.

International Finance Corporation. 2012. **Overview of performance standards on Environmental and Social Sustainability. Performance Standard 8, Cultural Heritage.** World Bank Group.

Knudson, S.J. 1978. **Culture in retrospect.** Chicago: Rand McNally College Publishing Company.

Korsman, S.A. & Meyer, A. 1999. Die Steentydperk en rotskuns. Bergh, J.S. (red.). **Geskiedenisatlas van Suid-Afrika. Die vier noordelike provinsies.** Pretoria: J.L. van Schaik.

Republic of South Africa. 1980. Ordinance on Excavations (**Ordinance no. 12 of 1980**). The Government Printer: Pretoria.

- Republic of South Africa. 1983. **Human Tissue Act** (Act 65 of 1983). The Government Printer: Pretoria.
- Republic of South Africa. 1999. **National Heritage Resources Act** (No 25 of 1999). Pretoria: the Government Printer.
- Republic of South Africa. 1998. **National Environmental Management Act** (no 107 of 1998). Pretoria: The Government Printer.
- Van der Ryst, M.M. & Meyer, A. 1999. Die Ystertydperk. Bergh, J.S. (red.). **Geskiedenisatlas van Suid-Afrika. Die vier noordelike provinsies.** Pretoria: J.L. van Schaik.
- Van Vollenhoven, A.C. & Van den Bos 1997. **'n Kultuurhulpbronstudie van die Britse blokhuisstelsel van die tweede Anglo-Boereoorlog (1899-1902) in die voormalige Transvaal (Zuid-Afrikaansche Republiek).** (Unpublished report, Pretoria, National Cultural History Museum).

APPENDIX A

DEFINITION OF TERMS:

Site: A large place with extensive structures and related cultural objects. It can also be a large assemblage of cultural artifacts, found on a single location.

Structure: A permanent building found in isolation or which forms a site in conjunction with other structures.

Feature: A coincidental find of movable cultural objects.

Object: Artifact (cultural object).

(Also see Knudson 1978: 20).

APPENDIX B

DEFINITION/ STATEMENT OF HERITAGE SIGNIFICANCE:

- Historic value: Important in the community or pattern of history or has an association with the life or work of a person, group or organization of importance in history.
- Aesthetic value: Important in exhibiting particular aesthetic characteristics valued by a community or cultural group.
- Scientific value: Potential to yield information that will contribute to an understanding of natural or cultural history or is important in demonstrating a high degree of creative or technical achievement of a particular period
- Social value: Have a strong or special association with a particular community or cultural group for social, cultural or spiritual reasons.
- Rarity: Does it possess uncommon, rare or endangered aspects of natural or cultural heritage.
- Representivity: Important in demonstrating the principal characteristics of a particular class of natural or cultural places or object or a range of landscapes or environments characteristic of its class or of human activities (including way of life, philosophy, custom, process, land-use, function, design or technique) in the environment of the nation, province region or locality.

APPENDIX C

SIGNIFICANCE AND FIELD RATING:

Cultural significance:

- Low A cultural object being found out of context, not being part of a site or without any related feature/structure in its surroundings.
- Medium Any site, structure or feature being regarded less important due to a number of factors, such as date and frequency. Also any important object found out of context.
- High Any site, structure or feature regarded as important because of its age or uniqueness. Graves are always categorized as of a high importance. Also any important object found within a specific context.

Heritage significance:

- Grade I Heritage resources with exceptional qualities to the extent that they are of national significance
- Grade II Heritage resources with qualities giving it provincial or regional importance although it may form part of the national estate
- Grade III Other heritage resources of local importance and therefore worthy of conservation

Field ratings:

- i. National Grade I significance should be managed as part of the national estate
- ii. Provincial Grade II significance should be managed as part of the provincial estate
- iii. Local Grade IIIA should be included in the heritage register and not be mitigated (high significance)
- iv. Local Grade IIIB should be included in the heritage register and may be mitigated (high/ medium significance)
- v. General protection A (IV A) site should be mitigated before destruction (high/ medium significance)
- vi. General protection B (IV B) site should be recorded before destruction (medium significance)
- vii. General protection C (IV C) phase 1 is seen as sufficient recording and it may be demolished (low significance)

APPENDIX D

PROTECTION OF HERITAGE RESOURCES:

Formal protection:

National heritage sites and Provincial heritage sites – grade I and II

Protected areas - an area surrounding a heritage site

Provisional protection – for a maximum period of two years

Heritage registers – listing grades II and III

Heritage areas – areas with more than one heritage site included

Heritage objects – e.g. archaeological, palaeontological, meteorites, geological specimens, visual art, military, numismatic, books, etc.

General protection:

Objects protected by the laws of foreign states

Structures – older than 60 years

Archaeology, palaeontology and meteorites

Burial grounds and graves

Public monuments and memorials

APPENDIX E

HERITAGE IMPACT ASSESSMENT PHASES

1. Pre-assessment or scoping phase – establishment of the scope of the project and terms of reference.
2. Baseline assessment – establishment of a broad framework of the potential heritage of an area.
3. Phase I impact assessment – identifying sites, assess their significance, make comments on the impact of the development and makes recommendations for mitigation or conservation.
4. Letter of recommendation for exemption – if there is no likelihood that any sites will be impacted.
5. Phase II mitigation or rescue – planning for the protection of significant sites or sampling through excavation or collection (after receiving a permit) of sites that may be lost.
6. Phase III management plan – for rare cases where sites are so important that development cannot be allowed.