

REVISION STATUS				
Rev.	Date	Description	By	Checked
01	03.05.2022	window and doors revised	PP	NS
02	06.06.2022	revised as per meeting with the QS on 31.05.2022	PP	NS/SM

- GENERAL NOTES:**
- CHECK ALL DIMENSIONS AND LEVELS BEFORE COMMENCING ANY WORK.
 - DO NOT SCALE FROM THE DRAWINGS.
 - ANY QUERIES TO BE BROUGHT TO THE ARCHITECT'S ATTENTION.
 - ALL STRUCTURAL STEEL, CONCRETE STRENGTH AND TIMBER SPECIFICATION ARE TO BE IN ACCORDANCE WITH ENGINEER'S DETAILS.
 - DRAWINGS FOR INFORMATION PURPOSES ONLY

CLIENT
 The Department of Public Works
 455A Jan Smuts Highway
 Mayville
 Durban
 4001

Tel: 060 554 3053
 Email: nqobile.cele@kznpworks.gov.za



PRINCIPAL AGENT AND ARCHITECTS
 RMA Architects
 346 Che Guevara Road
 Glenwood
 Durban
 4001

Tel: 031 201 5173
 E-mail: nishara.rma@gmail.com



QUANTITY SURVEYOR
 LDM QUANTITY SURVEYORS
 21 W Riding Road
 Sherwood
 Durban
 4001

Tel: 031 207 1340
 Email: ikhwela@ldm.co.za



ELECTRICAL ENGINEER
 Matla Consulting Engineers
 11 Sinembe Crescent
 Somerset Park
 Umhlanga
 4051

Tel: 031 566 2800
 Email: deon@matlaeng.com



STRUCTURAL AND CIVIL ENGINEERS
 Dartingo Consulting Engineers
 64 Underwood Road
 Halton Estate
 Pinetown
 3610

Tel: 031 266 0903
 Email: premesh@dartingo.co.za



MECHANICAL ENGINEER
 Muteo Consulting
 39 Grobler Street
 Polokwane
 0750

Tel: 012 664 6577
 Email: arinaon@muteo.co.za



PROJECT NAME: MLB BUILDING

ROOF REPLACEMENT AND RENOVATIONS TO THE MLB BUILDING

ERF NO : ERF 106 OF DURBAN & 107 OF DURBAN

DRAWING TITLE: FIRST FLOOR PLAN

DRAWN BY	PP
CHECKED BY	NS/TRW
DATE	22 APRIL 2022
LATEST ISSUE	06 JUNE 2022
SCALE	AS SHOWN

PROJ. NO :	DWG NO.	REV NO.
MLB BUILDING	MLB.SP.004	R.02

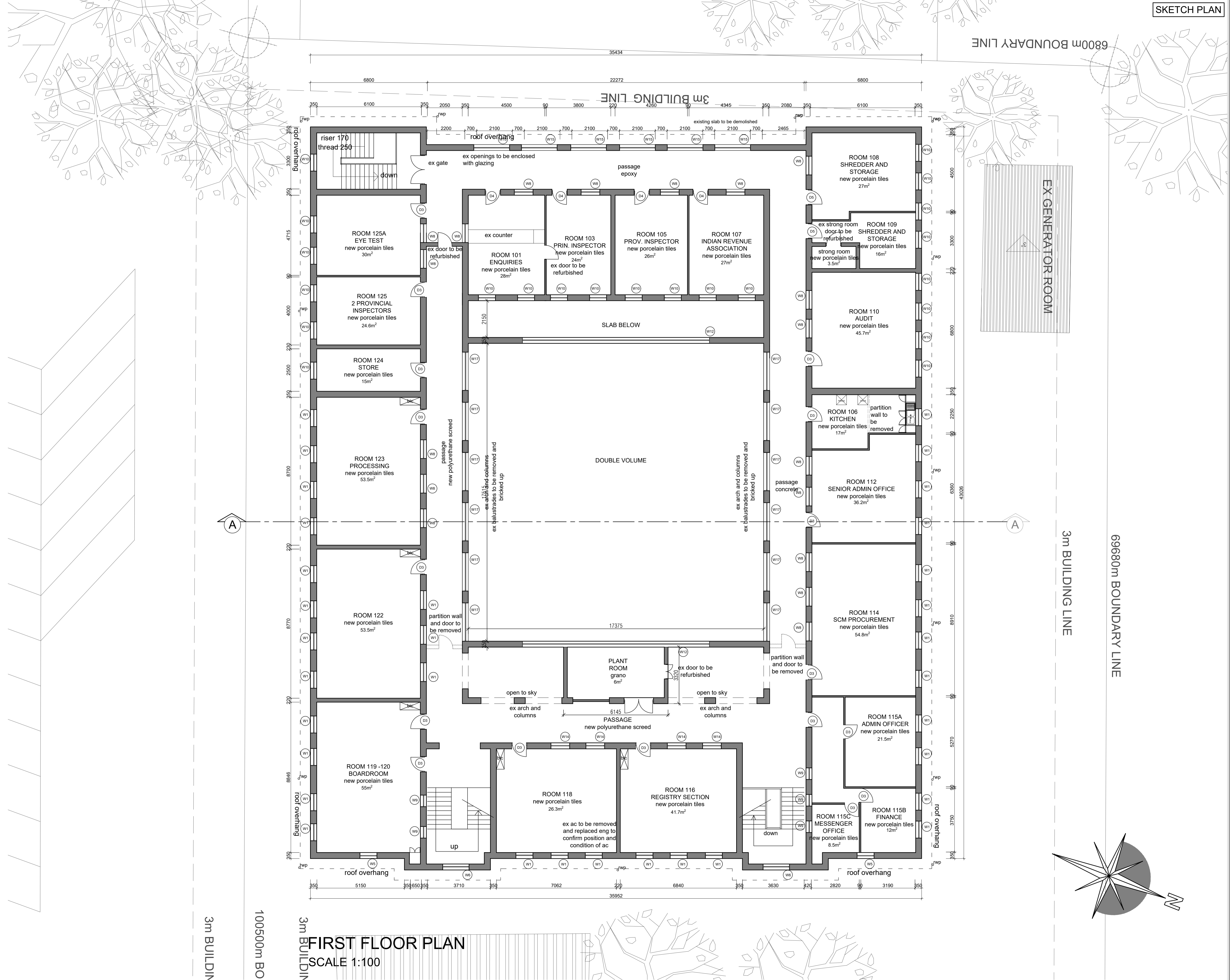

FIRST FLOOR PLAN
 SCALE 1:100