

Copyright over all designs and drawings shall remain the property of the author and any provision to the contrary in terms of the copyright act no.63 of 1965 is hereby specifically excluded.

All relevant details, levels and dimensions are to be checked on site prior to commencement of work.

Any discrepancies are to be brought to the attention of the architect.

The architectural professional accepts no responsibility for errors resulting from misinterpretation of the drawings.

All work to be carried out strictly in accordance with the national building regulations and local authority regulations.

All dimensions are given in millimetres.

Do not scale the drawing.

EXISTING LAYOUT

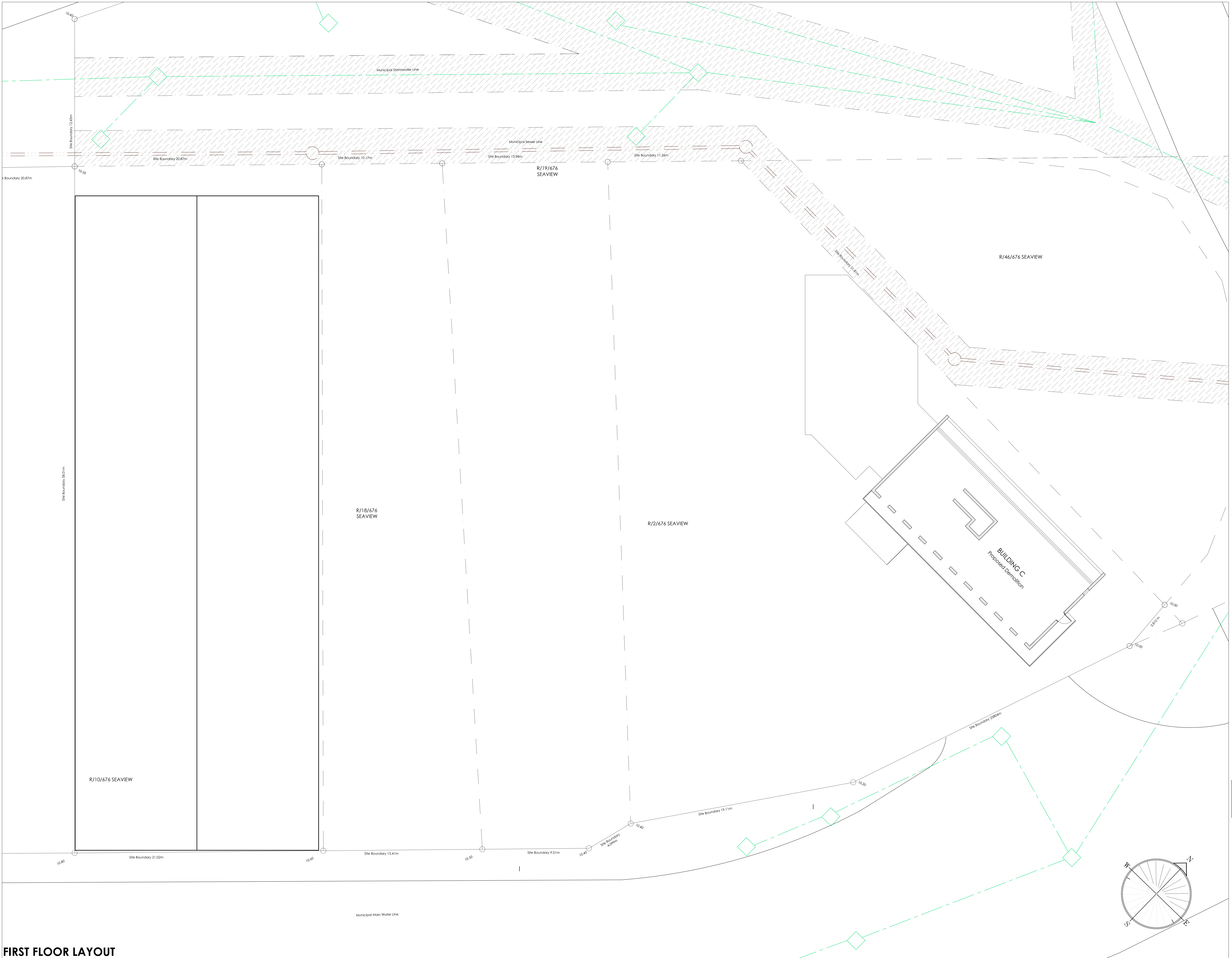

FIRST FLOOR LAYOUT

| | |
|---------------|---|
| OWNER | GANKUM PROPERTY INVESTMENTS (PTY) LTD |
| PROXY | KUMAREN PILLAY |
| CONTACT | 083 775 5921 |
| SIGNATURE (S) | |
| AUTHOR | Sumesh Govender |
| REGISTRATION | Pract 24692287 |
| CONTACT | 083 777 1569, design@sgarch.co.za |
| ADDRESS | 2 Firwood road, Oaklands, Verulam, 4339 |
| SIGNATURE | |



| | |
|--------------|--|
| PROJECT | SARNIA ROAD 98 |
| DESCRIPTION | PROPOSED ADDITIONS & ALTERATIONS |
| STREET ADDR. | 98 Sarnia Road, Rossburgh |
| ERF | Erf R/10/676, R/18/676, R/19/676, R/1/676, 1/677 SEAVIEW |
| STREET ADDR. | 100 Sarnia Road, Rossburgh |
| ERF | Sub S3 (OF 48) of 676 SEAVIEW + R/46/676 SEAVIEW |
| PROVINCE | Kwa Zulu Natal |
| DRAWING | FIRST FLOOR LAYOUT EXISTING |
| SCALE | 1:100@ A0 |
| DATE | 2022 06 06 |
| REVISION | 1 |
| DRAWING NO. | 2022.016.E102 |