

Copyright over all designs and drawings shall remain the property of the author and any provision to the contrary in terms of the copyright act no.63 of 1963 is hereby specifically excluded.
 All relevant details, levels and dimensions are to be checked on site prior to commencement of work.
 Any discrepancies are to be brought to the attention of the architect.
 The architectural professional accepts no responsibility for errors resulting from misinterpretation of the drawings.
 All work to be carried out strictly in accordance with the national building regulations and local authority regulations.
 All dimensions are given in millimeters.
 Do not scale this drawing.

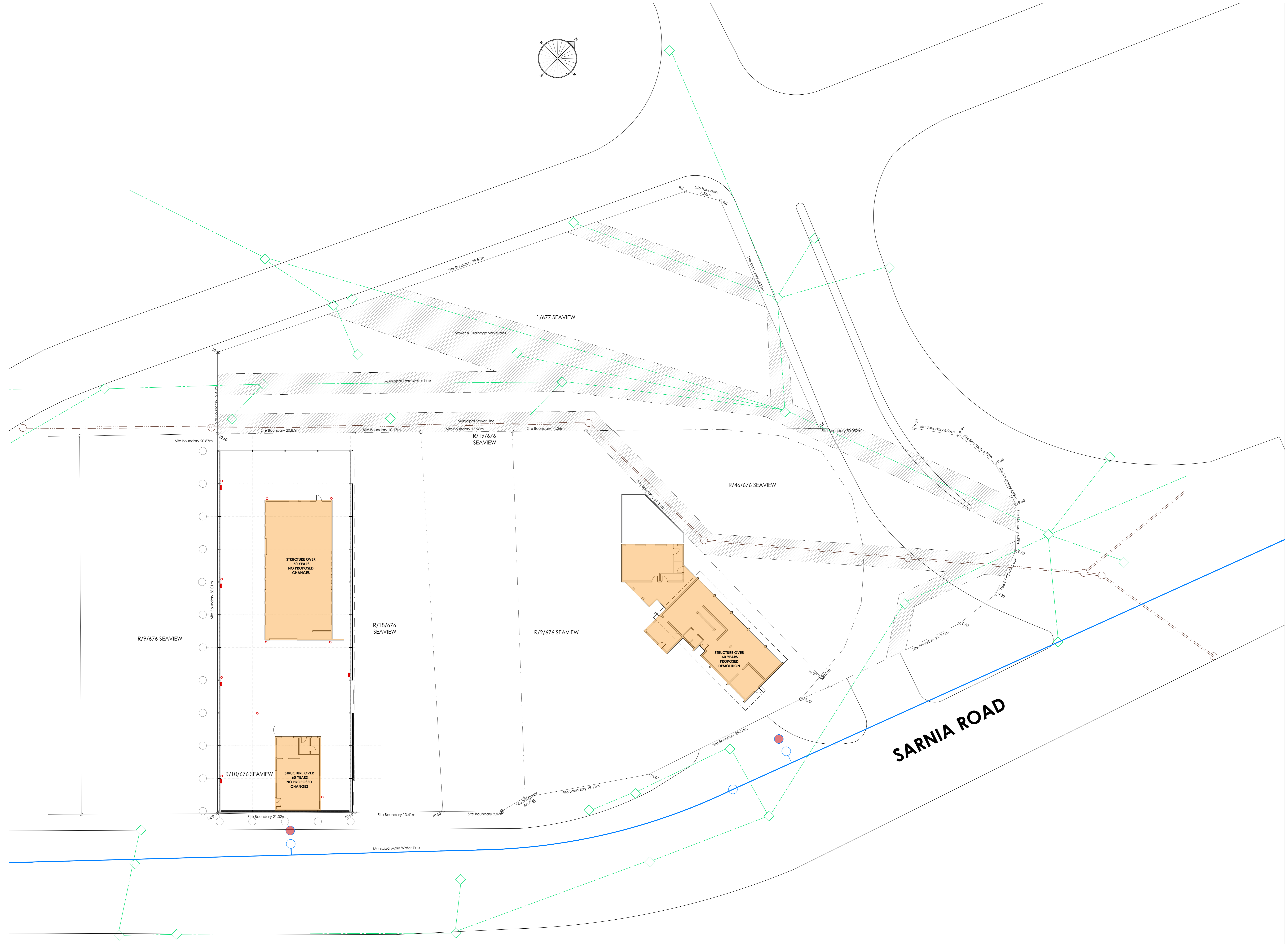

OWNER	GANKUM PROPERTY INVESTMENTS (PTY) LTD
PROXY	KUMAREN PILLAY
CONTACT	083 775 5921
SIGNATURE (S)	
AUTHOR	Sumesh Govender
REGISTRATION	PrArch 24692287
CONTACT	083 777 1569; design@sgarch.co.za
SIGNATURE	

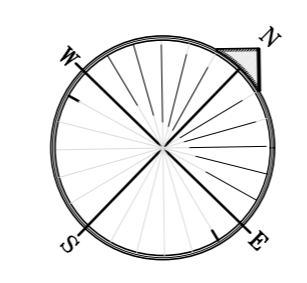

PROJECT	SARNIA ROAD 98
DESCRIPTION	PROPOSED ADDITIONS & ALTERATIONS
STREET ADD.	98 Sarnia Road, Rosburgh
ERF	ErF R/10/676, R/18/676, R/19/676, R/1/676, 1/677 SEAVIEW
STREET ADD.	100 Sarnia Road, Rosburgh
ERF	Sub S3 (CF-48) of 676 SEAVIEW + R/46/676 SEAVIEW
PROVINCE	Kwa Zulu Natal
DRAWING	SITE PLAN EXISTING
SCALE	1:200@ A1
DATE	2022-08-22
REVISION	1
DRAWING NO.	2022.016.H101