

REGULATION 2(2) PLAN

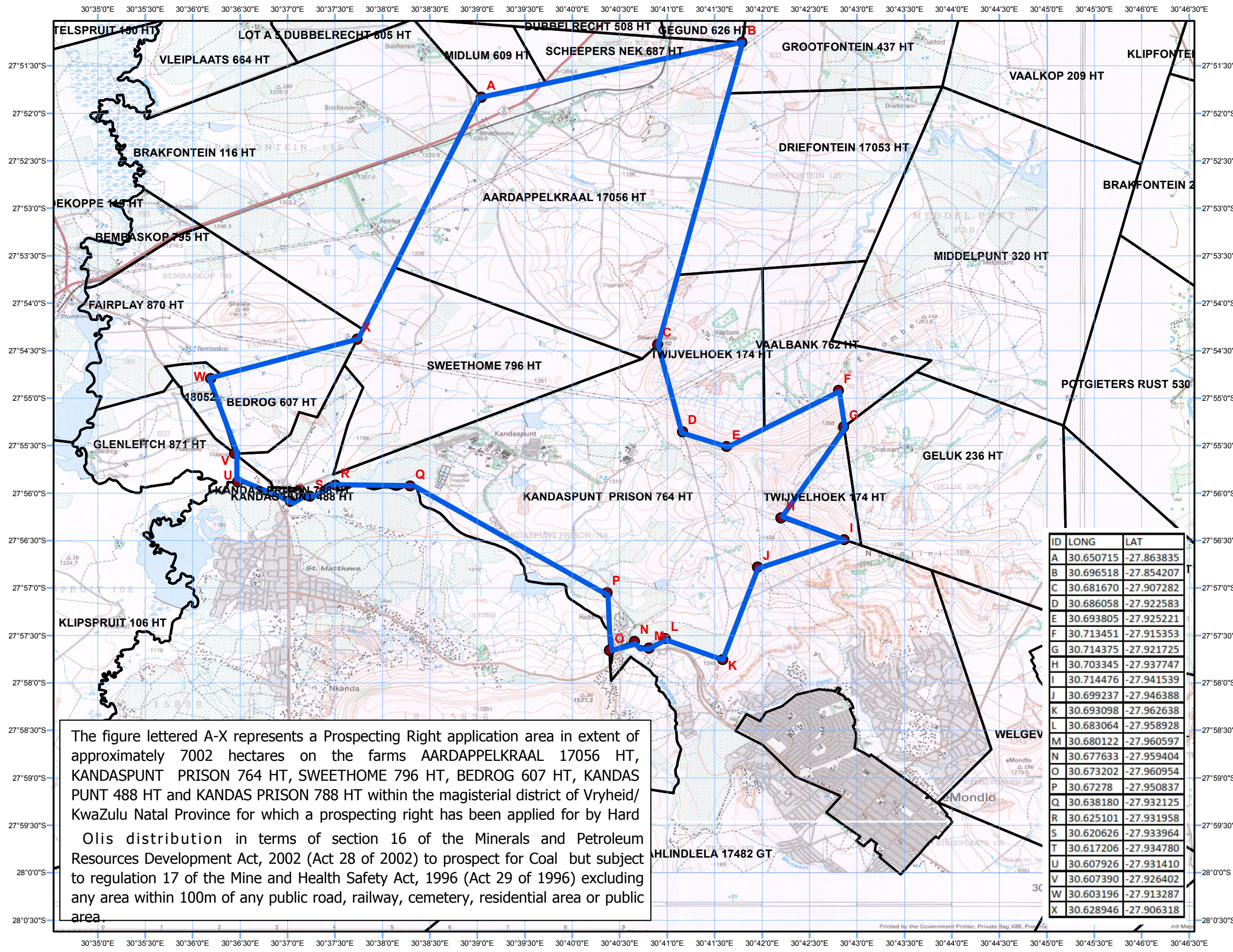

OLIS DISTRIBUTION CC

PROSPECTING RIGHT APPLICATION

PLAN COMPILED IN ACCORDANCE WITH REGULATION 2(2) OF THE MPRDA, 2002, (ACT NO 28 OF 2002)

TOTAL AREA EXTENT OF APPROXIMATELY 7002 HECTARES

SURVEY SYSTEM: GCS_WGS84

APPLICANT: Olis Distribution cc

SIGNATURE: _____

DATE: _____

LEGEND

FARM BOUNDARIES

APPLICATION AREA

ROADS

1:70 000

The figure lettered A-X represents a Prospecting Right application area in extent of approximately 7002 hectares on the farms AARDAPPELKRAAL 17056 HT, KANDASPUNT PRISON 764 HT, SWEETHOME 796 HT, BEDROG 607 HT, KANDAS PUNT 488 HT and KANDAS PRISON 788 HT within the magisterial district of Vryheid/ KwaZulu Natal Province for which a prospecting right has been applied for by Hard Olis distribution in terms of section 16 of the Minerals and Petroleum Resources Development Act, 2002 (Act 28 of 2002) to prospect for Coal but subject to regulation 17 of the Mine and Health Safety Act, 1996 (Act 29 of 1996) excluding any area within 100m of any public road, railway, cemetery, residential area or public area.

ID	LONG	LAT
A	30.650715	-27.863835
B	30.696518	-27.854207
C	30.681670	-27.907282
D	30.686058	-27.922583
E	30.693805	-27.925221
F	30.713451	-27.915353
G	30.714375	-27.921725
H	30.703345	-27.937747
I	30.714476	-27.941539
J	30.699237	-27.946388
K	30.693098	-27.962638
L	30.683064	-27.958928
M	30.680122	-27.960597
N	30.677633	-27.959404
O	30.673202	-27.960954
P	30.67278	-27.950837
Q	30.638180	-27.932125
R	30.625101	-27.931958
S	30.620626	-27.933964
T	30.617206	-27.934780
U	30.607926	-27.931410
V	30.607390	-27.926402
W	30.603196	-27.913287
X	30.628946	-27.906318

