

Proposed Residence on the Berea Burbar (Unnamed Rd)  
 for Mr. A. C. Foster Scale 1/8 inch = 1 foot

27 MUSGRAVE AV. 16 Ky lot 2034 B

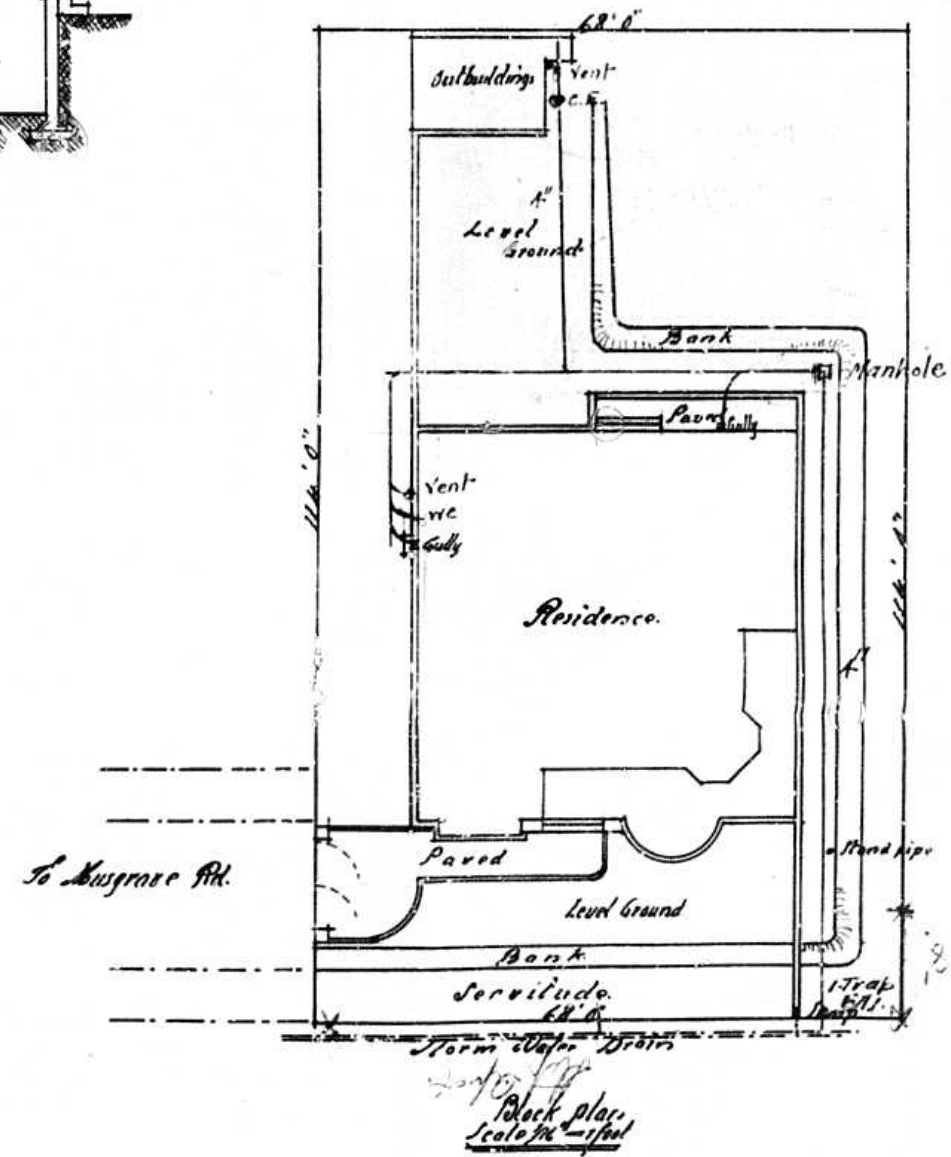
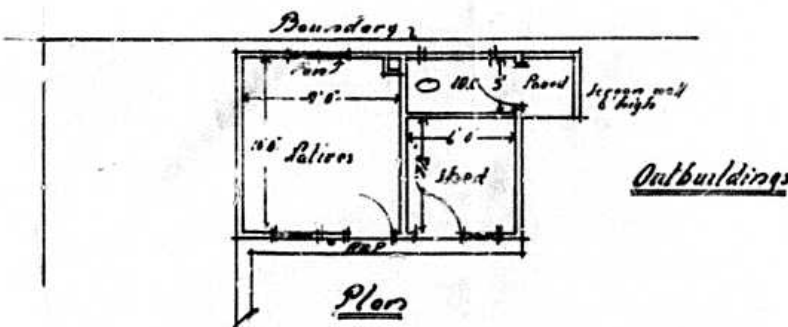
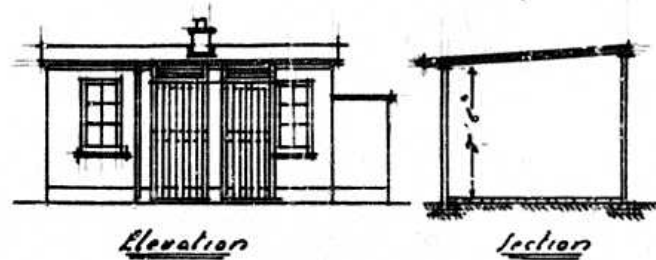
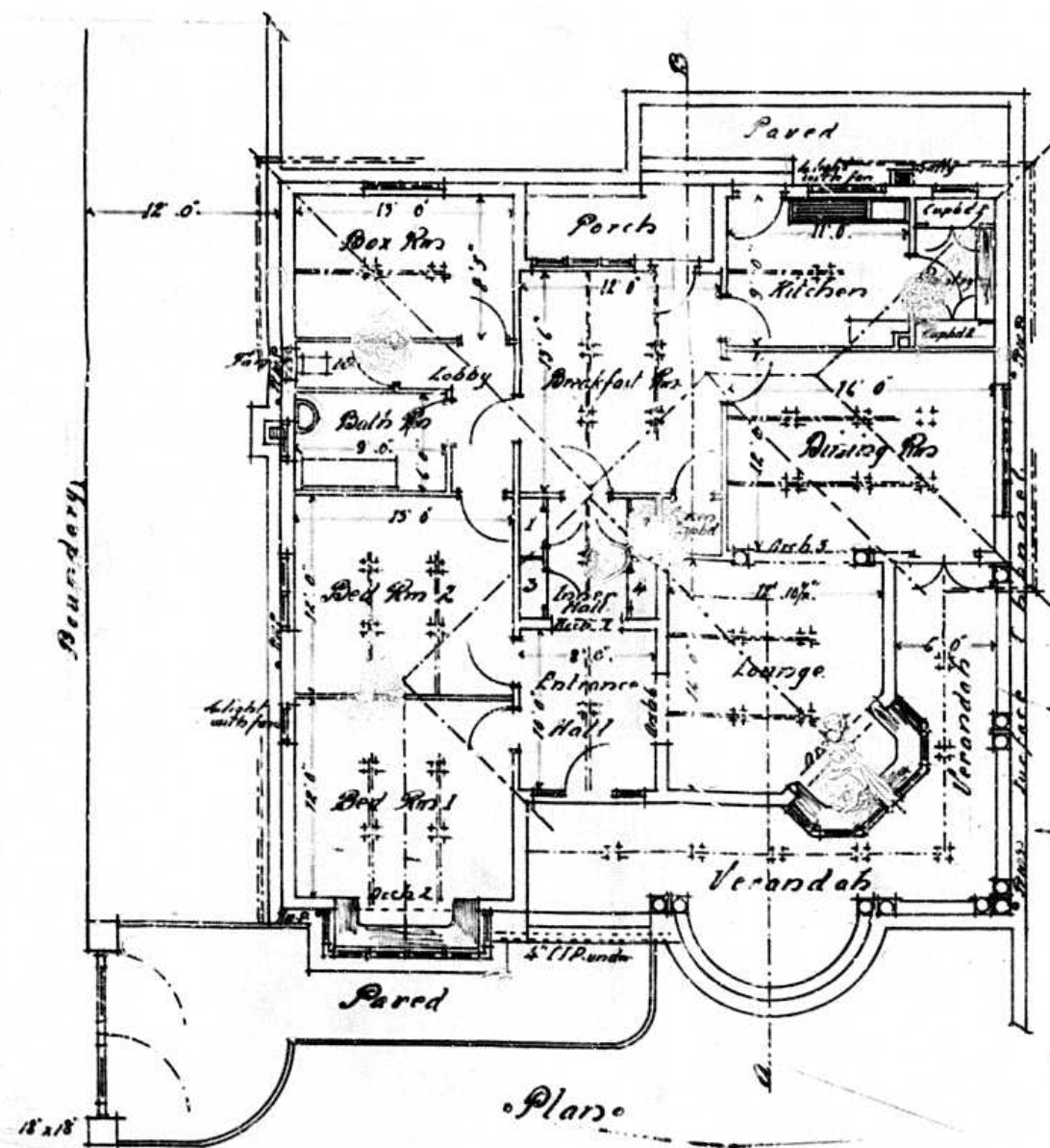
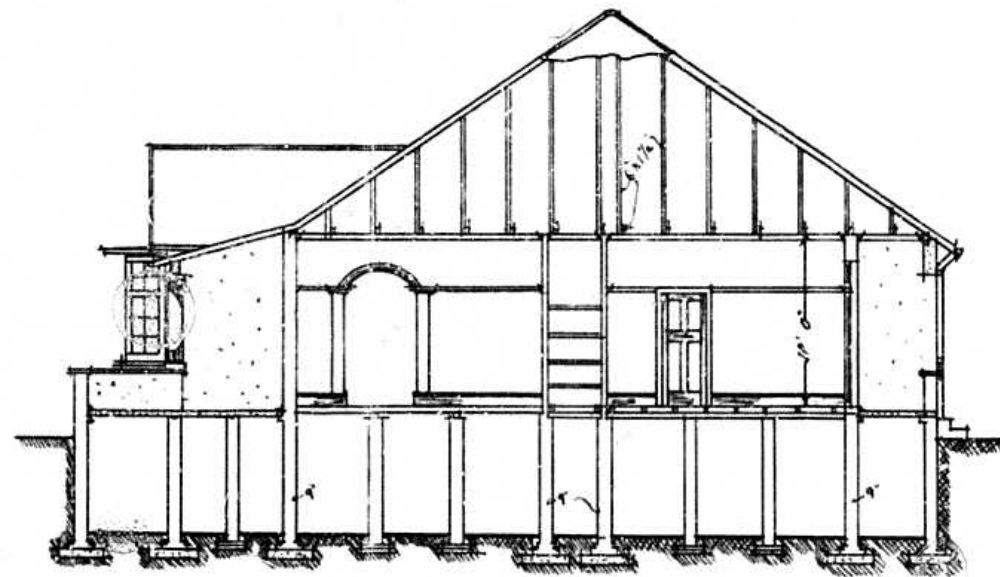
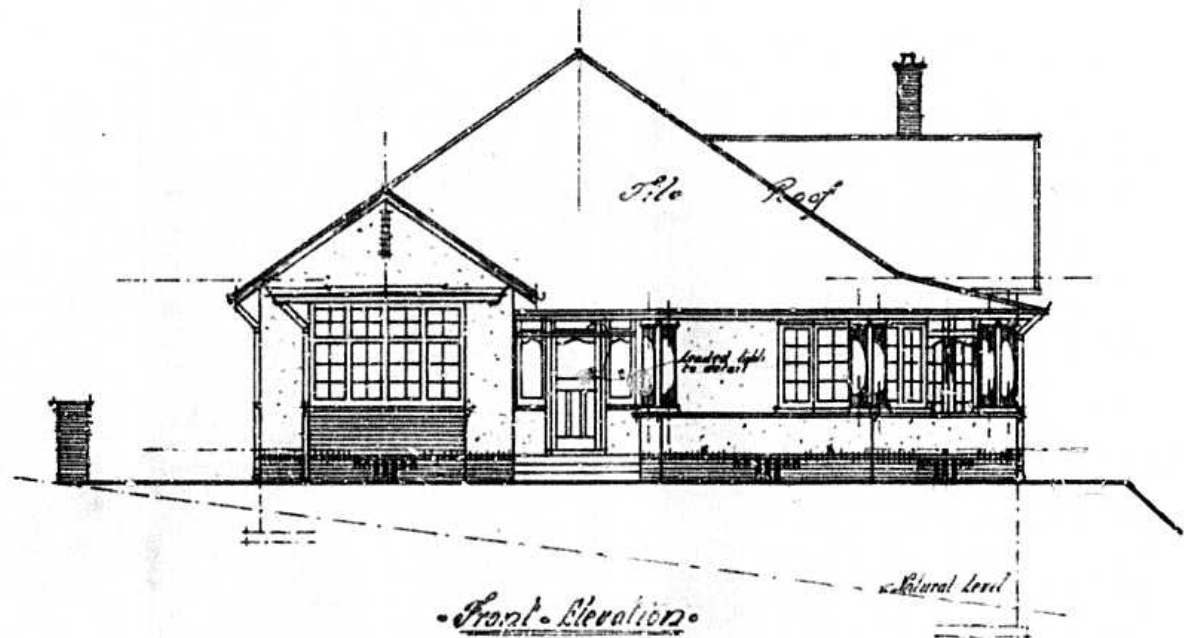

BOROUGH OF BURBAN.  
 PLANS APPROVED.  
 No. 16928

W. J. Ginn  
 Engineer