

PLAN SHOWING
PROPOSED FARM PRISON No. 18723
 HIBISCUS COAST MUNICIPALITY
 REGISTRATION DIVISION FT
 PROVINCE OF KWAZULU-NATAL
 SCALE 1:500

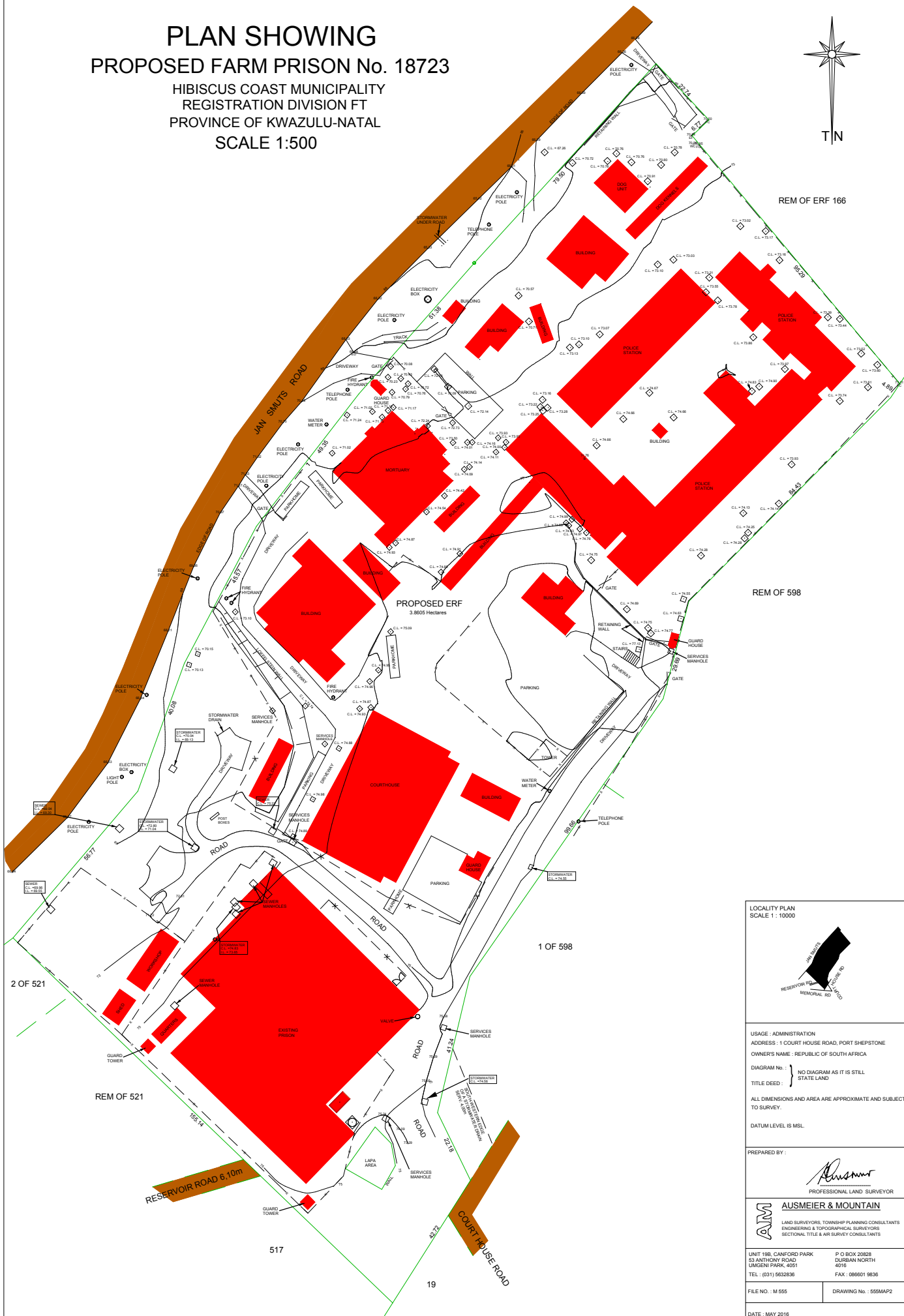
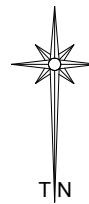

LOCALITY PLAN
 SCALE 1 : 10000

USAGE : ADMINISTRATION
 ADDRESS : 1 COURT HOUSE ROAD, PORT SHEPSTONE
 OWNER'S NAME : REPUBLIC OF SOUTH AFRICA
 DIAGRAM No. 1 : NO DIAGRAM AS IT IS STILL STATE LAND
 TITLE DEED : }
 ALL DIMENSIONS AND AREA ARE APPROXIMATE AND SUBJECT TO SURVEY.
 DATUM LEVEL IS MSL.

PREPARED BY :

 PROFESSIONAL LAND SURVEYOR

AUSMEIER & MOUNTAIN
 LAND SURVEYORS, TOWNSHIP PLANNING CONSULTANTS
 ENGINEERING & TOPOGRAPHICAL SURVEYORS
 SECTIONAL TITLE & AIR SURVEY CONSULTANTS

UNIT 19B, CANFORD PARK P O BOX 20828
 53 ANTHONY ROAD DURBAN NORTH
 4016
 TEL : (031) 5632836 FAX : 086601 9836

FILE NO. : M 555 DRAWING No. : 555M/A/2
 DATE : MAY 2016